

SHORT SERVICES
 STA. 6+70 & STA. 9+28
 FURNISH & INSTALL
 2 INCH OUTLET
 10 L.F. COPPER WATER LINE BY OPEN CUT
 CONNECT TO EXISTING WATER METER,
 INCLUDING ALL FITTINGS AND NEW METER BOX

LONG SERVICES
 STA. 6+82, STA. 6+83, STA. 6+84, STA. 6+86, STA. 9+57 & STA. 9+59
 FURNISH & INSTALL
 2 INCH OUTLET
 CONNECT TO EXISTING WATER SERVICES
 NO NEW SERVICE LINES REQUIRED UNDER PAVEMENT.

LEGEND

REINFORCED CONCRETE PAVT.
 REMOVAL AND REPLACEMENT

WATER LINE CONSTRUCTION
 BY OTHER THAN OPEN CUT

SUPERIOR AIR PARTS
 (15050 BELTWOOD PKWY.)

THOMAS REPROGRAPHICS
 (15000 BELTWOOD PKWY.)

WARNING
 LONE STAR GAS LINE
 NOTIFY LONE STAR GAS
 72 HOURS PRIOR TO
 EXCAVATION OR BORING
 IN THE VICINITY
 FOR SERVICE

WARNING
 LONE STAR GAS LINE
 NOTIFY LONE STAR GAS
 72 HOURS PRIOR TO
 EXCAVATION IN
 IN THE VICINITY
 OF STA. 8+25

WARNING
 LONE STAR GAS LINE
 NOTIFY LONE STAR GAS
 72 HOURS PRIOR TO
 EXCAVATION IN
 IN THE VICINITY
 OF STA. 10+25

- NOTE:**
- EXISTING WATER LINE SHALL REMAIN IN SERVICE DURING CONSTRUCTION OF NEW WATER LINE BETWEEN STA. 0+18 STA. 10+35. THE NEW LINE SHALL BE TESTED AND STERILIZED FROM THE SOUTH PRIOR TO CONNECTION TO 24" LINE IN BELT LINE ROAD.
 - CONTRACTOR SHALL KEEP ONE OF THE TWO DRIVEWAYS TO G.E. CAPITAL FLEET SERVICES OPEN AT ALL TIMES. TEMPORARY ACCESS CAN BE STEEL PLATE OR BACKFILL WITH 2" H.M.A.C. SURFACE.
 - CONTRACTOR SHALL NOTIFY PROPERTY OWNERS, TOWN OF ADDISON AND FIRE THE DEPT. PRIOR TO TRANSFER OF WATER SERVICES TO PROPOSED WATER MAIN.
 - CONTRACTOR SHALL FURNISH & INSTALL BENDS FOR 8 INCH WATER LINE GRADE CHANGE BETWEEN STATIONS 6+10 AND 6+70. FOUR BENDS REQUIRED.

TABLE OF COORDINATES

POINT	NORTH	EAST	ELEVATION
PT#1	5000.0000	5000.0000	626.75
PT#2	4668.1012	5088.9320	623.50
PT#391	4163.6763	5134.5572	621.32
STA. 6+00	4447.4520	5084.2888	-
STA. 8+00	4248.2640	5102.2931	-
STA. 10+00	4049.0761	5120.2974	-

FIELD CHANGE NO. 1
 1. ESTABLISH GRADE TO KNOWN BENCH MARK THAT IS TIED TO U.S.G.S

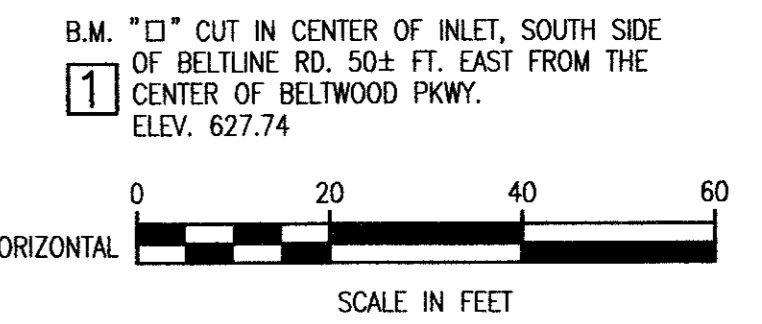

These plans and related specifications were prepared for construction of this specific project only. Reuse of these documents is not permitted without written authorization of Shimek, Jacobs & Finklea, L.L.P.

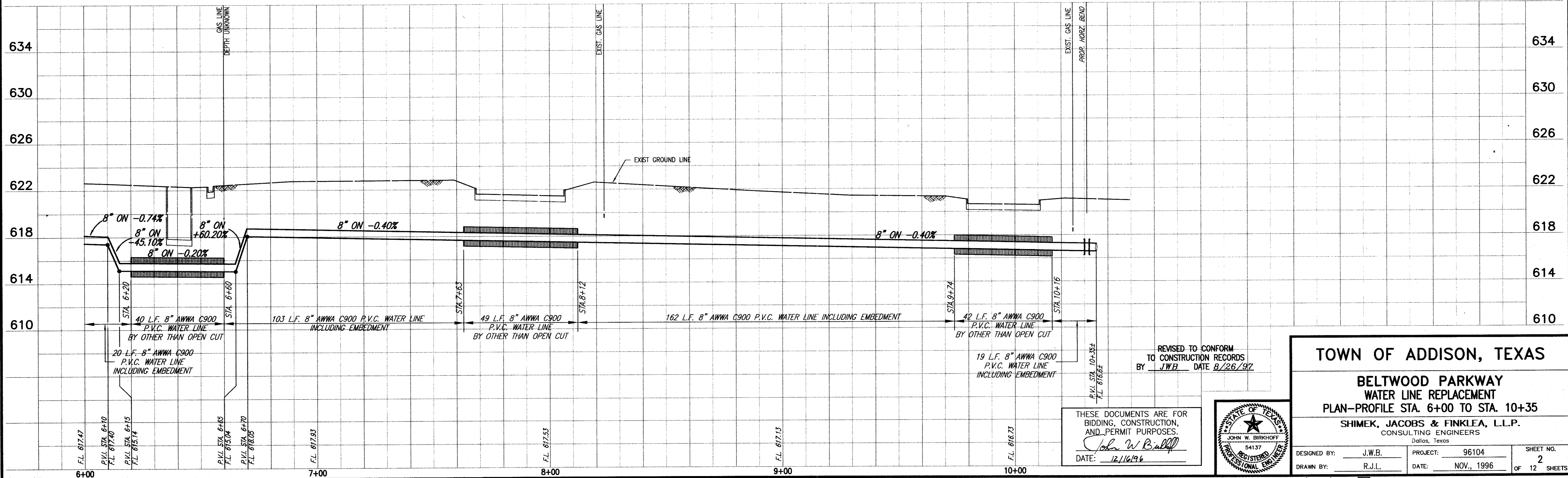

REVISED TO CONFORM TO CONSTRUCTION RECORDS BY JWB DATE 8/28/97

THESE DOCUMENTS ARE FOR BIDDING, CONSTRUCTION, AND PERMIT PURPOSES.
John W. Bull
 DATE: 12/16/96

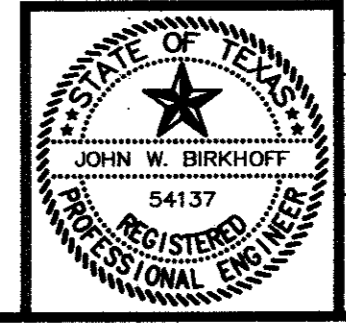

TOWN OF ADDISON, TEXAS

BELTWOOD PARKWAY WATER LINE REPLACEMENT
 PLAN-PROFILE STA. 6+00 TO STA. 10+35

SHIMEK, JACOBS & FINKLEA, L.L.P.
 CONSULTING ENGINEERS
 Dallas, Texas

DESIGNED BY: J.W.B. PROJECT: 96104 SHEET NO. 2
 DRAWN BY: R.J.L. DATE: NOV., 1996 OF 12 SHEETS