

FRONT ELEVATION

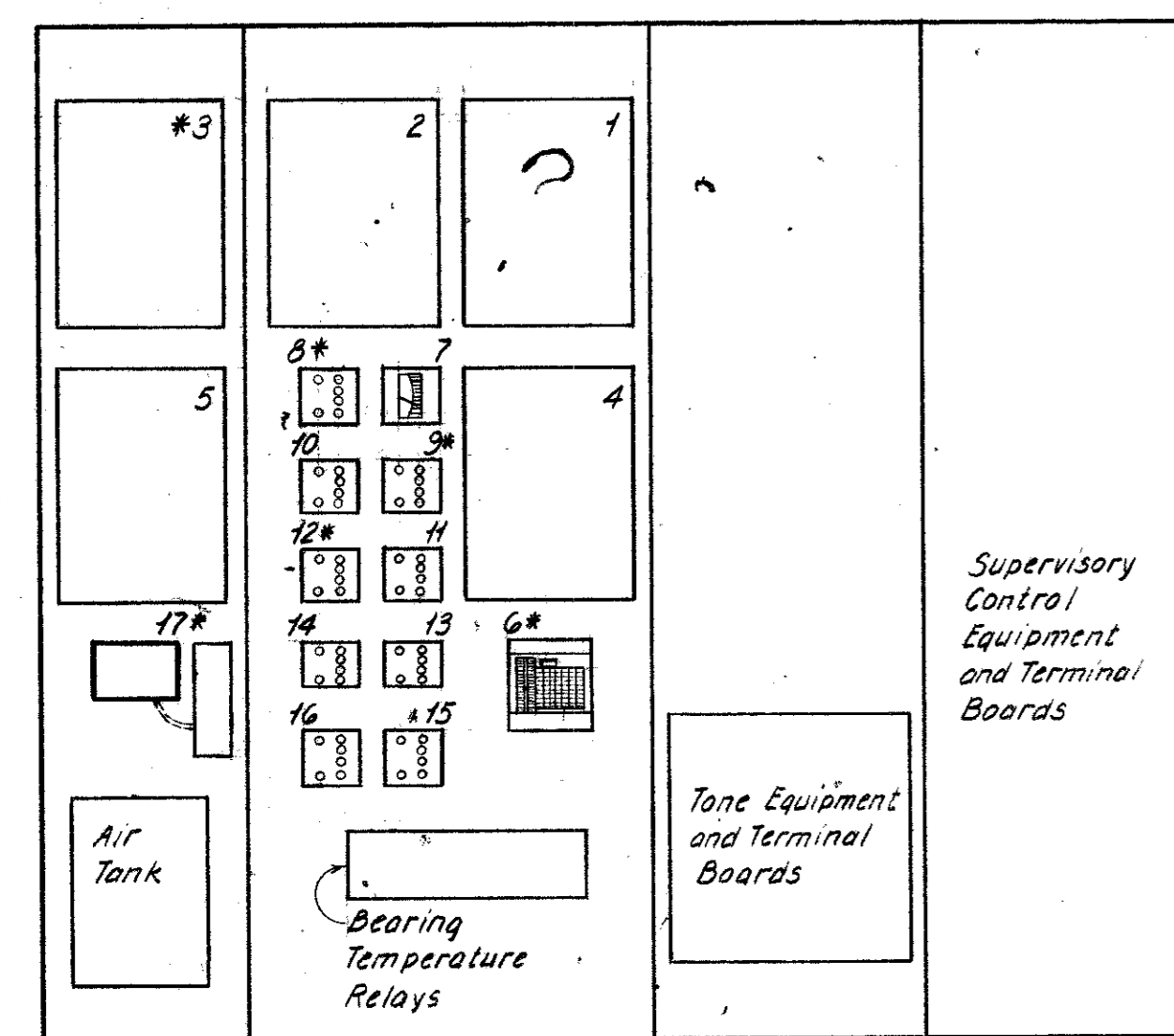

REAR ELEVATION
(Doors Removed)

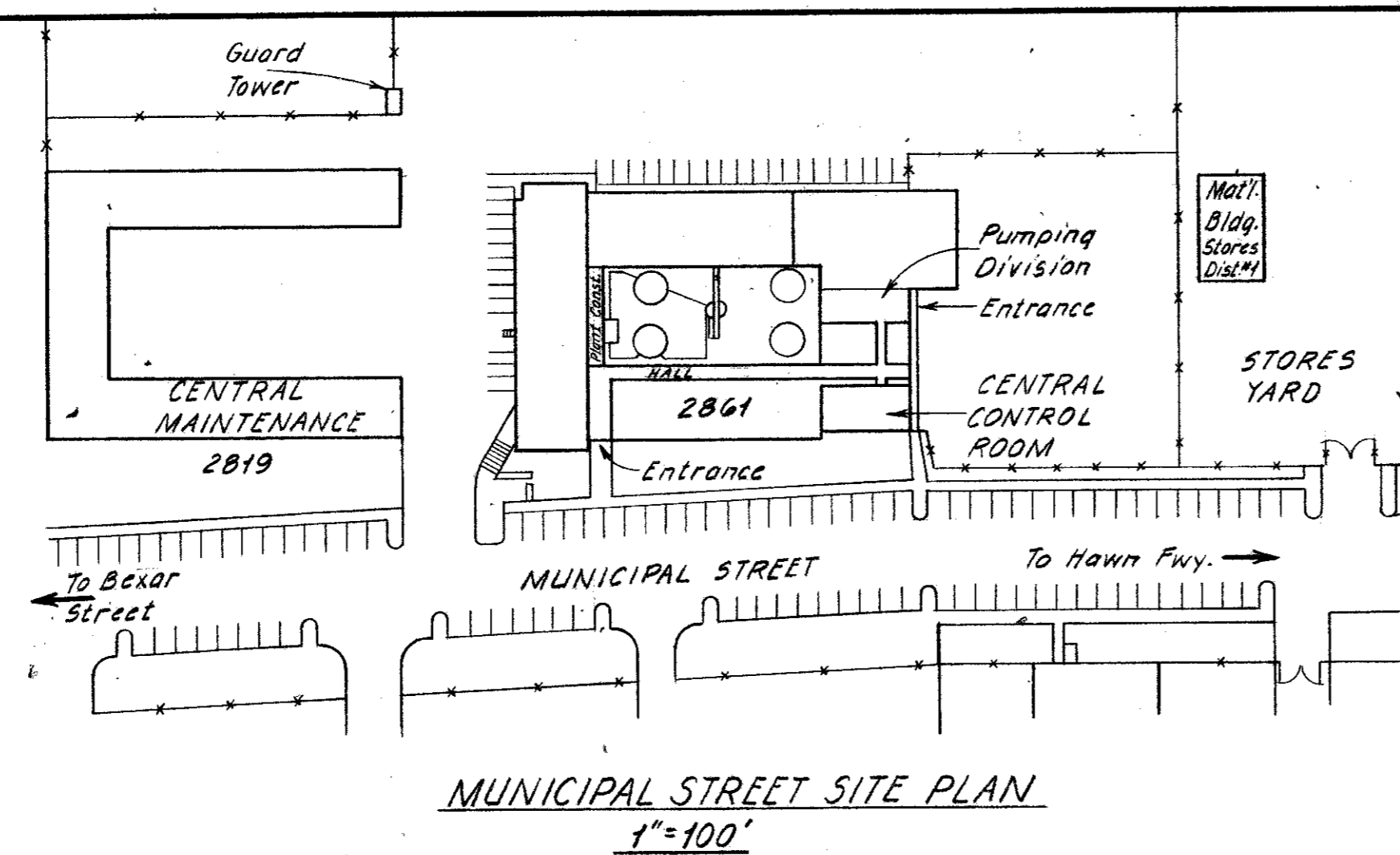

MUNICIPAL STREET SITE PLAN
1"=100'

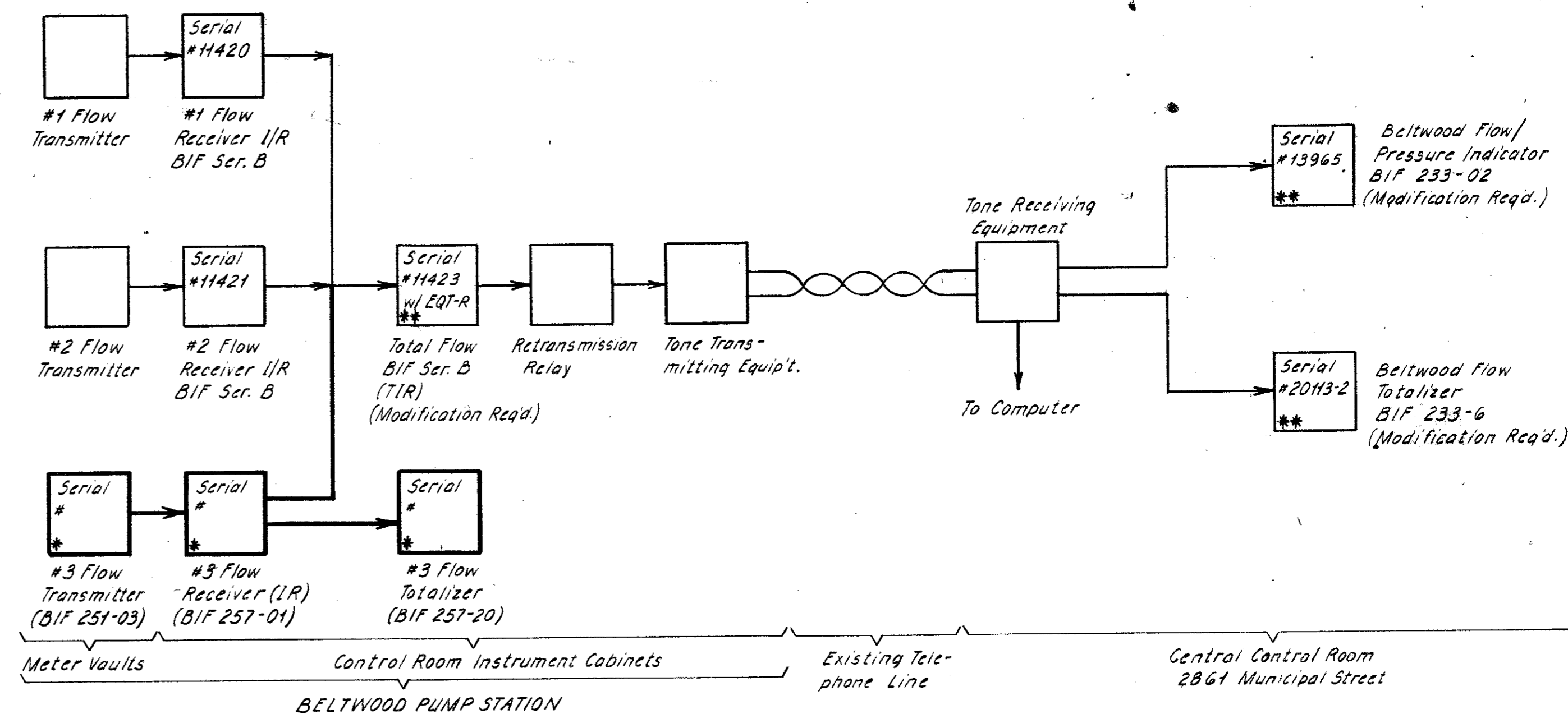

INSTRUMENTATION FLOW DIAGRAM

* Furnished by City - Installed by Contractor
** Furnished and Modified by City

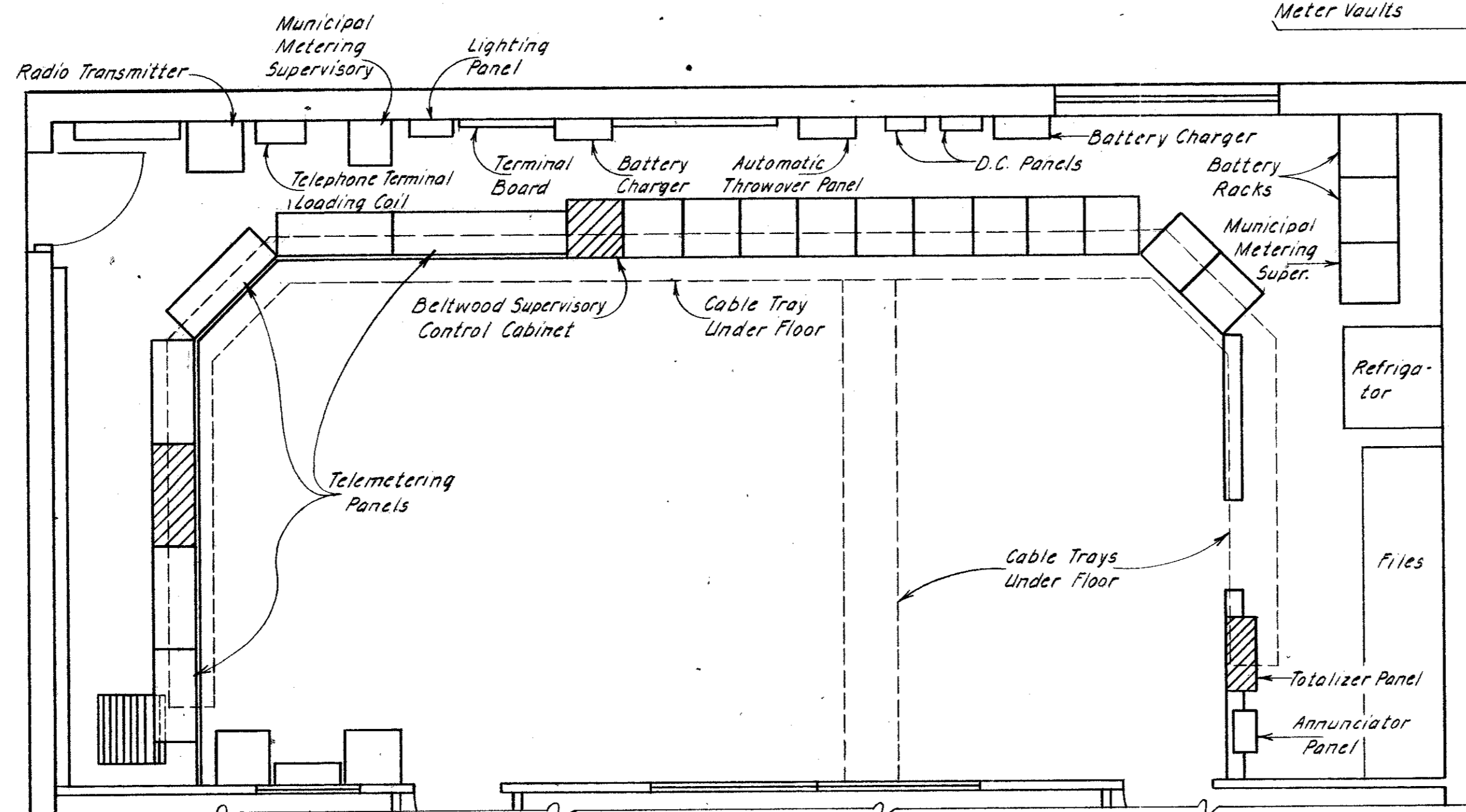

CENTRAL CONTROL ROOM PLAN
1/4"=1'-0"

- 1. Flow 1 - Indicator/Recorder
- 2. Flow 2 - Indicator/Recorder
- *3. Total Flow - Indicator/Recorder - Modification Required - By City.
- 4. Reservoir Level - Indicator/Recorder
- 5. Pressure - Indicator/Recorder
- *6. Flow 3 - Indicator/Recorder. Install This Contract.
- 7. Bearing Temperature Indicator
- *8. No. 1 Pump Temperature Monitor. Remove and Return to Engineer. Cover Hole with Blank Plate.
- *9. No. 2 Pump Temperature Monitor. Remove and Return to Engineer. Cover Hole with Blank Plate.
- 10. No. 3 Pump Temperature Monitor.
- 11. No. 4 Pump Temperature Monitor.
- *12. Pump No. 1, 2, 3, 4 Thrust Bearing Temperature Monitor. Disconnect Pump No. 1 and 2.
- 13. No. 5 Pump Temperature Monitor.
- 14. No. 6 Pump Temperature Monitor.
- 15. No. 7 Pump Temperature Monitor.
- 16. Pump No. 5, 6, 7 Thrust Bearing Temperature Monitor.
- *17. Flow 3 - Totalizer - Install This Contract.

BELTWOOD CONTROL PANELS
3/4"=1'-0"

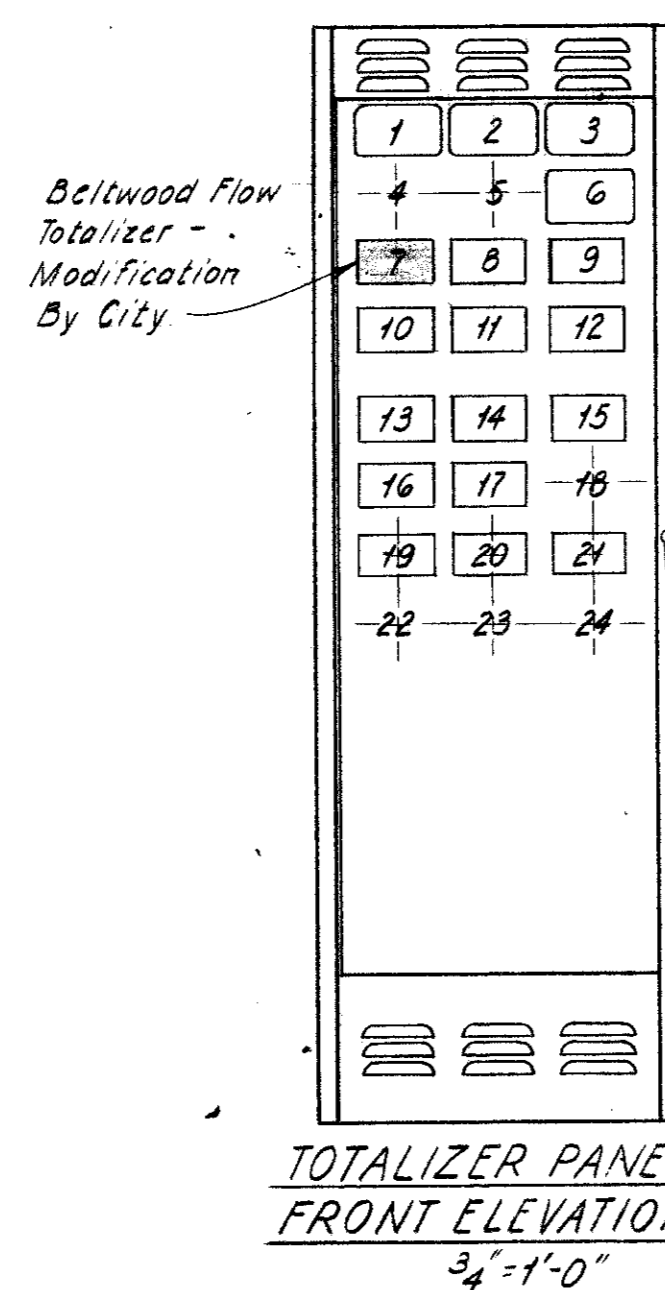

TOTALIZER PANEL
FRONT ELEVATION
3/4"=1'-0"

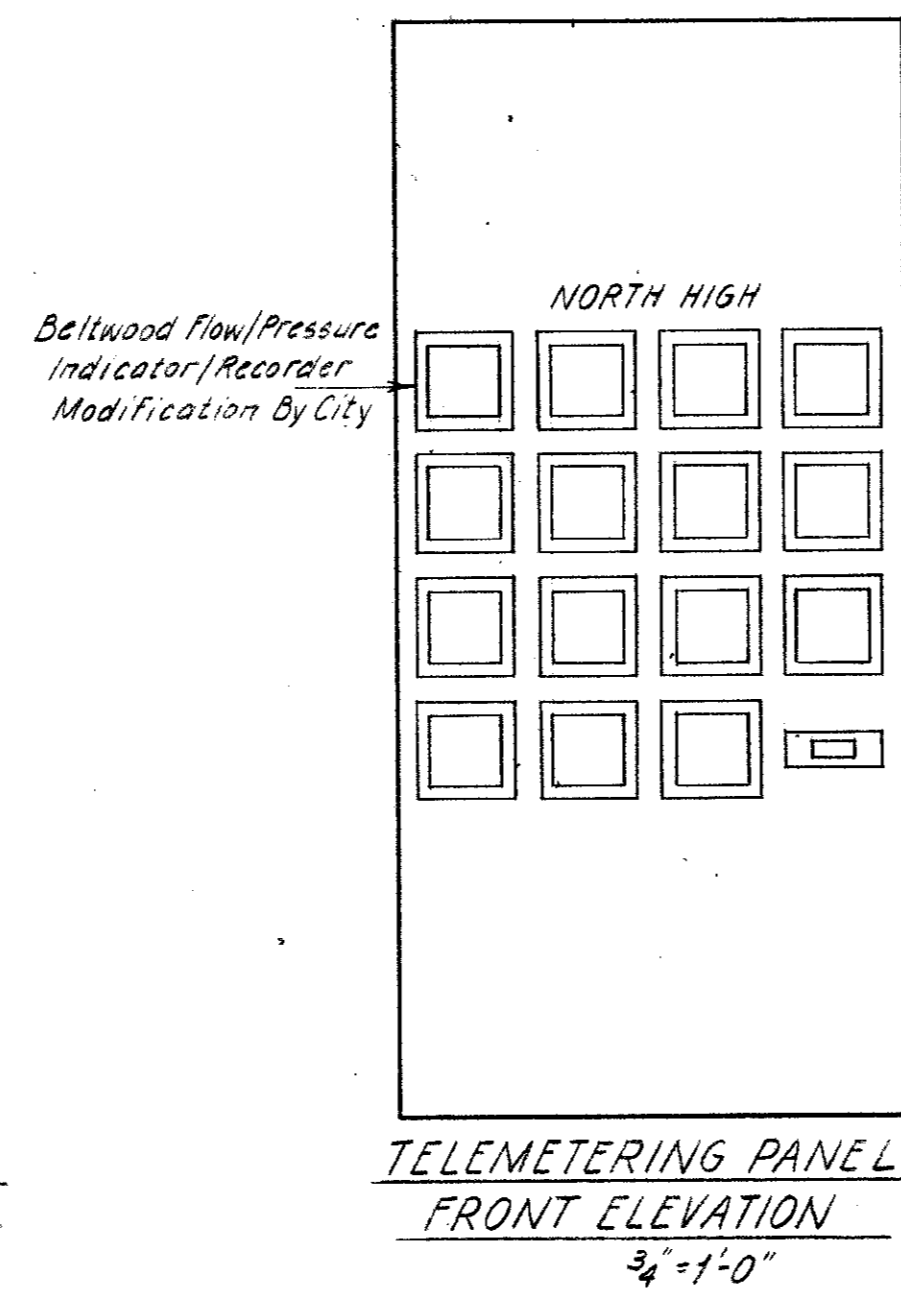

TELEMETERING PANEL
FRONT ELEVATION
3/4"=1'-0"

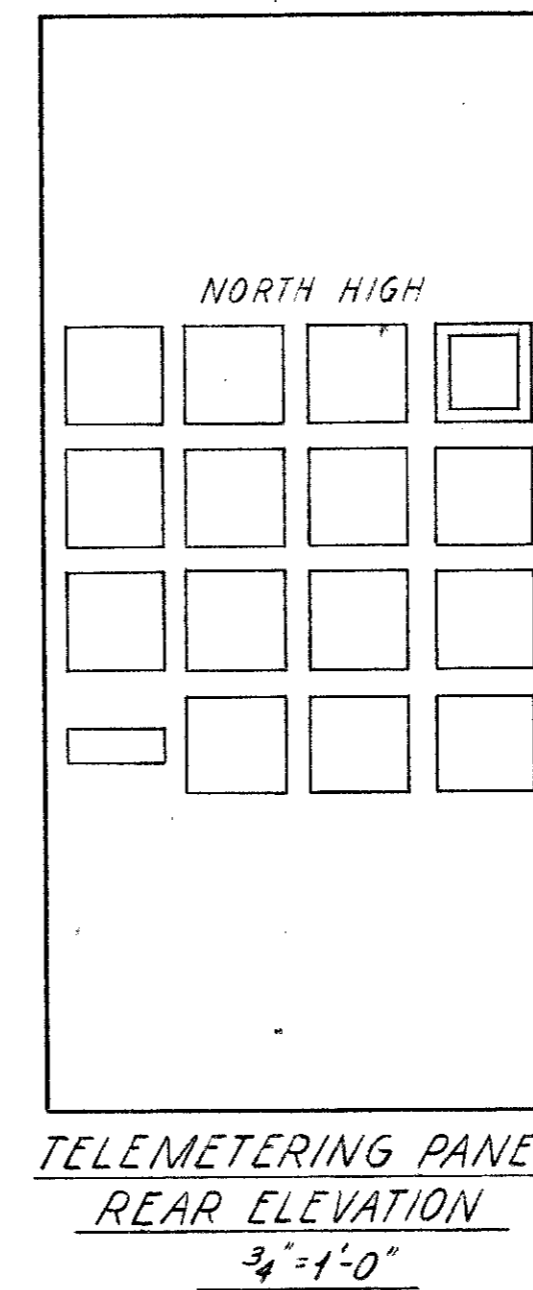

TELEMETERING PANEL
REAR ELEVATION
3/4"=1'-0"

CONTROL ROOM PLANS AND ELEVATIONS

Existing Device Modified Device

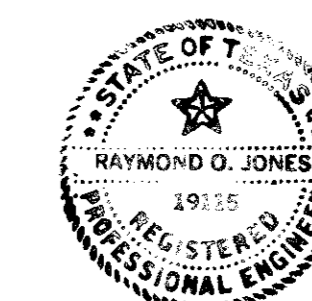

| DATE | REVISION | BY |
|--|----------|--------------------|
| INSTRUMENTATION PLANS, ELEVATIONS AND DIAGRAMS PUMPS 1A & 2A BELTWOOD PUMP STATION DALLAS WATER UTILITIES CITY OF DALLAS, TEXAS | | |
| DESIGN | ACP | CONTRACT NO. 81-7 |
| DRAWN | RME | FILE NO. 640Q-700B |
| CHECKED | | SHEET NO. 20 |
| DATE | Jan '81 | OF 20 |