

Line Stabilized Subgrade Required When P.I. is Greater Than 15. Otherwise Compact Subgrade to 95% Standard Proctor.

Typical Section

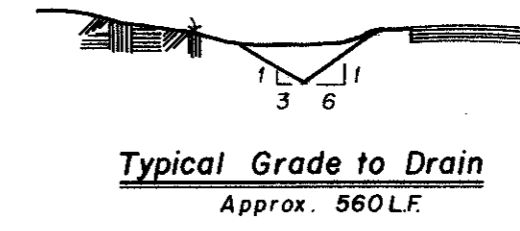

Typical Grade to Drain  
Approx. 560 LF

The contractor is responsible to preserve the final alignment and grade stakes as set by the engineer until the completed pavement is accepted by the City. In the event stakes are lost, the engineer accepts no responsibility for pavement alignment or grade.

- BENCH MARK # 1  
"1" on T.C. 60' east of Addison Road north side of Westgrove  
ELEVATION: 641.96
- BENCH MARK # 2  
"1" on T.C. 100'± north of Sir Lancelot Drive, west side of Addison Road  
ELEVATION: 642.49

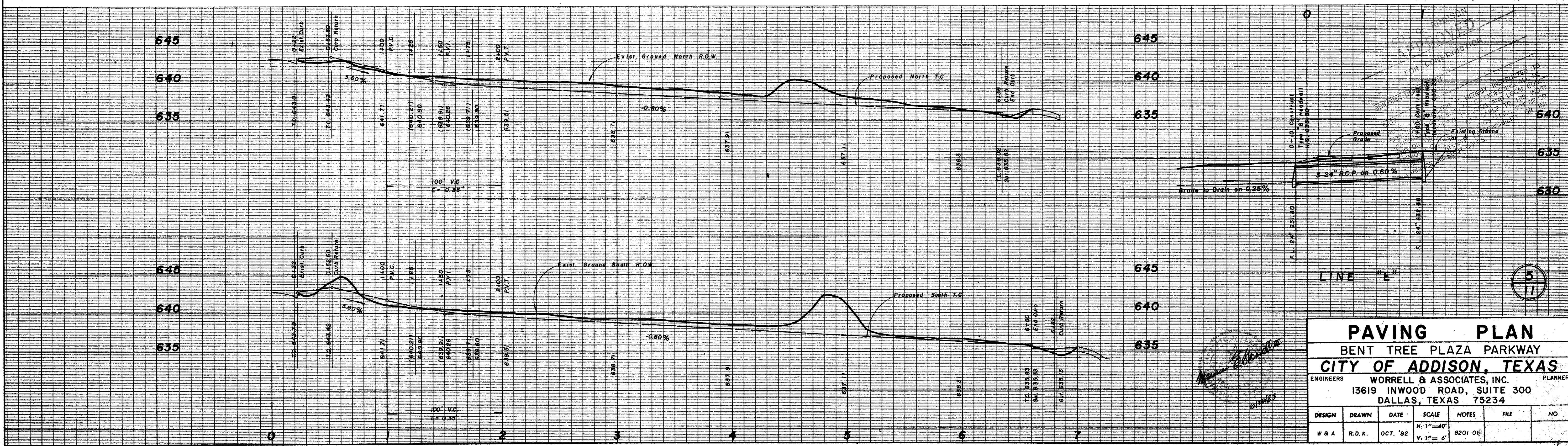

APPROVED FOR CONSTRUCTION

ENGINEERS: WORRELL & ASSOCIATES, INC.  
13619 INWOOD ROAD, SUITE 300  
DALLAS, TEXAS 75234

PLANNERS

DESIGN: W & A  
DRAWN: R.D.K.  
DATE: OCT. '82  
SCALE: H: 1"=40'  
V: 1"= 6'NOTES: 8201-01  
FILE: NO.