

**BENCH MARK # 1**  
 1"  $\square$  on T.C. 60' east of Addison Road north side of Westgrove.  
**ELEVATION:** 641.96

**BENCH MARK # 2**  
 1"  $\square$  on T.C. 100'± north of Sir Lancelot Drive, west side of Addison Road.  
**ELEVATION:** 642.49

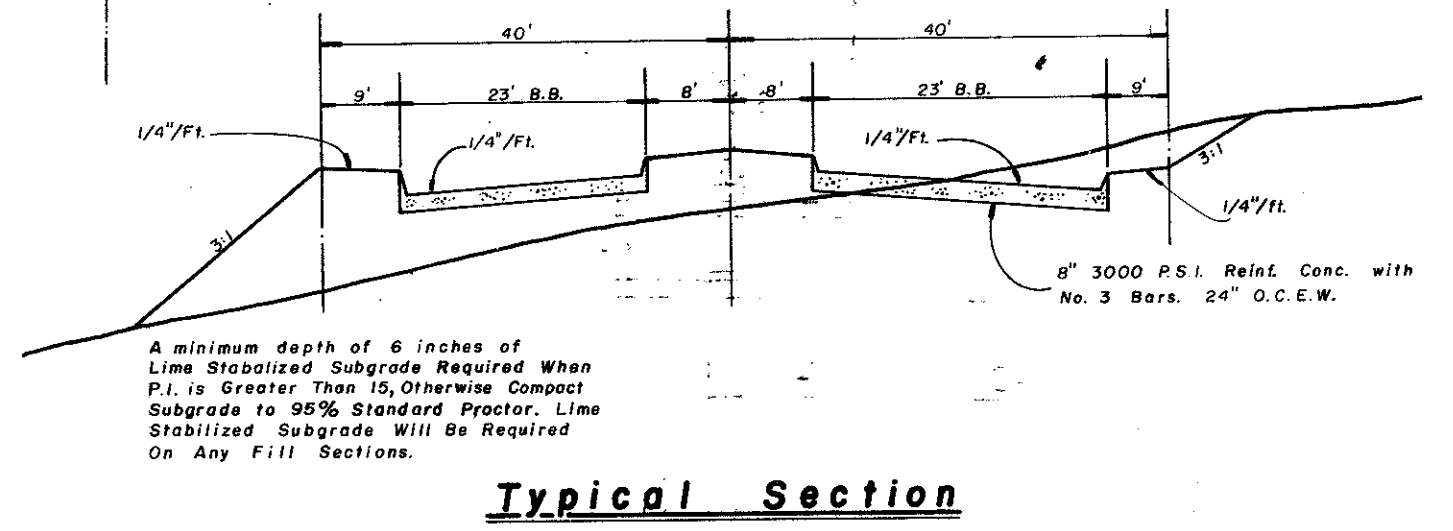

The contractor is responsible to preserve the final alignment and grade stakes as set by the engineer until the completed pavement is accepted by the City. In the event stakes are lost, the engineer accepts no responsibility for pavement alignment or grade.

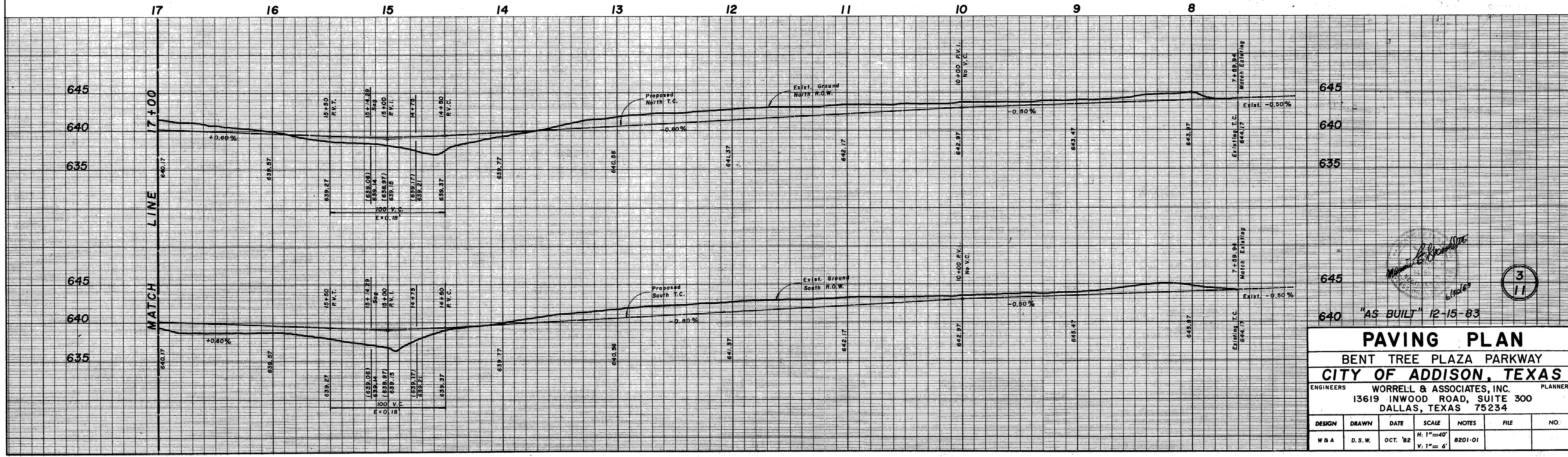

**PAVING PLAN**  
**BENT TREE PLAZA PARKWAY**  
**CITY OF ADDISON, TEXAS**

ENGINEERS: **WORRELL & ASSOCIATES, INC.** PLANNERS  
 13619 INWOOD ROAD, SUITE 300  
 DALLAS, TEXAS 75234

DESIGN: W & A    DRAWN: D.S.W.    DATE: OCT. '82    SCALE: H: 1"=40' V: 1"=6'    NOTES: 8201-01    FILE:    NO:   

AS BUILT 12-15-83

3/11