

Typical Section

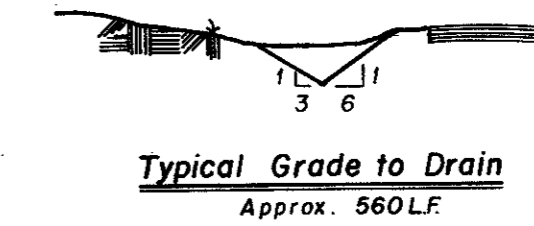

Typical Grade to Drain
Approx. 560 LF

The contractor is responsible to preserve the final alignment and grade stakes as set by the engineer until the completed pavement is accepted by the City. In the event stakes are lost, the engineer accepts no responsibility for pavement alignment or grade.

BENCH MARK # 1

"□" on T.C. 60' east of Addison Road north side of Westgrove
ELEVATION: 641.96

BENCH MARK # 2

"□" on T.C. 100'± north of Sir Lancelot Drive, west side of Addison Road
ELEVATION: 642.49

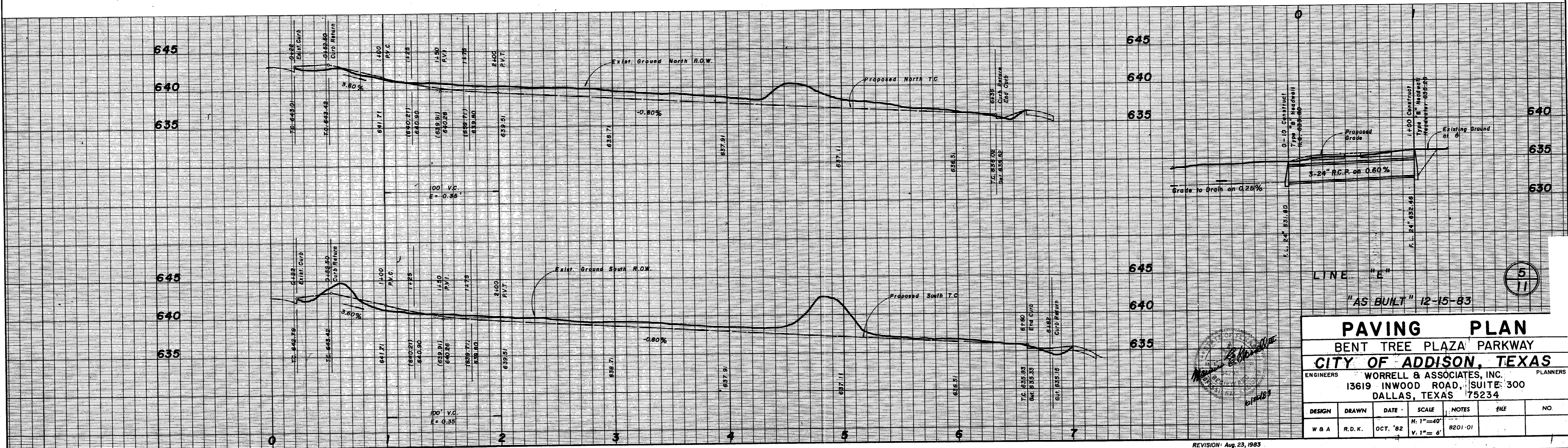

PAVING PLAN					
BENT TREE PLAZA PARKWAY					
CITY OF ADDISON, TEXAS					
ENGINEERS		WORRELL & ASSOCIATES, INC.		PLANNERS	
13619 INWOOD ROAD, SUITE 300					
DALLAS, TEXAS 75234					
DESIGN	DRAWN	DATE	SCALE	NOTES	NO
W & A	R.D.K.	OCT. '82	H: 1"=40' V: 1"= 6'	8201-01	