

WATER & SEWER SPECIFICATIONS

PVC Pressure Pipe

The PVC pipe shall be SDR-18, Dimension Class 150. The pipe shall meet or exceed requirements of AWWA C-900-75, PVC pipe with cast iron outside dimensions and with rubber ring joints. PVC water pipe shall be listed by Underwriters Laboratories and approved for use in cities and towns of Texas by the State Board of Insurance. The rigid PVC pipe shall bear the seal of approval (or NSF mark) of the National Sanitation Foundation Testing Laboratory for potable water pipe. Provisions must be made for contraction and expansion at each joint with a rubber ring, and an integral thickened bell as part of each joint. Pipe and fittings must be assembled with a non-toxic lubricant. Pipe shall be made from NSF approved Class 12454-A or B PVC Pipe Compound conforming to ASTM resin specification D1784.

Joints and Fittings - Fittings shall be mechanical joint or rubber ring slip joint cast iron fittings.

PVC Sewer Pipe

PVC pipe and fittings shall meet the extra strength requirements of ASTM specification D3034, SDR 34. Pipe shall have integral wall bell and spigot joints.

Joints - Joints for the PVC pipe and fittings shall be compression rubber gasket joints. The bell shall consist of an integral wall section with factory installed ring securely locked in bell groove to provide positive seal under all installation conditions.

Fittings - Fittings and accessories shall be manufactured and furnished by the pipe supplier and have bell and/or spigot configuration identical to that of the pipe.

Stiffness - Minimum pipe stiffness at 5% deflection shall be 46 for all sizes when calculated in accordance with ASTM D-2412.

Connections at Manholes - Asbestos cement sleeves with rubber ring joint will be used at manhole walls to provide positive water tight connections.

Pipe Bedding

Bedding material for water and sewer pipe shall be sand. Sand shall be placed 6" below the pipe, around the pipe, and 6" above the pipe.

Tracer

A no. 12 coated copper wire shall be placed in the trench over all water lines.

**FIRE HYDRANTS TO BE MUELLER CENTURION.
MANHOLES TO BE POURED IN PLACE.**

NOTE: ALL FIRELANES SHALL BE A MINIMUM WIDTH OF 24', LETTERED & STIPPED TO CITY OF ADDISON SPECS. WHERE CURBS ARE PRESENT STRIPES SHALL BE PAINTED ON FACE OF CURB.

CONNECT TO EX. 20" CONC. STEEL WATER LINE - INSTALL 1-20"x8" TAPPING SLEEVE & VALVE 1-8" VALVE

REMOVE & REPLACE EXIST. PAVEMENT

CAUTION! B.W.B. UNDERGROUND TELEPHONE

REMOVE & REPLACE EX. PAVT.

CONNECT TO EX. 20" CONC. STEEL WATER LINE - INSTALL 1-20"x8" TAPPING SLEEVE & VALVE 1-8" VALVE

CAUTION! BURIED TELE. CABLE CONTACT 404-0229 48 HRS. PRIOR TO START OF CONSTRUCTION.

29' BRAZOS ELEC. ESMT. VOL. 3087 PG. 404

28' BRAZOS ELEC. AERIAL EASEMENT VOL. 4922 PG. 563

INSTALL 1-8"x8"x6" TEE 1-6" VALVE 1-FIRE HYDRANT

INSTALL 1-8"x6" TEE 1-6" VALVE 1-FIRE HYDRANT

30' INGRESS & EGRESS EASEMENT VOL. 72245 PG. 1834

EXISTING 7'x7' CONCRETE PAD FOR POWER TRANSFORMER

INSTALL 1-8"x8"x6" TEE 1-6" VALVE 1-FIRE HYDRANT

INSTALL 1-8" VALVE

INSTALL 1-8" 90° BEND

INSTALL 1-8" 90° BEND

INSTALL 1-8"x8"x6" TEE 1-6" VALVE 1-FIRE HYDRANT

INSTALL 1-8"x8"x6" TEE 1-6" VALVE 1-FIRE HYDRANT

INSTALL 2" SERVICE

CONNECT TO EXISTING 8" C.I. WATER INSTALL 1-8"x8" TAPPING SLEEVE 1-8" VALVE

CONNECT TO EXISTING 10" P.V.C. SANI. SEWER PLAN E: Q15.92

CONNECT TO EXIST. 8" STUBOUT PLAN E: Q14.43

CONNECT TO EXISTING 8" C.I. WATER INSTALL 1-8"x8" TAPPING SLEEVE 1-8" VALVE

ARC CURVE DATA
Δ = 1° 20' 26"
R = 220.00'
T = 2.57'
L = 5.15'

REVISION	DATE	REVISION	DATE
R.H. STEPHENS AND ASSOCIATES CONSULTING ENGINEERS 2825 HIGHLAND BLVD. HOUSTON, TEXAS 77057		WATER & SANITARY SEW. BENT TREE VALLEY APARTMENTS	
SHEET NO. 4 OF 5 SCALE: 1" = 40' DRAWN BY: S.C.B. SURVEYED BY: R.H. CHECKED BY: B.L.S. JOB NO. 80024			

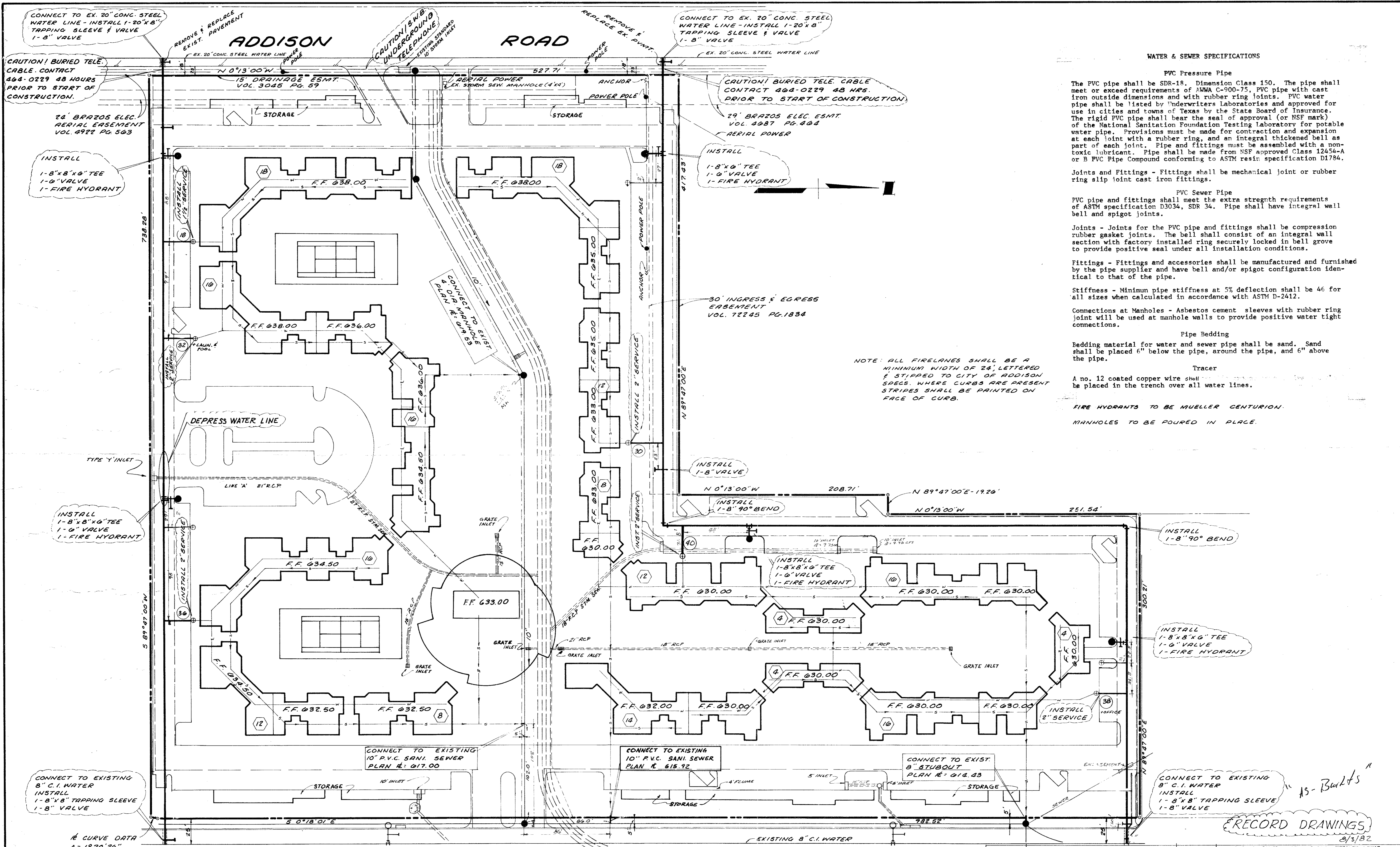

WATER & SEWER SPECIFICATIONS

PVC Pressure Pipe

The PVC pipe shall be SDR-18. Dimension Class 150. The pipe shall meet or exceed requirements of AWWA C-900-75, PVC pipe with cast iron outside dimensions and with rubber ring joints. PVC water pipe shall be listed by Underwriters Laboratories and approved for use in cities and towns of Texas by the State Board of Insurance. The rigid PVC pipe shall bear the seal of approval (or NSF mark) of the National Sanitation Foundation Testing Laboratory for potable water pipe. Provisions must be made for contraction and expansion at each joint with a rubber ring, and an integral thickened bell as part of each joint. Pipe and fittings must be assembled with a non-toxic lubricant. Pipe shall be made from NSF approved Class 12454-A or B PVC Pipe Compound conforming to ASTM resin specification D1784.

Joint and Fittings - Fittings shall be mechanical joint or rubber ring slip joint cast iron fittings.

PVC Sewer Pipe

PVC pipe and fittings shall meet the extra strength requirements of ASTM specification D3034, SDR 34. Pipe shall have integral wall bell and spigot joints.

Joints - Joints for the PVC pipe and fittings shall be compression rubber gasket joints. The bell shall consist of an integral wall section with factory installed ring securely locked in bell groove to provide positive seal under all installation conditions.

Fittings - Fittings and accessories shall be manufactured and furnished by the pipe supplier and have bell and/or spigot configuration identical to that of the pipe.

Stiffness - Minimum pipe stiffness at 5% deflection shall be 46 for all sizes when calculated in accordance with ASTM D-2412.

Connections at Manholes - Asbestos cement sleeves with rubber ring joint will be used at manhole walls to provide positive water tight connections.

Pipe Bedding

Bedding material for water and sewer pipe shall be sand. Sand shall be placed 6" below the pipe, around the pipe, and 6" above the pipe.

Tracer

A no. 12 coated copper wire shall be placed in the trench over all water lines.

FIRE HYDRANTS TO BE MUELLER CENTURION.

MANHOLES TO BE POURED IN PLACE.

NOTE: ALL FIRELANES SHALL BE A MINIMUM WIDTH OF 24', LETTERED & STRIPPED TO CITY OF ADDISON SPECS. WHERE CURBS ARE PRESENT STRIPES SHALL BE PAINTED ON FACE OF CURB.

CONNECT TO EX. 20" CONC. STEEL WATER LINE - INSTALL 1-20"x8" TAPPING SLEEVE & VALVE 1-8" VALVE

REMOVE & REPLACE EXIST. PAVEMENT

CAUTION! BURIED TELE. UNDERGROUND

REMOVE & REPLACE EX. PAVEMENT

CONNECT TO EX. 20" CONC. STEEL WATER LINE - INSTALL 1-20"x8" TAPPING SLEEVE & VALVE 1-8" VALVE

CAUTION! BURIED TELE. CABLE CONTACT 464-0229 48 HRS. PRIOR TO START OF CONSTRUCTION

24' BRAZOS ELEC. AERIAL EASEMENT VOL. 4922 PG. 563

INSTALL 1-8"x8"x6" TEE 1-6" VALVE 1-FIRE HYDRANT

INSTALL 1-8"x6" TEE 1-6" VALVE 1-FIRE HYDRANT

30' INGRESS & EGRESS EASEMENT VOL. 72245 PG. 1834

INSTALL 1-8"x8"x6" TEE 1-6" VALVE 1-FIRE HYDRANT

INSTALL 1-8" VALVE

INSTALL 1-8" 90° BEND

INSTALL 1-8" 90° BEND

INSTALL 1-8"x8"x6" TEE 1-6" VALVE 1-FIRE HYDRANT

INSTALL 2" SERVICE

CONNECT TO EXISTING 8" C.I. WATER INSTALL 1-8"x8" TAPPING SLEEVE 1-8" VALVE

CONNECT TO EXISTING 8" C.I. WATER INSTALL 1-8"x8" TAPPING SLEEVE 1-8" VALVE

CONNECT TO EXISTING 10" P.V.C. SANI. SEWER PLAN # 017.00

CONNECT TO EXISTING 10" P.V.C. SANI. SEWER PLAN # 615.92

CONNECT TO EXIST. 8" STUBOUT PLAN # 016.43

RECORD DRAWINGS

ARC CURVE DATA
 Δ = 1° 20' 26"
 R = 220.00'
 T = 2.57'
 L = 5.15'

REVISION	DATE: PARKING REVISED 5-18-81	REVISION	DATE: BLDG GRADES LOW'ED 9-20-81	ENTRANCE CHANGE
POLY L. STEPHENS AND ASSOCIATES CONSULTING ENGINEERS		WATER & SANITARY SEW		SHEET NO. 3 OF 5
BENT TREE VALLEY APARTMENTS		SCALE: 1" = 40'		DRAWN BY: S.C.S.
		SURVEYED BY: R.H.		CHECKED BY: B.L.S.
		SURVEYED: 7-6-80		JOB NO. 80024
				11-17-81