

STORM SEWER CURVE DATA
 (1) Δ = 23°49'22" R = 700.00' T = 144.38' L = 284.77'
 (2) Δ = 69°49'11" R = 325.00' T = 226.81' L = 396.04'
 (3) Δ = 53°45'28" R = 150.00' T = 75.98' L = 140.65'
 (4) Δ = 31°06'12" R = 70.00' T = 19.48' L = 38.00'

◎ BELLBROOK DR. CV DATA
 Δ = 23°18'33" R = 700.00' T = 144.38' L = 284.77'

SAWCUT, REMOVE & REPLACE EXIST. CONC. PVMT. & CURB - (See Detail Sheet 6)

BENCHMARK LIST
 BM #1 RAILROAD SPIKE IN THE NORTH SIDE OF A POWER POLE APPROXIMATELY 1300 FEET SOUTH OF BELTLINE ROAD AND 150 FEET WEST OF WINNWOOD ROAD. ELEV 560.69
 BM #2 RAILROAD SPIKE IN THE WEST SIDE OF A POWER POLE APPROXIMATELY 1300 FEET SOUTH OF BELTLINE ROAD AND 230 FEET WEST OF WINNWOOD ROAD. ELEV 569.89

NOTE:
 1. REFER TO SHEET 8 FOR GENERAL PAVING AND GRADING NOTES.
 2. REFER TO SHEET 3 FOR TYPICAL PAVEMENT SECTIONS.
 3. REFER TO SHEET 16 FOR EMBEDMENT DETAILS.
 4. REFER TO SHEET 15 FOR GENERAL STORM SEWER NOTES.

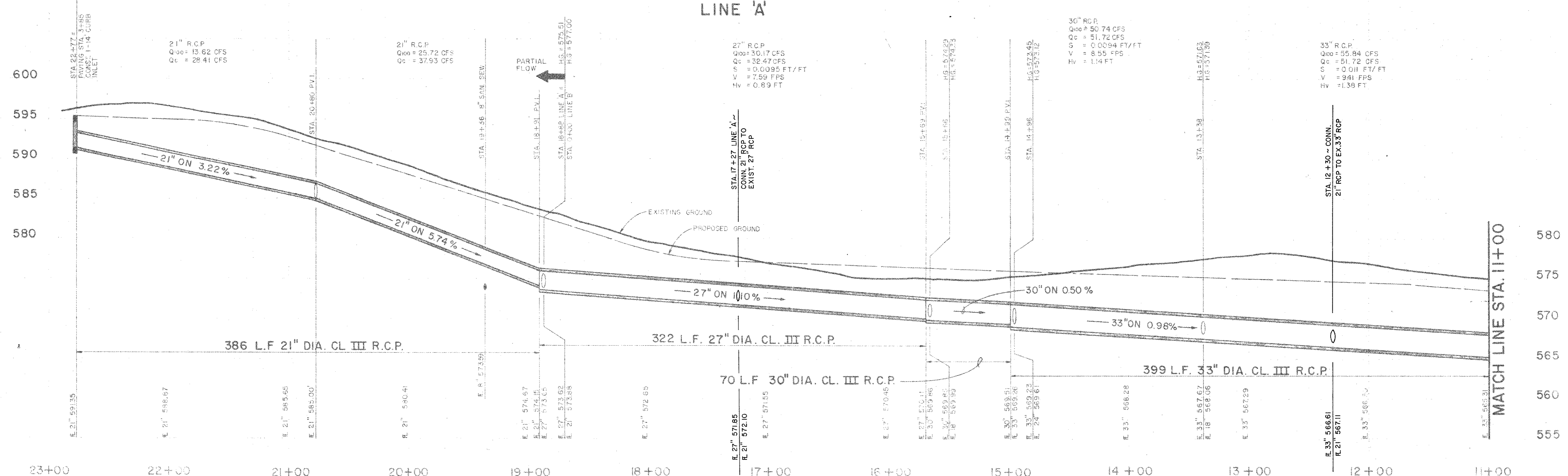
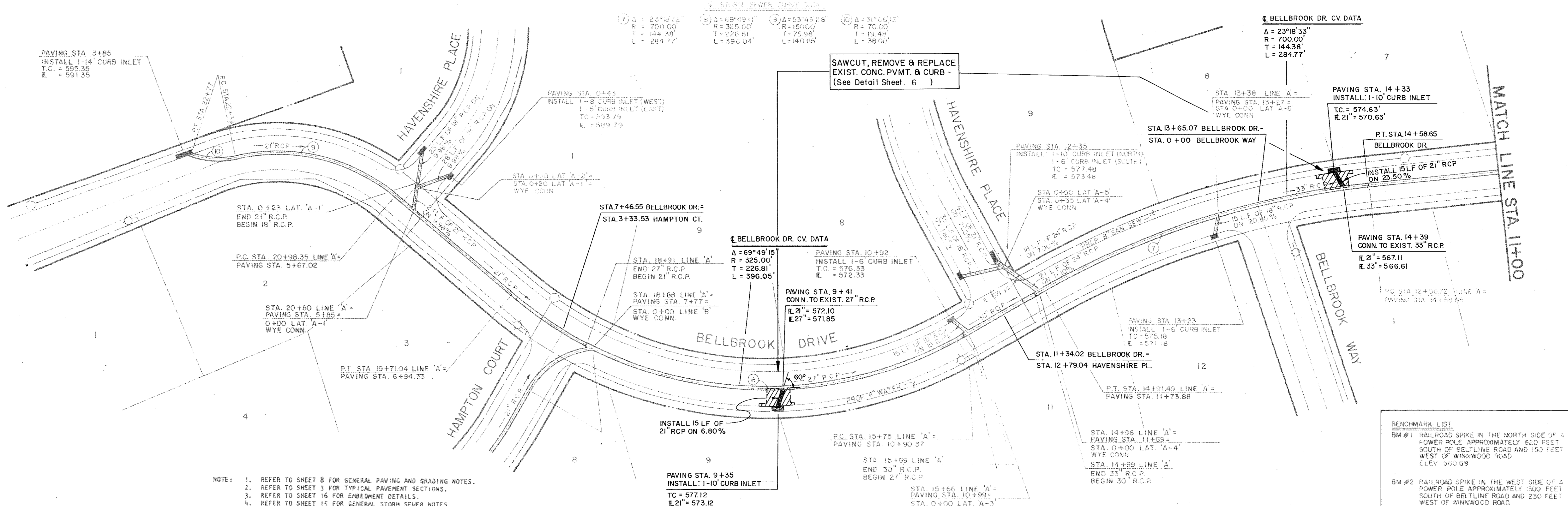

DESIGNED BY: E.H.&A.	 ESPEY, HUSTON & ASSOCIATES, INC. <i>Engineering & Environmental Consultants</i> 17811 Waterview Parkway Dallas, Texas 75252 (214) 669-9600	PLAN & PROFILE WINNWOOD/BELLBROOK DRAINAGE for THE TOWN OF ADDISON	SHEET NO. 5
DRAWN BY: E.H.&A.			OF 6 SHEETS
CHECKED BY: B. GRANTHAM			JOB NO. 12552
SCALE: 1"=6V/1"=40H			
DATE: MAY 1990			
NO	REVISION	BY	DATE