

!! WARNING !!
 LOCATION OF EXISTING UTILITIES SHOWN ARE APPROXIMATE! CONTRACTOR SHALL FIELD VERIFY LOCATIONS OF ALL EXISTING UTILITIES PRIOR TO CONSTRUCTION. CONTRACTOR SHALL CONTACT:
 LONE STAR GAS CO. 263-0166
 SOUTHWESTERN BELL 995-4102
 T.U. ELECTRIC 323-8910
 STORER CABLE 640-2388

NOTE:
 CONTRACTOR SHALL HYDROMULCH CUT/FILL SLOPES WITHIN EXCAVATION LIMITS.

NOTE:
 CONTRACTOR SHALL REPLACE EXISTING IRRIGATION AND LIGHTING FACILITIES IN MEDIAN IF DISTURBED WITH CONSTRUCTION. NO SEPARATE PAY ITEM.

NOTE:
 CONTRACTOR SHALL ONLY REMOVE PORTION OF HEDGE REQUIRED FOR STORM SEWER INSTALLATION, HEDGE TO BE REPLACED BY TOWN OF ADDISON. PROTECT AND MAINTAIN EXISTING TREES.

!! CAUTION !!
 GAS SERVICE IN AREA. CONTRACTOR TO NOTIFY LONE STAR GAS AT LEAST 48 HOURS PRIOR TO CONSTRUCTION.

!! CAUTION !!
 RELOCATION OF UNDERGROUND ELECTRIC CABLE REQUIRED BY TU ELECTRIC PRIOR TO INSTALLATION OF STORM DRAIN.

LIST OF BENCHMARKS

B.M. #6:
 RAILROAD SPIKE FOUND IN A POWER POLE ON THE SOUTH SIDE OF CELESTIAL ROAD, 100' EAST OF THE SOUTHWEST PROPERTY CORNER, FIRST POLE EAST OF BELLSBROOK DRIVE. ELEVATION = 563.83
 B.M. #10:
 RAILROAD SPIKE FOUND IN A POWER POLE 20' WEST OF THE SOUTHEAST LOT CORNER OF MAN'S LITTLE ACRE ADDITION, SAME CORNER BEING 57' SOUTH OF THE NORTHEAST CORNER OF LOT 9 OF BELLSBROOK ESTATES. ELEVATION = 567.28
 B.M. #11:
 BOX SET IN THE NORTH RM OF A SANITARY SEWER MANHOLE 5' SOUTH OF THE SOUTH CURB LINE OF BELLSBROOK WAY, NEAR THE NORTHEAST CORNER OF LOT 12 OF BELLSBROOK ESTATES. ELEVATION = 567.70

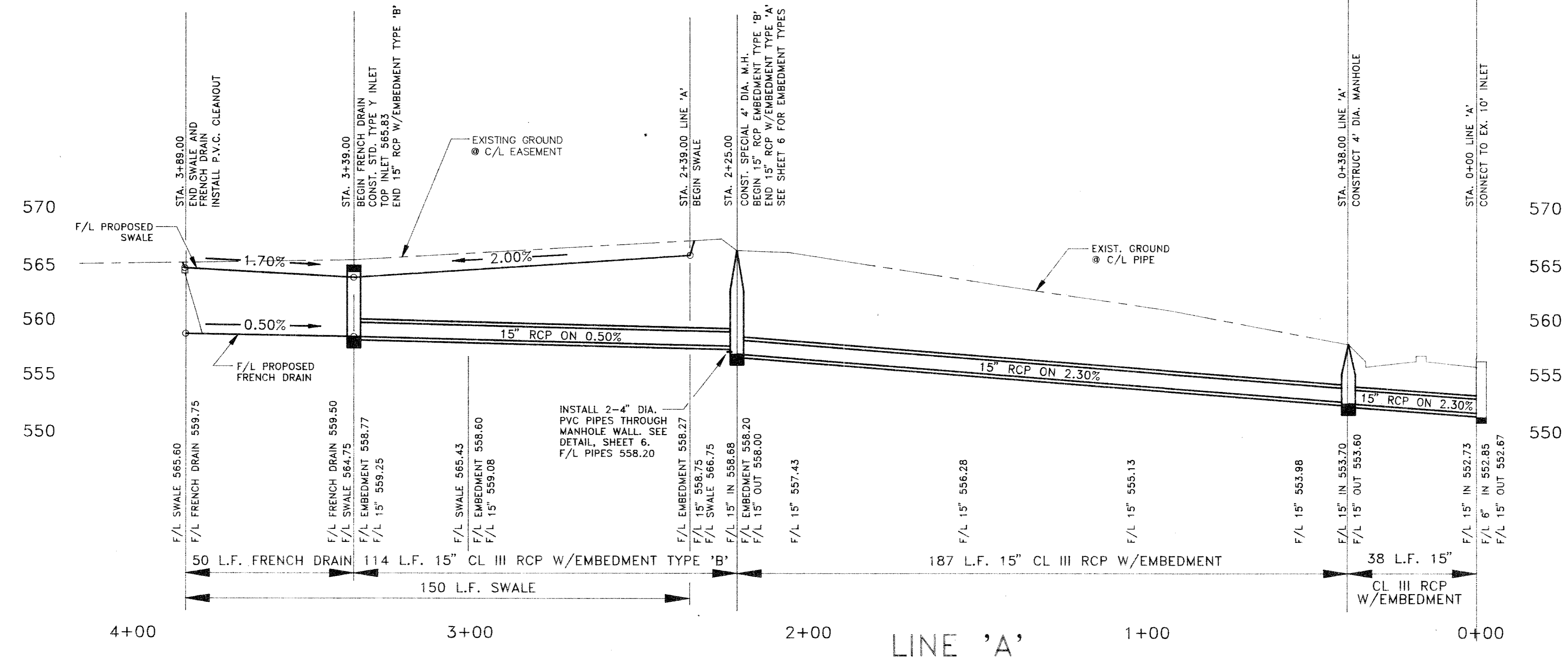

NO.	REVISION	BY	DATE

DESIGNED BY: J. WALLBAUER
 DRAWN BY: C. PARKER
 CHECKED BY: B. GRANTHAM
 SCALE: 1" = 6' V, 1" = 20' H
 DATE: J Y 1991



ESPEY, HUSTON & ASSOCIATES, INC.
 Engineering & Environmental Consultants
 (214) 669-9600

PHASE 2
DRAINAGE PLAN & PROFILE
 WINNWOOD/BELLSBROOK DRAINAGE
 PHASES 2 AND 3
 for
 THE TOWN OF ADDISON

SHEET NO. **3**
 OF **6** SHEETS
 JOB NO. **13404**