

1461 SURVEYOR BLVD.
= 0+23 LINE "A"
BUILD 4.0' DIA. MH

1- 12" TAPPING SLEEVE & VALVE
1- 12" x 6" TEE
1- 6" VALVE
1- F.H. (0+50)

0+00 LINDBERGH DR.
= 1+36 SURVEYOR BLVD.

REMOVE & SALVAGE FIRE
HYDRANT & VALVE.
PLUG TEE.

4+23
2- 10" INLET
603.40 T.C.
599.40 F.L.

5+77
10" INLET
604.04 T.C.
600.04 F.L.

7+00
10" INLET
604.38 T.C.
600.38 F.L.

9+40
10" INLET
606.70 T.C.
602.70 F.L.

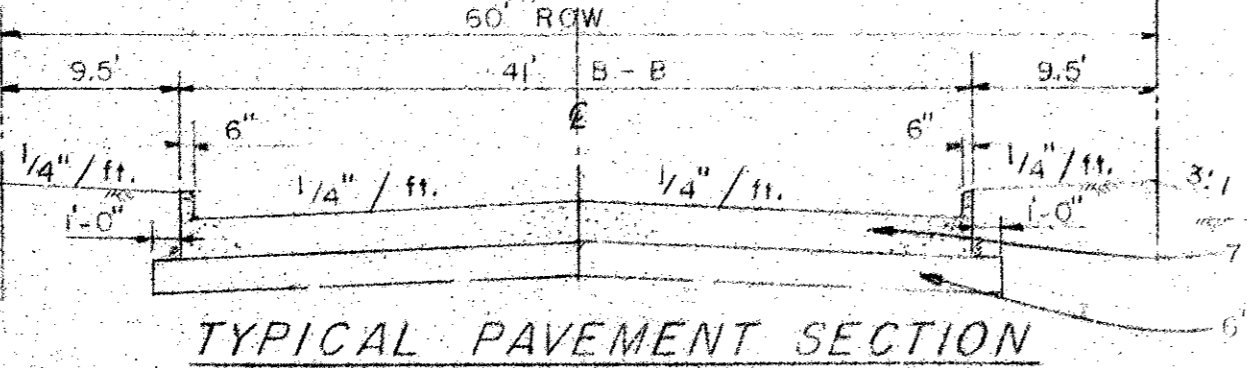

SEE SHT. 7
FOR CONTINUATION

4+92.12 LINE "A"
= 0+25 LINE "B"
BUILD 4.0' DIA. MH

NOTE:
ALL INLET LEADS
SHALL BE CLASS III
PIPE UNLESS OTHER-
WISE NOTED.

B.M.
60d Nail in Power Pole North of
St. L. Sw. Ry. & East of Surveyor Blvd.
Elev. 602.18

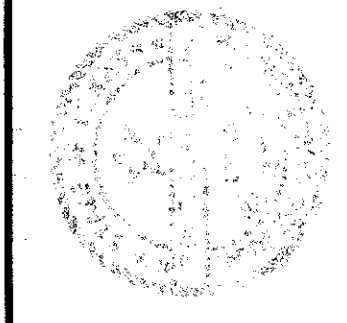
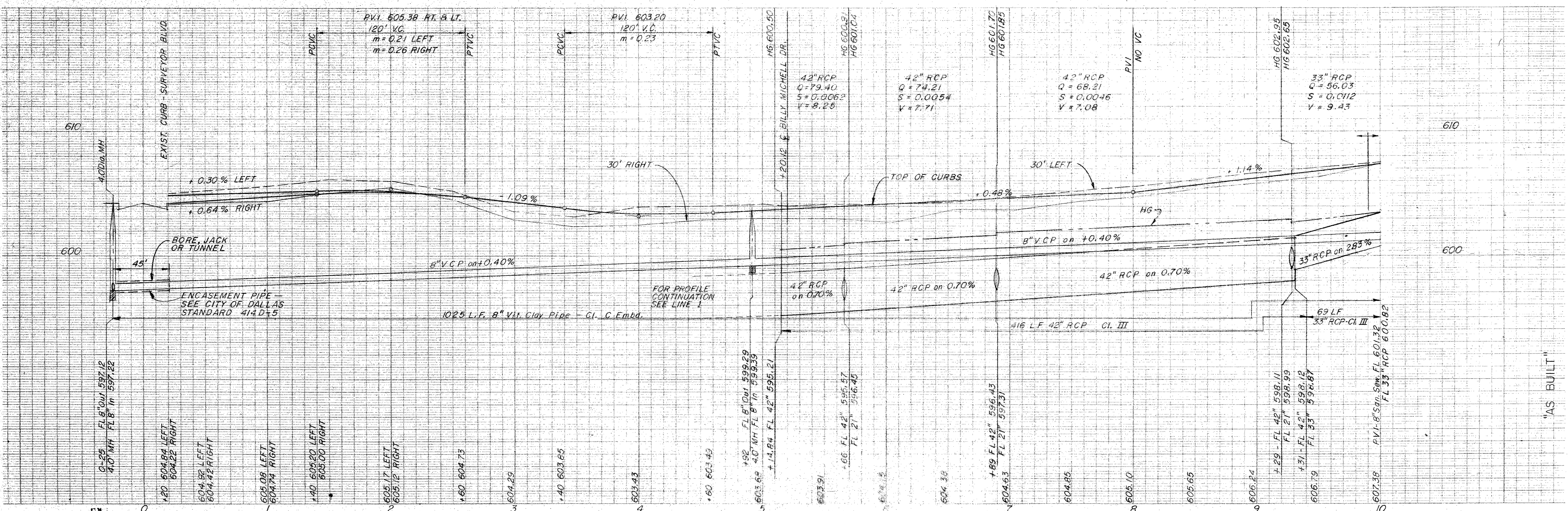
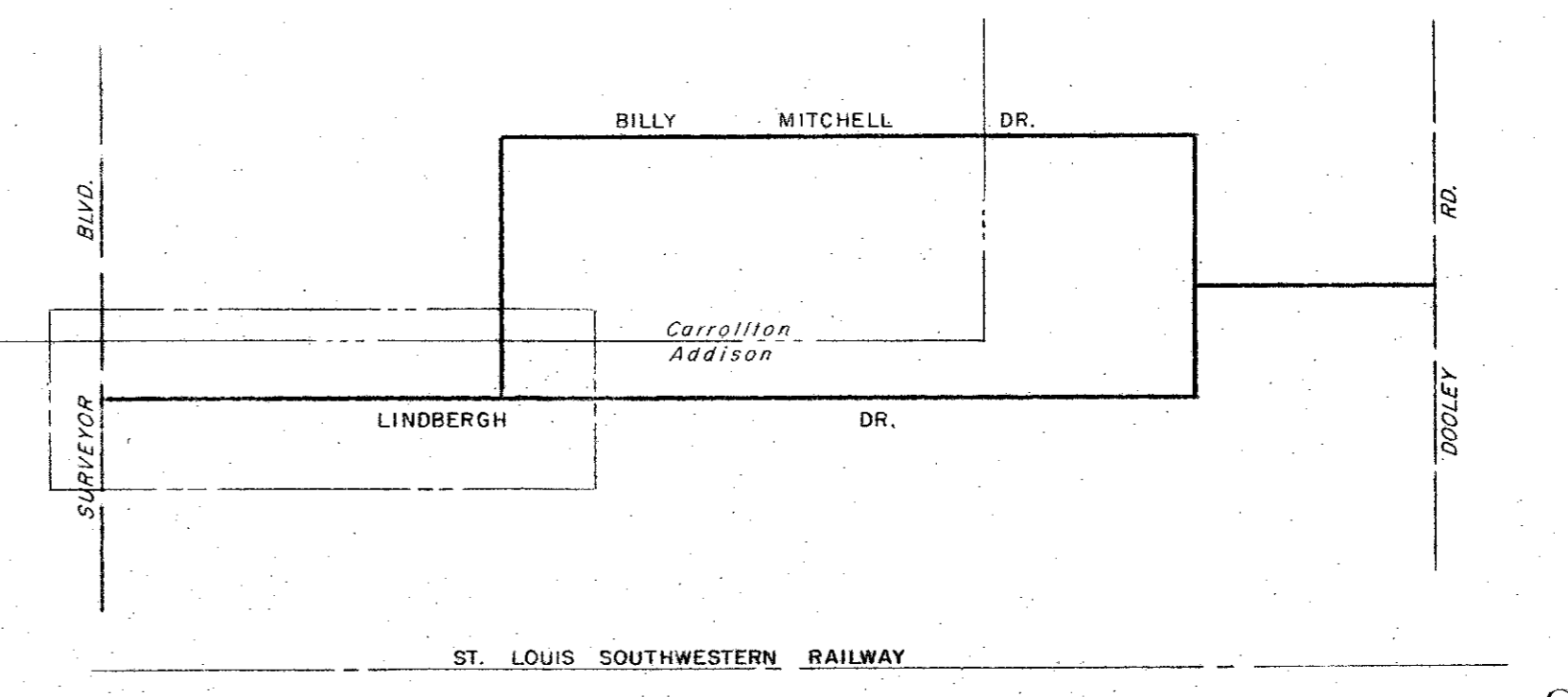

CORRELL & ASSOCIATES, INC.
consulting engineers
(817) 332-0822

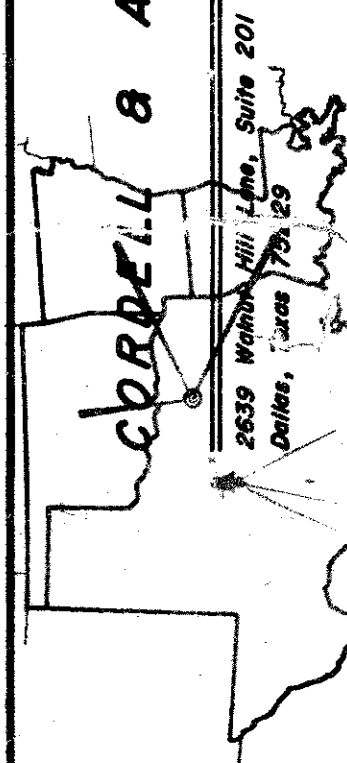

LINDBERGH DRIVE
PAVING AND UTILITIES
ADDISON WEST INDUSTRIAL PARK
DEPARTMENT OF PUBLIC WORKS
CITY OF ADDISON, TEXAS

DATE Sept. 1972

SHEET

DWG. NO. 70-3.2-5