

STORM SEWER
CURVE DATA
 $\Delta = 28^{\circ}40'$
 $R = 100.00'$
 $L = 50.03'$

B.M.
60d Nail in Power Pole North of St. L. Sw. Ry.
8 East of Surveyor Blvd.
Elev. 602.18

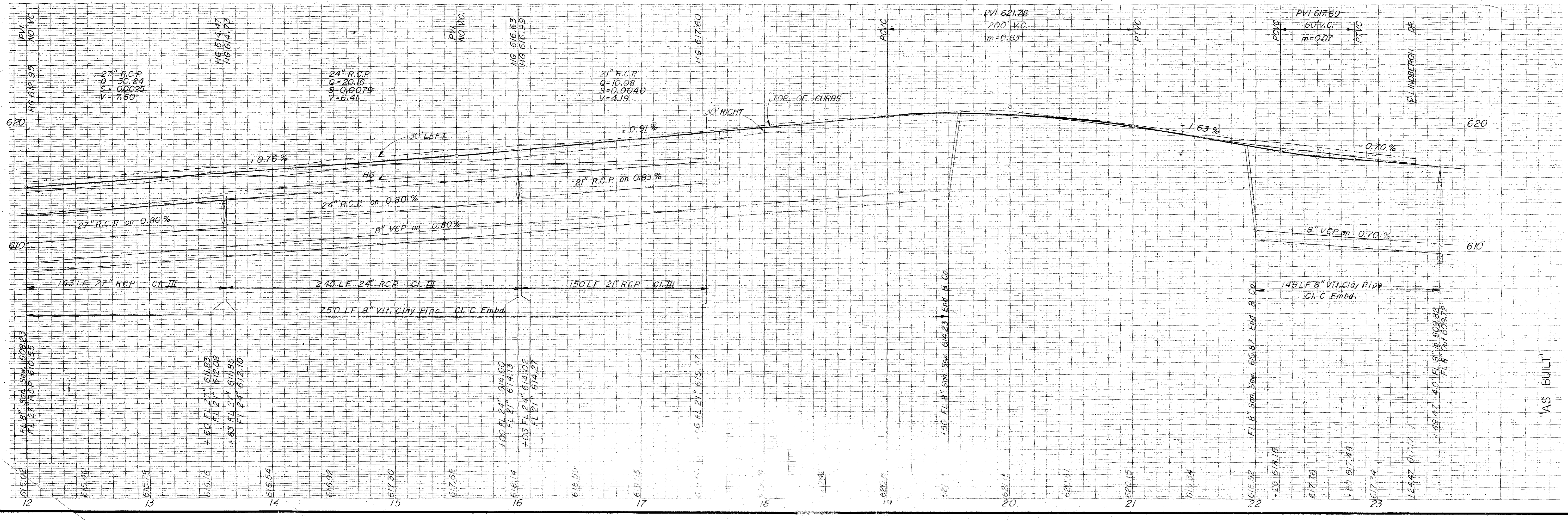

CORPELL & ASSOCIATES, INC.
consulting engineers

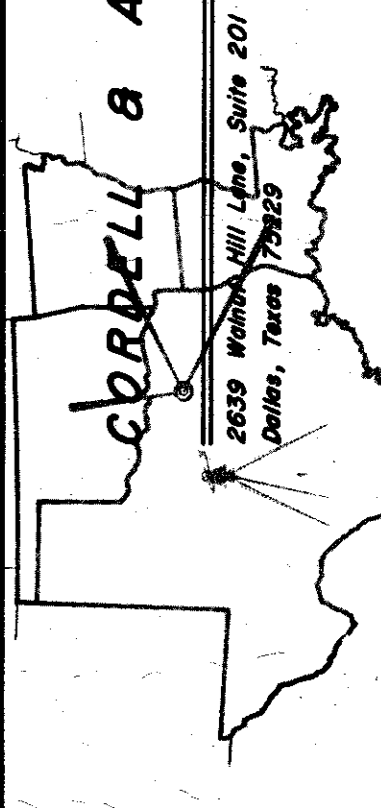

BILLY MITCHELL DRIVE
 PAVING AND UTILITIES
 ADDISON WEST INDUSTRIAL PARK
 DEPARTMENT OF PUBLIC WORKS
 City of Addison, Tarrant County, Texas

DATE Sept 1972

SHEET



DWG. NO. 70-32-9