

PLANS FOR THE CONSTRUCTION OF
STORM DRAIN RELOCATION
 BROOKHAVEN CLUB DRIVE

FOR
VITRUVIAN PARK - PHASE 1 - SOUTH
TOWN OF ADDISON, TEXAS
 PUBLIC WORKS # 2007-001

OWNER/DEVELOPER:

UDR
 THREE LINCOLN CENTRE
 5430 LBJ FREEWAY, SUITE 1250
 DALLAS, TEXAS 75240
 PH: (972) 763-3510
 FAX: (972) 866-0163
 CONTACT: MATT BRENDEL

CIVIL ENGINEER:

ICON CONSULTING ENGINEERS, INC.
 250 W. SOUTHLAKE BLVD., SUITE 117
 SOUTHLAKE, TEXAS 76092
 PH: (817) 552-6210
 FAX: (817) 552-3126
 CONTACT: BRUCE F. DUNNE, P.E.

SURVEYOR:

LANE'S SOUTHWEST SURVEYING, INC.
 2717 MOTLEY DRIVE, SUITE 'B'
 MESQUITE, TEXAS 95150
 PH: (972) 681-4442
 FAX: (972) 681-4829
 CONTACT: JIM LANE

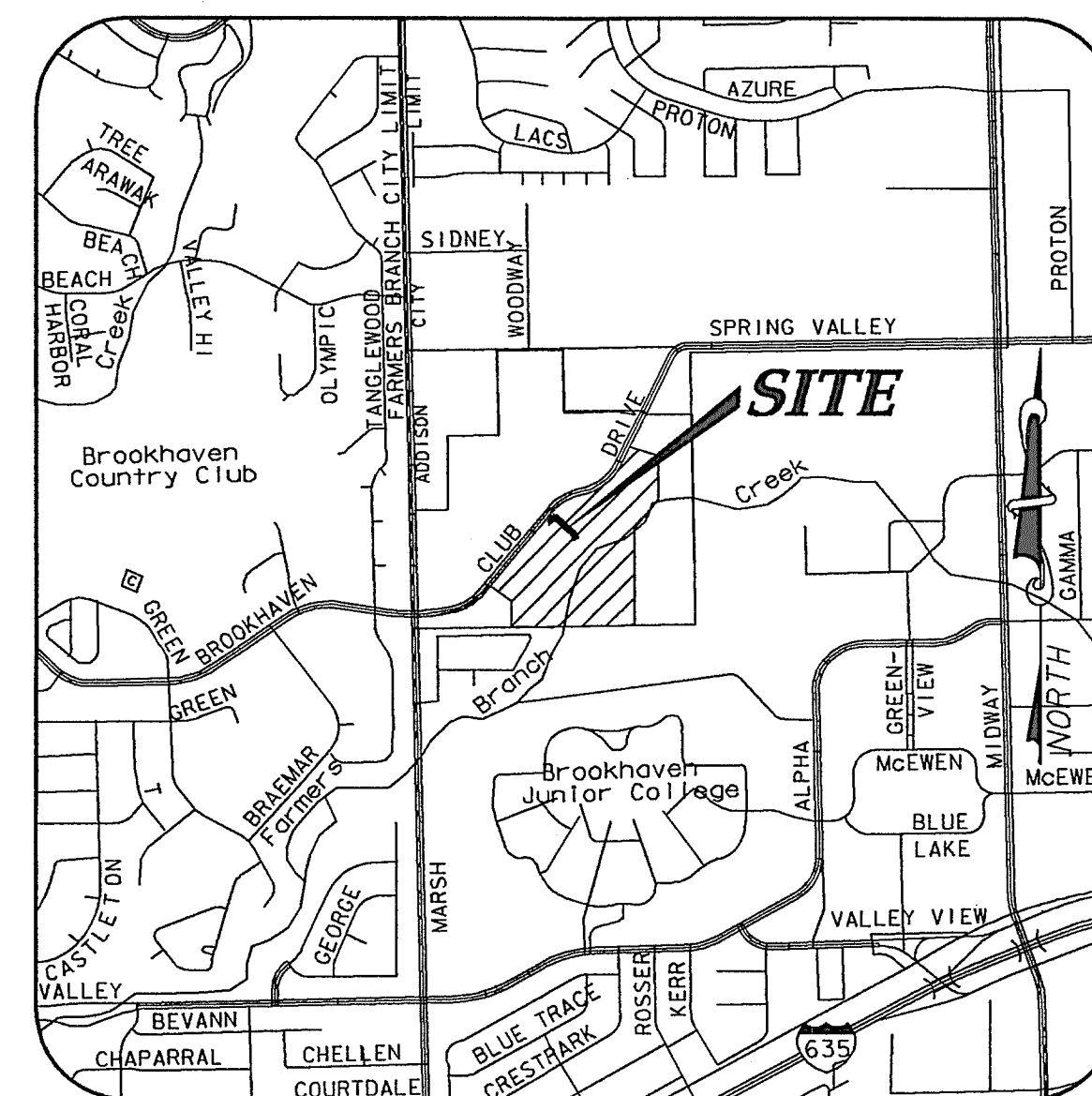

VICINITY MAP

NOT TO SCALE
 (MAPSCO GRID 13 & 14)

INDEX OF DRAWINGS

SHEET NO.	DESCRIPTION
1	COVER SHEET
2	GENERAL CONSTRUCTION NOTES, LEGENDS & ABBREVIATIONS
3	DRAINAGE AREA MAP & DRAINAGE CALCULATIONS
4	STORM DRAIN PLAN & PROFILE - LINE B1
5	STORM DRAIN DETAILS
6	GRADING AND EROSION & SEDIMENT CONTROL PLAN & DETAILS

APPROVED FOR
 CONSTRUCTION
 Town of Addison
 Public Works Department
 APPROVED BY: CURT BARNETT
 DATE: 5-20-08

All responsibility for the adequacy of these plans remains with the Engineer who prepared them. In approving these plans, the Town of Addison makes no representation of adequacy of the work of the Design Engineer.

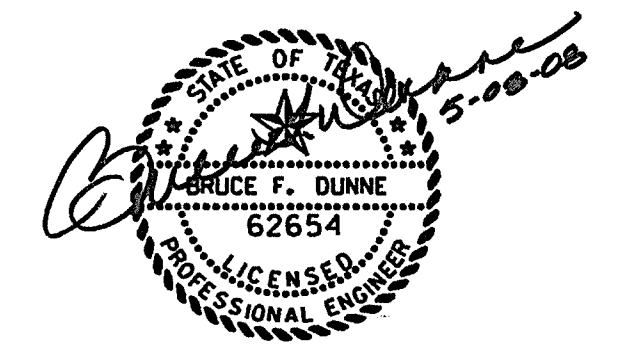

icon Consulting Engineers, Inc.
 Civil Engineers - Designers - Planners

MAY, 2008

PROJECT 5019-01

icon Consulting Engineers, Inc. Civil Engineers - Designers - Planners
 8/8/08
 2007-01
 5/8/08
 STORM DRAIN RELOCATION - BROOKHAVEN CLUB DRIVE