

**BROOKHAVEN CLUB DRIVE PARK**  
 Town of Addison  
 Parks Recreation & Landscape Development  
 P.O. Box 9010  
 Addison, Texas 75001

F&A JOB NUMBER:  
0228  
 DATE ISSUED:  
Apr. 22, 2003  
 REVISIONS:  
 \_\_\_\_\_  
 \_\_\_\_\_  
 \_\_\_\_\_  
 SHEET NUMBER:  
**IR-1**

CONNECT TO EXISTING 1/2" METER AND 1/2" DOUBLE CHECK ASSEMBLY.  
INSTALL: (1) 1/2" FLOW METER

CONTRACTOR SHALL TEST EXISTING DCA PRIOR TO INSTALLATION OF SYSTEM TO ENSURE DCA IS WORKING. IF DCA IS FOUND NOT TO BE WORKING PROPERLY, CONTRACTOR SHALL NOTIFY TOWN OF ADDISON REPRESENTATIVE IMMEDIATELY.

2" IRRIGATION MAIN LINE TO MEDIAN AREAS ALONG BROOKHAVEN CLUB DRIVE.  
(REFER TO IRRIGATION PLANS FOR BROOKHAVEN CLUB DRIVE PROVIDED BY OTHERS.)

32± L.F. 6" BORE  
INSTALL: (1) 4" SLEEVE FOR IRRIGATION IN MEDIAN AREAS

**BROOKHAVEN CLUB DRIVE**

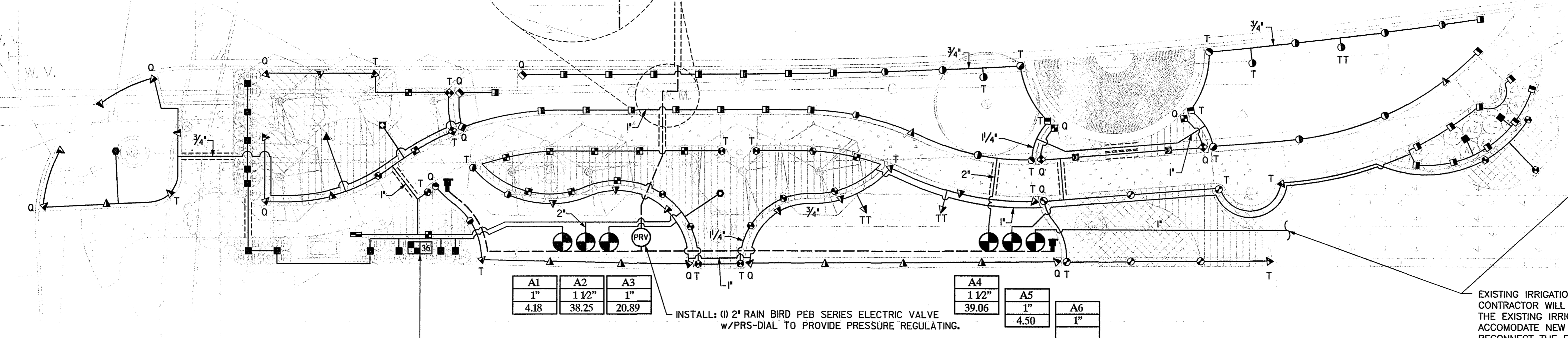

INSTALL: (1) RAIN MASTER EVOLUTION DX-2 SERIES PEDESTAL MOUNTED CONTROLLER.  
LOCATION OF CONTROLLER SHALL BE APPROVED BY OWNER PRIOR TO INSTALLATION.  
CONTRACTOR TO SET (1) 120V POWER/20 AMP/60 HZ PANEL FOR IRRIGATION SYSTEM.

EXISTING IRRIGATION IN THIS AREA TO REMAIN.  
CONTRACTOR WILL BE RESPONSIBLE FOR MODIFYING THE EXISTING IRRIGATION IN THIS AREA IN ORDER TO ACCOMMODATE NEW SITE LAYOUT. CONTRACTOR SHALL RECONNECT THE EXISTING IRRIGATION ZONE INTO NEW ZONE VALVE #A6.

**PIPING NOTES:**

- TORO 570Z MPR PLUS 15" R 4" POP UP SPRAY HEAD - PART CIRCLE @ 30 psi
  - ◐ TORO 570Z MPR PLUS 15" R 12" POP UP SPRAY HEAD - PART CIRCLE @ 30 psi  
F (360°) - 3.60 GPM, TO (270°) - 2.60 GPM, TT (240°) - 2.20 GPM, \* (180°) - 1.65 GPM, T (120°) - 1.10 GPM, Q (90°) .85 GPM
  - ▲ TORO 570Z MPR PLUS 12" R 4" POP UP SPRAY HEAD - PART CIRCLE @ 30 psi
  - ▲ TORO 570Z MPR PLUS 12" R 12" POP UP SPRAY HEAD - FULL CIRCLE @ 30 psi
  - ▲ TORO 570Z MPR PLUS 12" R 12" POP UP SPRAY HEAD - PART CIRCLE @ 30 psi  
F (360°) - 2.19 GPM, TO (270°) - 1.55 GPM, TT (240°) - 1.45 GPM, \* (180°) - 1.09 GPM, T (120°) - .72 GPM, Q (90°) .50 GPM
  - TORO 570Z MPR PLUS 10" R 4" POP UP SPRAY HEAD - FULL CIRCLE @ 30 psi
  - TORO 570Z MPR PLUS 10" R 4" POP UP SPRAY HEAD - PART CIRCLE @ 30 psi
  - TORO 570Z MPR PLUS 10" R 12" POP UP SPRAY HEAD - FULL CIRCLE @ 30 psi
  - TORO 570Z MPR PLUS 10" R 12" POP UP SPRAY HEAD - PART CIRCLE @ 30 psi  
F (360°) - 1.49 GPM, TO (270°) - 1.04 GPM, TT (240°) - .97 GPM, \* (180°) - .71 GPM, T (120°) - .52 GPM, Q (90°) .40 GPM
  - TORO 570Z MPR PLUS 8" R 4" POP UP SPRAY HEAD - FULL CIRCLE @ 30 psi
  - TORO 570Z MPR PLUS 8" R 4" POP UP SPRAY HEAD - PART CIRCLE @ 30 psi
  - TORO 570Z MPR PLUS 8" R 12" POP UP SPRAY HEAD - FULL CIRCLE @ 30 psi
  - TORO 570Z MPR PLUS 8" R 12" POP UP SPRAY HEAD - PART CIRCLE @ 30 psi  
F (360°) - 1.00 GPM, TO (270°) - .76 GPM, TT (240°) - .70 GPM, \* (180°) - .50 GPM, T (120°) - .30 GPM, Q (90°) .24 GPM
  - TORO 570Z MPR PLUS 4" POP UP SPECIAL PATTERN SPRAY HEAD @ 30 psi  
45-SST - 1.47 GPM
  - \* ALL SPRAY HEADS NOT OTHERWISE DESIGNATED SHALL BE 180° THROW.
  - ◻ FLOW METER
  - ⊕ MASTER VALVE w/PRESSURE REGULATOR
  - ⊕ WEATHERMATIC 11000 FCR SERIES ELECTRIC VALVE
  - 1/2" IRRIGATION WATER MAIN (NUMBER DENOTES PIPE SIZE) - 2" UNLESS OTHERWISE NOTED.
  - 1/4" IRRIGATION WATER LATERAL (NUMBER DENOTES PIPE SIZE)
  - SLEEVE (SLEEVE SHALL BE 2 SIZES LARGER THAN PIPE CARRIED)
- |      |              |
|------|--------------|
| A1   | VALVE NUMBER |
| 1/2" | VALVE SIZE   |
| 40   | GPM          |
- ⊕ RAINMASTER DX-2 SERIES PEDESTAL MOUNTED CONTROLLER w/NUMBER OF STATIONS REQUIRED
  - ⊕ WEST AG V075 QUICK COUPLER

**IRRIGATION NOTES:**

- Irrigation Plan Is Schematic. All Piping Heads, Valves, Etc. Shall Be Located As Shown On The Details. Report Any Discrepancies Between Actual And Proposed Site Conditions To The Representative For The Town Of Addison. Do Not Proceed With Work Until Said Discrepancies Are Resolved.
- Verify That The Work Of Other Contractors/Trades Is Sufficiently Complete To Allow Commencement Of Irrigation Installation Prior To Beginning Work. Contractors Shall Coordinate Installation Of All Irrigation Sleeves Under Pavement With Other Contractors.
- Coordinate Irrigation Installation With The Work Of Other Contractors/Trades And Protect The Work Of Other Contractor/Trades. Irrigation Contractor Is Responsible For All Damages Resulting From His Actions.
- The Irrigation Contractor Shall Provide The Owner With Two Copies Of The Parts List And Manufacturer's Catalog Showing Performance, Quality And Function Of Each Item Of Equipment In The System. In Addition, The Irrigation Contractor Shall Provide The Owner Written Instructions For Operation And Maintenance Of The System.
- Prior To The Acceptance Of Irrigation System By Owner, A Person Qualified To Represent The Irrigation Contractor Shall Be Present At The Final Inspection To Demonstrate The System And Prove Its Performance Prior To The Inspection. All Work Shall Have Been Completed, TESTED, ADJUSTED AND PLACED IN OPERATION.
- All Work And Equipment To Be Guaranteed For One Year From Date Of Acceptance By Town of Addison. A Copy Of The Guarantee Shall Be Included In The Operation/Maintenance Instructions.
- Irrigation System Installation To Be Performed In Accordance With All Pertinent Codes And Ordinances.
- No PVC Piping Shall Be Located Under Tree Rootballs.
- The Contractor Shall Verify Location Of All Underground Utilities Prior To Installation. If Any Underground Or Above Ground Construction Is Located As To Significantly Hinder Installation Or Function Of The Irrigation System, The Owner Shall Be Notified Immediately.
- Main Line Piping And Lateral Piping May Be Placed In Same Trench When Possible. Main Line Piping Shall Be Installed In Bottom Of Trench With Laterals On Top.
- Sleeves Shall Be Installed Wherever Pipes Run Under Pavement.
- The Contractor Is Responsible For Running Power To All Controllers.
- The Contractor Is Responsible In Coordinating With The Town of Addison The Installation Of The Southwestern Bell Phone Line Needed For Linking The New Irrigation System Into To The Existing Central Irrigation Control System.

**PIPING NOTES:**

1. MINIMUM PIPE SIZE FOR SPRAY SECTIONS SHALL BE 1/2".
2. MINIMUM PIPE SIZE FOR ROTOR SECTIONS SHALL BE 3/4".
3. THE MINIMUM AMOUNT OF PIPE LABELING IS INDICATED. THE PIPE SIZES ARE LABELED WHERE THEY INCREASE IN PIPE SIZE MOVING FROM DOWNSTREAM TO UPSTREAM ALONG THE SECTION. WHERE PIPE IS NOT LABELED DOWNSTREAM IT SHALL BE OF THE MINIMUM SIZE.

Irrigation Contractor Is Responsible For Obtaining A Copy Of The Town Of Addison's Irrigation Specifications, And Adhering To The Specifications During Installation Of The Irrigation System..

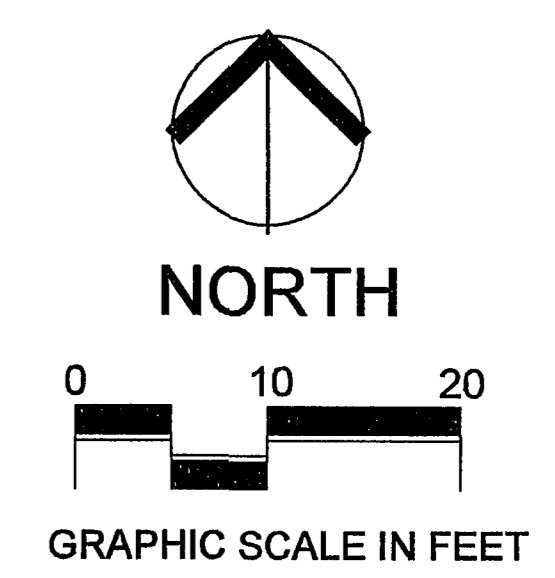

**IRRIGATION PLAN**