

07/23/02 RLL 99123-17-AC-ADWG SCALE: 1"=20' BLOCKS:

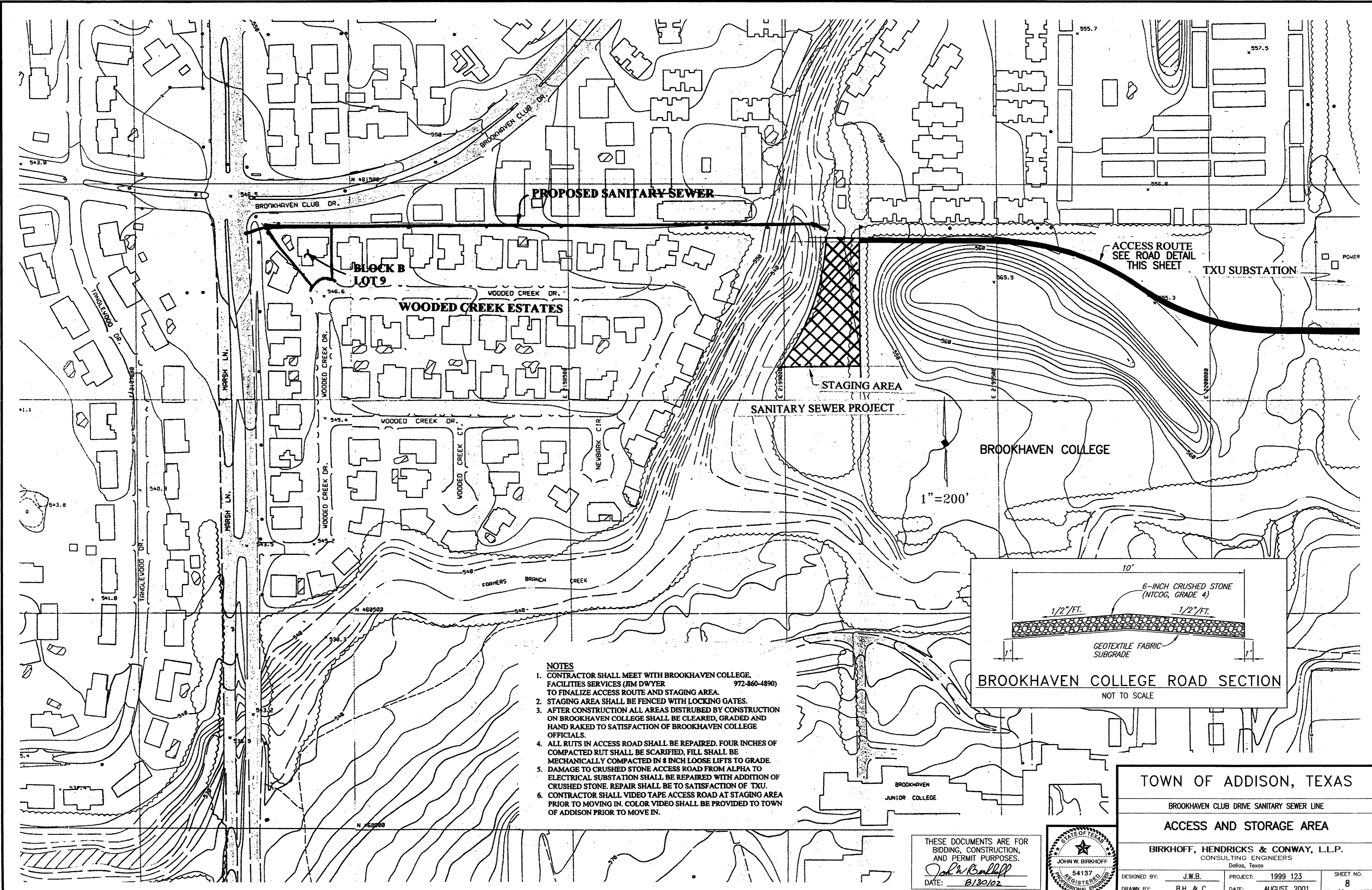

PROPOSED SANITARY SEWER

BLOCK B LOT 9

WOODED CREEK ESTATES

STAGING AREA

SANITARY SEWER PROJECT

BROOKHAVEN COLLEGE

1"=200'

ACCESS ROUTE SEE ROAD DETAIL THIS SHEET

TXU SUBSTATION

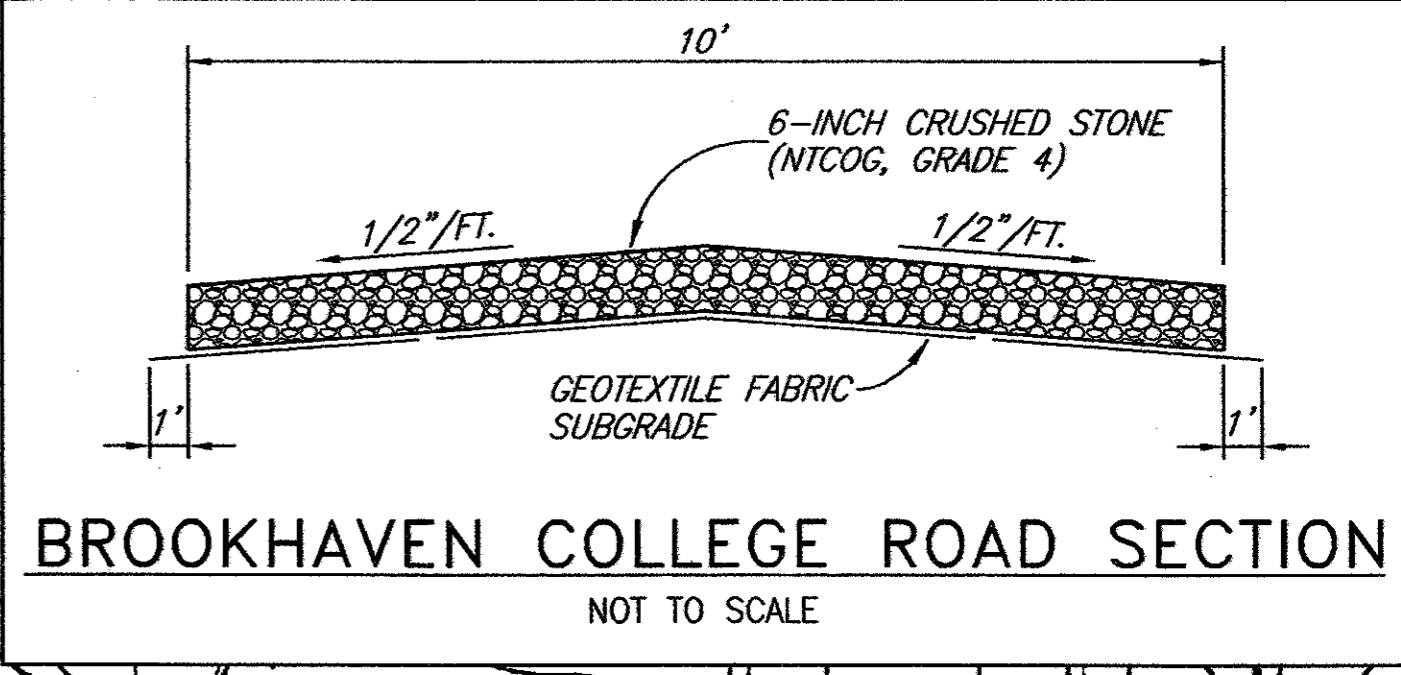

BROOKHAVEN COLLEGE ROAD SECTION NOT TO SCALE

NOTES

1. CONTRACTOR SHALL MEET WITH BROOKHAVEN COLLEGE, FACILITIES SERVICES (JIM DWYER 972-960-4890) TO FINALIZE ACCESS ROUTE AND STAGING AREA.
2. STAGING AREA SHALL BE FENCED WITH LOCKING GATES.
3. AFTER CONSTRUCTION ALL AREAS DISTURBED BY CONSTRUCTION ON BROOKHAVEN COLLEGE SHALL BE CLEARED, GRADED AND HAND RAKED TO SATISFACTION OF BROOKHAVEN COLLEGE OFFICIALS.
4. ALL RUTS IN ACCESS ROAD SHALL BE REPAIRED. FOUR INCHES OF COMPACTED RUT SHALL BE SCARIFIED, FILL SHALL BE MECHANICALLY COMPACTED IN 8 INCH LOOSE LIFTS TO GRADE.
5. DAMAGE TO CRUSHED STONE ACCESS ROAD FROM ALPHA TO ELECTRICAL SUBSTATION SHALL BE REPAIRED WITH ADDITION OF CRUSHED STONE. REPAIR SHALL BE TO SATISFACTION OF TXU.
6. CONTRACTOR SHALL VIDEO TAPE ACCESS ROAD AT STAGING AREA PRIOR TO MOVING IN. COLOR VIDEO SHALL BE PROVIDED TO TOWN OF ADDISON PRIOR TO MOVE IN.

THESE DOCUMENTS ARE FOR BIDDING, CONSTRUCTION, AND PERMIT PURPOSES. *John W. Birkhoff* DATE: 8/30/02

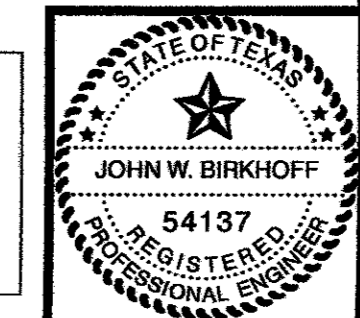

TOWN OF ADDISON, TEXAS

BROOKHAVEN CLUB DRIVE SANITARY SEWER LINE

ACCESS AND STORAGE AREA

BIRKHOFF, HENDRICKS & CONWAY, L.L.P.
CONSULTING ENGINEERS
Dallas, Texas

DESIGNED BY: J.W.B.	PROJECT: 1999 123	SHEET NO. 8
DRAWN BY: B.H. & C.	DATE: AUGUST, 2001	OF 11 SHEETS