

# PLANS FOR THE CONSTRUCTION OF PHASE TWO DEMOLITION IMPROVEMENTS

FOR

# BROOKHAVEN VILLAGE "BROOKS", "GREENBROOK" AND "THE ADDISON" TOWN OF ADDISON, TEXAS

PUBLIC WORKS # 2007-001

**OWNER/DEVELOPER:**

UDR  
THREE LINCOLN CENTRE  
5430 LBJ FREEWAY, SUITE 1250  
DALLAS, TEXAS 75240  
PH: (972) 763-3510  
FAX: (972) 866-0163  
CONTACT: MATT BRENDEL

**CIVIL ENGINEER:**

ICON CONSULTING ENGINEERS, INC.  
250 W. SOUTHLAKE BLVD., SUITE 117  
SOUTHLAKE, TEXAS 76092  
PH: (817) 552-6210  
FAX: (817) 552-3126  
CONTACT: BRUCE F. DUNNE, P.E.

**SURVEYOR:**

LANE'S SOUTHWEST SURVEYING, INC.  
2717 MOTLEY DRIVE, SUITE 'B'  
MESQUITE, TEXAS 95150  
PH: (972) 681-4442  
FAX: (972) 681-4829  
CONTACT: JIM LANE

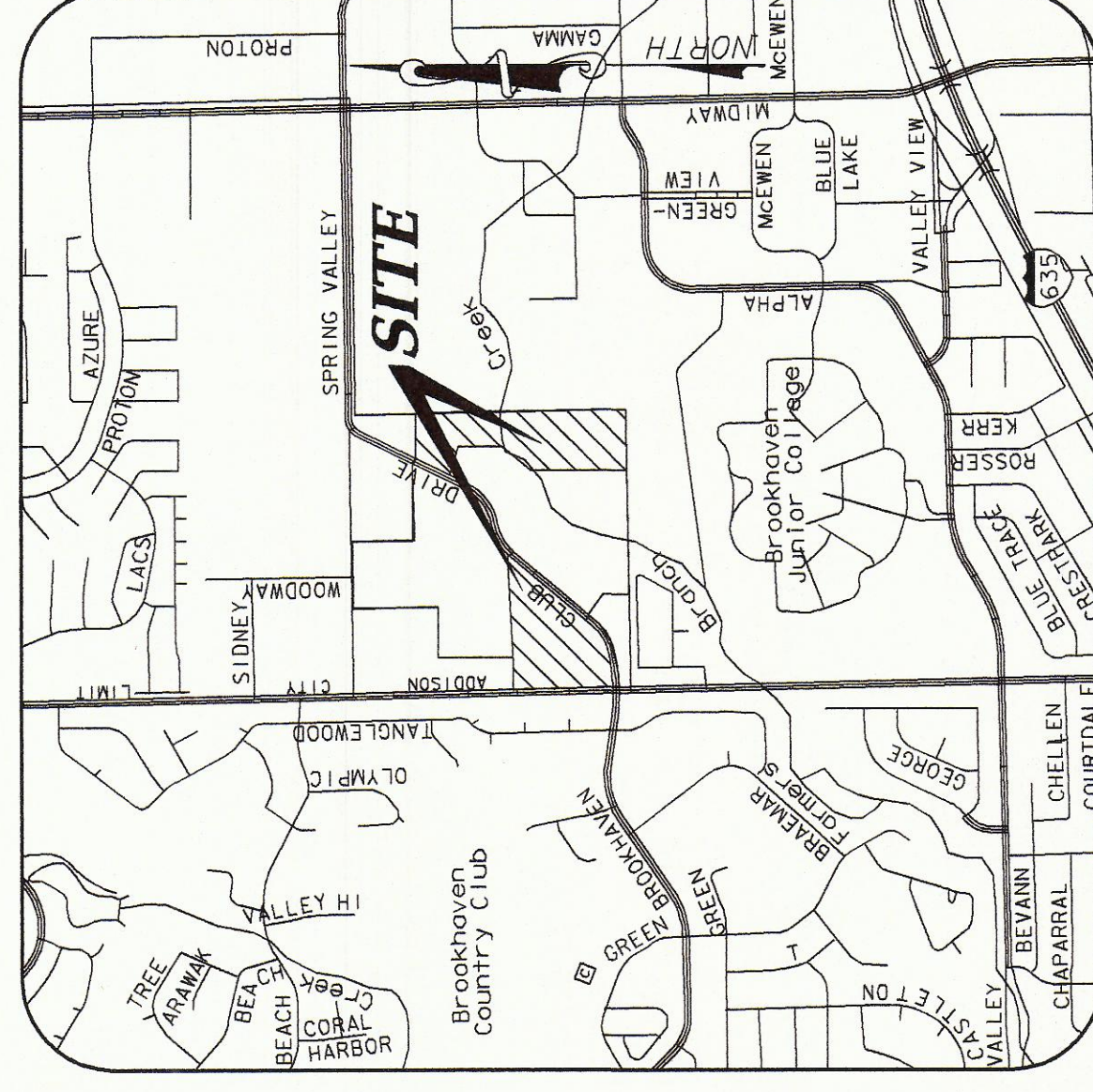

**VICINITY MAP**

NOT TO SCALE  
(MAPSCO GRID 13 & 14)

APPROVED FOR  
CONSTRUCTION  
Town of Addison  
Public Works Department  
APPROVED BY: **CLAY BARRETT**  
DATE: **5-20-08**

All responsibility for the adequacy of these plans remains with the Engineer who prepared them. In approving these plans, the Town of Addison makes no representation of adequacy of the work of the Design Engineer.

**icon** Consulting Engineers, Inc.  
Civil Engineers - Designers - Planners

MAY 2008

**INDEX OF DRAWINGS**

SHEET NO.	DESCRIPTION
C0.1	BOUNDARY EXHIBIT
C1.1	GENERAL CONSTRUCTION NOTES, LEGENDS & ABBREVIATIONS
C2.0	OVERALL DEMOLITION PLAN
C2.1	DEMOLITION PLAN - "BROOKS" & "GREENBROOK" (WEST)
C2.2	DEMOLITION PLAN - "GREENBROOK" (EAST)
C2.3	DEMOLITION PLAN - "THE ADDISON" (NORTH)
C2.4	DEMOLITION PLAN - "THE ADDISON" (SOUTH)
C3.1	EROSION & SEDIMENT CONTROL PLAN - "BROOKS" & "GREENBROOK"
C3.2	EROSION & SEDIMENT CONTROL PLAN - "THE ADDISON" (NORTH)
C3.3	EROSION & SEDIMENT CONTROL PLAN - "THE ADDISON" (SOUTH)
C3.4	EROSION & SEDIMENT CONTROL DETAILS

**NOTES:**

1. DEVELOPER TO CONTACT TOWN OF ADDISON FINANCE DEPARTMENT AT 972-450-7080 TO DISCONNECT WATER SERVICES PRIOR TO DEMOLITION OF ANY BUILDINGS ON EACH SERVICE.
2. METHODS OF DEMOLITION, REMOVAL OF PAVEMENT, STAGING OF DEBRIS, ETC. SHALL BE CONDUCTED SUCH THAT FIRE DEPARTMENT ACCESS WILL BE AVAILABLE AT ALL TIMES TO ANY REMAINING BUILDINGS. PARTIALLY DEMOLISHED STRUCTURES OR ACCUMULATIONS OF DEBRIS ON THE SITE.
3. FIRE HYDRANTS SERVING THE SITE SHALL REMAIN OPERATIONAL AS LONG AS POSSIBLE AND NO HYDRANT SHALL BE RENDERED INOPERABLE WITHOUT THE PERMISSION OF THE FIRE DEPARTMENT.
4. ANY TEMPORARY ACCESS ROADS SERVING THE SITE SHALL BE OF SUFFICIENT DESIGN AND CONSTRUCTION TO ACCOMMODATE A FIRE FIGHTING VEHICLE.

