

NO.	REVISION	BY	DATE

**icon**  
 Consulting Engineers, Inc.  
 BioCentral Financial Center  
 250 W. Southlake Blvd., Suite 117  
 Southlake, TX 75092  
 Phone: (817) 552-6210  
 Fax: (817) 552-3126

**EROSION & SEDIMENT CONTROL PLAN - "BROOKS" & "GREENBROOK" TOWN OF ADDISON, TX**

**PHASE TWO DEMOLITION PLANS BROOKHAVEN VILLAGE**



Date: 5/19/08  
 Scale: AS SHOWN  
 Drawn By: SAM  
 Reviewed By: JAM  
 Project: 5019-01d  
**SHEET C3.1**

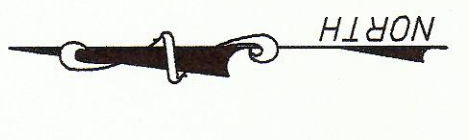

0 25 50 75 100  
 GRAPHIC SCALE IN FEET  
 SCALE: 1"=50'

**WARNING**

CONTRACTOR IS TO CONTACT TEXAS ONE-CALL SYSTEM (1-800-245-4945) OR OTHER UTILITY SYSTEMS PRIOR TO ANY CONSTRUCTION TO LOCATE ALL UTILITIES. ICON CONSULTING ENGINEERS, INC. IS NOT RESPONSIBLE FOR KNOWING OR UNKNOWN UTILITIES OR LOCATIONS OF UTILITIES ON THESE DRAWINGS.

**PROJECT BENCHMARKS**

**BM #1 REF. ELEVATION = 559.47**  
 SQUARE CUT IN TOP OF CURB, SOUTH MEDIAN END NOSE, MARSH LANE  
 1127 NORTH OF BROOKHAVEN CLUB DRIVE.

**BM #2 REF. ELEVATION = 547.84**  
 SQUARE CUT IN TOP OF CURB, NORTH MEDIAN END NOSE, AT INTERSECTION OF BROOKHAVEN CLUB DRIVE AND MARSH LANE.

**LEGEND**

- SILT FENCE
- EXISTING SILT FENCE
- INLET PROTECTION
- STABILIZED CONSTRUCTION ENTRANCE
- VEGETATED BUFFER

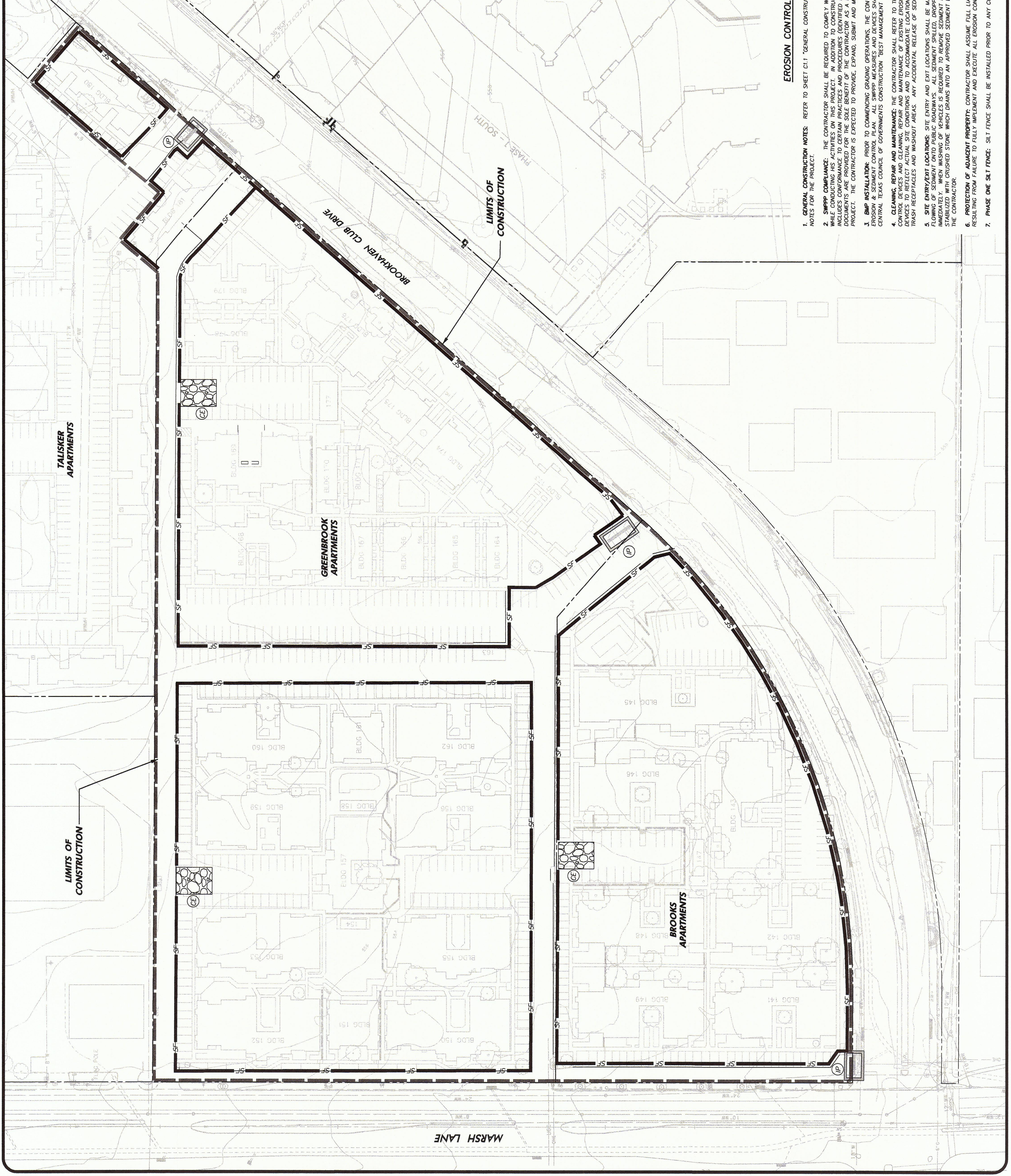

**EROSION CONTROL NOTES:**

1. GENERAL CONSTRUCTION NOTES: REFER TO SHEET C1.1 "GENERAL CONSTRUCTION NOTES, LEGEND AND ABBREVIATIONS" FOR THE GENERAL CONSTRUCTION NOTES FOR THE PROJECT.
2. SWPPP COMPLIANCE: THE CONTRACTOR SHALL BE REQUIRED TO COMPLY WITH THE STORM WATER POLLUTION PREVENTION PLAN (SWPPP) WHILE CONDUCTING HIS ACTIVITIES ON THIS PROJECT. IN ADDITION TO CONSTRUCTING THOSE ITEMS INDICATED ON THE PLAN SHEETS, COMPLIANCE WITH THE SWPPP SHALL BE THE CONTRACTOR'S RESPONSIBILITY. THE SWPPP SHALL BE REVIEWED AND APPROVED BY THE TOWN OF ADDISON PRIOR TO THE START OF CONSTRUCTION. THE SWPPP SHALL BE MAINTAINED ON THE PROJECT AND SHALL BE AVAILABLE TO THE TOWN OF ADDISON AT ALL TIMES. THE CONTRACTOR IS EXPECTED TO PROVIDE, EXPAND, SUBMIT AND MONITOR A FULL COMPREHENSIVE SWPPP BEYOND WHAT IS HEREIN PROVIDED.
3. BMP INSTALLATION: PRIOR TO COMMENCING GRADING OPERATIONS, THE CONTRACTOR SHALL INSTALL ALL SWPPP MEASURES AND DEVICES AS INDICATED ON THE PLAN SHEETS. SWPPP MEASURES AND DEVICES SHALL BE IN ACCORDANCE WITH SPECIFICATIONS AND DETAILS SHOWN IN THE NORTH CENTRAL TEXAS COUNCIL OF GOVERNMENTS CONSTRUCTION BEST MANAGEMENT PRACTICES (BMP) MANUAL, OR AS MODIFIED BY THE CONTRACT DOCUMENTS.
4. CLEANING, REPAIR AND MAINTENANCE: THE CONTRACTOR SHALL REFER TO THE SWPPP FOR SEQUENCING OF CONSTRUCTION, INSTALLATION OF NEW EROSION CONTROL DEVICES AND CLEANING, REPAIR AND MAINTENANCE OF EXISTING EROSION CONTROL DEVICES. THE CONTRACTOR SHALL RELOCATE AND/OR ADD SWPPP MEASURES AND DEVICES AS NECESSARY TO MAINTAIN PROTECTION OF ADJACENT AREAS, INCLUDING RECEIVING AREAS, TRASH RECEPTACLES AND WASHOUT AREAS. ANY ACCIDENTAL RELEASE OF SEDIMENT OR POLLUTANTS FROM THE SITE SHALL BE CLEANED BY THE CONTRACTOR.
5. SITE ENTRY/EXIT LOCATIONS: SITE ENTRY AND EXIT LOCATIONS SHALL BE MAINTAINED BY THE CONTRACTOR IN A CONDITION THAT WILL PREVENT TRACKING OR FLOODING OF SEDIMENT ONTO PUBLIC ROADWAYS. ALL SEDIMENT SPILLED, DROPPED, WASHED OR TRACKED ONTO PUBLIC ROADWAYS MUST BE REMOVED IMMEDIATELY. PUBLIC ROADWAYS SHALL BE STABILIZED WITH CRUSHED STONE WHICH DRAINS INTO AN APPROVED SEDIMENT BASIN. ALL FINES IMPOSED FOR TRACKING ONTO PUBLIC ROADS SHALL BE PAID BY THE CONTRACTOR.
6. PROTECTION OF ADJACENT PROPERTY: CONTRACTOR SHALL ASSUME FULL LIABILITY FOR DAMAGE TO ADJACENT PROPERTIES AND/OR PUBLIC RIGHT-OF-WAY RESULTING FROM FAILURE TO FULLY IMPLEMENT AND EXECUTE ALL EROSION CONTROL METHODS AND PROCEDURES SHOWN AND NOTED IN THE PLANS AND SWPPP.
7. PHASE ONE SILT FENCE: SILT FENCE SHALL BE INSTALLED PRIOR TO ANY CONSTRUCTION ACTIVITIES ON THE SITE.