

Addison!

CONSTRUCTION PLANS FOR BROOKHAVEN CLUB DRIVE SANITARY SEWER LINE

CITY COUNCIL

R. SCOTT WHEELER, MAYOR
 DIANE MALLORY, MAYOR PRO TEM
 JOE CROW GLYNDA TURNER
 BOB BARRETT FREDRIC SILVER
 CATHY WAYS

CITY MANAGER

RON WHITEHEAD

CITY ENGINEER/ DIRECTOR OF PUBLIC WORKS

MICHAEL MURPHY, P.E.

CITY SECRETARY

CARMEN MORAN

BIRKHOFF, HENDRICKS & CONWAY, L.L.P.
 CONSULTING ENGINEERS
 Dallas, Texas

AUGUST, 2002

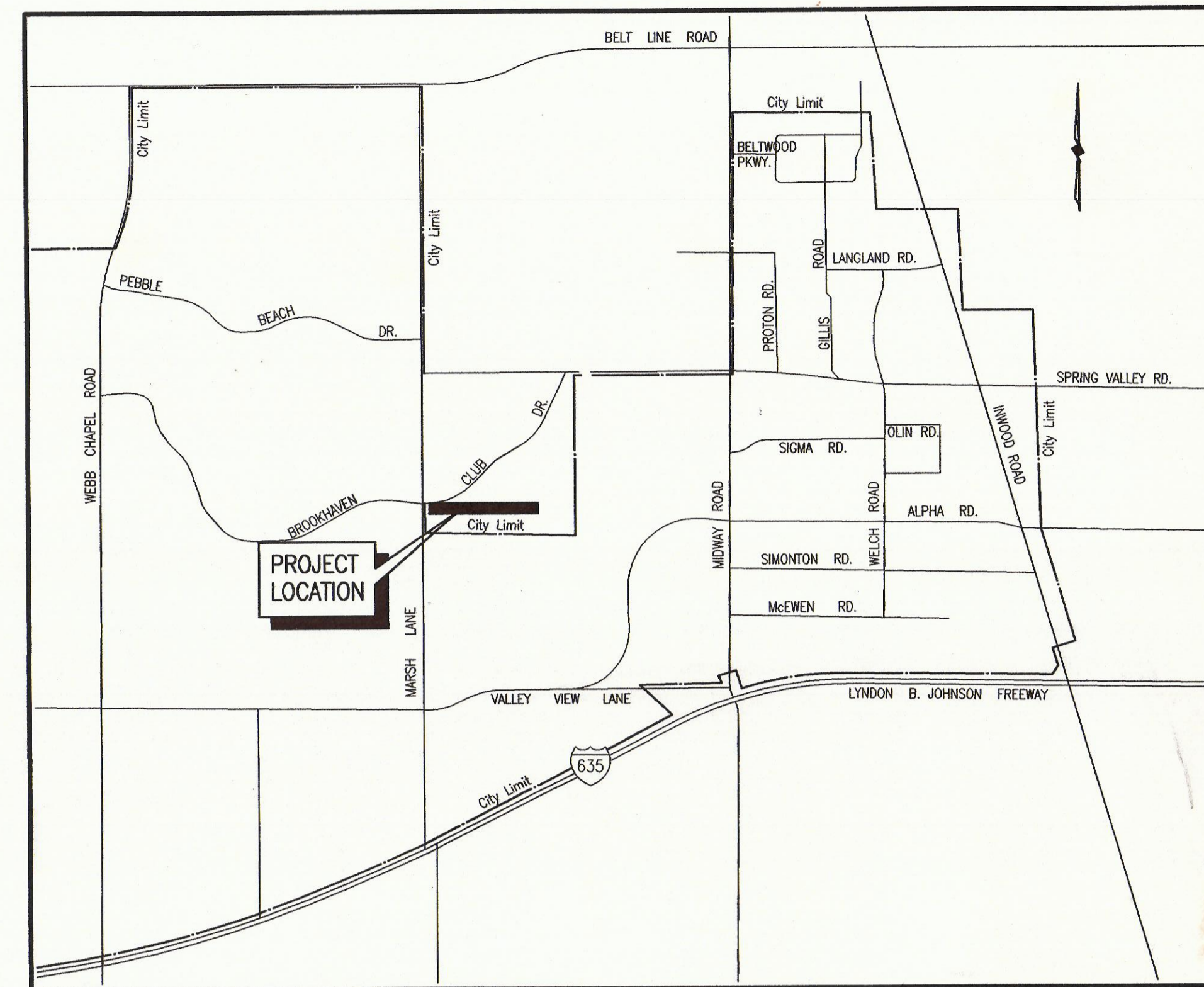

LOCATION MAP

SHEET INDEX

<u>SHEET DESCRIPTION</u>	<u>SHEET NO.</u>
BROOKHAVEN CLUB DRIVE SANITARY SEWER LINE STA. 0+00 TO 5+00	1
BROOKHAVEN CLUB DRIVE SANITARY SEWER LINE STA. 5+00 TO 10+00	2
BROOKHAVEN CLUB DRIVE SANITARY SEWER LINE STA. 10+00 TO 13+79.76	3
BROOKHAVEN CLUB DRIVE SAN. SEW. 'SS1' REPLACEMENT STA. -(0+23.77) TO 1+65	4
BROOKHAVEN CLUB DR. EXIST. SANITARY SEWER LINER STA. 0+00 TO 5+00	5
BROOKHAVEN CLUB DR. EXIST. SANITARY SEWER LINER STA. 5+00 TO 10+00	6
BROOKHAVEN CLUB DR. EXIST. SANITARY SEWER LINER STA. 10+00 TO 12+10.43	7
ACCESS AND STORAGE AREA	8
ACCESS AND STORAGE AREA	9
DETAILS	10
GENERAL NOTES	11



THESE DOCUMENTS ARE FOR
 BIDDING, CONSTRUCTION,
 AND PERMIT PURPOSES.
John W. Birkhoff
 DATE: 8/30/02

B19-9
 BROOKHAVEN SEWER

pdf

B19-9

B19-9

BROOKHAVEN SEWER

REVISED 08/29/02 R.L. SCALE: 1"=1' 98123-00.DWG