

NOTES:
 1. M.S. DENOTES TYPICAL REINFORCEMENT THRU MIDDLE STRIP.
 2. C.S. DENOTES TYPICAL REINFORCEMENT THRU COLUMN STRIP.

★ **ROOF PLAN**
 N.T.S.

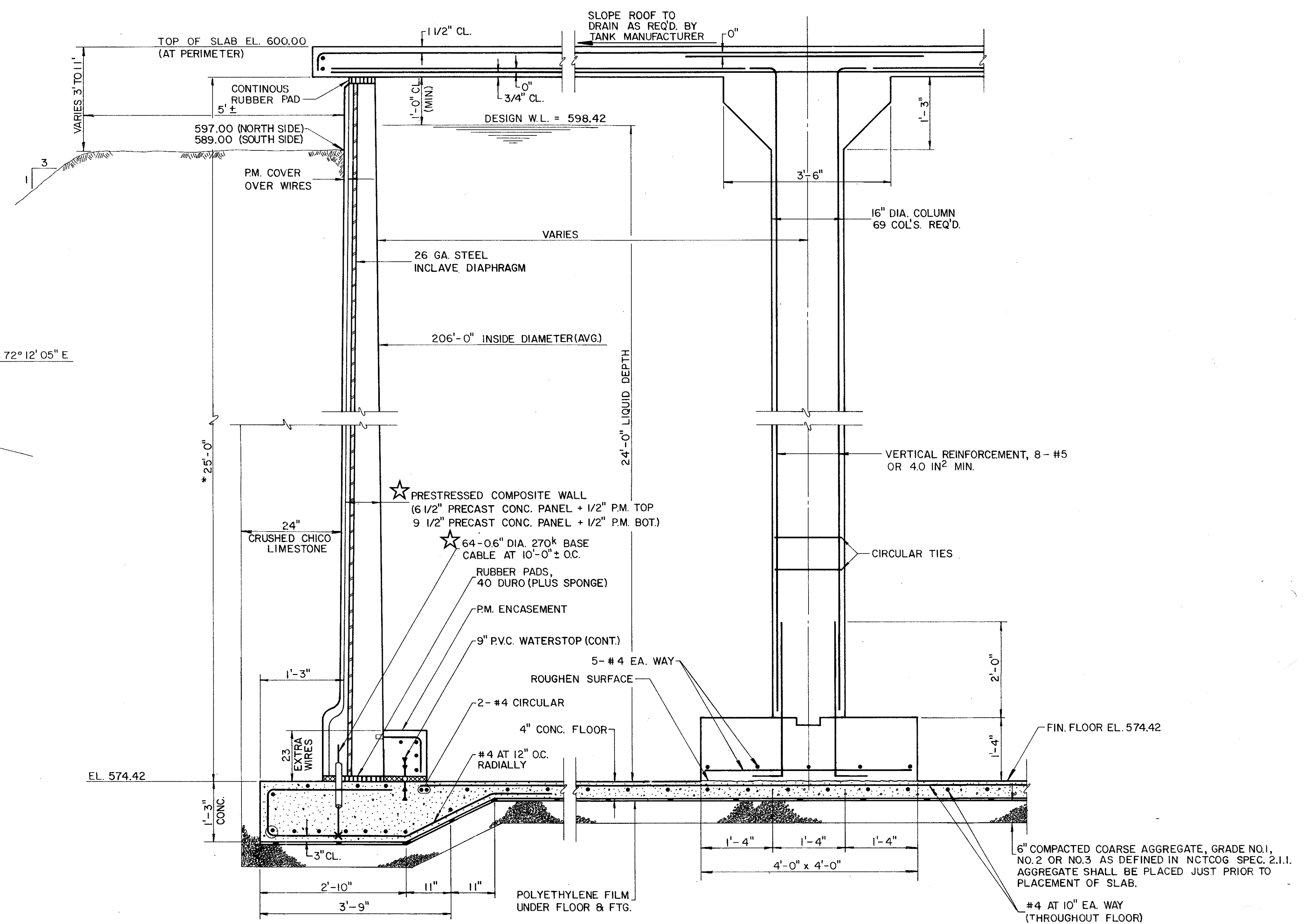

★ **SECTION THRU COLUMN STRIP**
 N.T.S.

NOTE: MAXIMUM SOIL PRESSURE = 10,000 P.S.F.

* HORIZONTAL PRESTRESSING WIRES AT 150,000 P.S.I. INITIAL AND 120,000 P.S.I. DESIGN STRESS WITH 61 WIRES/FT. AT BOTTOM TO 14 WIRES/FT. AT 6'-0" FROM TOP OF WALL AND 14 WIRES/FT. TO TOP OF WALL.
 WIRE DIAMETER BEFORE PRESTRESSING = 0.192"
 DIE DIAMETER = 0.164"

- NOTES:**
- P.M. = PNEUMATIC MORTAR
 - MINIMUM 28 DAY CONCRETE CYLINDER STRENGTHS:
 FLOOR, FOOTING & COLUMN FOOTING 3000 P.S.I.
 ROOF SLAB 4000 P.S.I.
 COLUMN CONCRETE 4000 P.S.I.
 WALL CONCRETE 4500 P.S.I.
 PNEUMATIC MORTAR 4500 P.S.I.
 - ROOF LIVE LOAD = 100 P.S.F.
 - REINFORCING STEEL SHALL CONFORM TO ASTM A-615 GR-60.

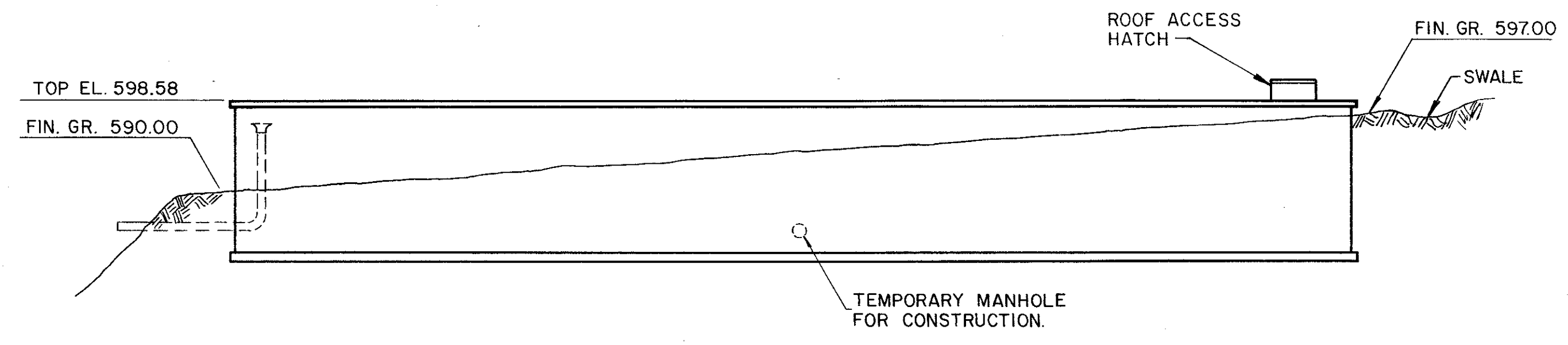

ELEVATION (LOOKING WEST)
 N.T.S.

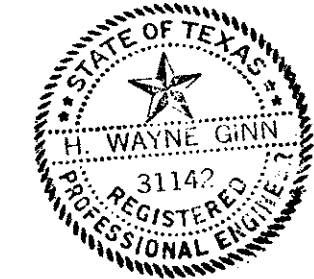

No.	Revision	By	Date
TOWN OF ADDISON DALLAS COUNTY, TEXAS			
6 MG CELESTIAL ROAD STORAGE TANK			
PLAN AND SECTIONS			
GINN, INC. Consulting Engineers Dallas, Texas			
Designed - RCH	Drawn - ALA	Date - FEB., 1986	Job No. - 215
Approved - HWG	Checked - GF	Scale - AS SHOWN	Sheet 2 of 8