

ST. LOUIS & SOUTHWESTERN RAILWAY

BROADWAY STREET

Moses & Cline

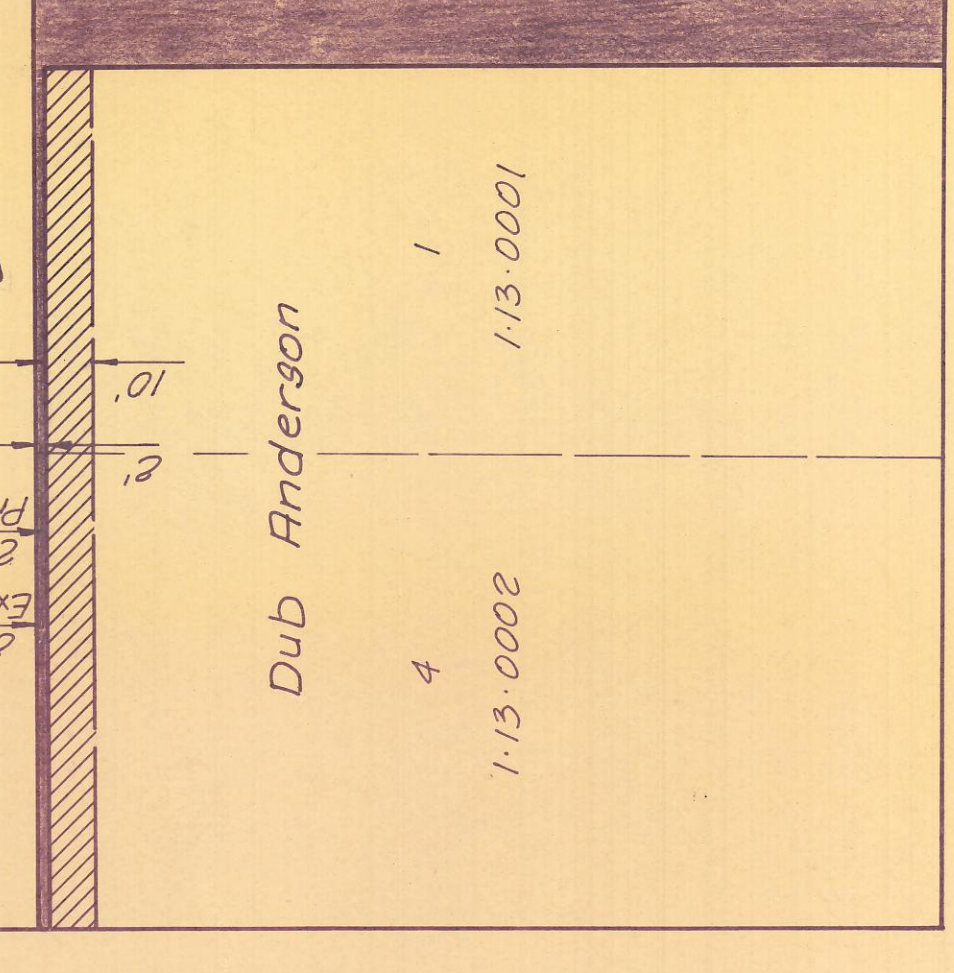
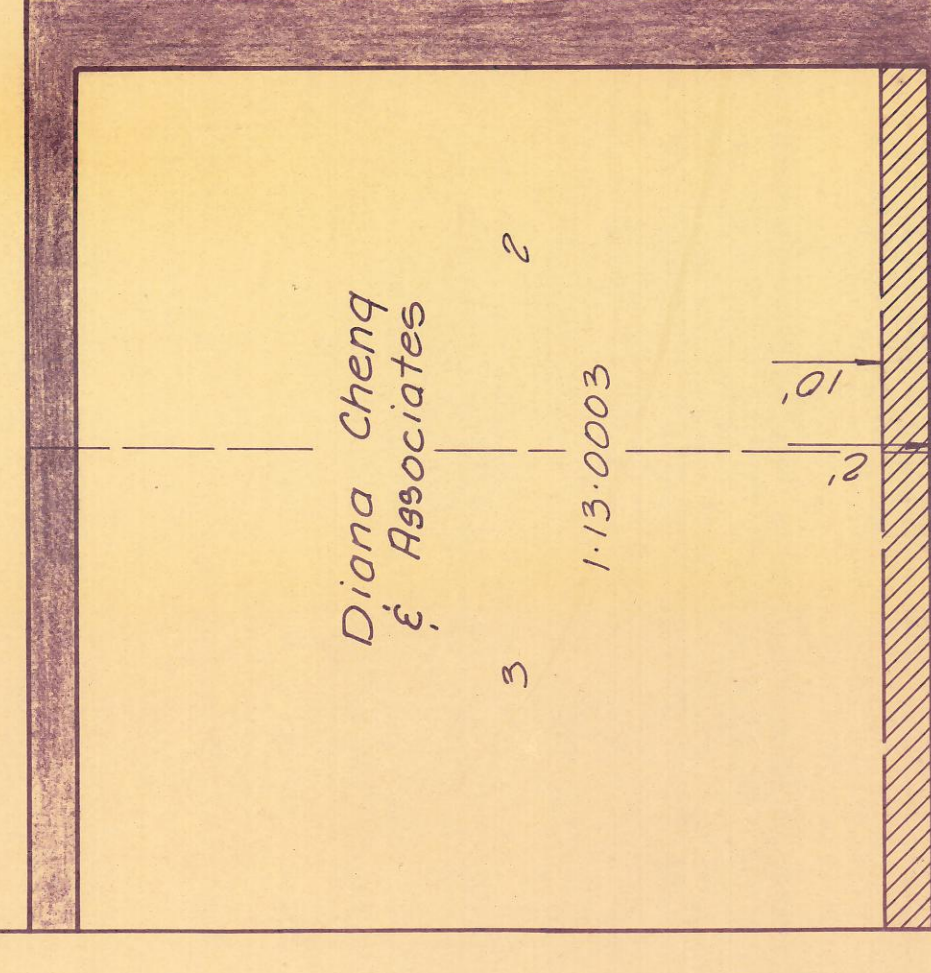
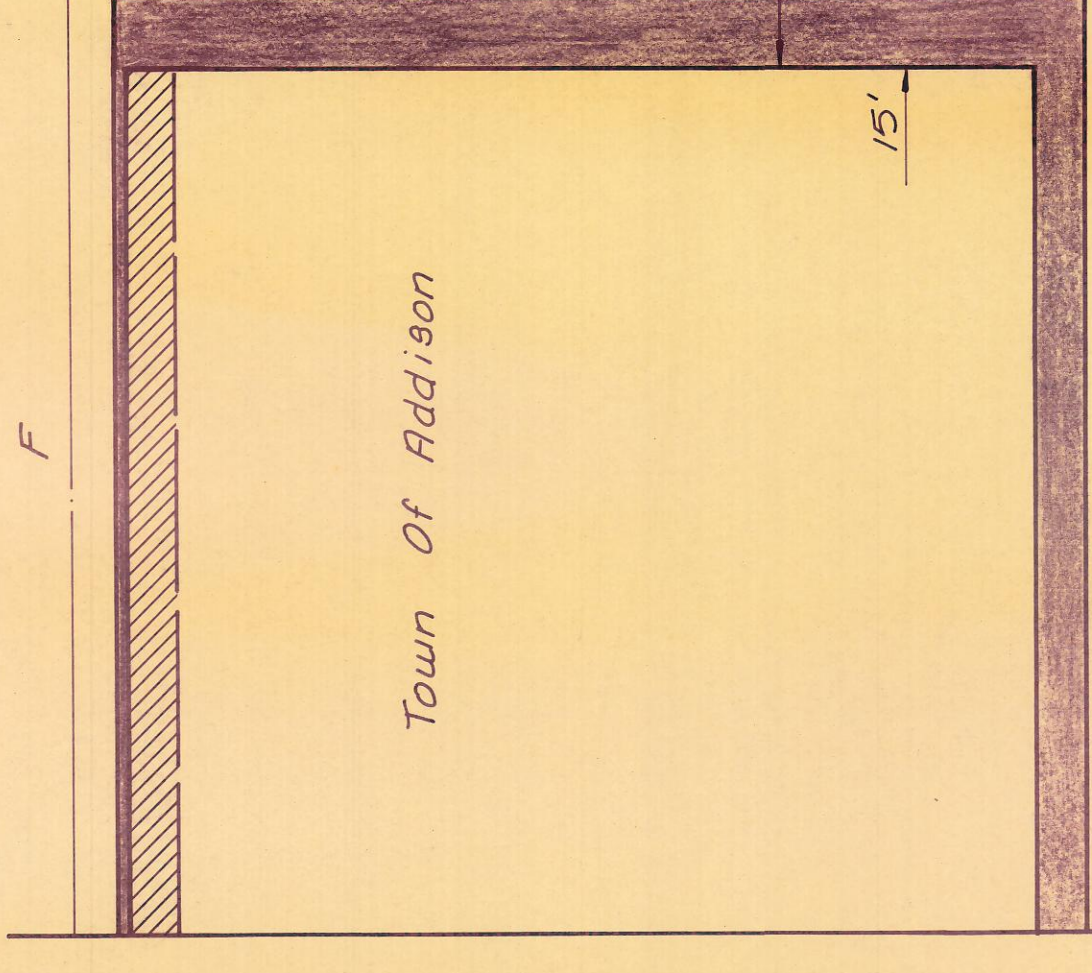
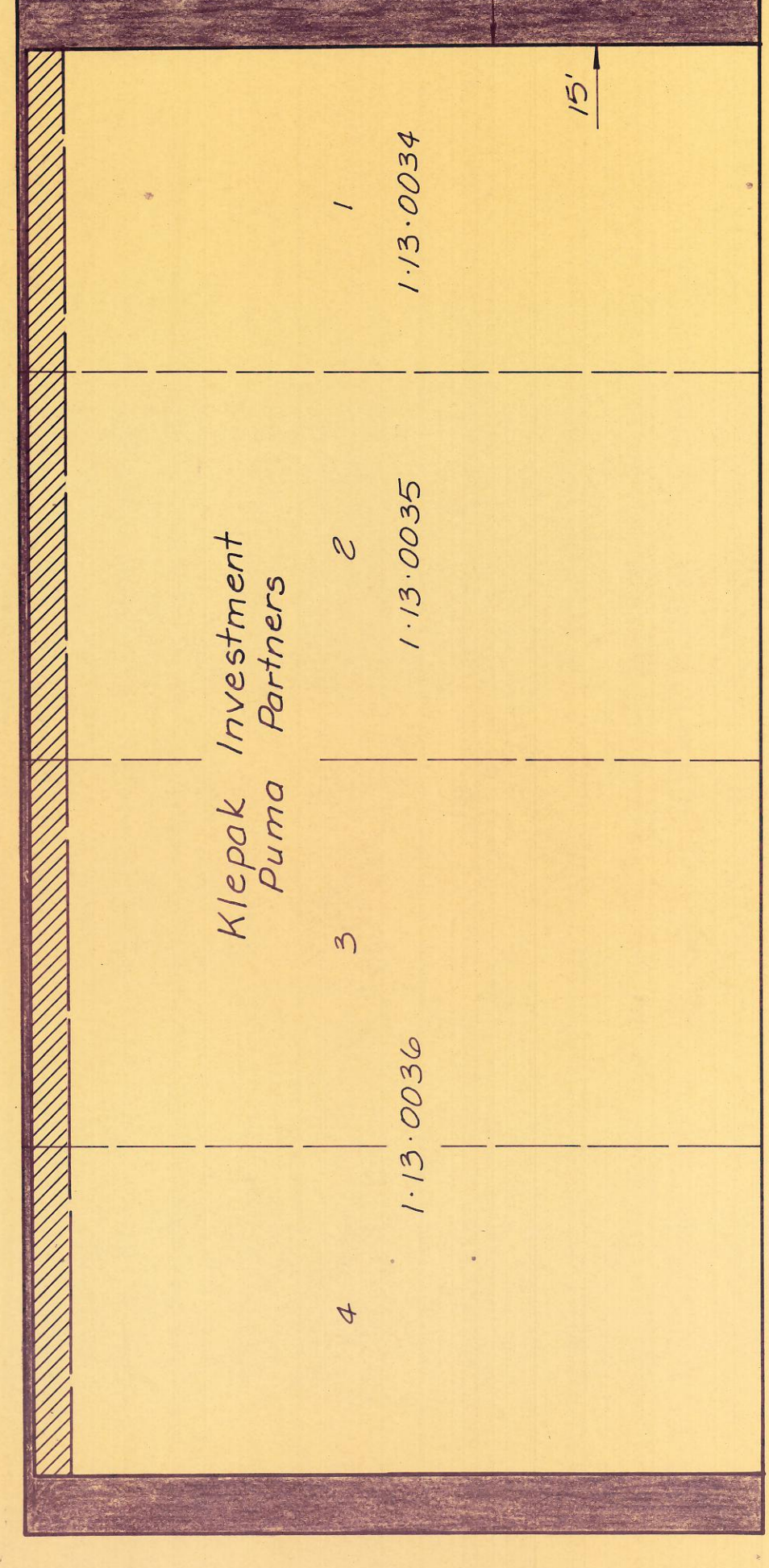
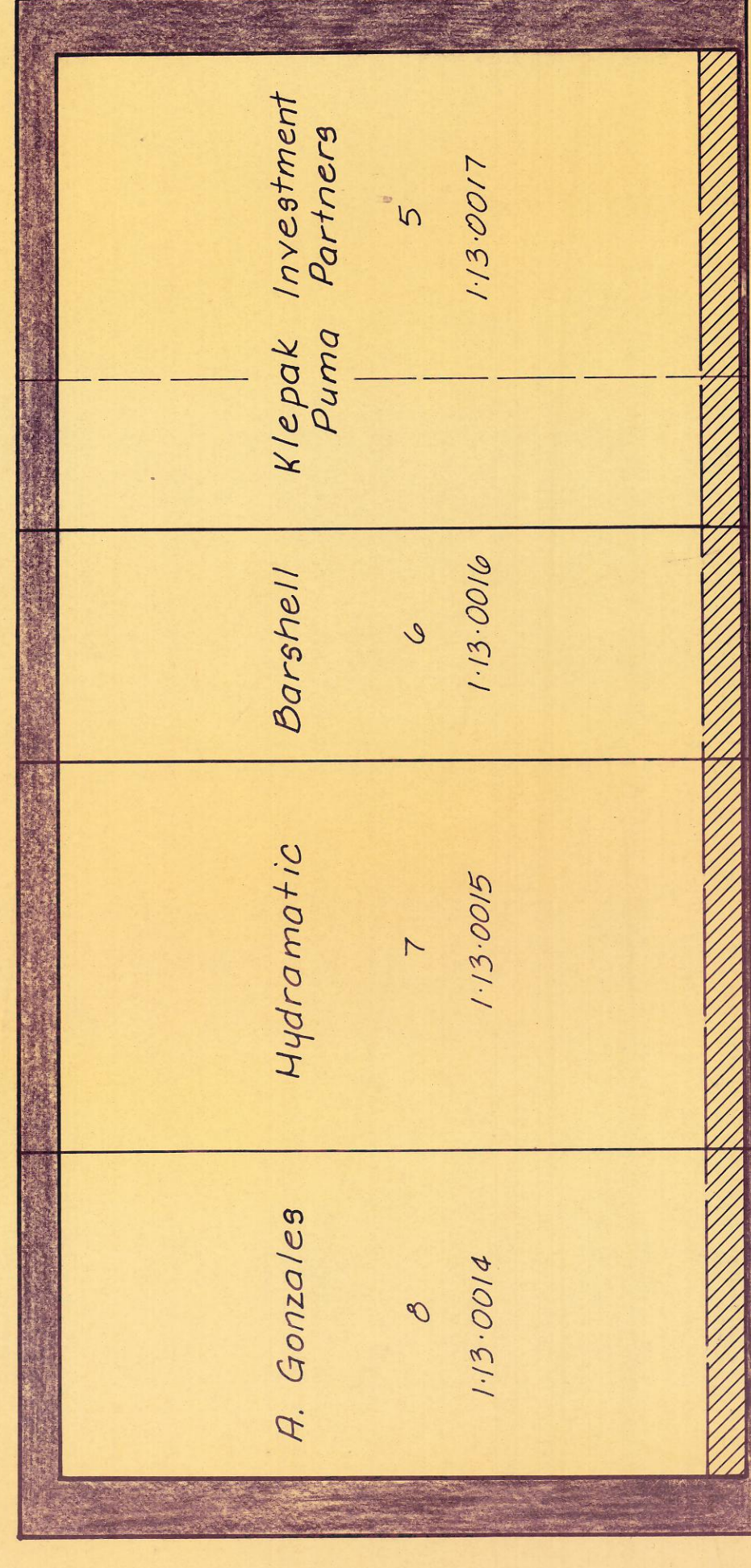
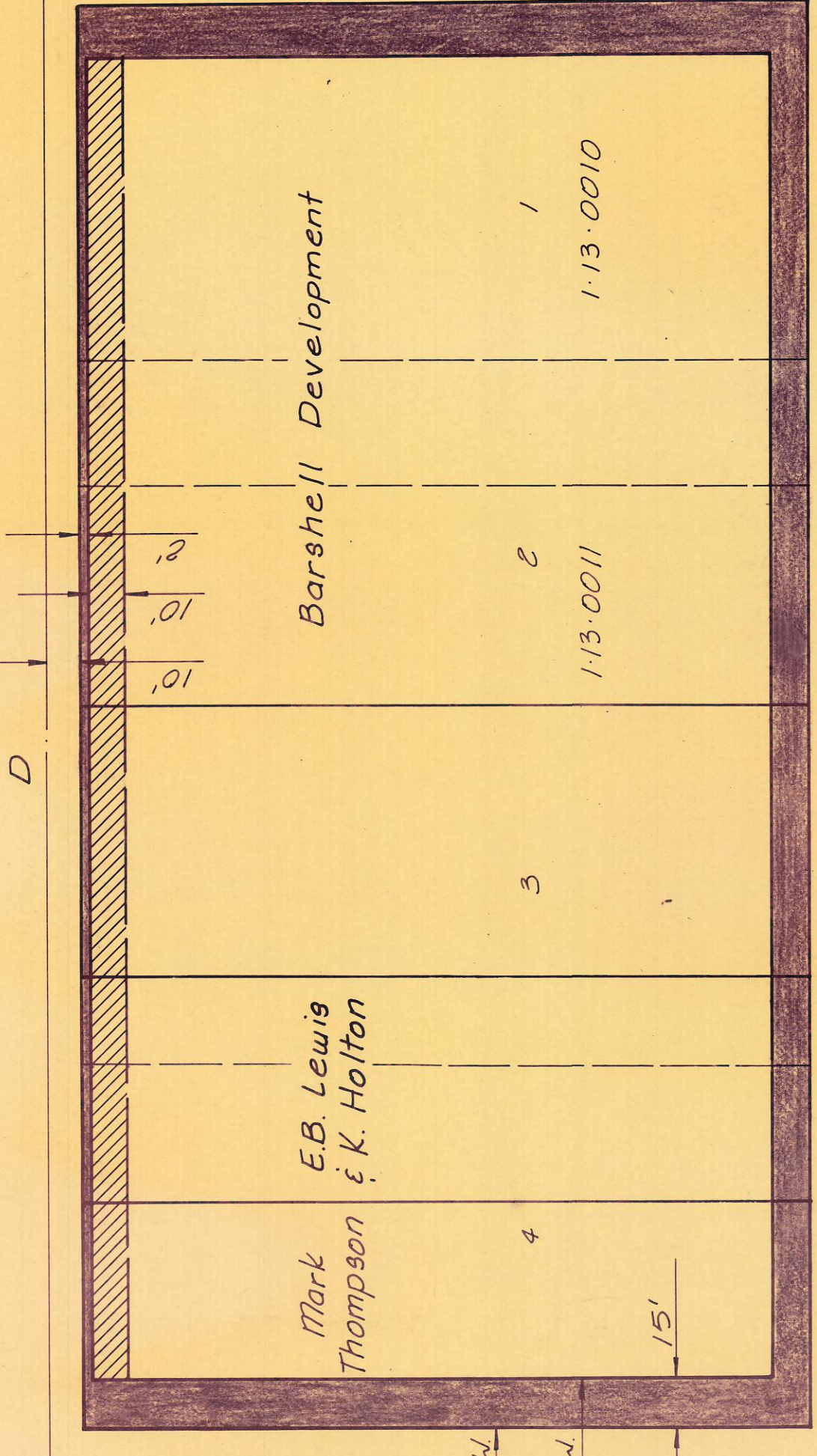
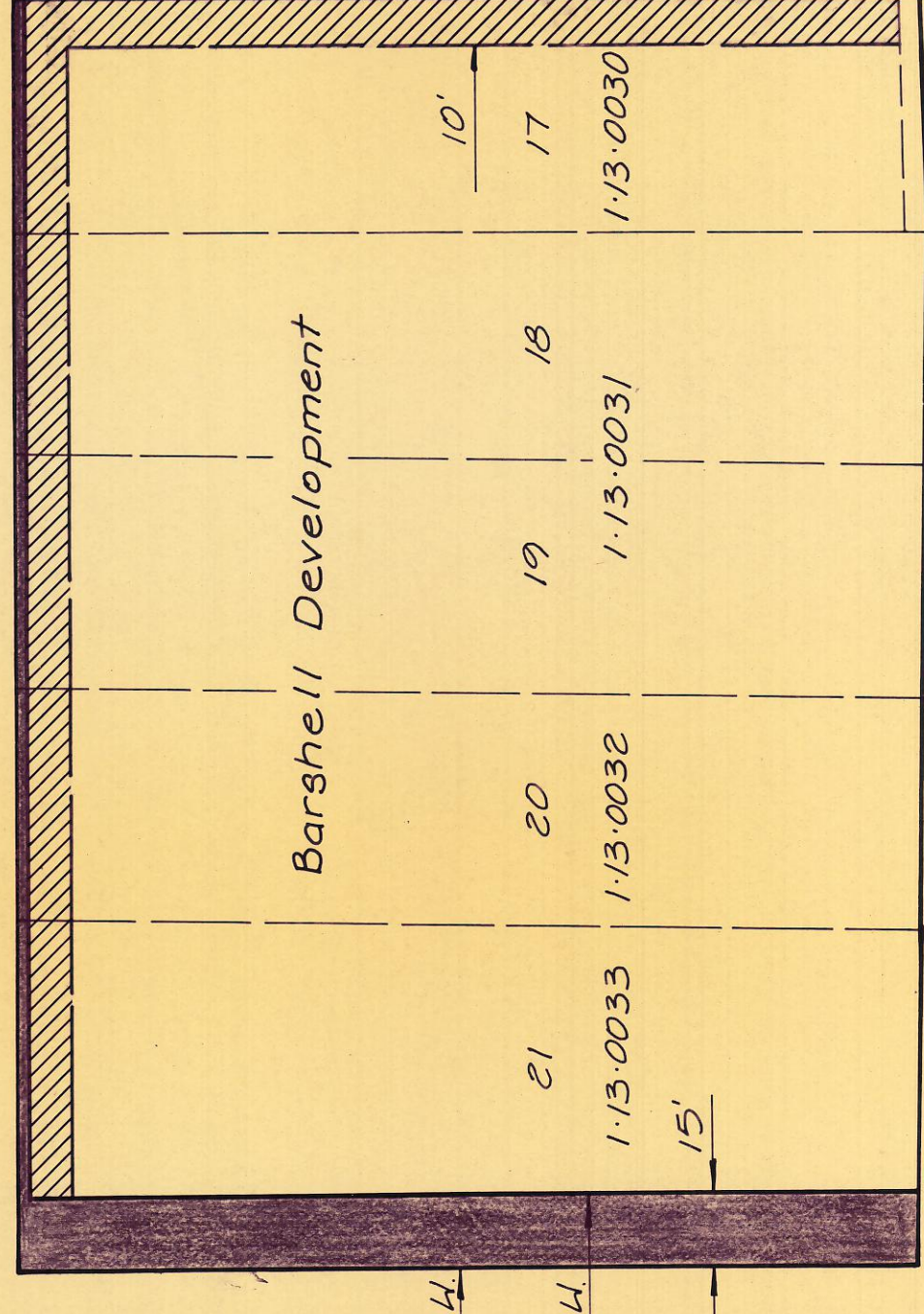
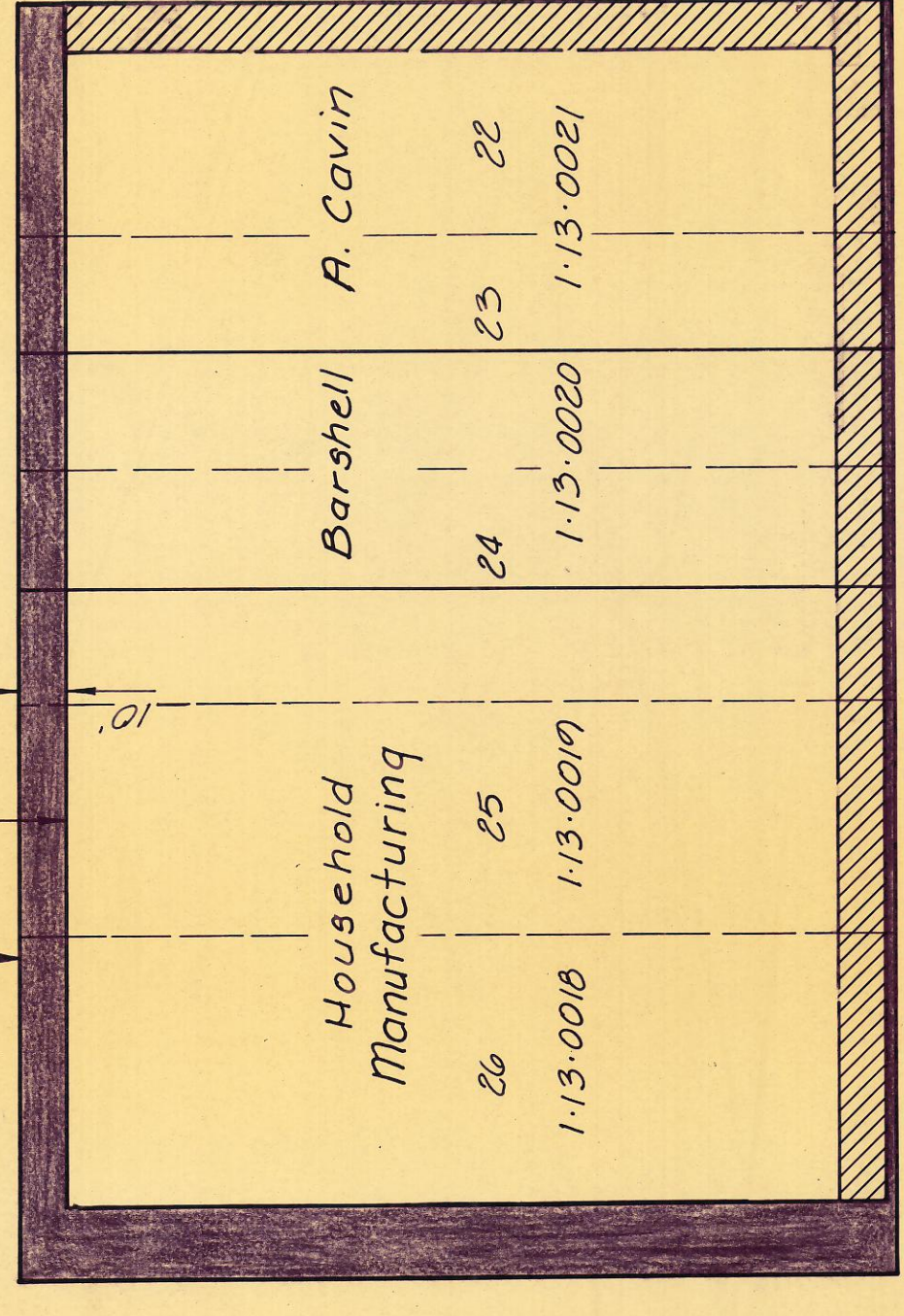
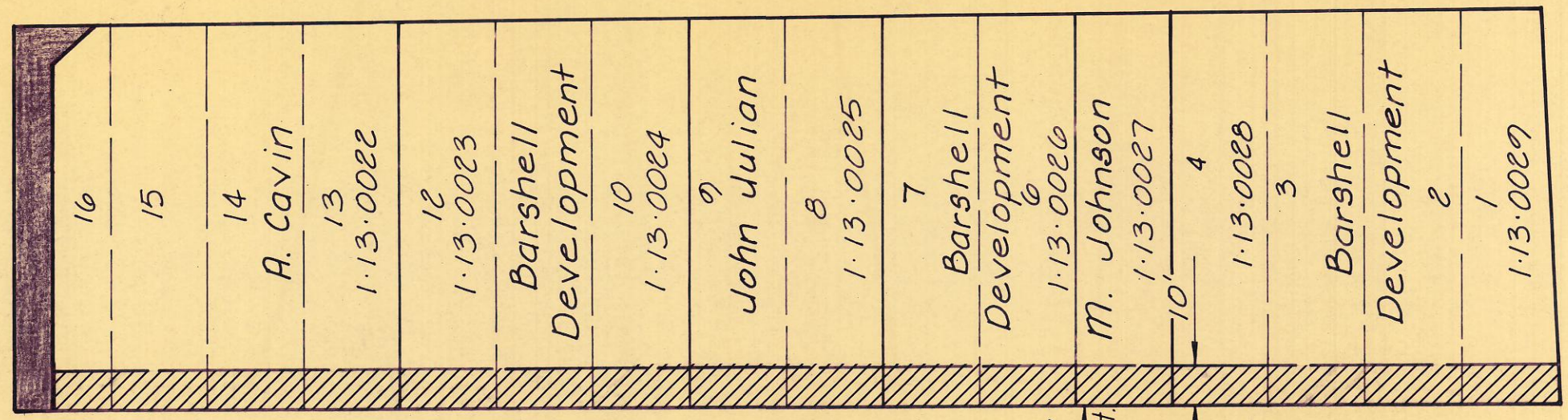
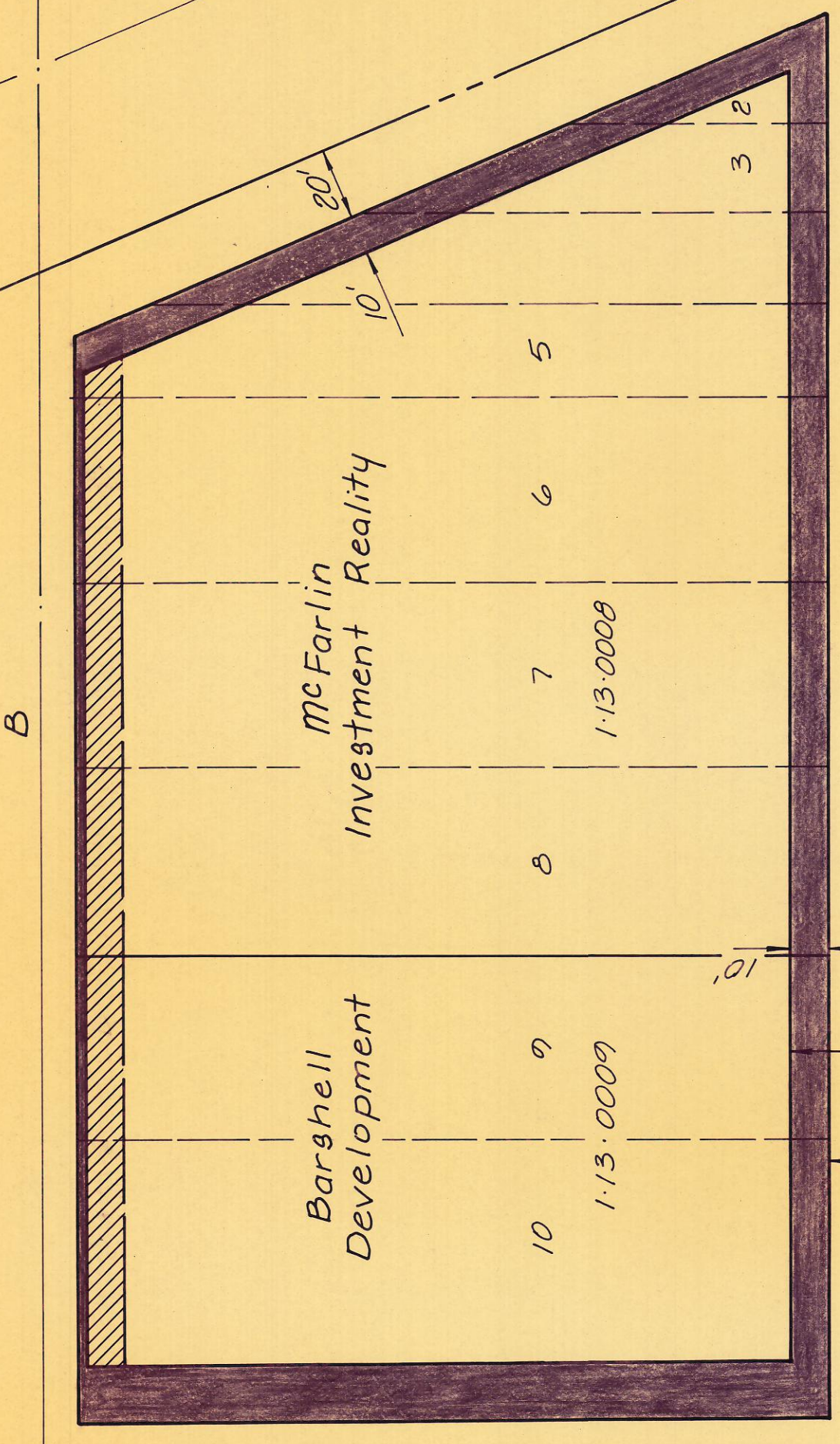

JULIAN AVENUE

CLARA STREET

STREET

STREET

MILDRED STREET

ADDISON ROAD

Proposed Easement Dedication  
Proposed R.O.W. Dedication

**PROGRESS PRINT**  
Not For Construction

Town of Addison  
Dallas County, Texas  
OLD TOWN

**PRELIMINARY**  
NOT FOR CONSTRUCTION

GINN, INC.  
Consulting Engineers  
Dallas, Texas

Designed -  
Checked -  
Approved -  
Date -  
Scale -  
Job No. -  
Sheet - 01