

ST. LOUIS & SOUTHWESTERN RAILWAY

BROADWAY STREET

Moses & Cline

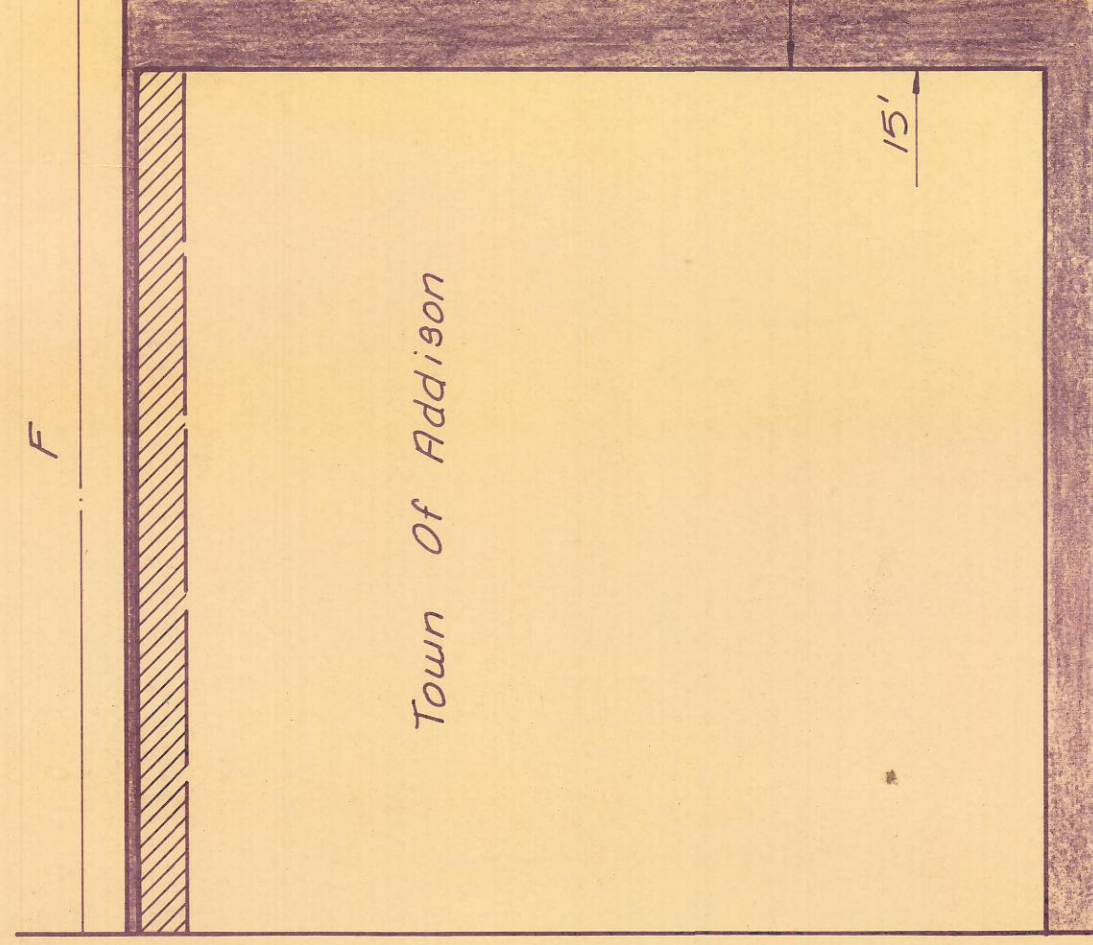
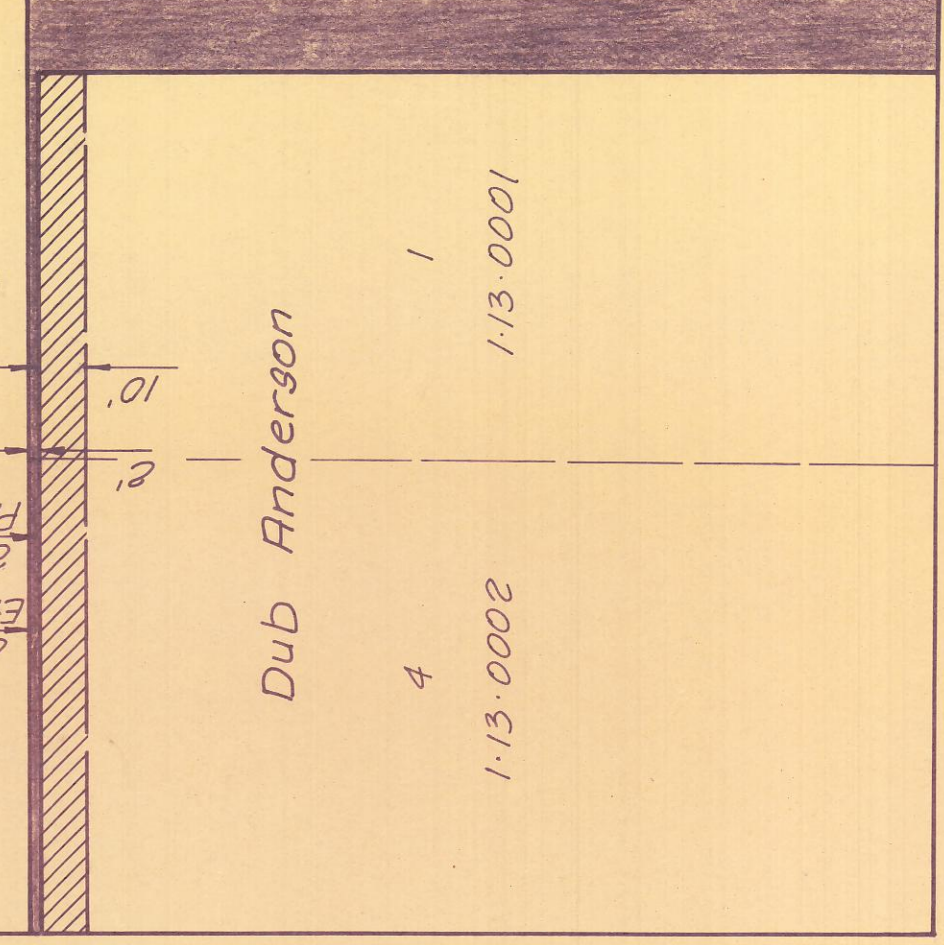
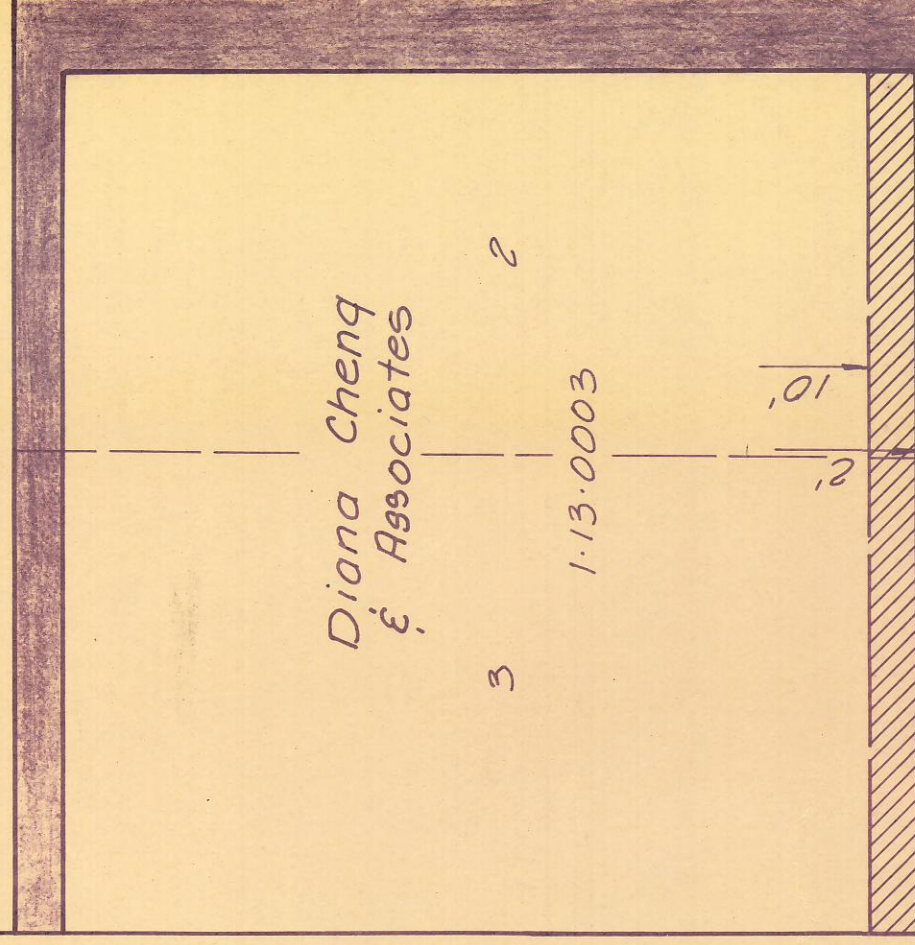
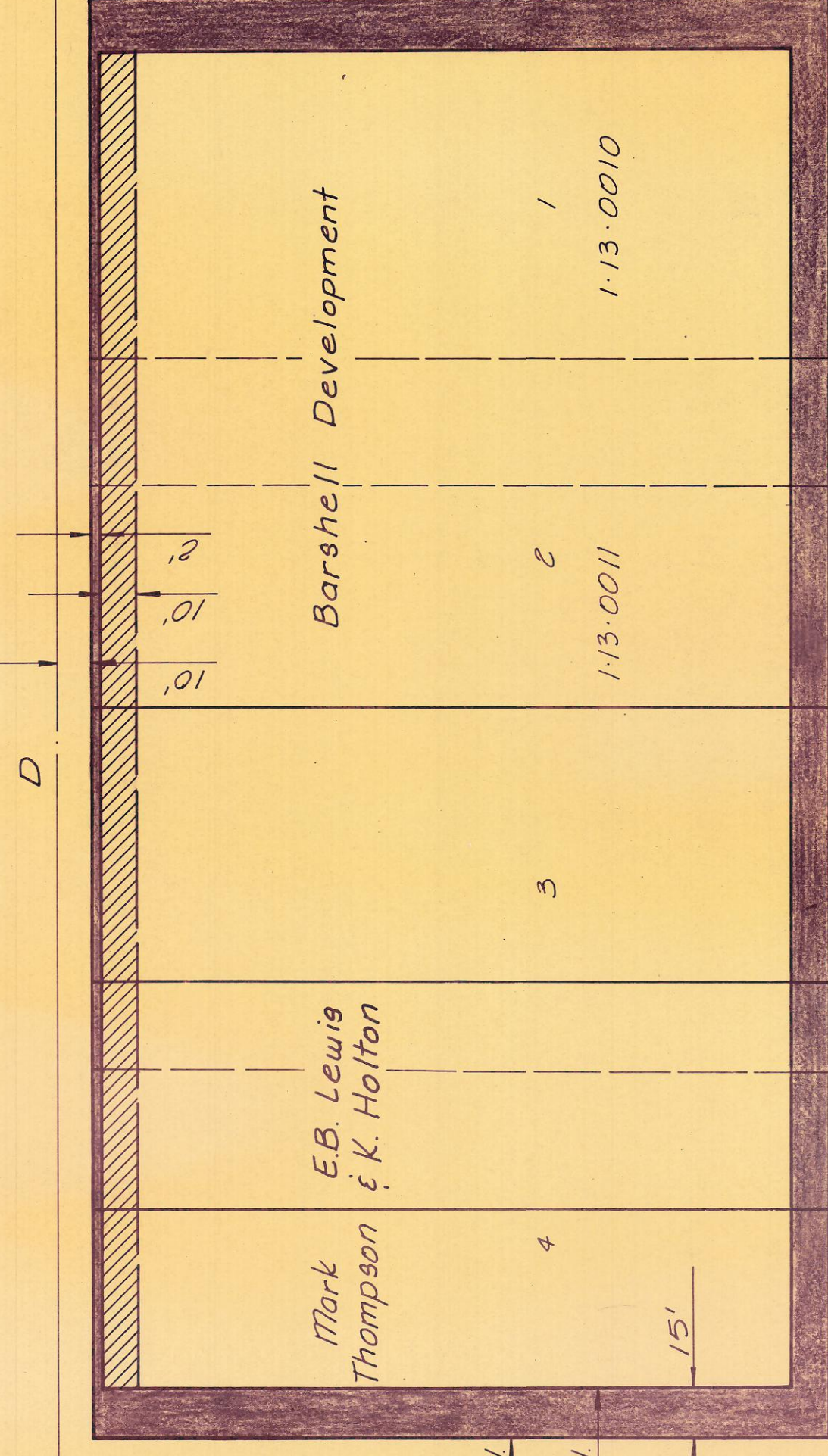
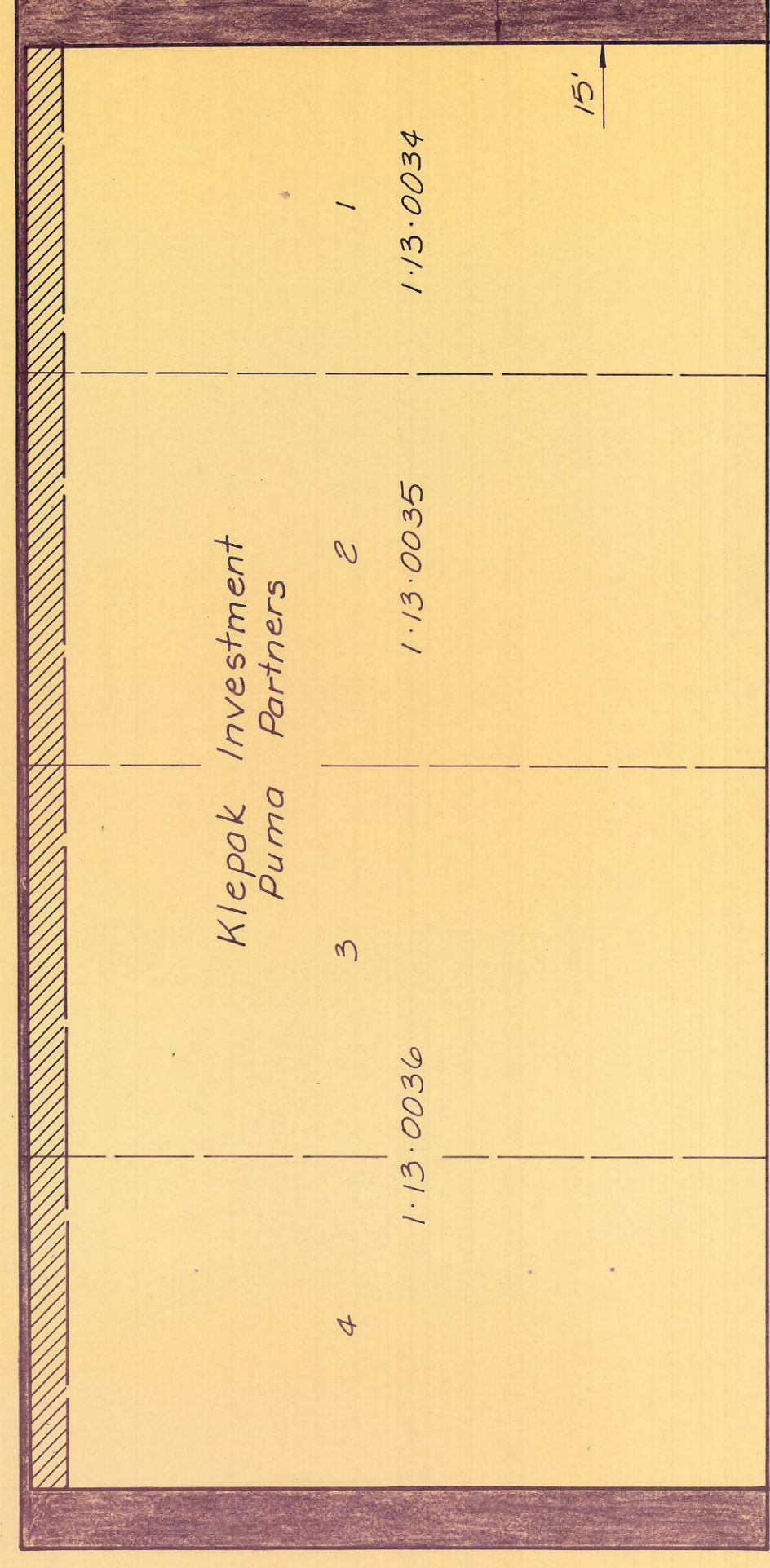
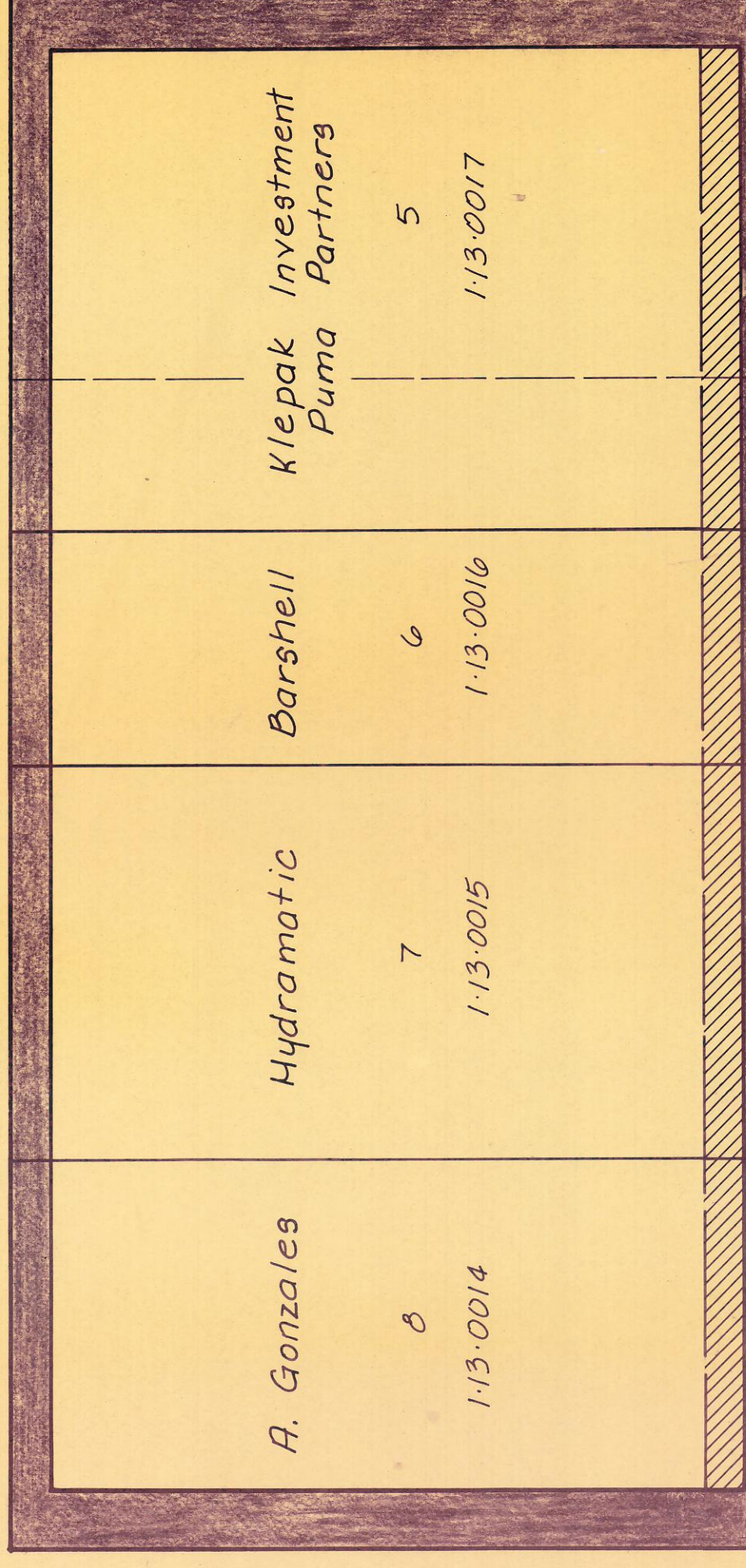
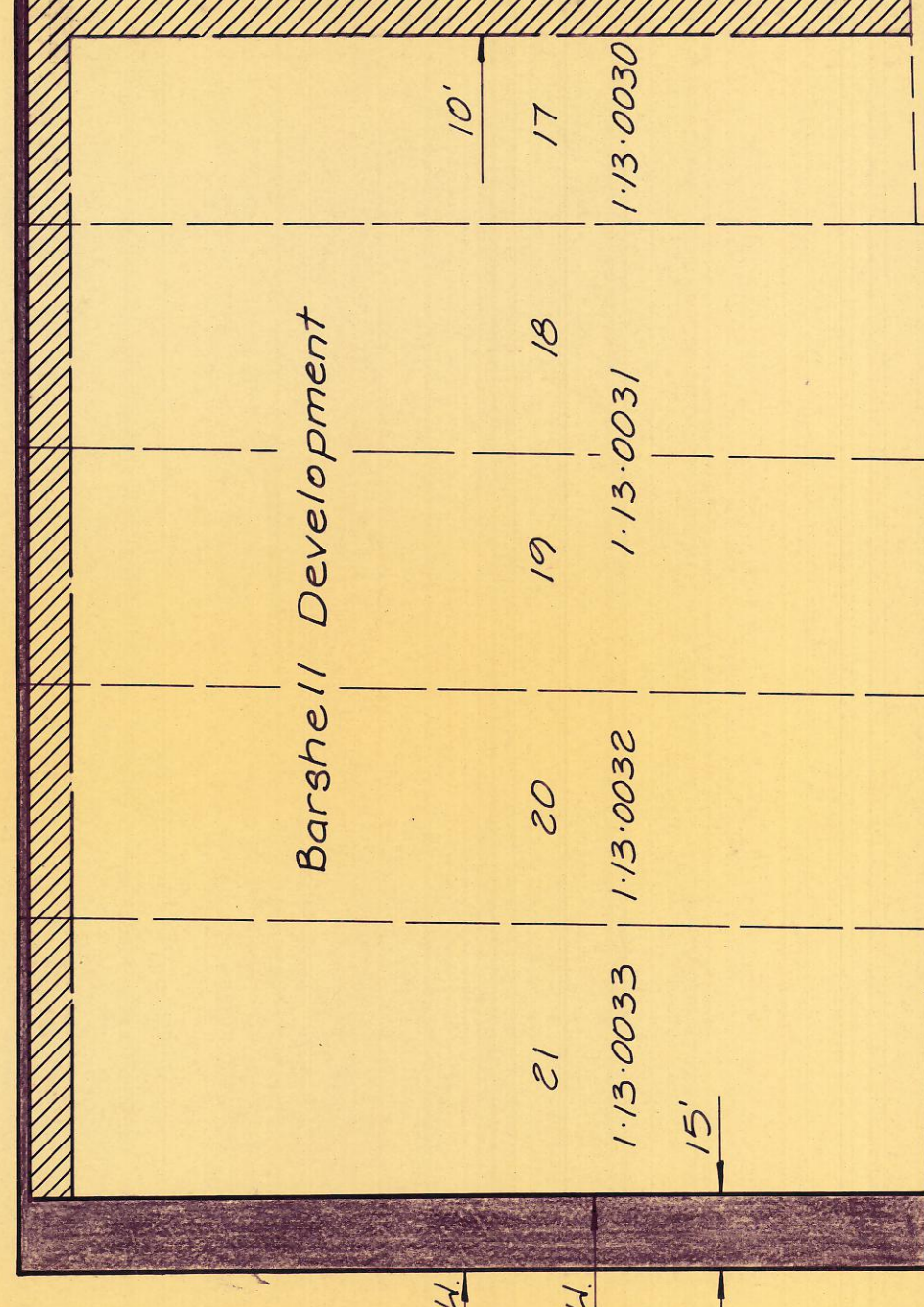
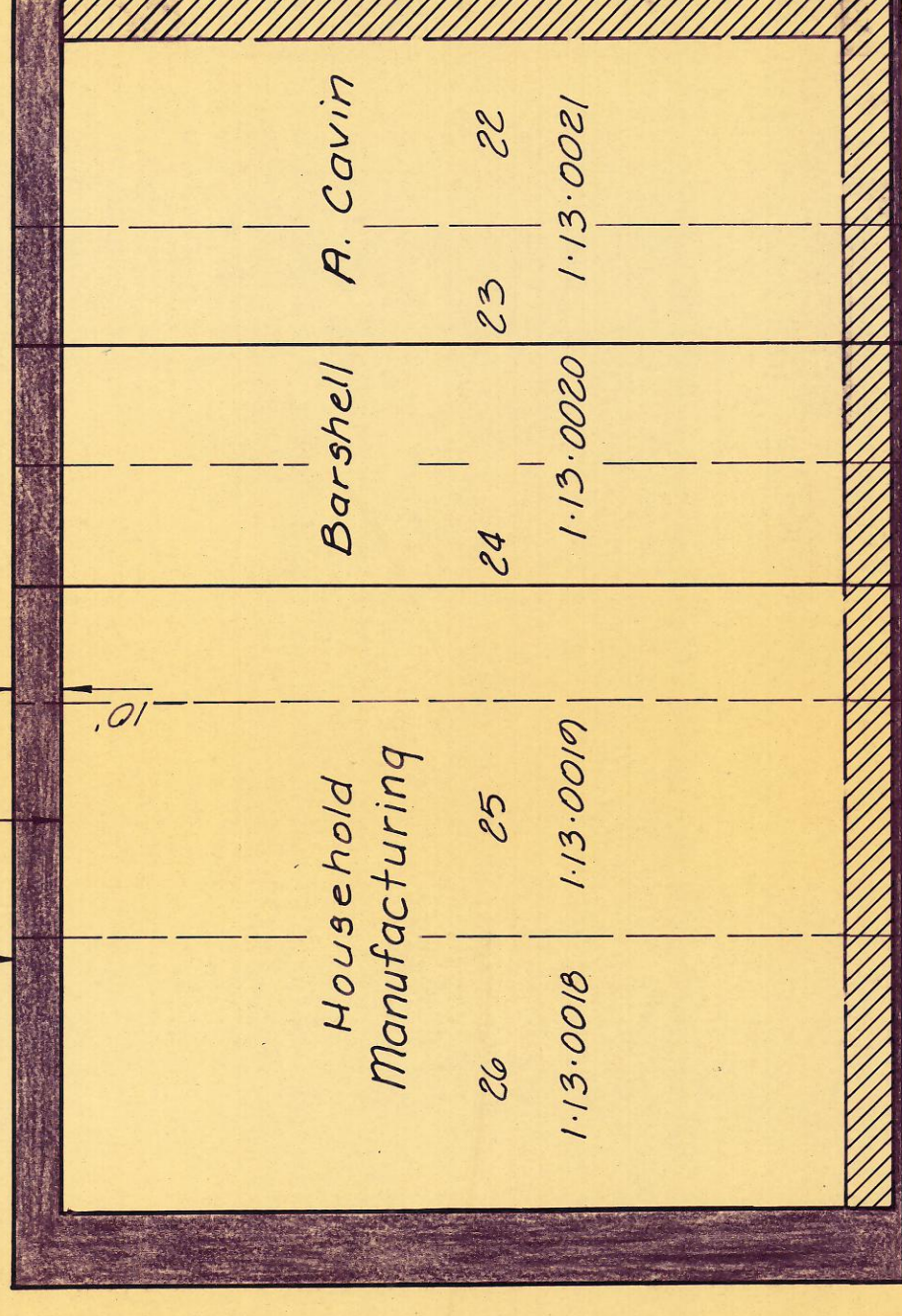
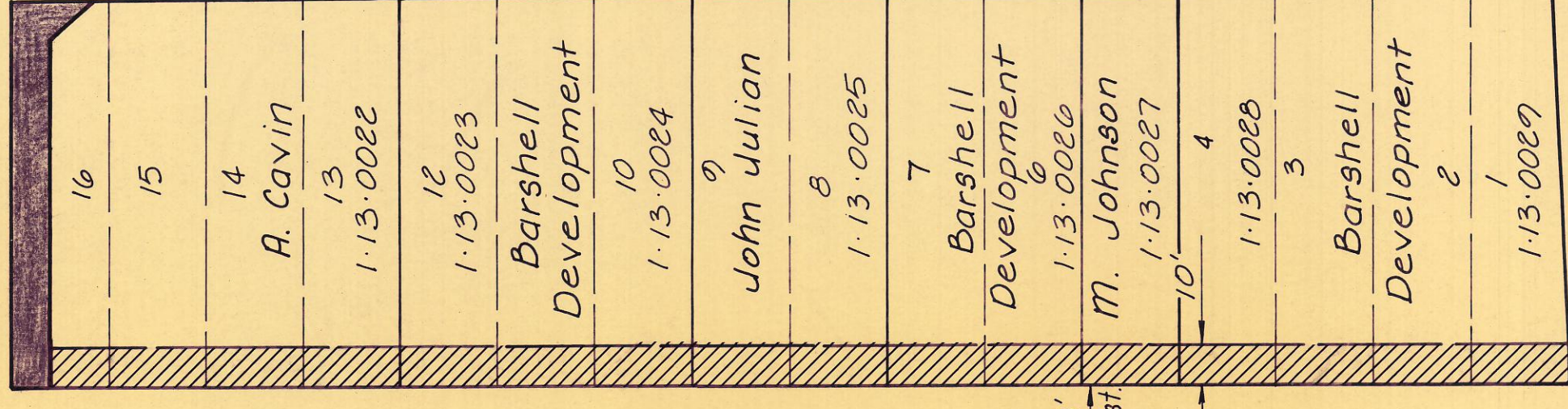
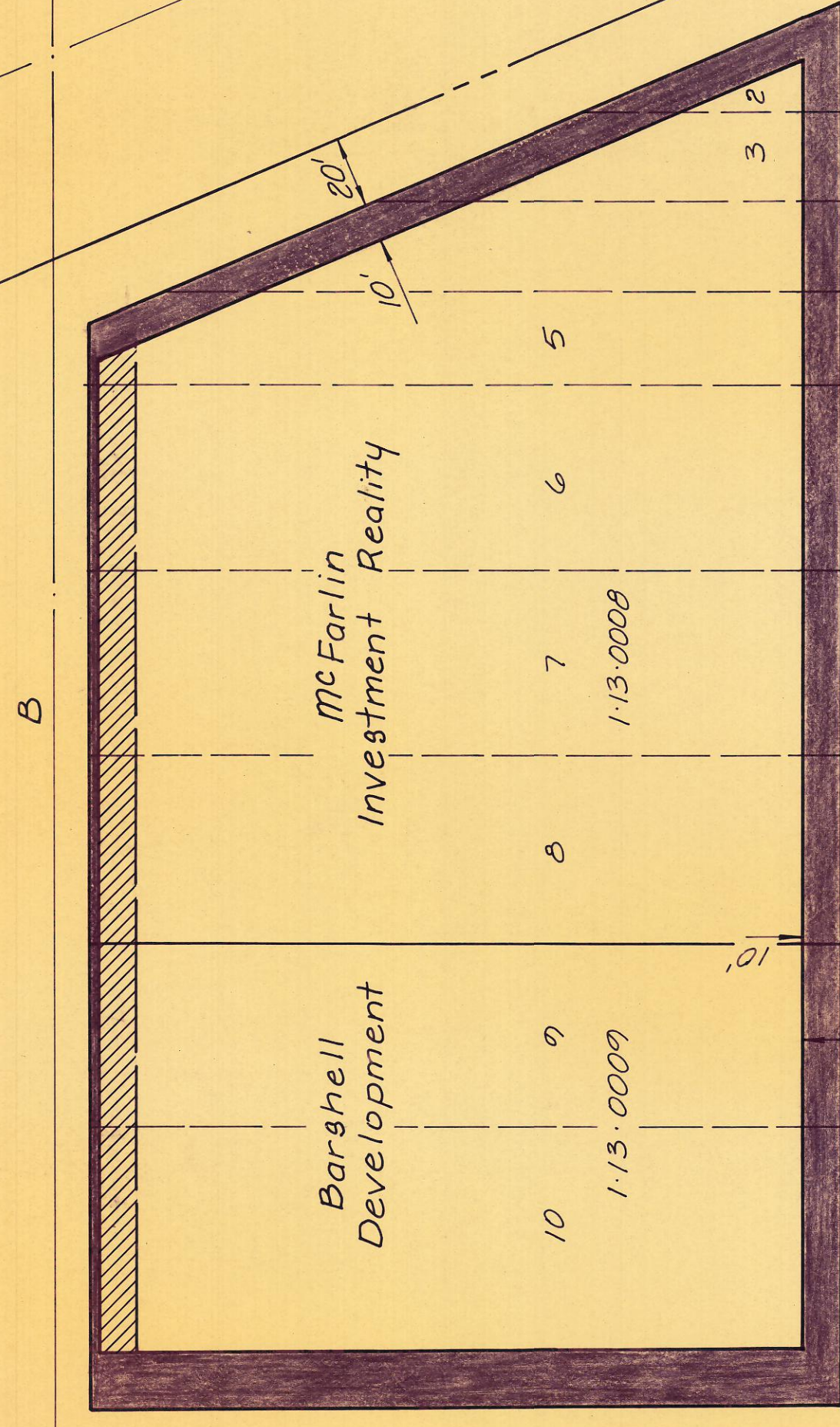

Proposed Easement Dedication
Proposed R.O.W. Dedication



ADDISON ROAD

MILDRED STREET

CLARA STREET

STREET

BROADWAY STREET

PRELIMINARY
NOT FOR CONSTRUCTION

PROGRESS PRINT
Not For Construction

Town of Addison
Dallas County, Texas
OLD TOWN

GINN, INC.
Dallas, Texas
Consulting Engineers

Approved - _____
Checked - _____
Designed - _____
Drawn - _____
Scale - _____
Job No. - _____
Sheet - 01