

ALLEY WIDTH (A)	HALF SECTION WIDTH (L)	INVERT DEPTH (d)
10'	5'	4"
12'	6'	6"
16'	8'	6"
20'	10'	6"

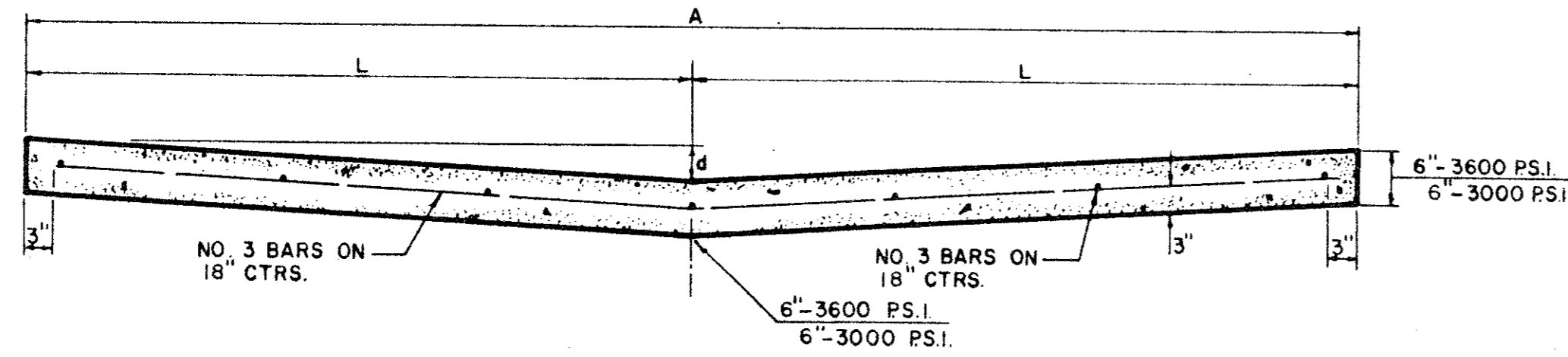

STANDARD 10', 12', 16', & 20' ALLEY SECTION

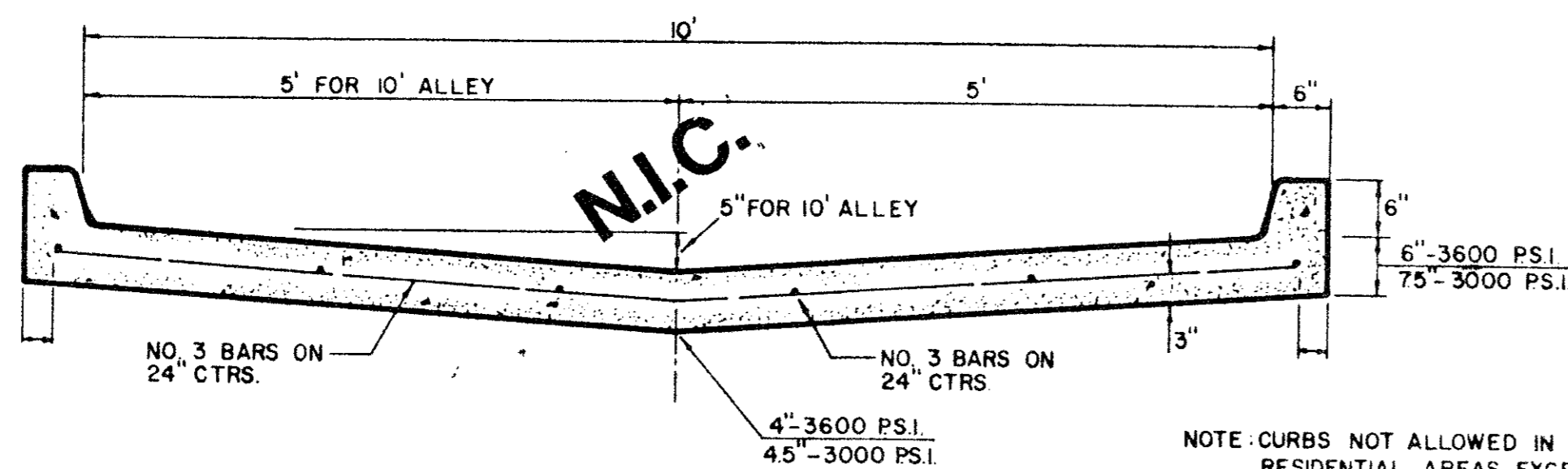

STANDARD ALLEY SECTION WITH CURBS

NOTE: CURBS NOT ALLOWED IN RESIDENTIAL AREAS EXCEPT AS APPROVED BY THE ENGINEER.

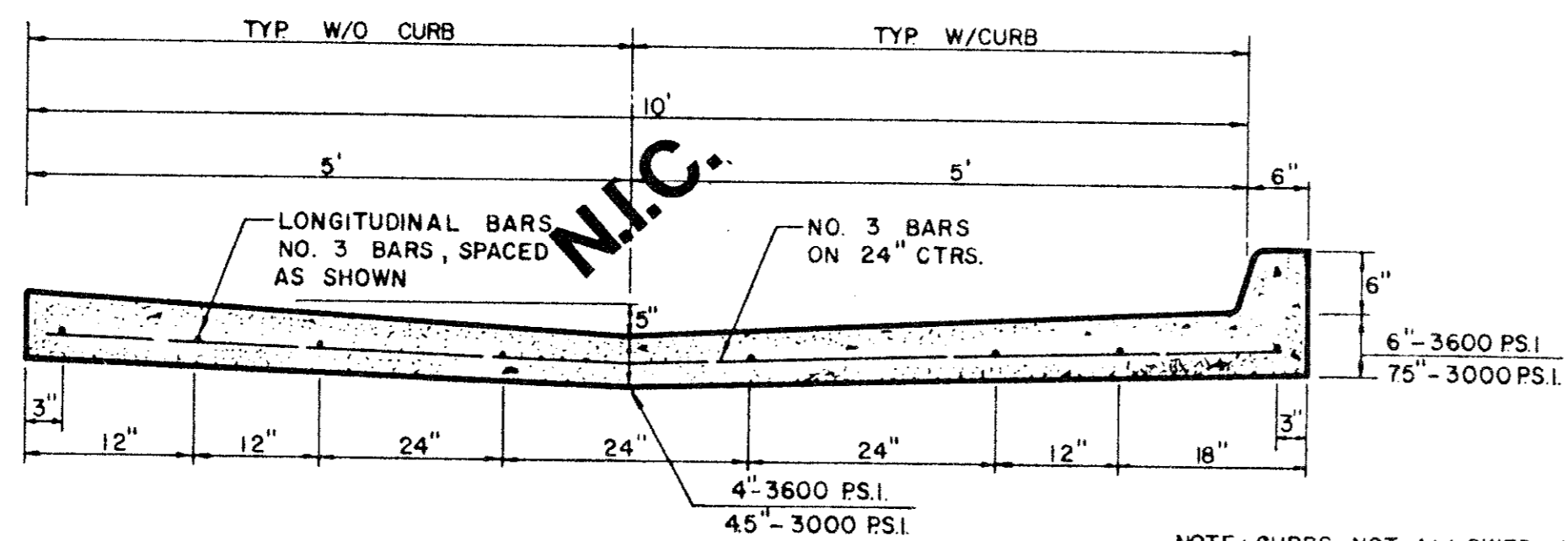

ALTERNATE 10' ALLEY SECTION / CURB

NOTE: CURBS NOT ALLOWED IN RESIDENTIAL AREAS EXCEPT AS APPROVED BY THE ENGINEER.

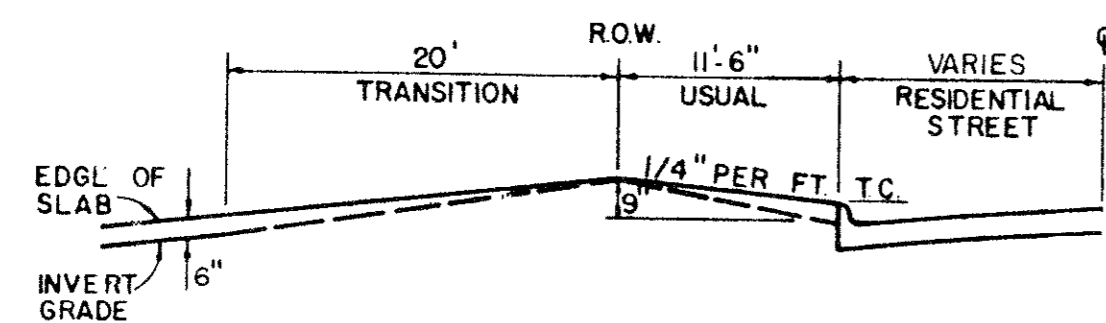

TYPE I ALLEY ENTRANCE

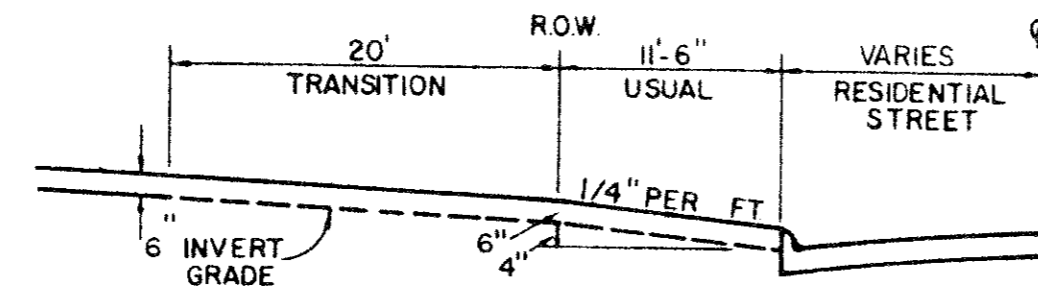

TYPE II ALLEY ENTRANCE

N.I.C. (Not In Conformance)

ALLEY WIDTH	A	B	C	D	E	F
10'	10'	2'-6"	15'	1'-6"	12'	8'6"
12'	12'	1'-6"	15'	1'-6"	12'	8'5"
16'	16'	2'-0"	20'	2'-0"	16'	8'0"
20'	20'	0	20'	0	20'	10'0"

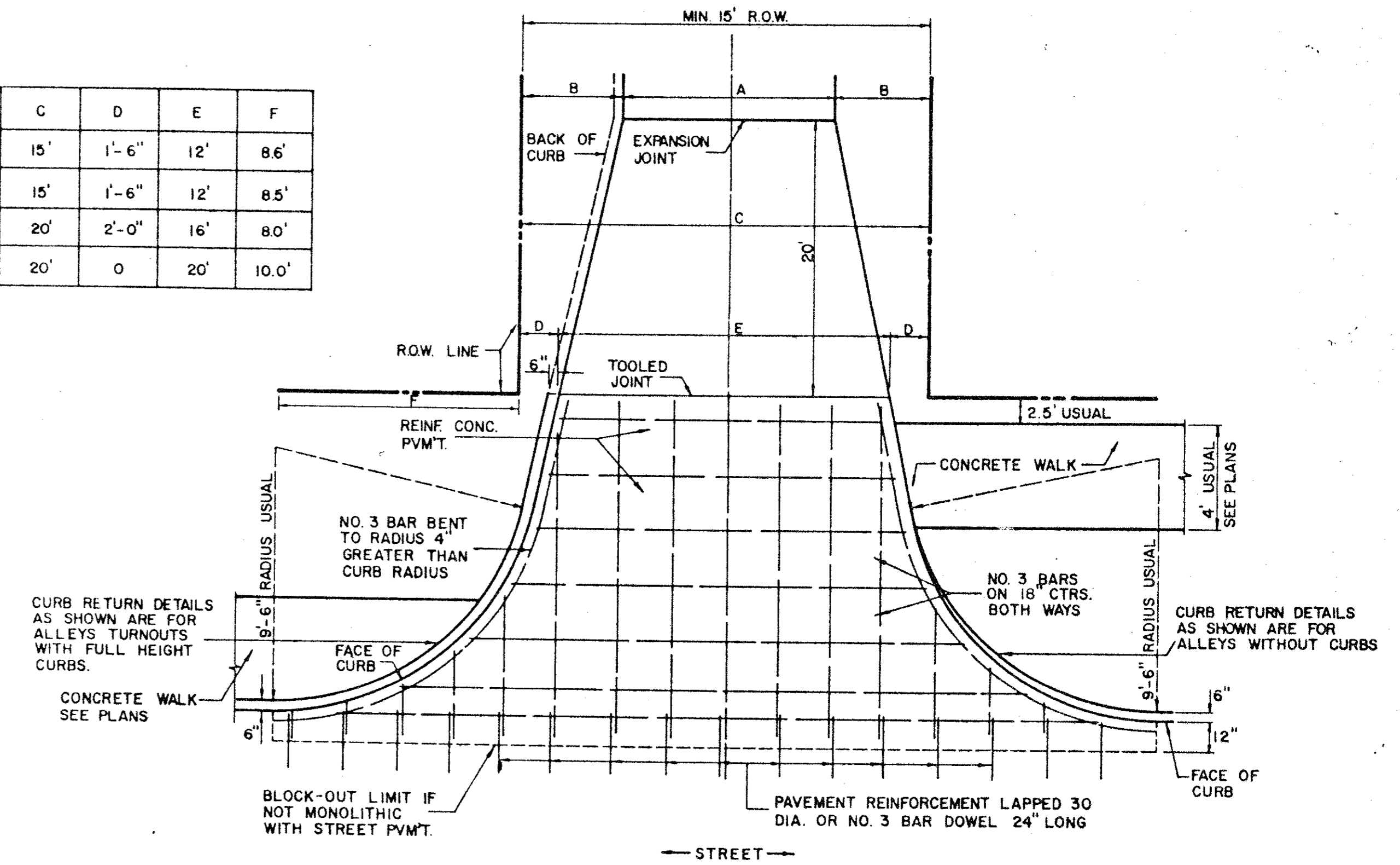

ALLEY RETURN DETAILS

FOR DETAILS ONLY-SEE PLAN FOR DIMENSIONS

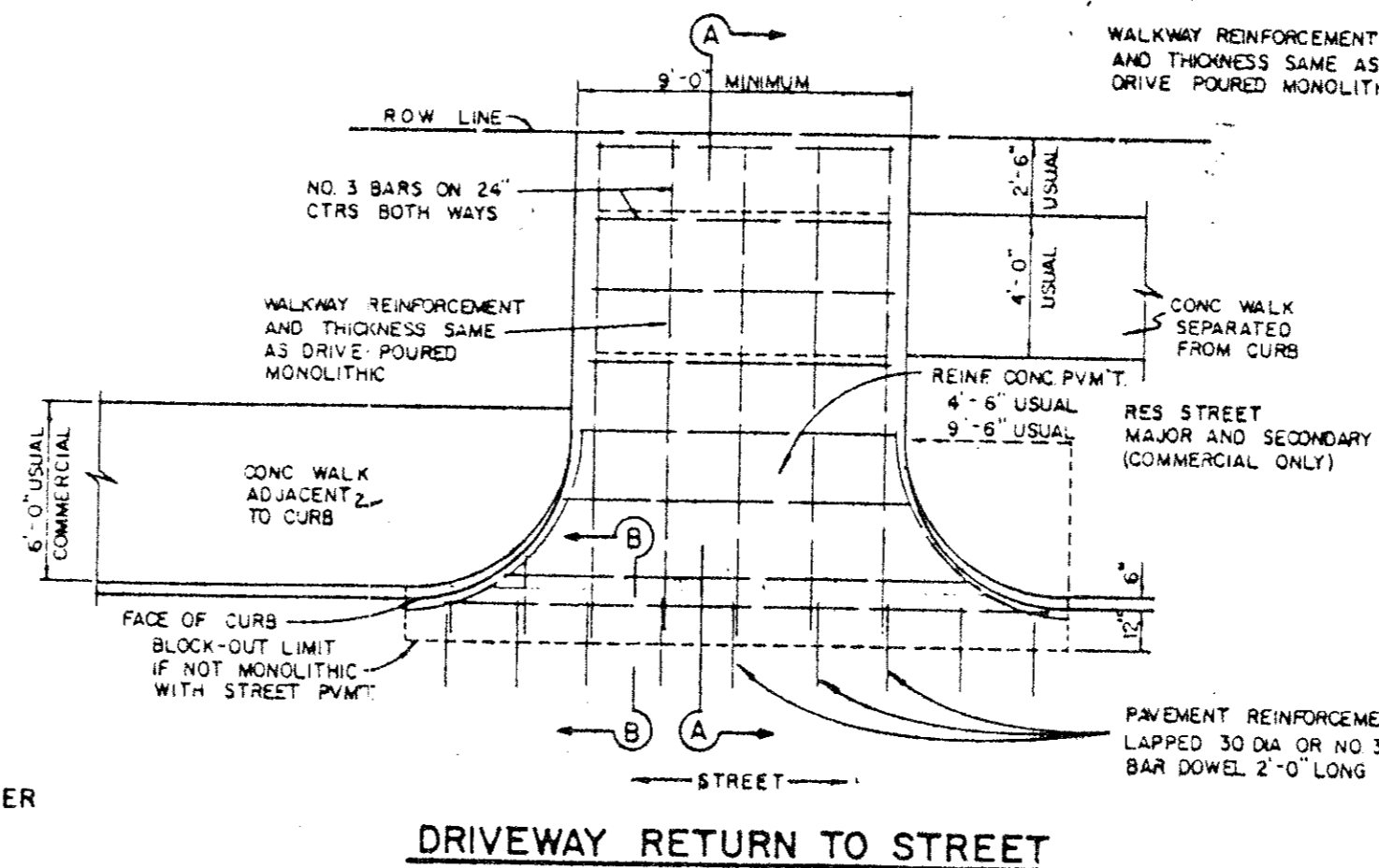

DRIVEWAY RETURN TO STREET

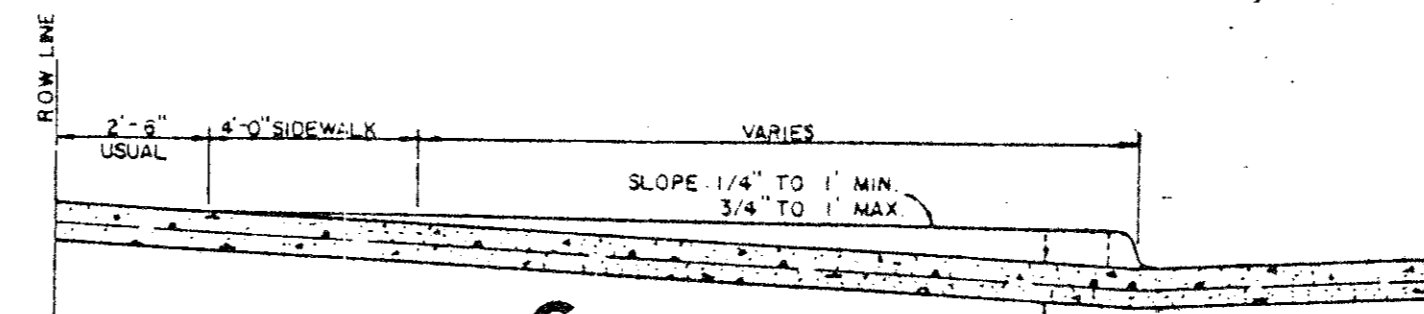

SECTION A-A

SECTION B-B
DRIVEWAY RETURN DETAILS

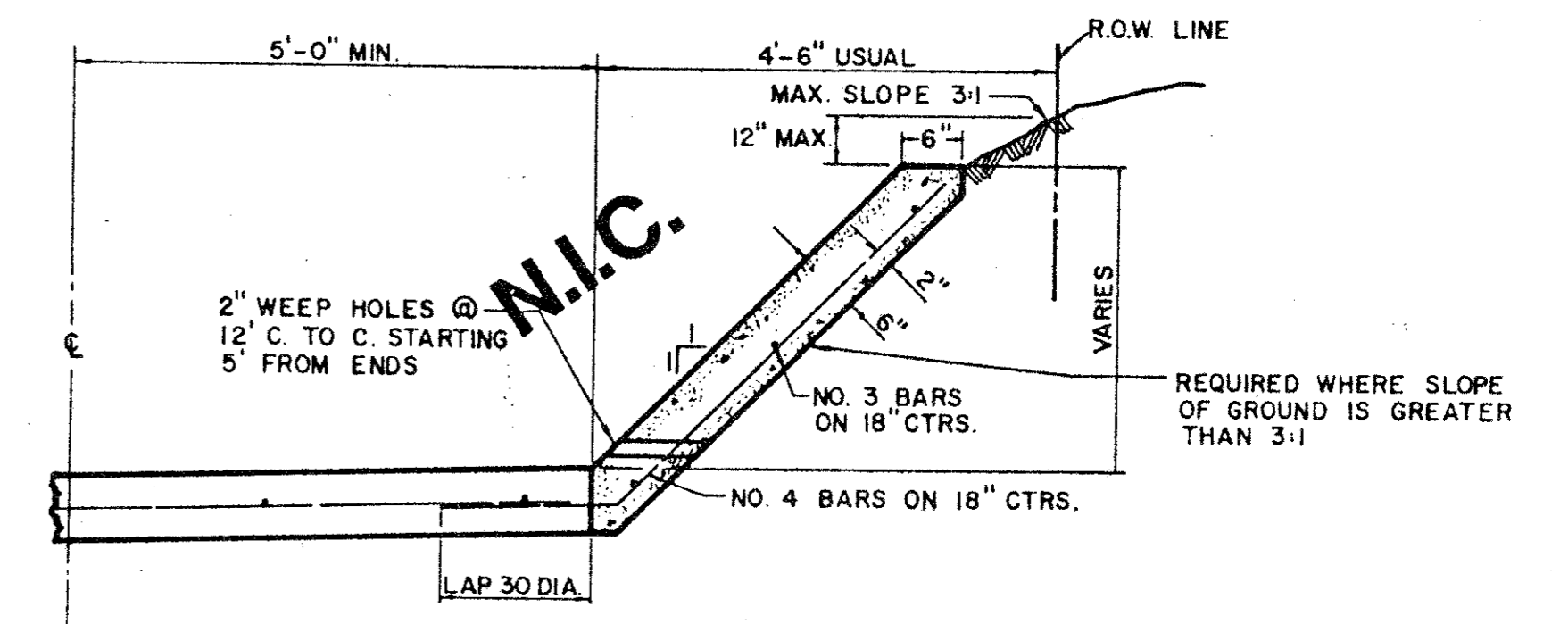

ALLEY SLOPE PROTECTION

GENERAL NOTES FOR ALLEYS AND DRIVEWAYS

1. CONCRETE FOR ALLEY RETURNS AND DRIVEWAYS SHALL HAVE A MINIMUM COMPRESSIVE STRENGTH AT 28 DAYS IDENTICAL TO THAT SPECIFIED FOR THE STREET PAVEMENT OR BASE WHEN BUILT AS COMPONENTS OF A CONCRETE PAVING PROJECT. WHEN BUILT SEPARATELY, THE STRENGTH SHALL BE AS SPECIFIED ON THE CONSTRUCTION PLANS.
2. CONCRETE FOR ALLEY PAVEMENT SHALL BE OF THE STRENGTH SPECIFIED ON THE CONSTRUCTION PLANS. (3000 P.S.I. OR 3600 P.S.I. MINIMUM COMPRESSIVE)
3. SPACING AND CONSTRUCTION OF JOINTS SHALL CONFORM TO STREET PAVEMENT DETAILS.

AS BUILTS

I CERTIFY THIS PROJECT WAS CONSTRUCTED IN GENERAL CONFORMANCE WITH THESE CONSTRUCTION PLANS AND WILL FUNCTION AS DESIGNED.

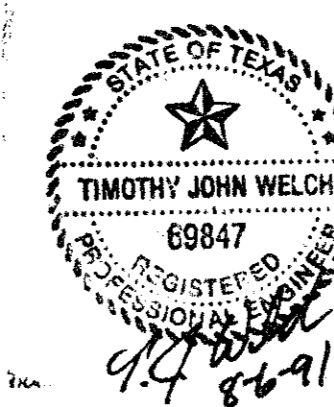

TOWN OF ADDISON, TEXAS
 DEPARTMENT OF ENGINEERING
STANDARD CONSTRUCTION DETAILS PAVING
ALLEY & DRIVEWAY RETURNS

Designed -	Drawn -	Date - AUGUST, 1991	Job No. - 90025-4
Approved -	Checked -	Scale -	Sheet D-2 OF