

Revisions	Date	Description	Drawn By	Checked By

WATER & SANITARY GENERAL NOTES

- All water mains shall be PVC SDR-18 water pipe.
- All sanitary sewer mains shall be PVC SDR-35 and shall have integral wall bell and spigot joints.
- All water mains shall have a minimum cover below finished grades as follows: 6" & 8" - 48", 12" - 60", or as required to clear other utilities.
- The location of all utilities are taken from existing public records. The exact location must be determined by the Contractor. It is the duty of the contractor to ascertain whether any other facilities (additional), other than those on the plans may be present.
- All utility and service laterals trenches shall be backfilled and compacted to 95% Standard Proctor Density.
- All manholes, cleanouts, valve boxes, fire hydrants, etc., must be adjusted to proper line and grade by the Contractor after placing of permanent paving.
- All work and materials shall be in accordance with the Town of Addison Standard Specifications.
- Contractor shall be responsible for providing "as-built" plans to the Engineer showing the location of sewer service by distance to the lot lines.
- All fire hydrants shall be Mueller Centurion model.
- The No. 12 plastic coated wire shall be placed in the trench over all water lines. The wire will be tied to all valves and fire hydrants and attached directly to the top of pipe and extend to six (6") inches above finished grade along the outside of all valve stacks and fire hydrants.
- All dimensions shown are to centerline of pipe and the R.O.W., unless otherwise noted.
- Contractor shall be responsible for trench safety and details as required.

UTILITY KEY

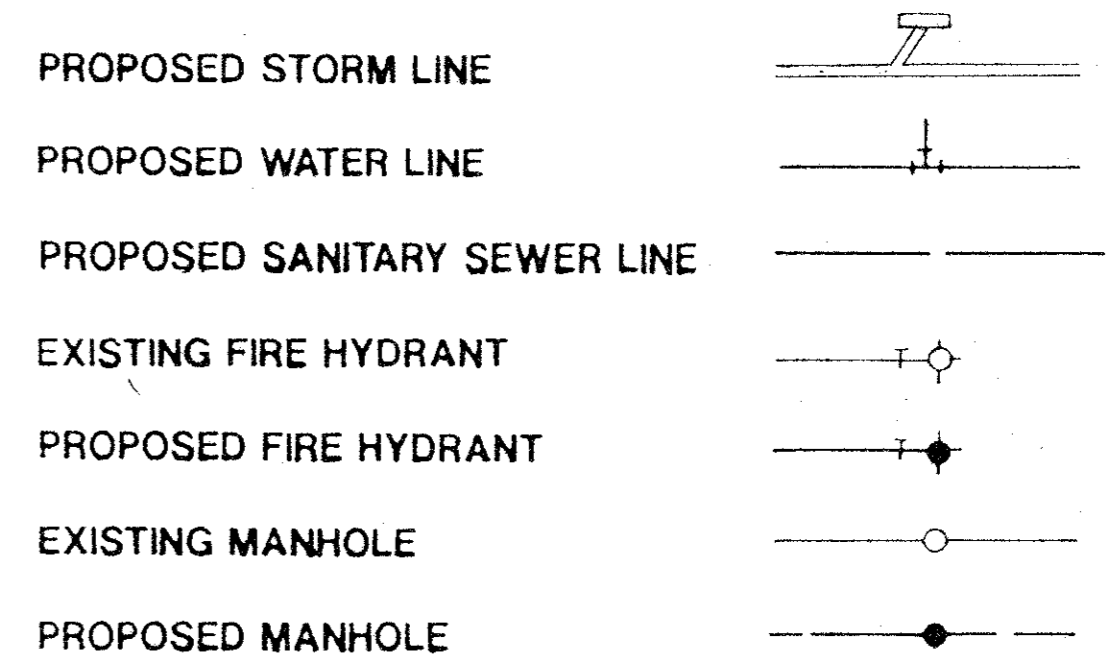

BENCHMARKS:

- Square cut on N.W. corner of footing of T.U. Electric tower No. 12N-3W-T288 near Addison Fire Station No. 2. Elev. 605.20
- Square cut on top of curb of east median nose in the centerline of Beltway Drive at Les Lacs Avenue. Elev. 594.42
- Square cut on centerline of 14' inlet at the N.E. corner of the intersection of Beltway Drive and Marsh Lane. Elev. 585.20

AS BUILT

I CERTIFY THIS PROJECT WAS CONSTRUCTED IN GENERAL CONFORMANCE WITH THESE CONSTRUCTION PLANS AND WILL FUNCTION AS DESIGNED.

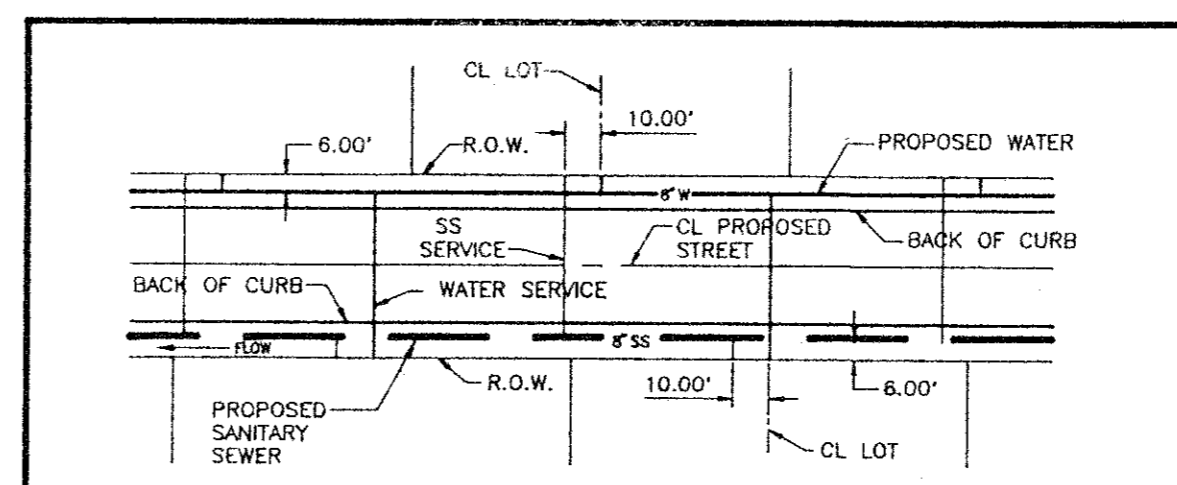

TYPICAL INSTALLATION DETAIL FOR WATER & SANITARY SEWER SERVICES
N.T.S.

WATER & SANITARY SEWER PLAN

CHATHAM COURT
TOWN OF ADDISON, TEXAS

Date: AUGUST, 1991	Scale: 1" = 50'	SHEET _____ OF _____
Drawn By: TNC	Approved By: TNC	WS-1 SHEETS

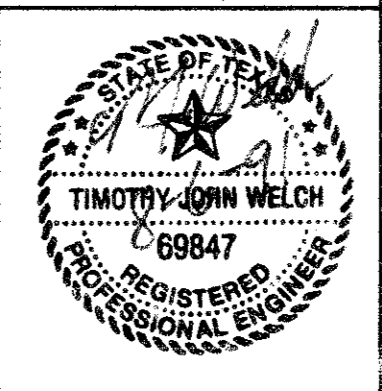

THE NELSON CORPORATION
LAND PLANNING • ENGINEERING • SURVEYING

5099 SUMMERSIDE DRIVE • SUITE 202 • DALLAS, TEXAS 75252 • (214) 380-2505