

PERMANENT BENCHMARK: CITY OF ADDISON CONTROL MONUMENT #AA-2, 3" ALUMINUM DISK SET IN CONCRETE INSCRIBED WITH "AA-2" LOCATED ON THE EAST SIDE OF ADDISON AIRPORT, 320.63' WEST OF WEST ROW OF ADDISON ROAD AND 477.1' SOUTH OF SOUTH ROW OF WESTGROVE DRIVE (60' ROW). ELEVATION=641.92

CONSTRUCTION BENCHMARK: SQUARE CUT ON EDGE OF CONCRETE ON THE NORTH SIDE OF CLAIRE CHENNAULT APPROXIMATELY 22 FEET S26°42'25"E OF THE SOUTHEAST PROPERTY CORNER OF SUBJECT PROPERTY. ELEVATION = 643.36

GRASS COVER TO BE ESTABLISHED AND MAINTAINED ON ALL DISTURBED GROUND AREAS UPON COMPLETION OF FINAL GRADING

BMP MAINTENANCE SCHEDULE		
BEST MANAGEMENT PRACTICE	MAINTENANCE FREQUENCY	BY:
SILT FENCE	WEEKLY/AFTER RAIN	CONTRACTOR
SANITARY FACILITY	WEEKLY	CONTRACTOR

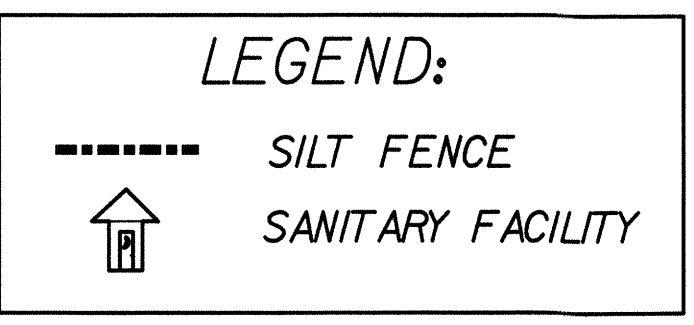
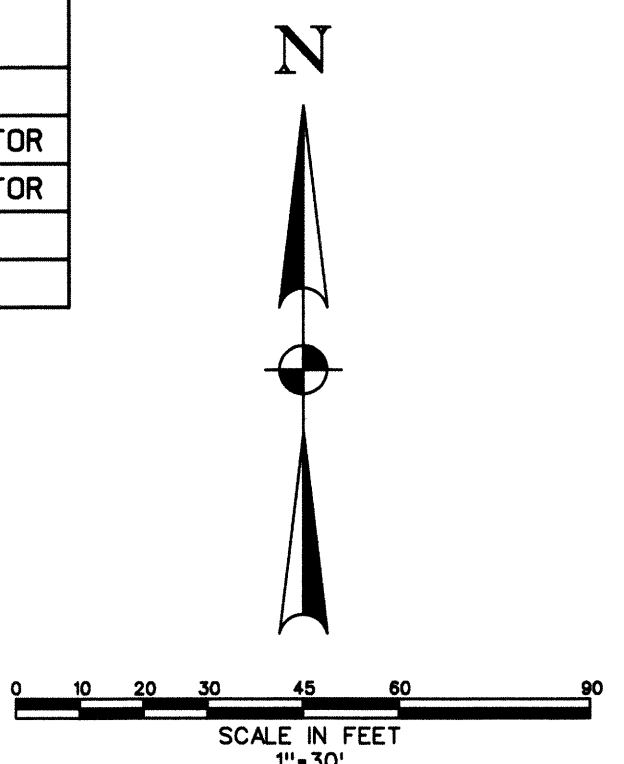

**EROSION CONTROL CONSTRUCTION PLAN**

SILT FENCE	INSTALLATION:	REMOVAL:
	PRIOR TO STARTING	AFTER ESTABLISHING GRASS COVER

STABILIZATION OF DISTURBED AREAS PRIOR TO FINAL ACCEPTANCE

A. PUBLIC RIGHTS-OF-WAY, EASEMENTS, AND COMMON AREAS MUST BE STABILIZED WITH PERENNIAL VEGETATION COVER, FULLY ESTABLISHED WITH 100% COVERAGE, OR OTHER APPROVED STABILIZATION METHOD.

B. ALL WORK IN THE RIGHT-OF-WAY OF CLAIRE CHENNAULT IS TO BE PERFORMED IN ACCORDANCE WITH CITY OF ADDISON STANDARDS.

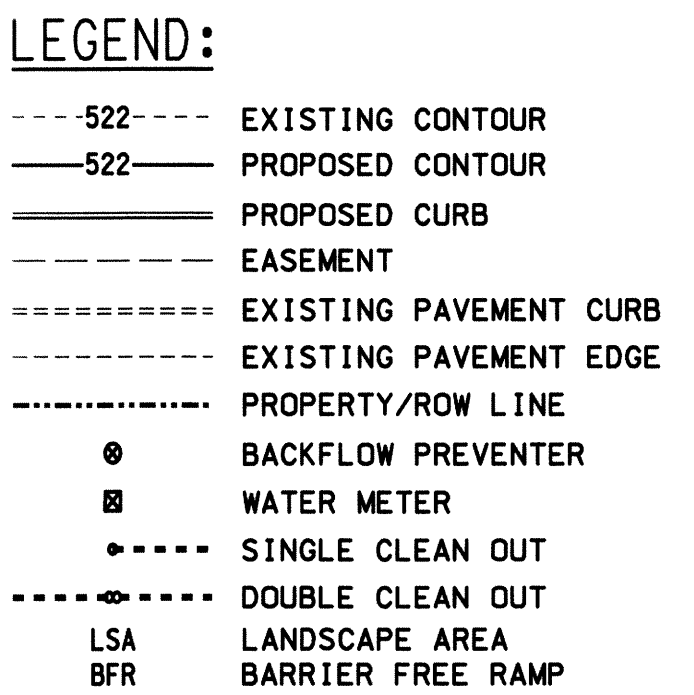

**GENERAL NOTES:**

1. EROSION CONTROL DEVICES AS SHOWN ON THE EROSION CONTROL PLAN FOR THE PROJECT SHALL BE INSTALLED PRIOR TO THE START OF LAND DISTURBING ACTIVITIES ON THE PROJECT.
2. ALL EROSION CONTROL DEVICES ARE TO BE INSTALLED IN ACCORDANCE WITH THE APPROVED PLANS AND SPECIFICATIONS FOR THE PROJECT. CHANGES ARE TO BE APPROVED BEFORE CONSTRUCTION BY THE DESIGN ENGINEER AND THE CITY OF ADDISON ENGINEERING DIVISION.
3. IF THE EROSION CONTROL PLAN AS APPROVED CANNOT CONTROL EROSION AND OFF-SITE SEDIMENTATION FROM THE PROJECT THE EROSION CONTROL PLAN WILL BE REQUIRED TO BE REVISED AND/OR ADDITIONAL EROSION CONTROL DEVICES WILL BE REQUIRED ON SITE.
4. IF OFF-SITE SOIL BORROW OR SPOIL SITES ARE USED IN CONJUNCTION WITH THIS PROJECT, THIS INFORMATION SHALL BE DISCLOSED AND SHOWN ON THE EROSION CONTROL PLAN. OFF-SITE BORROW AND SPOIL AREAS ARE CONSIDERED A PART OF THE PROJECT SITE AND THEREFORE SHALL COMPLY WITH THE CITY EROSION CONTROL REQUIREMENTS. THESE AREAS SHALL BE STABILIZED WITH PERMANENT GROUND COVER PRIOR TO FINAL APPROVAL OF THE PROJECT.

Design survey provided by the owner.

As-built utilities, paving and drainage information obtained from record drawings on file with the City of Addison.

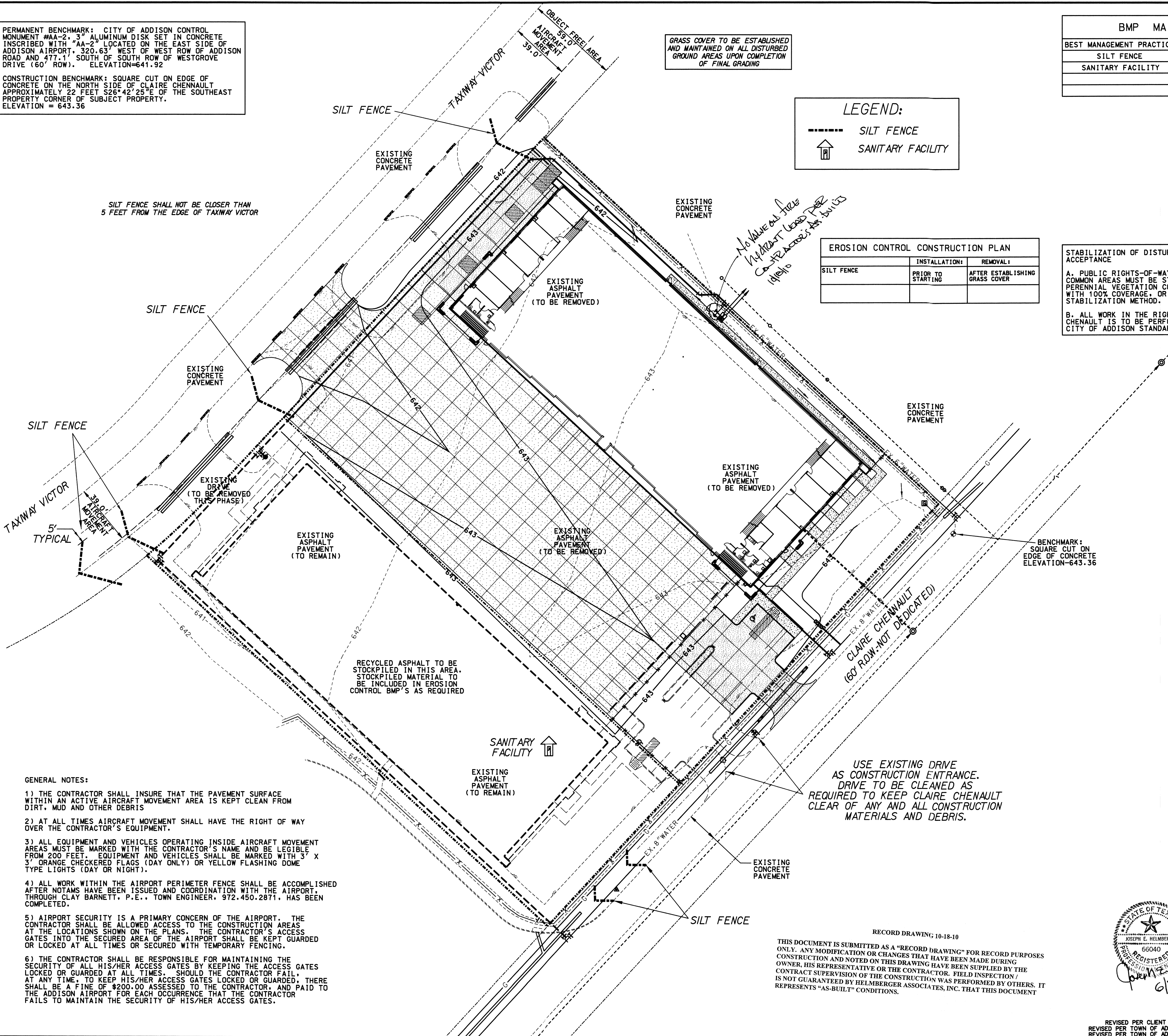

**GENERAL NOTES:**

- 1) THE CONTRACTOR SHALL INSURE THAT THE PAVEMENT SURFACE WITHIN AN ACTIVE AIRCRAFT MOVEMENT AREA IS KEPT CLEAN FROM DIRT, MUD AND OTHER DEBRIS
- 2) AT ALL TIMES AIRCRAFT MOVEMENT SHALL HAVE THE RIGHT OF WAY OVER THE CONTRACTOR'S EQUIPMENT.
- 3) ALL EQUIPMENT AND VEHICLES OPERATING INSIDE AIRCRAFT MOVEMENT AREAS MUST BE MARKED WITH THE CONTRACTOR'S NAME AND BE LEGIBLE FROM 200 FEET. EQUIPMENT AND VEHICLES SHALL BE MARKED WITH 3" X 3" ORANGE CHECKERED FLAGS (DAY ONLY) OR YELLOW FLASHING DOME TYPE LIGHTS (DAY OR NIGHT).
- 4) ALL WORK WITHIN THE AIRPORT PERIMETER FENCE SHALL BE ACCOMPLISHED AFTER NOTAMS HAVE BEEN ISSUED AND COORDINATION WITH THE AIRPORT, THROUGH CLAY BARNETT, P.E., TOWN ENGINEER, 972.450.2871, HAS BEEN COMPLETED.
- 5) AIRPORT SECURITY IS A PRIMARY CONCERN OF THE AIRPORT. THE CONTRACTOR SHALL BE ALLOWED ACCESS TO THE CONSTRUCTION AREAS AT THE LOCATIONS SHOWN ON THE PLANS. THE CONTRACTOR'S ACCESS GATES INTO THE SECURED AREA OF THE AIRPORT SHALL BE KEPT GUARDED OR LOCKED AT ALL TIMES OR SECURED WITH TEMPORARY FENCING.
- 6) THE CONTRACTOR SHALL BE RESPONSIBLE FOR MAINTAINING THE SECURITY OF ALL HIS/HER ACCESS GATES BY KEEPING THE ACCESS GATES LOCKED OR GUARDED AT ALL TIMES. SHOULD THE CONTRACTOR FAIL AT ANY TIME, TO KEEP HIS/HER ACCESS GATES LOCKED OR GUARDED, THERE SHALL BE A FINE OF \$200.00 ASSESSED TO THE CONTRACTOR, AND PAID TO THE ADDISON AIRPORT FOR EACH OCCURRENCE THAT THE CONTRACTOR FAILS TO MAINTAIN THE SECURITY OF HIS/HER ACCESS GATES.

USE EXISTING DRIVE AS CONSTRUCTION ENTRANCE. DRIVE TO BE CLEANED AS REQUIRED TO KEEP CLAIRE CHENNAULT CLEAR OF ANY AND ALL CONSTRUCTION MATERIALS AND DEBRIS.

RECORD DRAWING: 10-18-10

THIS DOCUMENT IS SUBMITTED AS A "RECORD DRAWING" FOR RECORD PURPOSES ONLY. ANY MODIFICATION OR CHANGES THAT HAVE BEEN MADE DURING CONSTRUCTION AND NOTED ON THIS DRAWING HAVE BEEN SUPPLIED BY THE OWNER. HIS REPRESENTATIVE OR THE CONTRACTOR. FIELD INSPECTION / IS NOT GUARANTEED BY HELMBERGER ASSOCIATES, INC. THAT THIS DOCUMENT REPRESENTS "AS-BUILT" CONDITIONS.



OWNER/DEVELOPER:  
EXECUTIVE HANGAR  
ATTN: DANIEL CLAASEN  
8811 SOUTH KANSAS  
SEDGWICK, KANSAS 67135  
316-282-0440

ARCHITECT:  
ALBERTSON ASSOCIATES, LLC  
9225 PEPPER TREE  
WICHITA, KANSAS 67226  
MR. JAMES R. ALBERTSON, AIA  
316-636-9472

ENGINEER:  
HELMBERGER ASSOCIATES, INC.  
TBP# REGISTRATION F-000756  
1525 BOZMAN ROAD  
WYLIE, TEXAS 75098  
JOSEPH E. HELMBERGER, PE  
972-442-7459

TOWN OF ADDISON PUBLIC WORKS NO. PW2010-01

<b>EROSION CONTROL PLAN</b>					
EXECHANGAR					
4565 CLAIRE CHENNAULT ROAD					
CITY OF ADDISON, TEXAS					
TBP# REGISTRATION F-000756		<b>HELMBERGER ASSOCIATES, INC.</b> CIVIL AND ENVIRONMENTAL ENGINEERS 1525 BOZMAN ROAD, WYLIE, TEXAS 75098 (972) 442-7459			
DESIGN	DRAWN	DATE	SCALE	NOTES	FILE
HELM.	CADD	JAN. 27, 2010	1"=30'	ERBORDER JGN	1001
					<b>NO.</b>
					<b>C6</b>

REVISED PER CLIENT COMMENT 06-24-10  
REVISED PER TOWN OF ADDISON COMMENT 03-16-10  
REVISED PER TOWN OF ADDISON COMMENT 02-19-10