

LEGEND

- 1"=20' FIRE WIDENING
- 1"=20' POWER POLE
- 1"=20' LIGHT STANDARD
- 1"=20' WATER METEER
- 1"=20' WATER VALVE
- 1"=20' CLEANOUT
- 1"=20' GAS METER
- 1"=20' PROPERTY LINE
- 1"=20' EXIST CONTOUR
- 1"=20' EXIST SPOT ELEVATION
- 1"=20' EXIST TOP OF CURB ELEVATION
- 1"=20' EXIST GUTTER ELEVATION
- 1"=20' DITCH LINE
- 1"=20' EXISTING DRAINAGE DIVIDE
- 1"=20' PROPOSED DRAINAGE LINE
- 1"=20' DRAINAGE AREA SF (6cfs)
- 1"=20' EROSION CONTROL FENCING
- 1"=20' INLET PROTECTION

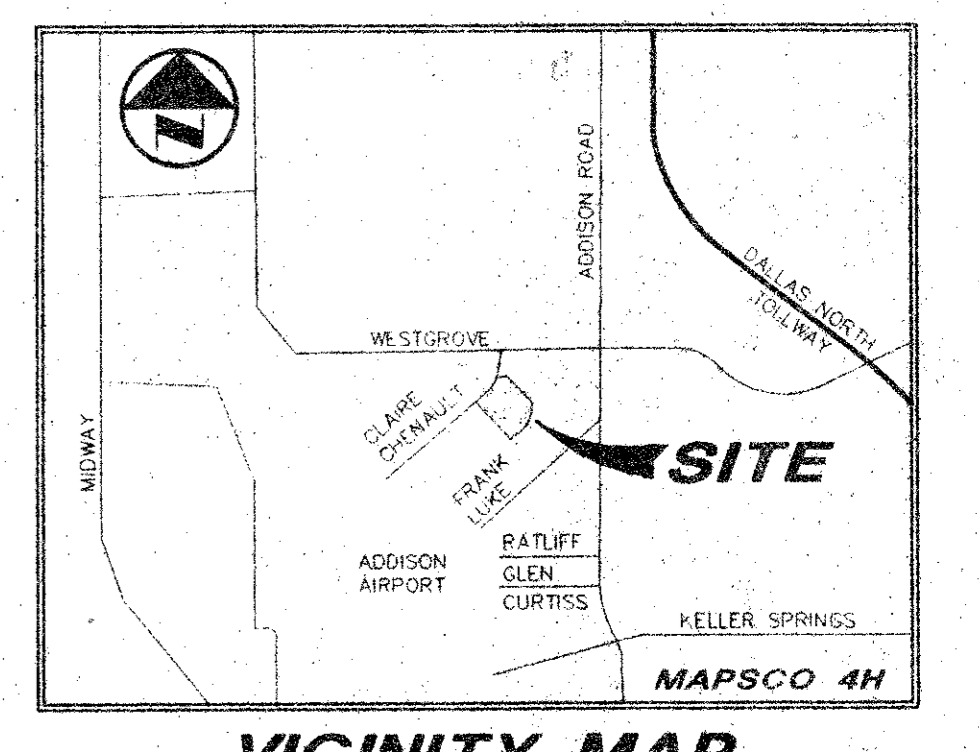

PAVING AND DRAINAGE GENERAL NOTES

1. ALL WORK, UNLESS OTHERWISE NOTED, SHALL CONFORM TO THE STANDARD SPECIFICATIONS FOR PUBLIC WORKS CONSTRUCTION, ISSUED BY THE NORTH CENTRAL TEXAS COUNCIL OF GOVERNMENTS, AND TOWN OF ADDISON STANDARD CONSTRUCTION SPECIFICATIONS.
2. UNLESS OTHERWISE NOTED, ALL CONCRETE SHALL BE CLASS "A", (3000 PSI).
3. THE HORIZONTAL AND VERTICAL LOCATIONS OF EXISTING SUBSURFACE UTILITIES HAVE BEEN DETERMINED FROM DATA RECORDED BY OTHERS. CONTRACTOR SHALL VERIFY THAT NECESSARY CROSSING CLEARANCES BETWEEN EXISTING AND PROPOSED UTILITIES EXIST PRIOR TO CONSTRUCTION OF ANY SUCH CROSSING. IT WILL BE THE RESPONSIBILITY OF THE CONTRACTOR TO PROTECT ALL PUBLIC UTILITIES IN THE CONSTRUCTION OF THIS PROJECT.
4. CONTRACTOR SHALL MAINTAIN ONE SET OF "RECORD DRAWINGS" ON SITE WHICH WILL BE SUBMITTED TO OWNER OR ENGINEER UPON COMPLETION OF THE PROJECT. RECORD DRAWINGS SHALL INDICATE THE LOCATION OF ALL SUBTERRANEAN UTILITY IMPROVEMENTS, AND INDICATE TIES TO ALL MANHOLES, CULVERTS, INLETS, JUNCTION BOXES, ETC.
5. THE CONTRACTOR IS RESPONSIBLE FOR COMPLIANCE WITH ALL FEDERAL, STATE AND LOCAL REGULATIONS REGARDING TRENCH SAFETY.
6. STORM DRAIN LINES MAY BE OF THE FOLLOWING MATERIALS:
 - a. RCP C-76, CLASS III
7. BARRICADING AND PROJECT SIGNS SHALL CONFORM TO "STATE DEPARTMENT OF HIGHWAYS AND PUBLIC TRANSPORTATION BARRICADING AND CONSTRUCTION STANDARDS."
8. PRIOR TO COMMENCEMENT OF CONSTRUCTION, BONDS AND THREE-WAY CONTRACTS SHALL BE SUBMITTED TO THE CITY AS REQUIRED.

POLLUTION CONTROL GENERAL NOTES

1. THIS PLAN HAS BEEN PREPARED TO PROVIDE MEANS TO PREVENT OR MINIMIZE POLLUTION OF STORM WATER.
2. THE CONSTRUCTION ACTIVITY INCLUDED IN THIS PLAN WILL INCLUDE:
 - A. CLEARING AND GRUBBING
 - B. ROUGH GRADING
 - C. FINAL GRADING
 - D. UTILITY INSTALLATION
 - E. PAVEMENT INSTALLATION
 - F. BUILDING CONSTRUCTION
3. THE TOTAL ESTIMATED LAND AREA TO BE DISTURBED IS 1.579 ACRES.
4. THE ESTIMATED RUNOFF COEFFICIENT UPON COMPLETION OF THE PROJECT IS 0.90X.
5. THE STORM WATER EXISTING THE SITE IS COLLECTED IN AN EXISTING DRAINAGE SYSTEM MAINTAINED BY THE CITY OF DALLAS, TEXAS.
6. THE SOILS ON THE SITE ARE GENERALLY EXPANSIVE CLAYS.
7. THE CONTRACTOR SHALL PROVIDE EROSION PROTECTION AROUND THE WORK AREA PERIMETER AND AT ALL INLET MOUTHS DURING CONSTRUCTION.
8. THE CONTRACTOR WILL REMOVE ALL EXCESS SOIL FROM CONSTRUCTION VEHICLES PRIOR TO EXITING THE SITE.
9. ALL DISTURBED AREAS WHICH WILL NOT BE RE-DISTURBED FOR A MINIMUM OF 21 DAYS MUST BE STABILIZED BY THE CONTRACTOR TO CONTROL EROSION.
10. THE CONTRACTOR SHALL UNDERTAKE PROPER METHODS TO REDUCE DUST GENERATION FROM THE SITE.
11. THE CONTRACTOR MUST COMPLY WITH FEDERAL, STATE AND LOCAL REGULATIONS REGARDING SEDIMENT AND EROSION CONTROL.
12. A COPY OF THIS PLAN MUST BE KEPT AT THE CONSTRUCTION FACILITY DURING THE ENTIRE CONSTRUCTION PERIOD.

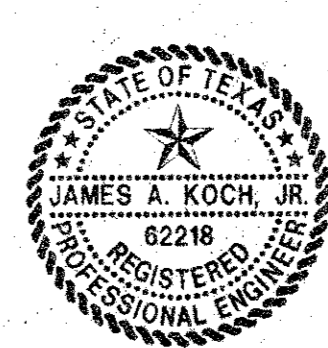

THIS DOCUMENT IS RELEASED FOR THE PURPOSE OF INTERIM REVIEW UNDER THE AUTHORITY OF JAMES A. KOCH JR., P.E., 62218 ON 09/12/97. IT IS NOT TO BE USED FOR CONSTRUCTION, BIDDING OR PERMIT PURPOSES.

PACHECO KOCH Consulting Engineers, Inc.
9401 LBJ Freeway, Suite 300
Dallas, Texas 75243
(972) 236-3031
Civil Engineering • Land Surveying

GRADING & DRAINAGE PLAN
MISSION PROPERTIES HANGAR
4550 CLAIRE CHENAULT ROAD
ADDISON AIRPORT
TOWN OF ADDISON, TEXAS

DESIGN	DRAWN	DATE	SCALE	NOTES	FILE	NO.
JAK	CHI/MWA	JULY 1997	1"=20"			C-1

DRAINAGE AREA CALCULATIONS

DA	A	C	I ₁₀₀	Q
1	0.62	0.8	8.74	4.36
2	0.18	0.8	8.74	1.26
3	0.79	0.8	8.74	5.52
4	0.37	0.8	8.74	2.60

BENCHMARK LISTING

BM #1	"C" CUT ON THE NORTHWEST CORNER OF THE SUBJECT TRACT.	ELEV. 641.66
BM #2	"C" CUT ON THE FIRST STEP ON THE EAST CORNER OF 4559 WESTGROVE ROAD.	ELEV. 644.46