

CONSTRUCTION NOTES:
(STA. 61+51 to 67+81 See Typ. Detail Sht.)

The following notes correspond by station number with the appropriate typical detail drawing.

1. Saw And Remove Existing Asphalt Required To Construct The Water Line With Appurtenances, As Shown With Typical Detail Drawing.
2. Replace With 5" Thick Asphalt, As Shown With Typical Detail Drawing. Pay Item No. 101.2

PI. STA. 63+55.48
 $\Delta = 18^\circ 30' 00''$
Install 1-24" 18.5° Horz Bend Complete In Place

CAUTION!
Water Line
Gas Line
Do Not Disturb

STA. 61+51 to STA. 63+56
1. Saw And Remove Existing Asphalt See Detail Sheet
2. Replace With 5" Thick Asphalt. See Detail Sheet. Pay Item No. 101.2

Remove & Replace Exist. 24" RCP To Prior To Construction. Not A Separate Pay Item. Include in Item No. 101.2

STA. 66+18 to STA. 66+53
1. Saw And Remove Existing Asphalt. See Detail Sheet
2. Replace With 5" Thick Asphalt. See Detail Sheet. Pay Item No. 101.2

NOTE:

1. Contractor Shall Determine The Exact Location And Depth Of The Underground Utilities Shown Prior To Construction By Contacting The Utility Companies. The Utility Elevations Shown Are Only Approximate.
2. Contractor Shall Be Responsible For Any Utility Damages Resulting From Construction.
3. Contractor Shall Repair Or Replace Any Damaged Utility Equal To Or Better Than The Original Condition At No Additional Compensation.

Water Line Curve Data:

$\Delta = 110^\circ 12' 00''$
 $R = 75.00'$
 $L = 144.25'$
 $T = 107.51'$

NOTE:

Block All Bends, Tees And Plugs As Required By Appurtenances. See Typical Detail Sheet.

B.M. "□" Plus Mark # 22 At Sta. 61+95± On Celestial Rd. Elev. 596.59

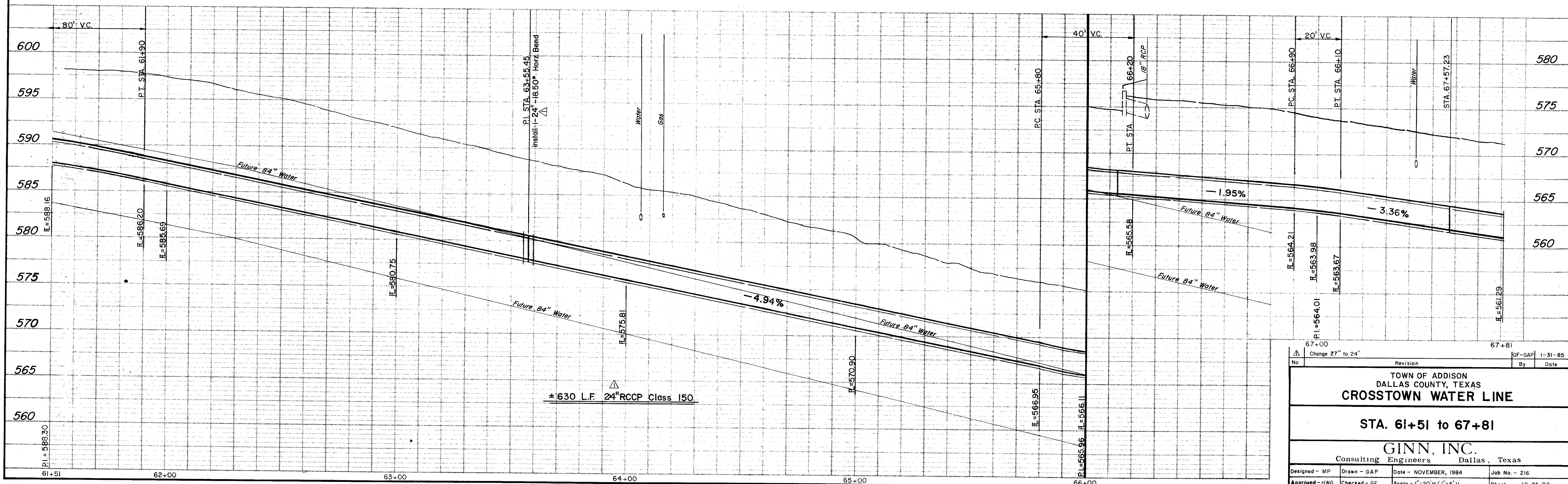

No.	Revision	GF-GAP	1-31-85
1	Change 27" to 24"	By	Date
TOWN OF ADDISON DALLAS COUNTY, TEXAS CROSTOWN WATER LINE			
STA. 61+51 to 67+81			
GINN, INC. Consulting Engineers Dallas, Texas			
Designed - MP	Drawn - GAP	Date - NOVEMBER, 1984	Job No. - 216
Approved - HWG	Checked - GF	Scale - 1"=20'H/1"=5'V	Sheet 12 OF 20