

c:\cadd\94010.2\2\sh1\abt\ccp01.0
 02 MAR 98
 DART-TBL
 \$(USER)

1000-900 DWG No. 9AD

BROADWAY STREET

TBM-1

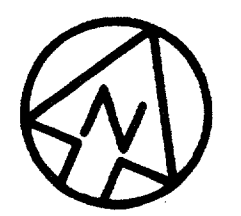

SCALE (IN FEET)
 0 20 40 80

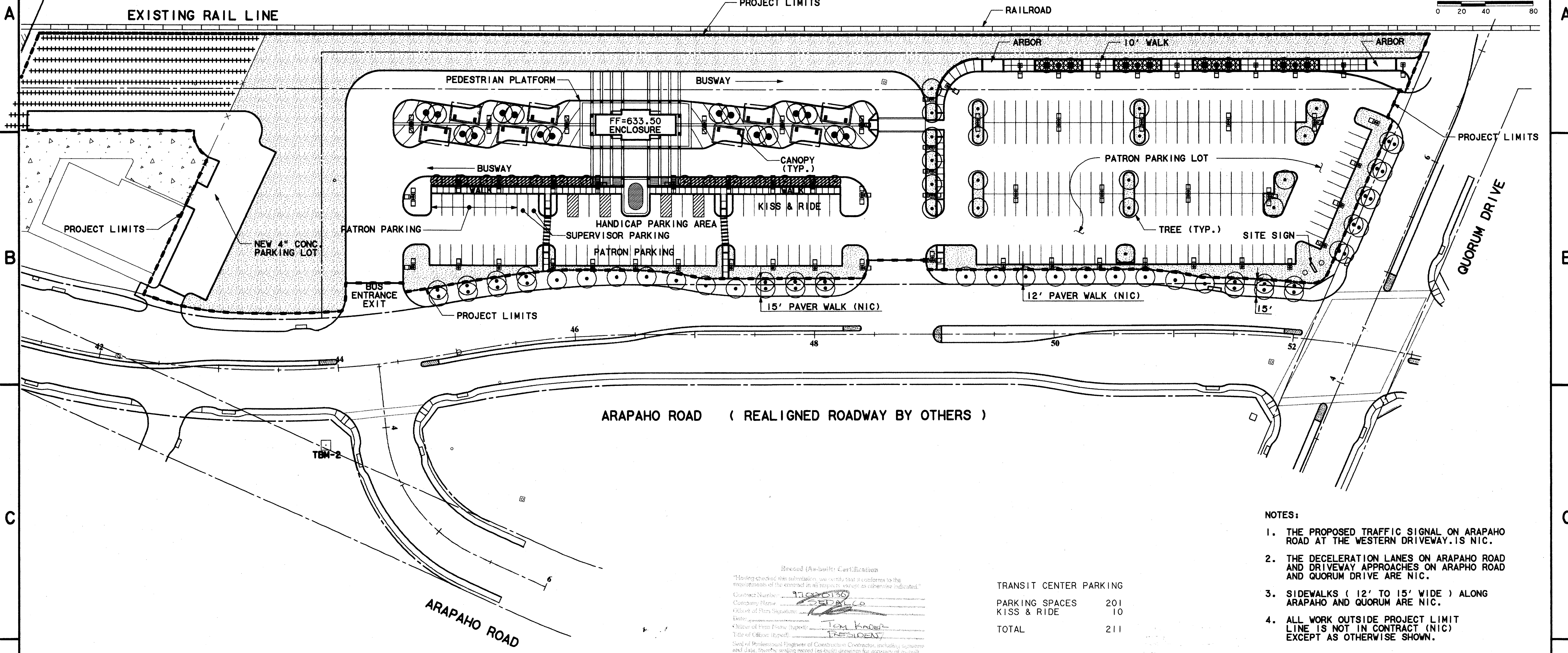

ARAPAHO ROAD (REALIGNED ROADWAY BY OTHERS)

TBM-2

- NOTES:
1. THE PROPOSED TRAFFIC SIGNAL ON ARAPAHO ROAD AT THE WESTERN DRIVEWAY IS NIC.
 2. THE DECELERATION LANES ON ARAPAHO ROAD AND DRIVEWAY APPROACHES ON ARAPAHO ROAD AND QUORUM DRIVE ARE NIC.
 3. SIDEWALKS (12' TO 15' WIDE) ALONG ARAPAHO AND QUORUM ARE NIC.
 4. ALL WORK OUTSIDE PROJECT LIMIT LINE IS NOT IN CONTRACT (NIC) EXCEPT AS OTHERWISE SHOWN.

TRANSIT CENTER PARKING

PARKING SPACES	201
KISS & RIDE	10
TOTAL	211

Based (As-built) Certification
 "Having checked the submission, we certify that it conforms to the requirements of the contract in all respects except as otherwise indicated."
 Contract Number: 97000136
 Company Name: WENDY LOPEZ & ASSOCIATES, INC.
 City and State: DALLAS, TEXAS
 Title of Client (Project): ADDISON TRANSIT CENTER
 Name of Firm (Signature): Tom Kader
 Title of Client (Typed): PRESIDENT
 I am a Professional Engineer of Construction Contractor, including signature and date, thereby making record (as-built) drawings for accuracy of as-built conditions reflected herein, must be placed before.

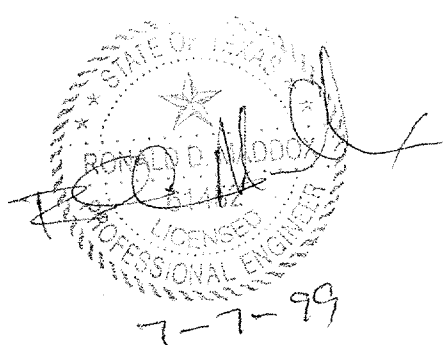

CONFORMED

CONTRACT SHEET No. 11 OF 95

ADDISON
 TRANSIT CENTER
 SITE PLAN

REV	DATE	DESCRIPTION	BY	ENG	CHK	APP	REV	DATE	DESCRIPTION	BY	ENG	CHK	APP
△							△						
△							△						
△							△						
△							△						
△							△						

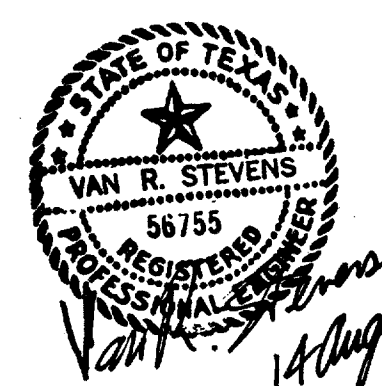

WENDY LOPEZ & ASSOC.
 LOCKWOOD, ANDREWS & NEWNAM
 THE SWA GROUP
 GERARD & ASSOCIATES
 ZAXON

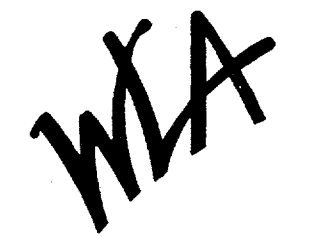

WENDY LOPEZ & ASSOCIATES, INC.
 ENGINEERING • SURVEYING • CONSTRUCTION SERVICES
 825 MARKET CENTER BLVD - SUITE 200
 DALLAS, TEXAS 75207
 (214) 748-7777

DART PROJECT



SCALE	1"=40'
DRAWN	D. KRUCIAK
DESIGNED	P. ZHAO
CHECKED	V. STEVENS
IN CHARGE	V. STEVENS
DATE	AUG. 14, 1997



CONTRACT C-97000136

DWG No. CC5-0001

REV 0