

GENERAL NOTES

Designed according to AASHTO 1977 Standard and Interim Specifications thru 1987 for a HS20-44 or alternate military loading. Bridge protective assemblies shall be attached to the outside face of exterior beams to points six inches beyond the roadway centerline and curb at locations shown. For details, see Standard Drawing No. 29. For details of concrete riprap, see Standard Drawing No. 21. For approach slab details, see Standard Drawing No. 22. For traffic rail and traffic barrier details, see Standard Drawing Nos. 30, 31 & 32. Horizontal dimensions are shown and lengths must be corrected for grade or cross slope, where appropriate. For details of Walls W-III & W-12, see Sheets W-3, W-4 & W-5. See Roadway Plans for location of light poles.

ITEM NO.	DESCRIPTION	UNIT	QUANTITY
416	Drilled Shaft (30"Ø)	L.F.	235
416	Drilled Shaft (42"Ø)	L.F.	199
421	Class C Concrete (Abutment)	CY	123.4
421	Class C Concrete (Bent)	CY	156.9
422	Reinforced Concrete Slab	S.F.	23,496.7
425	Prestressed Concrete Beams (Type C)	L.F.	3,568.00
432	Concrete Riprap (Class B)	CY	115.2
436	Preformed Joint Seal (2')	L.F.	198
440	Reinforcing Steel	Lb.	73,247
442	Sir. SH (HYC) (Armor Jt.)	Lb.	5,422
444	Bridge Protective Assembly	Ea.	4
450	Traffic Rail, Type T5	L.F.	457.0
514	Concrete Traffic Barrier (Type I)	L.F.	228.5
556	Filter Material (Type D)	CY	54.6
618	Conduit (Rigid Metal)(1 in.)	L.F.	204

ESTIMATED QUANTITY SUMMARY

NOTE: The information shown on this drawing concerning type and location of underground utilities is not guaranteed to be accurate or all inclusive. The Contractor is responsible for checking his own determinations as to type and location of underground utilities as may be necessary to avoid damage thereto. The Contractor shall verify location of underground pipe lines, conduits, and structures by contacting owners of underground utilities and by prospecting in advance of excavation operations.

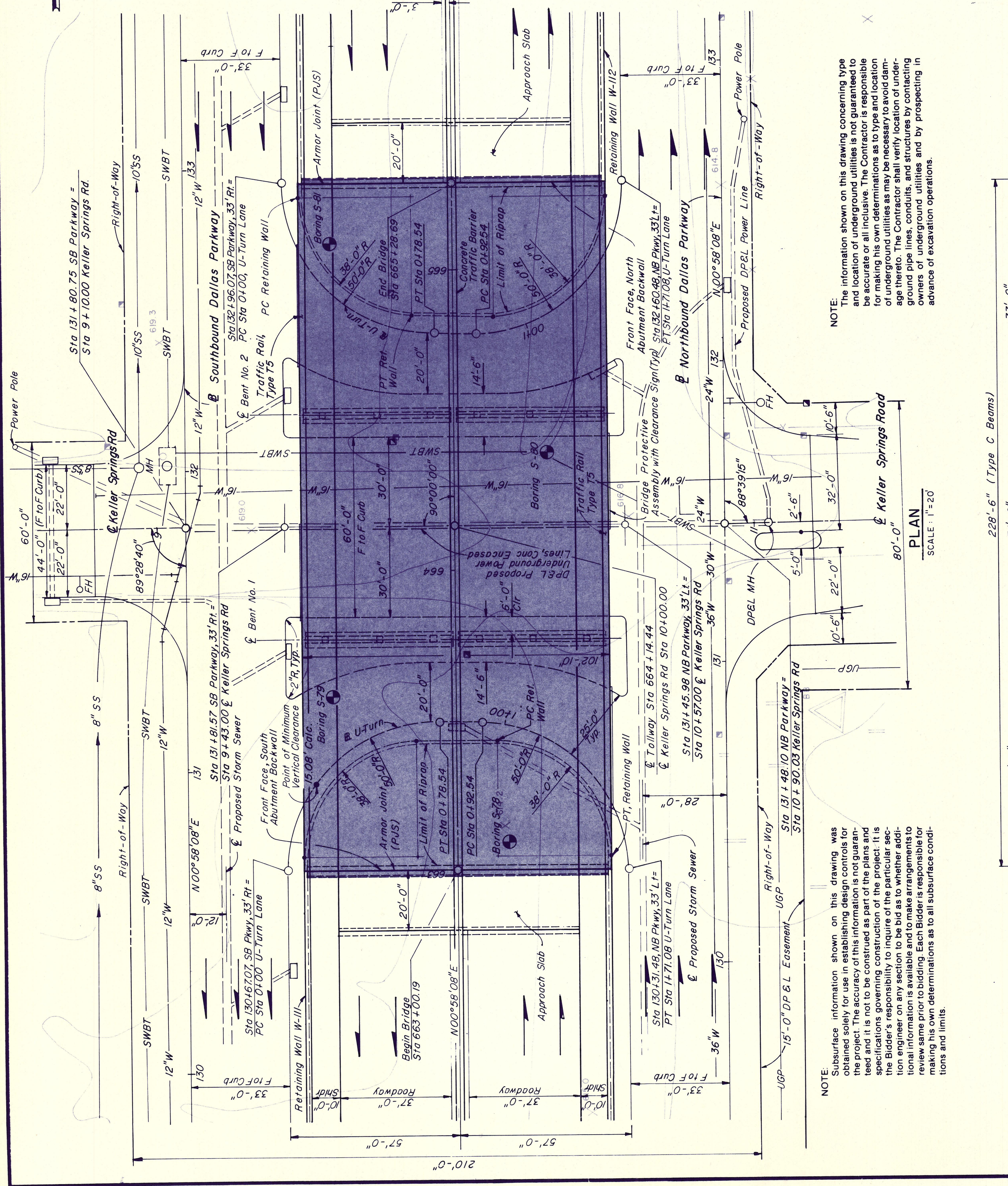

PLAN
SCALE: 1"=20'

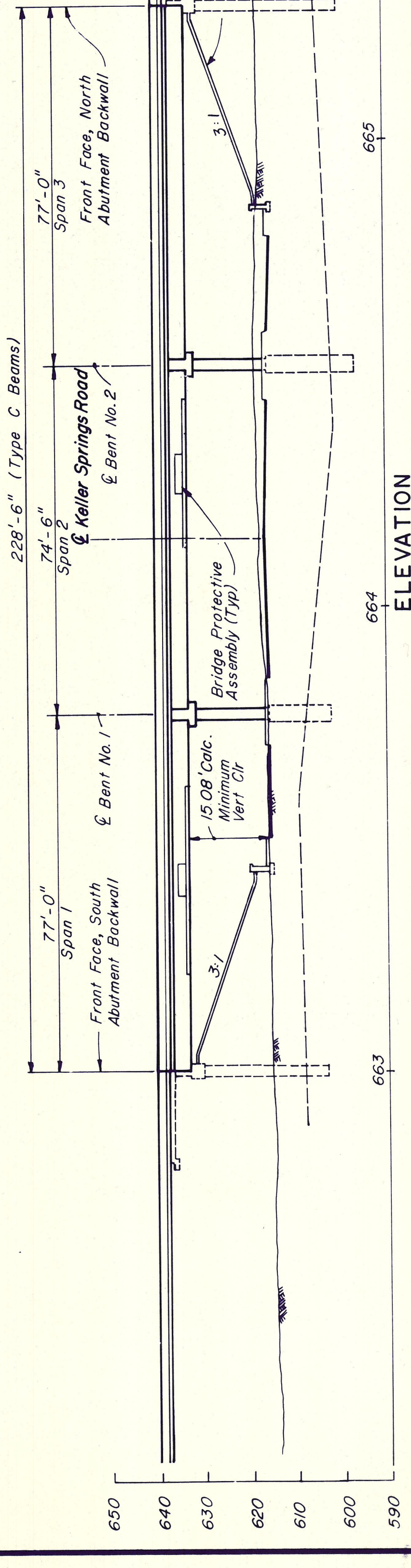

ELEVATION
SCALE: 1"=20'

Datum: Chiseled "O" on end of curb radius at first drive on north side of Keller Springs Road, 150' east of United Fidelity Bldg, 500' west of Dallas Parkway. Elevation: 626.24

NO.	REVISION	BY	DATE
TEXAS TURNPIKE AUTHORITY DALLAS NORTH TOLLWAY			
KELLER SPRINGS ROAD OVERPASS GENERAL PLAN AND ELEVATION			
Gibbs & Hill, Inc. ENGINEERS - DESIGNERS - CONSTRUCTORS DALLAS			SECTION VII
DRAWN	CHKD	DESIGNED	DATE
REF	REF	REF	5/23/83
DATE	DATE	DATE	5/16/83
SCALE	SCALE	SCALE	1"=20'-0" Hor. 1"=10'-0" Vert.
CONTRACT NO. DNT-115			SHEET 51 OF 52