

**ESTIMATED QUANTITY SUMMARY**

LOCATION	ITEM NO.	DESCRIPTION	UNIT	QUANTITY
WALL W - 113	423	RETAINING WALL (OPTIONAL)	S.F.	30,441.8
WALL W - 113	556	PIPE UNDERDRAIN(6") (NRCP)	L.F.	22

**OUTFALL NOTE**  
 NRCP shall be used between the footing toe and the pipe. Outfall shall have a minimum slope of 0.5%.

**GENERAL NOTES:**

- For retaining wall design and details, see Standard Drawing No. 40 & 41.
- For concrete riprap details, see Standard Drawing No. 21.
- For south abutment details, see Sheet S12.
- Wall lengths are given along front face of wall.
- Denotes match points.

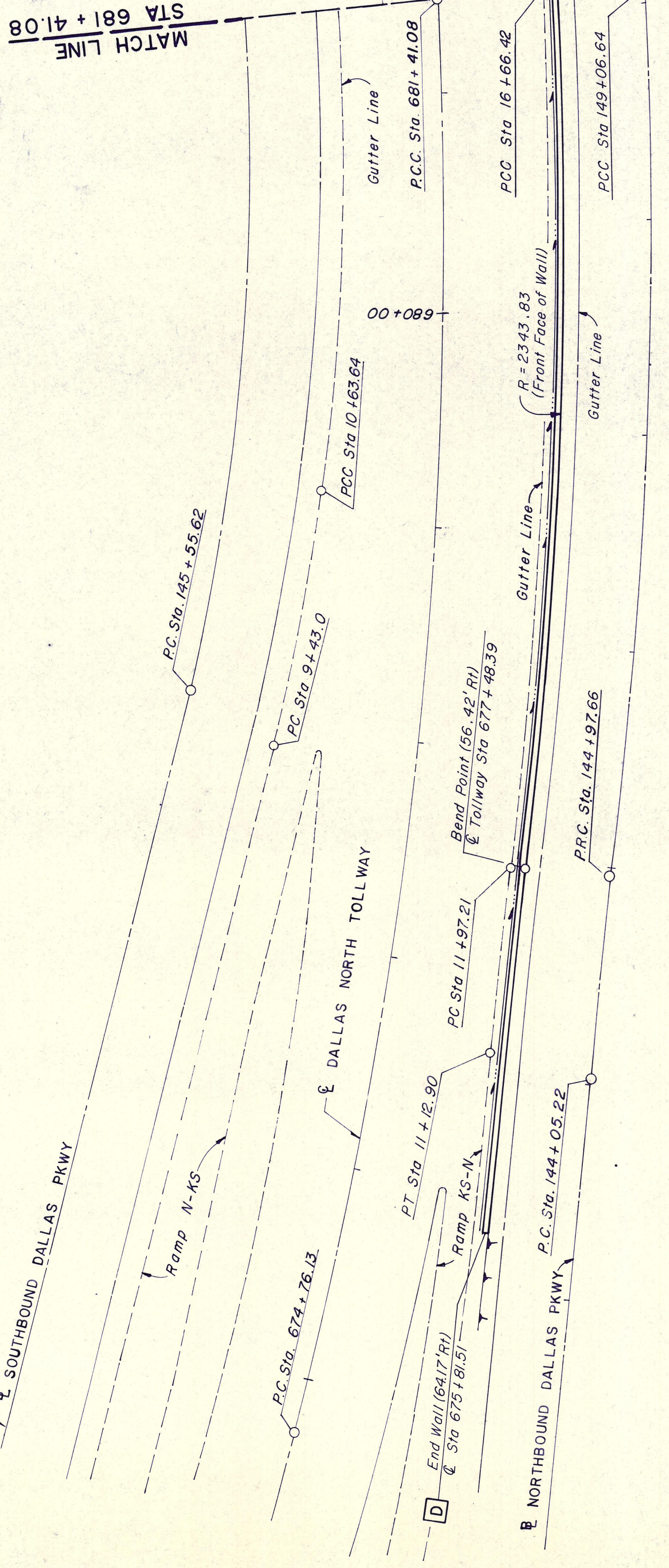

NO.	REVISION	BY	DATE
<b>TEXAS TURNPIKE AUTHORITY</b>			
<b>DALLAS NORTH TOLLWAY</b>			
<b>WESTGROVE DRIVE OVERPASS</b>			
<b>SOUTH ABUTMENT RETAINING WALL</b>			
<b>PLAN</b>			
<b>Gibbs &amp; Hill, Inc.</b>			<b>SECTION VII</b>
<small>ENGINEERS CONSTRUCTORS DALLAS</small>			<small>DESIGNED REF. DATE 9/26/83</small>
<small>DRAWN MAY</small>	<small>CHECKED REF.</small>	<small>DATE 10/3/83</small>	<small>SCALE 1" = 40'</small>
<b>CONTRACT NO. DNT-115</b>			<b>SHEET W6 OF W12</b>