

NOTES:

1. See Volume 2 Plans For Bridge Details
2. See Volume 2 Plans For Approach Slab Details
3. See Sheets 19 Thru 20 For Additional Horiz. & Vert. Details
4. See Volume 2 Plans For Retaining Wall Details
5. Contours Shown Are Supplementary To Profile Sheets And Are Finished Top Of Pavement Elevations.
6. Existing Trees And Bricks In Median To Be Removed By The Town Of Addison. The Contractor Shall Notify The Town Of Addison Prior To Construction Of B.L. Road.

LEGEND

- TOLLWAY AND RAMP JOINTS**
- SC - Construction
 - LC - Longitudinal Construction w/ Tie Bar
 - SL - Sawed Longitudinal
 - L - Longitudinal Construction w/o Tie Bar
 - E - Transverse Expansion
 - S - Sawned Dummy
 - SP - Special Construction Joint
 - C - Construction
 - E - Transverse Expansion
 - (7) - Horizontal Curve Number
 - A70 - Inlet Number
- SERVICE ROADS AND STREET JOINTS**

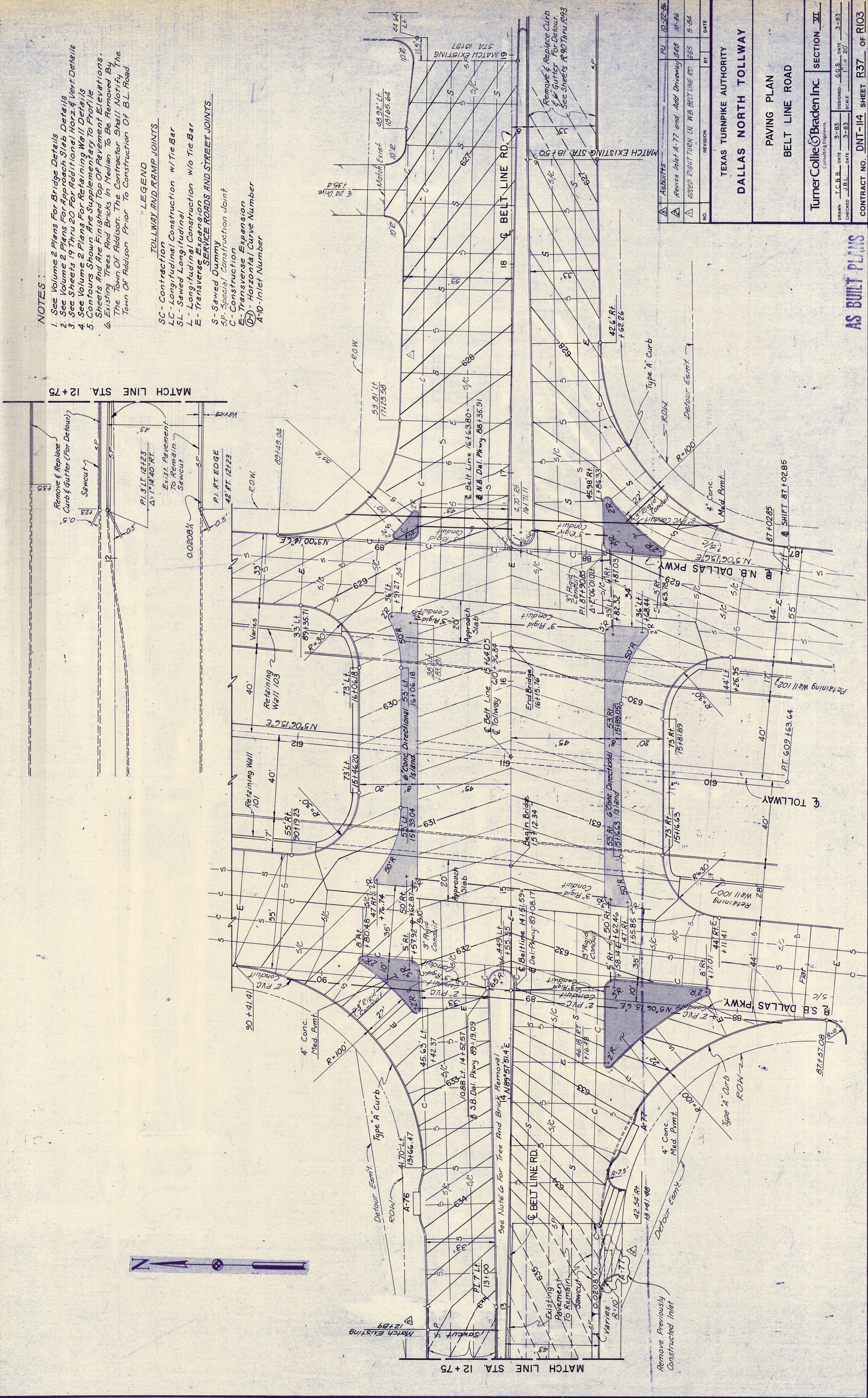

NO.	REVISION	BY	DATE
1	AS BUILT		10-22-86
2	Revise Inlet A-77 and Add Driveway R&S		10-86
3	ADDED RIGHT TURN LN. WB BELT LINE RD. R&S		5-84

TEXAS TURNPIKE AUTHORITY
DALLAS NORTH TOLLWAY

PAVING PLAN
 BELT LINE ROAD

TurnerCollieBraden Inc.
 Consulting Engineers

SECTION VI

DRAWN: J.C.B. DATE: 3-83 DESIGNED: S.G.S. DATE: 3-83
 CHECKED: J.B.L. DATE: 3-83 SCALE: 1" = 20'

CONTRACT NO. DNT-114 SHEET R37 OF R103

AS BUILT PLANS