

**NOTES:**

1. See Volume 2 Plans For Bridge Details
2. See Volume 2 Plans For Approach Slab Details
3. See Sheets 19 Thru 20 For Additional Horz. & Vert Details
4. See Volume 2 Plans For Retaining Wall Details
5. Contours Shown Are Supplementary To Profile Sheets And Are Finished Top Of Pavement Elevations.
6. Existing Trees And Bricks In Median To Be Removed By The Town Of Addison. The Contractor Shall Notify The Town Of Addison Prior To Construction Of B.L. Road.

**LEGEND**

- TOLLWAY AND RAMP JOINTS**
- SC - Contraction
  - LC - Longitudinal Construction w/ Tie Bar
  - SL - Sawed Longitudinal
  - L - Longitudinal Construction w/o Tie Bar
  - E - Transverse Expansion
  - SE - Service Roads AND STREET JOINTS
  - S - Sawn Dummy
  - SP - Special Construction Joint
  - C - Construction
  - E - Transverse Expansion
  - (D) - Horizontal Curve Number
  - A-10 - Inlet Number

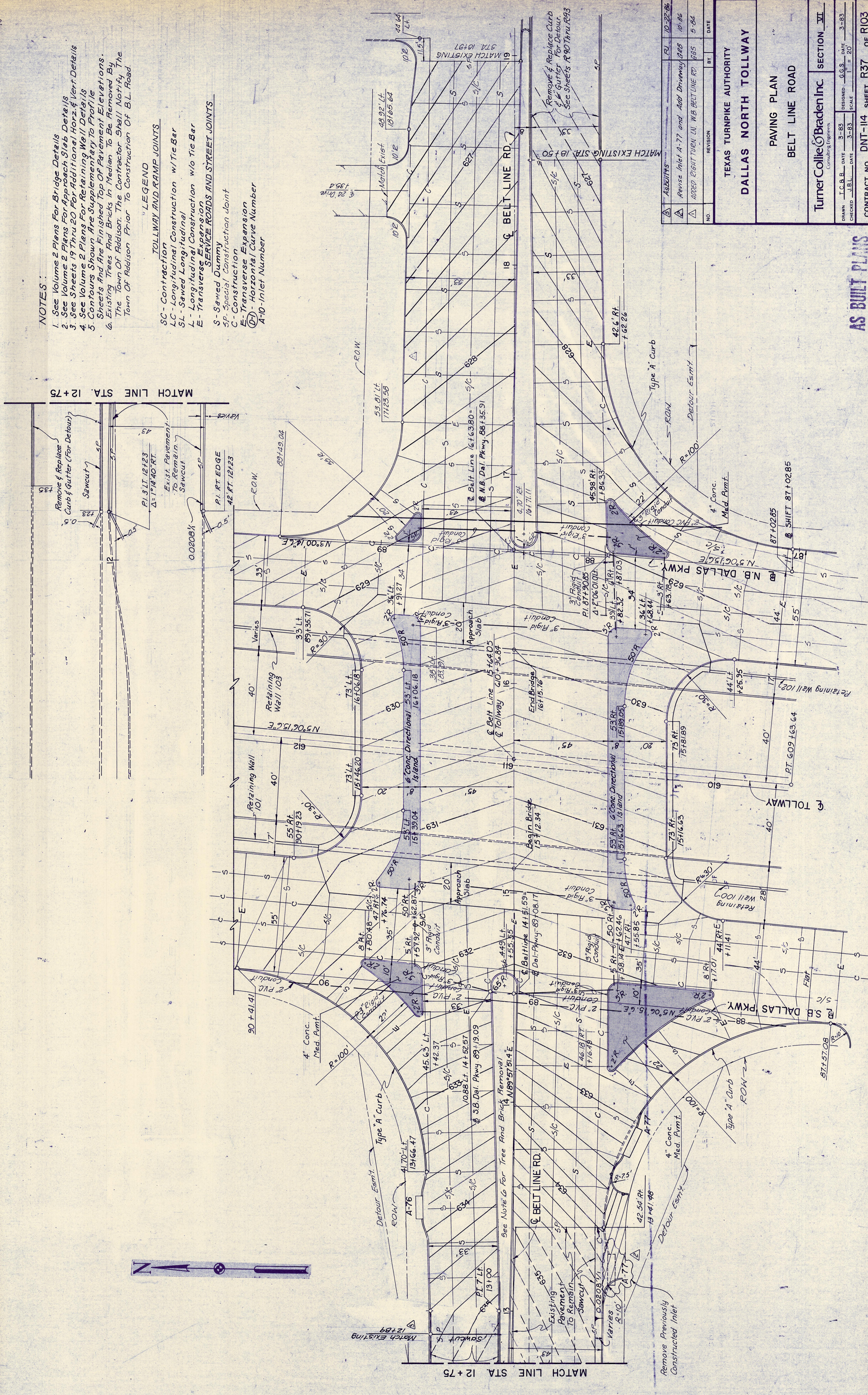

NO.	REVISION	BY	DATE
1	AS BUILT		10-22-86
2	Revise Inlet A-77 and Add Driveway 825		10-86
3	ADDED EIGHT TUNNELS IN WB BELT LINE RD. 1985		5-84

TEXAS TURNPIKE AUTHORITY  
**DALLAS NORTH TOLLWAY**

PAVING PLAN  
 BELT LINE ROAD

TurnerCollieBraden Inc.  
 Consulting Engineers

SECTION VI

DRAWN: J.C.B.B. - DATE: 3-83 DESIGNED: G.C.S. - DATE: 3-83  
 CHECKED: J.B.L. - DATE: 3-83 SCALE: 1" = 20'

CONTRACT NO. DNT-114 SHEET R37 OF R103

**AS BUILT PLANS**