

| TABLE OF ESTIMATED QUANTITIES |                     |                    |                   |                           |
|-------------------------------|---------------------|--------------------|-------------------|---------------------------|
| SPAN                          | REINF CONCRETE SLAB | CLASS "S" CONCRETE | TOTAL REINF STEEL | STRUC STEEL (ARMOR JOINT) |
|                               | SF                  | CY                 | Lb                | Lb                        |
| 1                             | 355                 | 8.5                | 2307              | ?                         |
| 2                             | 621                 | 14.9               | 4036              | 0                         |
| 3                             | 887                 | 21.2               | 5766              | ?                         |
| TOTAL                         | 1863                | 44.6               | 12109             | ?                         |

| BAR TABLE |      |
|-----------|------|
| BAR       | SIZE |
| A         | #5   |
| B         | #5   |
| D, D1, D2 | #5   |
| G         | #5   |
| H         | #5   |
| J         | #5   |
| M         | #5   |
| T         | #4   |

LENGTH SHOWN IS BOTTOM BEAM FLANGE LENGTH WITH ADJUSTMENT MADE FOR BEAM SLOPE.

LENGTH SHOWN IS BOTTOM BEAM FLANGE LENGTH WITH ADJUSTMENT MADE FOR BEAM SLOPE.

**GENERAL NOTES:**

- DESIGNED ACCORDING TO AASHTO 2002 STANDARD AND CURRENT INTERIM SPECIFICATIONS.
- SEE IBTS STANDARD FOR THICKENED SLAB END DETAILS AND QUANTITY ADJUSTMENTS.
- SEE PCP STANDARD FOR DETAILS AND QUANTITY ADJUSTMENTS IF EITHER OF THESE OPTIONS ARE USED.
- ALL REINFORCING STEEL SHALL BE GRADE 60. CONCRETE STRENGTH  $f'_c = 4,000$  PSI. BAR LAPS WHERE REQUIRED, SHALL BE AS FOLLOWS:  
UNCOATED = #4 = 1'-5"  
#5 = 1'-9"
- ALL NEW REINFORCING TO BE EPOXY COATED.

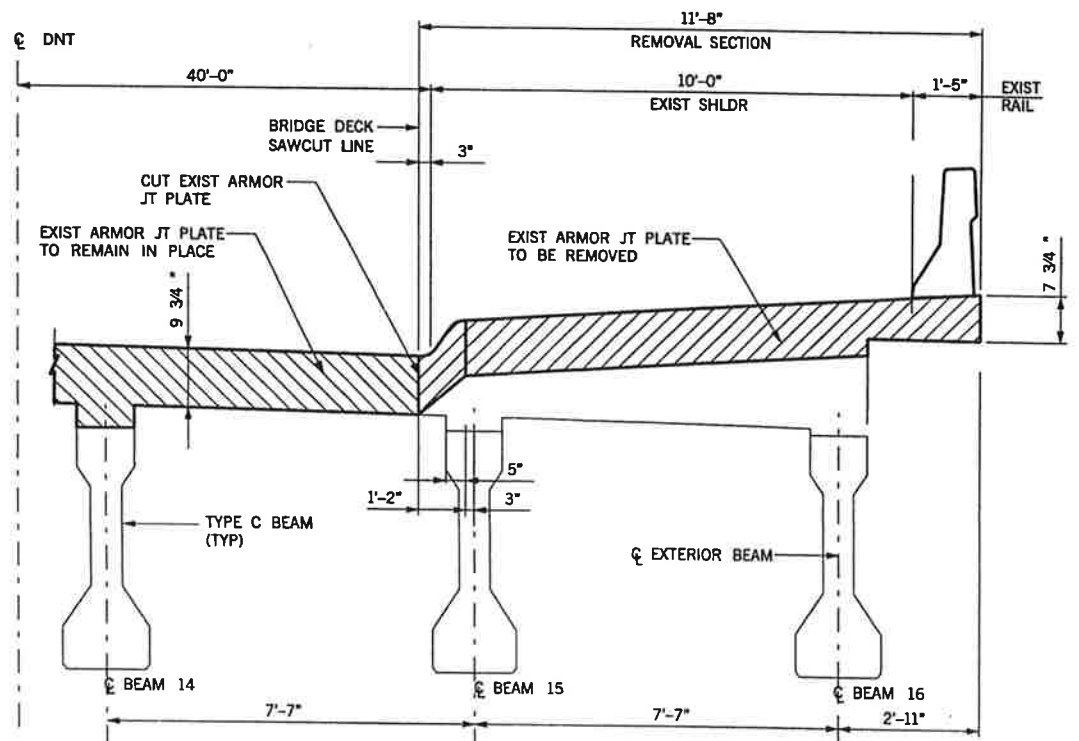
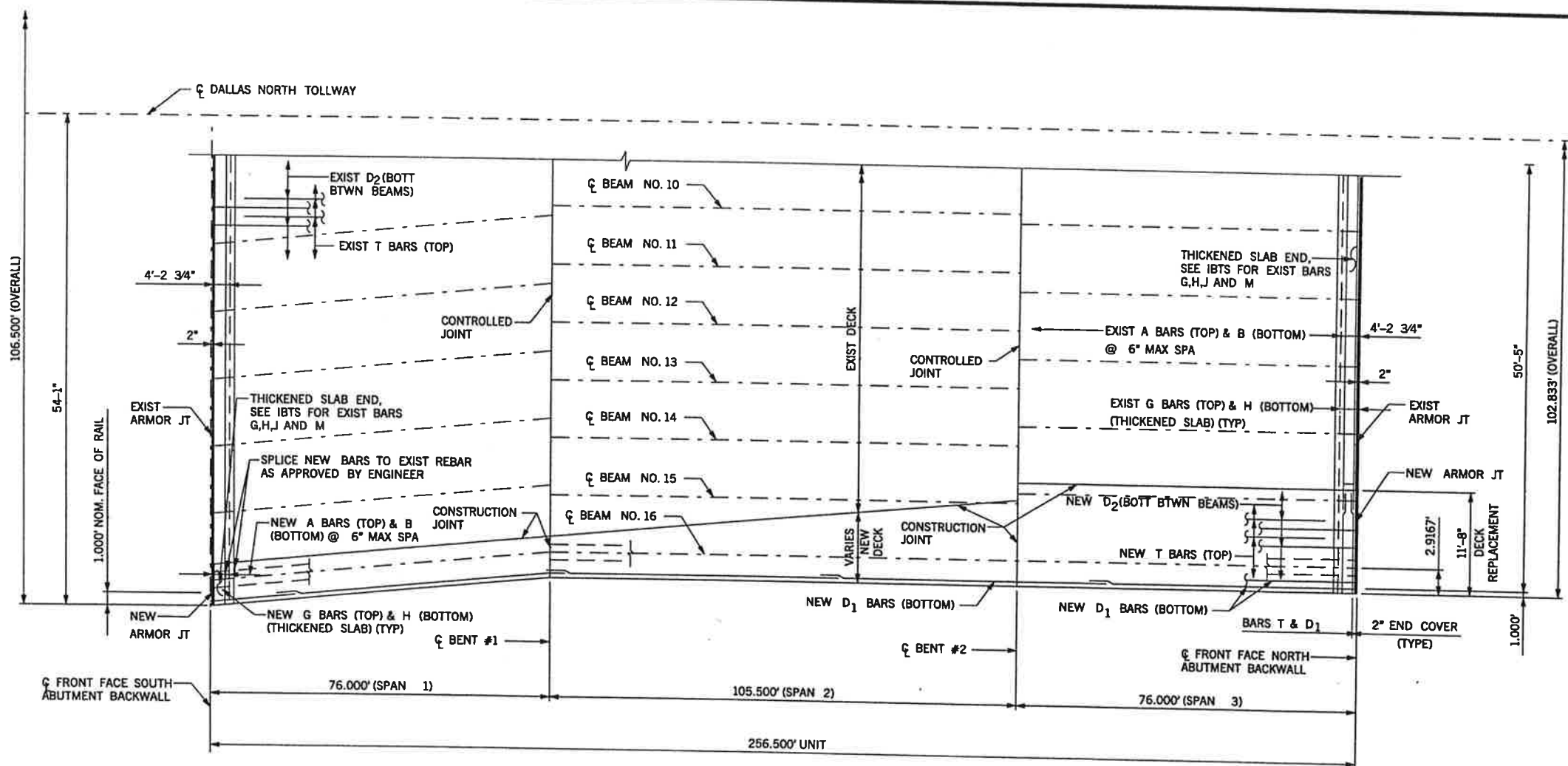

ARMOR JOINT REMOVAL DETAIL  
SCALE: 1/4" = 1'-0"

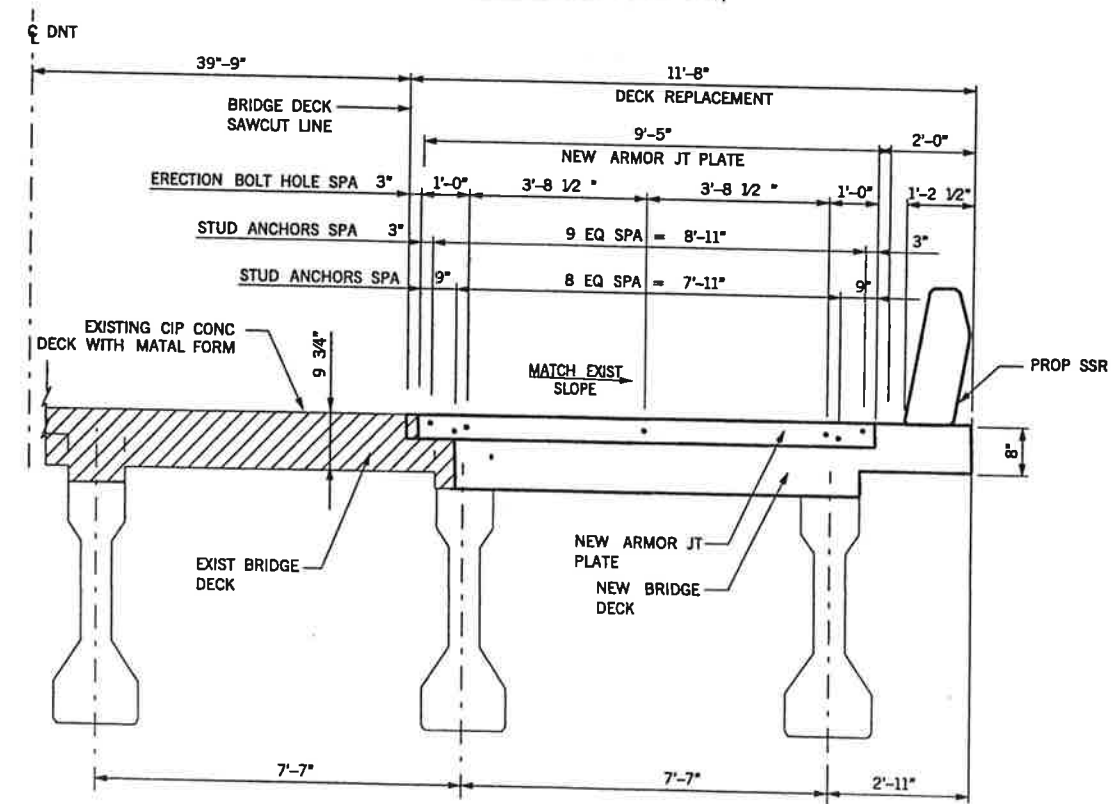

ARMOR JOINT REPLACEMENT DETAIL  
SCALE: 1/4" = 1'-0"

*Frank H. Olshefski*  
9/27/05



|  |      |               |                           |
|--|------|---------------|---------------------------|
| NO.  | DATE | REVISION      | APPROV.                   |
| DALLAS NORTH TOLLWAY   |      |               |                           |
| <b>NITA</b><br>NORTH TEXAS TOLLWAY AUTHORITY   |      |               |                           |
| PRE STRESSED CONCRETE<br>I-BM SPAN (TYPE C)<br>WEST GROVE OVERPASS<br>SHOULDER REPLACEMENT |      |               |                           |
| <b>PATE ENGINEERS</b><br>13322 N.W. Freeway, Suite 300, Dallas, TX, Phone: 714-465-9170    |      |               | STM #7 & #8<br>PLAN SET A |
| DRAWN  | KMH  | DATE 09-02-05 | DESIGNED DD DATE 09-02-05 |
| CHECKED  | RR   | DATE 09-02-05 | SCALE                     |
| CONTRACT NO. 02039-DNT-02-CN-EN A170 OF A247   |      |               |                           |

PATE ENGINEERS  
 6:14:16 PM  
 9/27/05  
 x:\1308001\001\plans\diff\diff\02\02.dgn  
 L:\P\952-384.PLT