

8/30/2005 12:36:33 PM K:\PROJECTS\2050401\DNT-STM_CIF231\Sheets\Bridge Modification Plans\VerdeValley\d07bbvvs01.dgn

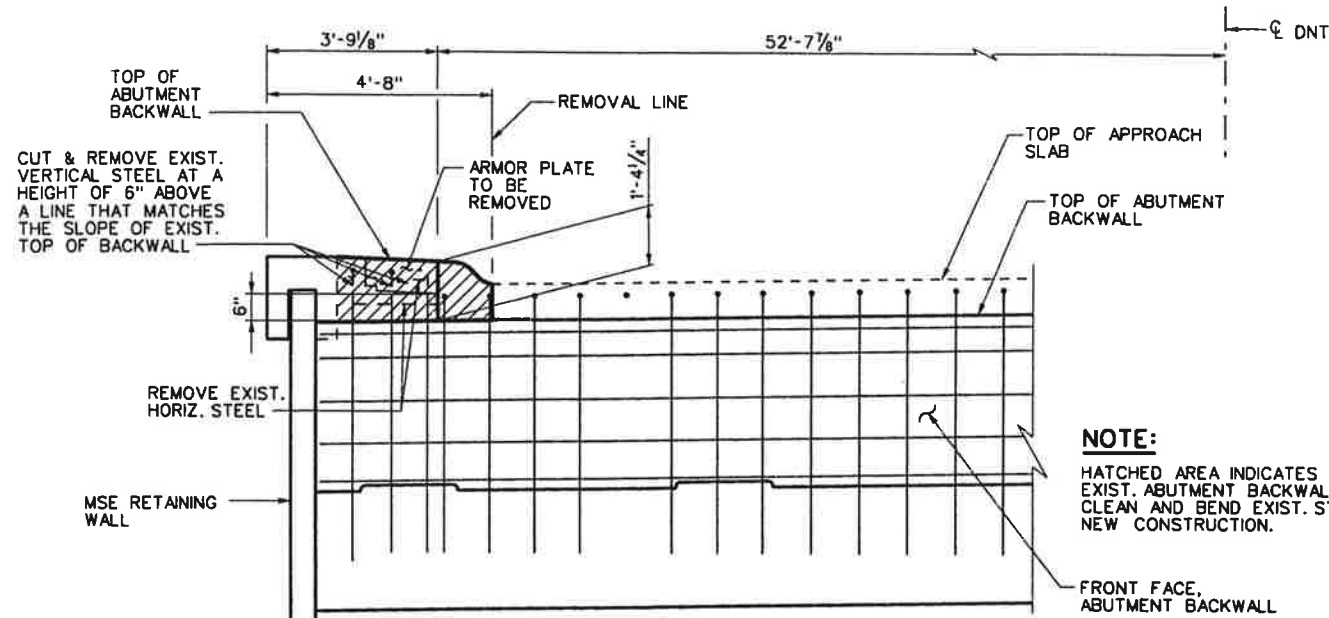

ABUTMENT BACKWALL REMOVAL DETAIL
SCALE: 1/4" = 1'-0"

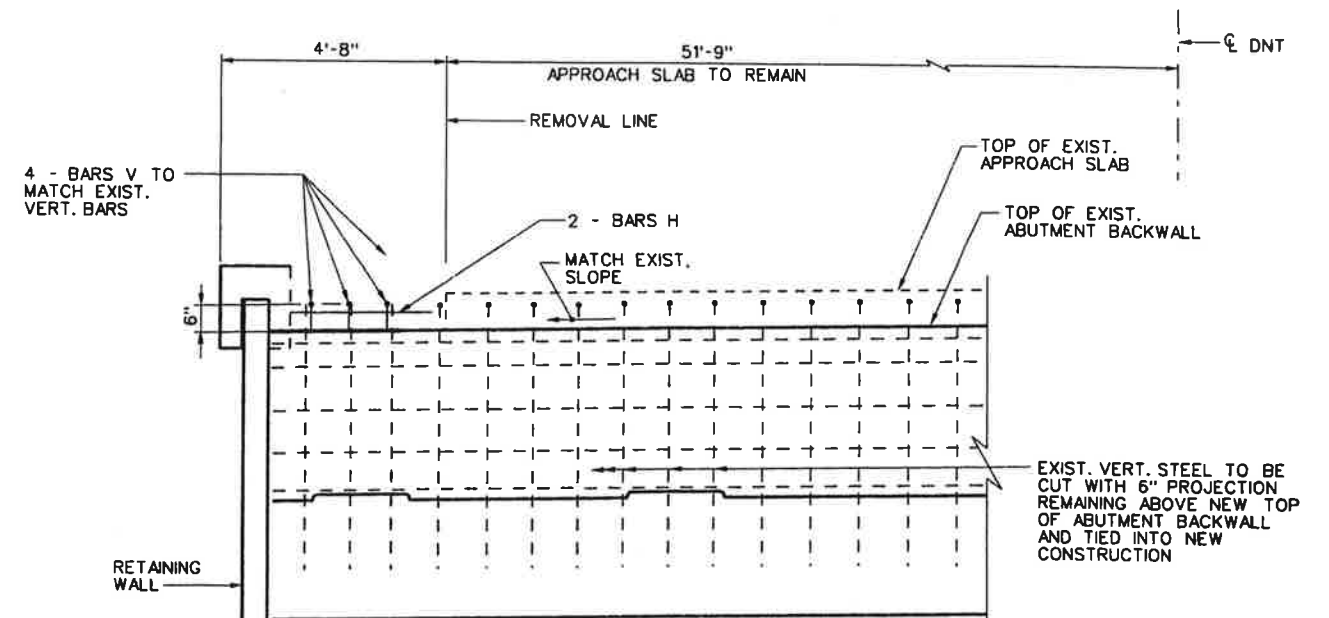

ABUTMENT BACKWALL REPLACEMENT DETAIL
SCALE: 1/4" = 1'-0"

NOTE:
HATCHED AREA INDICATES PORTION OF EXIST. ABUTMENT BACKWALL TO BE REMOVED. CLEAN AND BEND EXIST. STEEL AND TIE INTO NEW CONSTRUCTION.

NOTE:
REMOVAL OF ABUTMENT CONCRETE SHALL BE CONSIDERED INCIDENTAL TO EXTENDING OF SLAB.

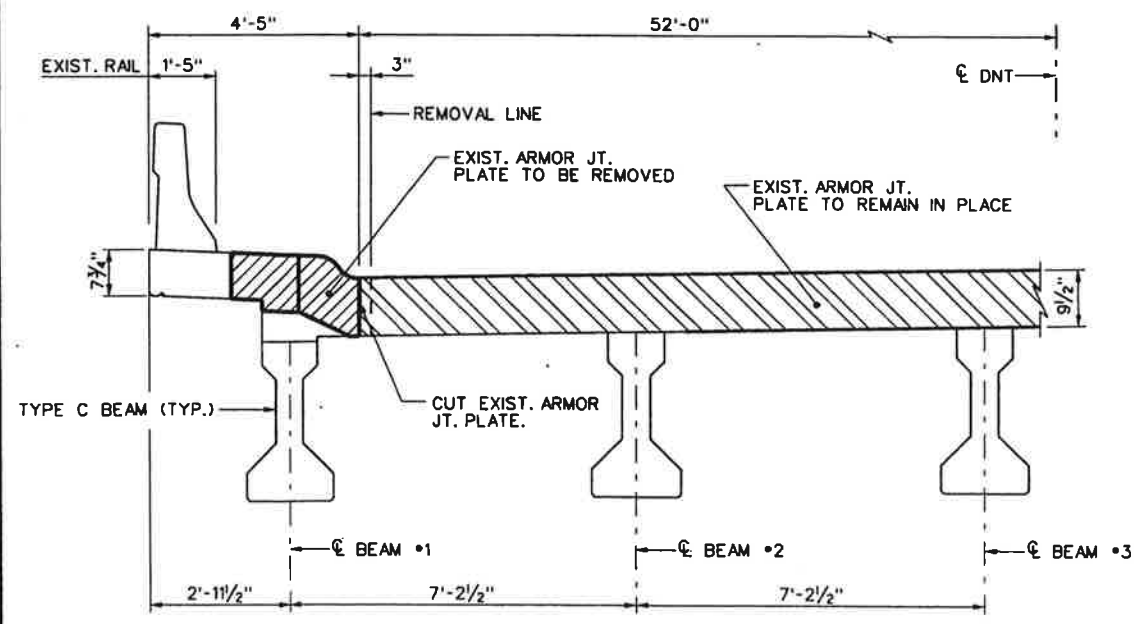

ARMOR JT. REMOVAL DETAIL
SCALE: 1/4" = 1'-0"

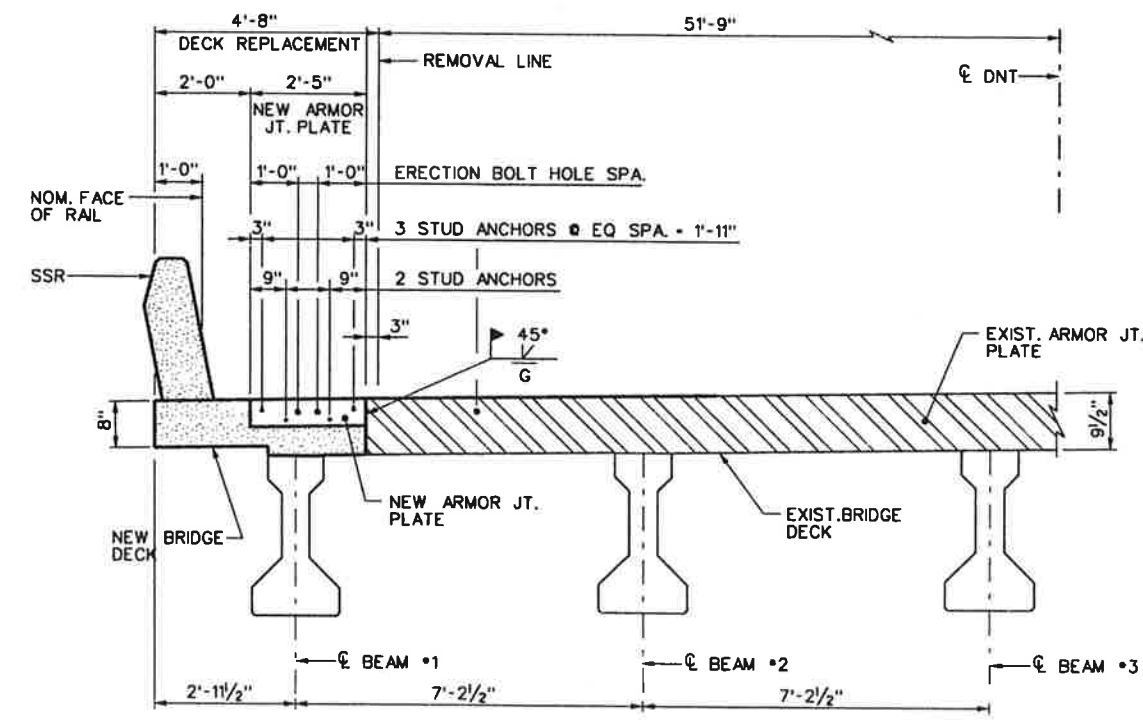

ARMOR JT. REPLACEMENT DETAIL
SCALE: 1/4" = 1'-0"

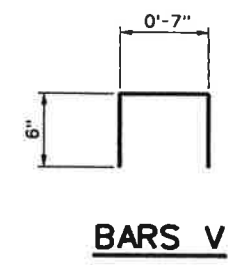

NO.	DATE	REVISION	APPROV.
DALLAS NORTH TOLLWAY			
NTTA NORTH TEXAS TOLLWAY AUTHORITY			
ABUTMENT MODIFICATION DETAILS VERDE VALLEY LANE OVERPASS SHOULDER REPLACEMENT			
SHEET 2 OF 5			
PBSJ			STM 4 & 5 PLAN SET A
DRAWN TLH	DATE 03-21-05	DESIGNED DWS	DATE 03-21-05
CHECKED JFT	DATE 03-25-05	SCALE	
CONTRACT NO. 02040-DNT-02-CN-EN SHEET A16 of A260			