

12:31:43 PM

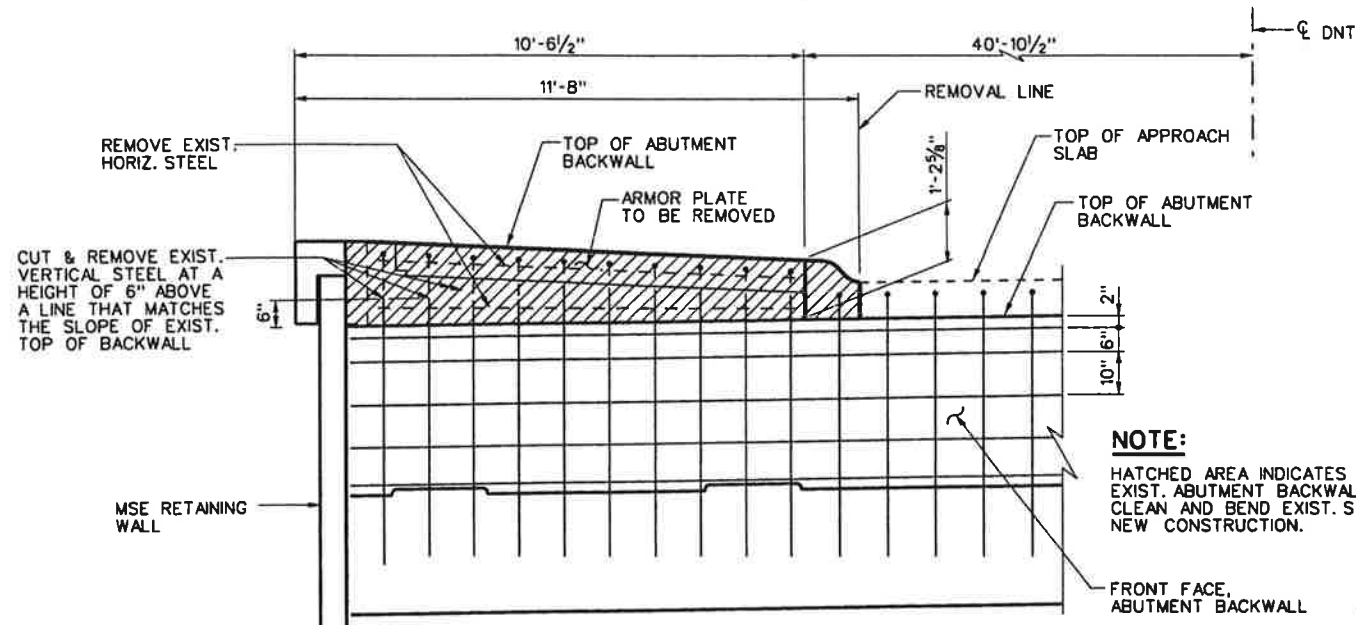

ABUTMENT BACKWALL REMOVAL DETAIL
SCALE: 1/4" = 1'-0"

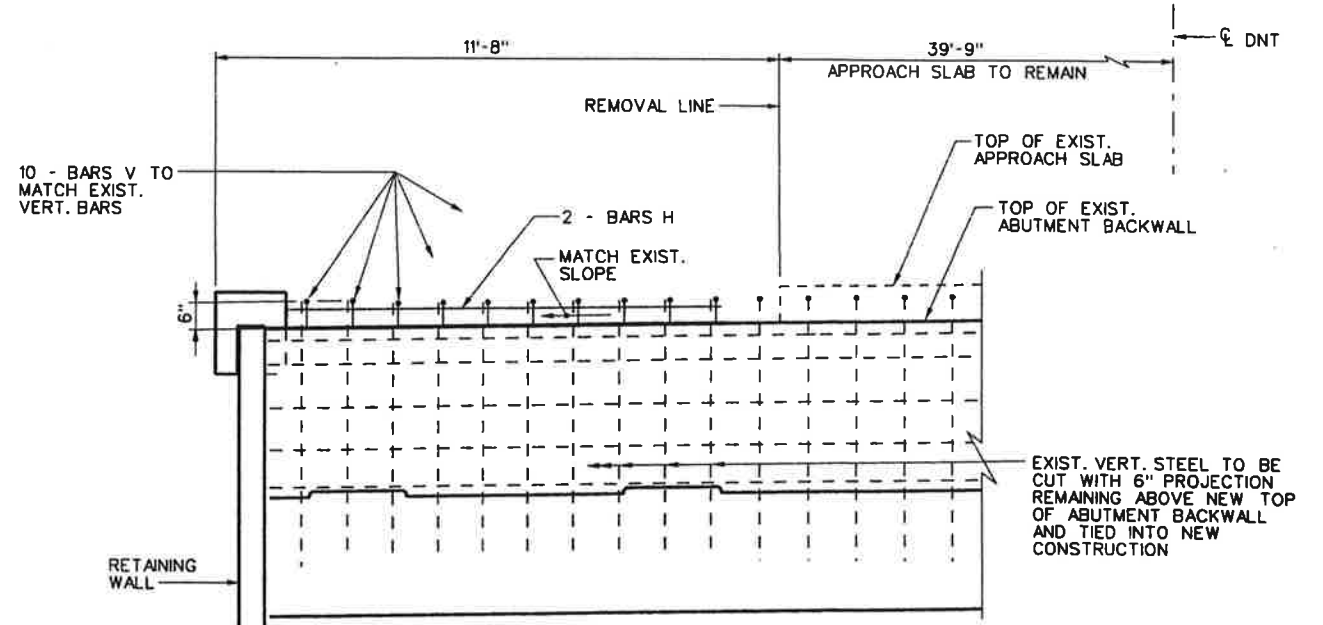

ABUTMENT BACKWALL REPLACEMENT DETAIL
SCALE: 1/4" = 1'-0"

NOTE:
HATCHED AREA INDICATES PORTION OF EXIST. ABUTMENT BACKWALL TO BE REMOVED. CLEAN AND BEND EXIST. STEEL AND TIE INTO NEW CONSTRUCTION.

NOTE:
REMOVAL OF ABUTMENT CONCRETE SHALL BE CONSIDERED INCIDENTAL TO EXTENDING OF SLAB.

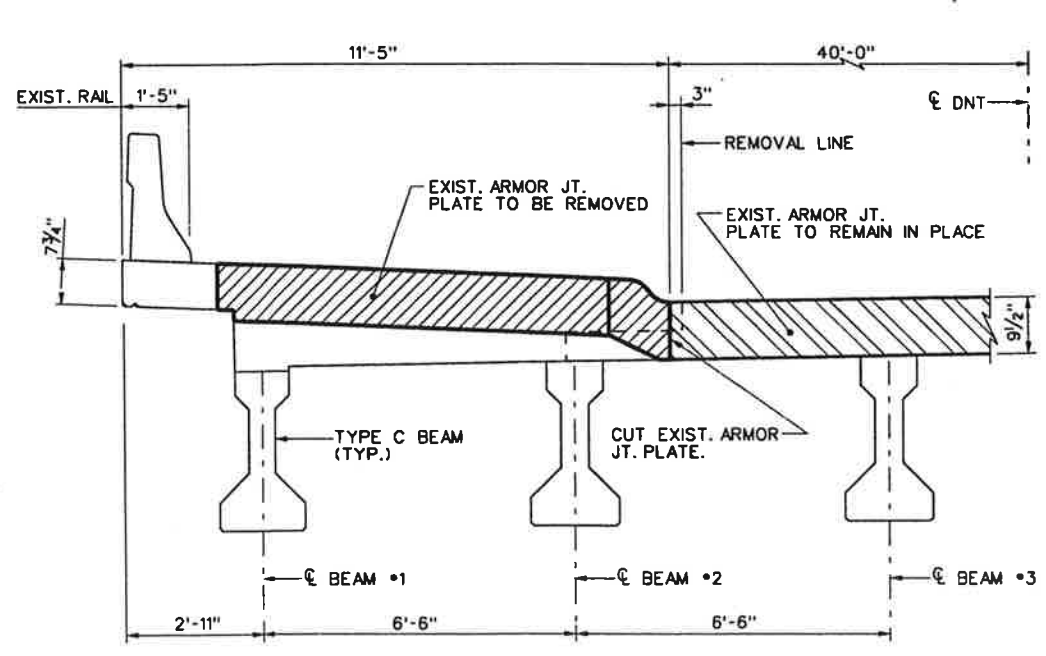

ARMOR JT. REMOVAL DETAIL
SCALE: 1/4" = 1'-0"

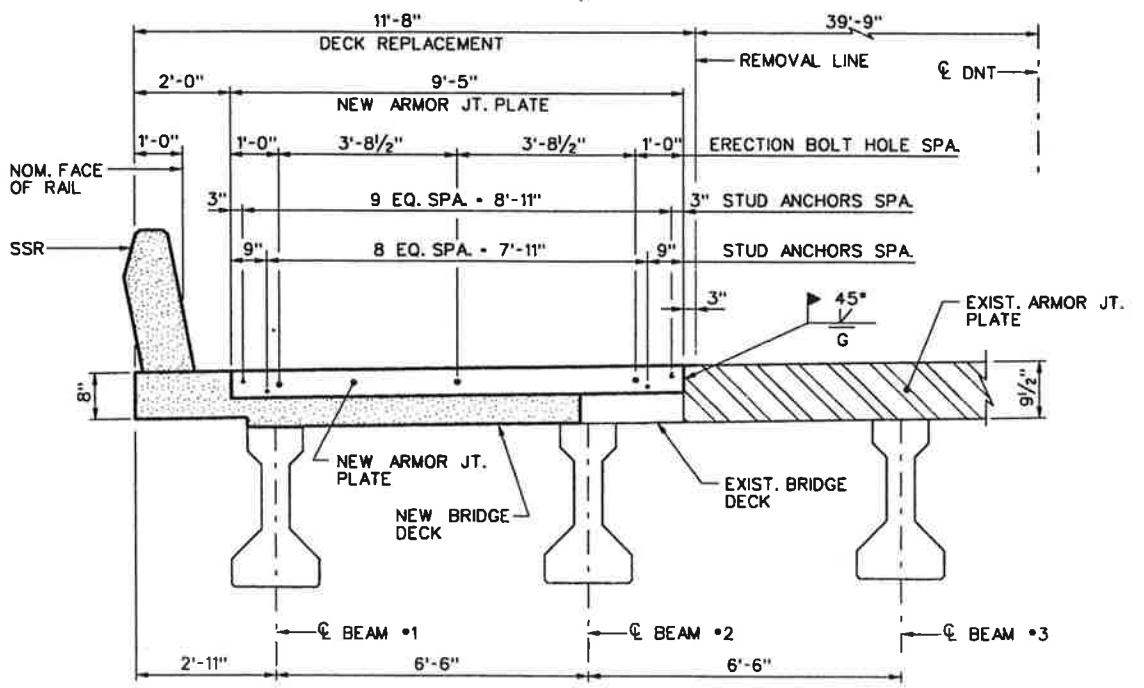

ARMOR JT. REPLACEMENT DETAIL
SCALE: 1/4" = 1'-0"

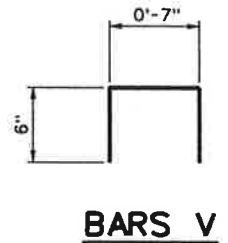

STATE OF TEXAS
REGISTERED PROFESSIONAL ENGINEER
DOUGLAS W. SPRULL
35529
DWS
08/31/2005

NO.	DATE	REVISION	APPROV.
DALLAS NORTH TOLLWAY			
NTTA NORTH TEXAS TOLLWAY AUTHORITY			
ABUTMENT MODIFICATION DETAILS KELLER SPRINGS ROAD OVERPASS SHOULDER REPLACEMENT			
SHEET 2 OF 5			
PBSJ			STM 4 & 5 PLAN SET A
DRAWN	ALC	DATE	07-09-04
CHECKED	DWS	DATE	09-03-04
DESIGNED	DWS	DATE	07-09-04
SCALE			
CONTRACT NO. 02040-DNT-02-CN-EN SHEET A167 OF A200			

8/30/2005 K:\PROJECTS\HK1\52050401\DNT-STM_CIF231\Sheets\Bridge Modification Plans\KellerSprings\d07bbks01.dgn