

HOTEL INVESTORS TRUST
Sta. 6+53.16 to Sta. 7+29.66 Ramp BL-S
Pavement Leaveout for Toll Plaza
Grading & Subgrade to be included
in this contract. Base by others.

FIRST TEXAS SAVINGS ASSOC.

PLAZA AT THE QUORUM ASSOC.

- NOTES**
1. See Volume 2 Plans for Belt Line Rd. Bridge Details
 2. See Volume 2 Plans for Approach Slab details.
 3. See Sheets 20 & 37 for Belt Line Rd. plan and profile.
 4. See Sheets 23 & 24 for N.B. Dallas Pkwy. profile.
 5. See Sheets 25 & 26 for S.B. Dallas Pkwy. profile.
 6. See Sheet 28 for Ramp BL-S profile.
 7. See Sheet 28 for Ramp S-BL profile.
 8. See Sheet 5 for Additional Horizontal Geometrics.
 9. See Sheets 35 & 36 for Ramp BL-S details & nose station.
 10. See Sheets 33 & 34 for Ramp S-BL details & nose station.
 11. See Sheets 51 & 52 for storm sewer plan.
 12. See Sheets 12 & 13 for removals.
 13. See Volume 2 Plans for Retaining Wall Details.

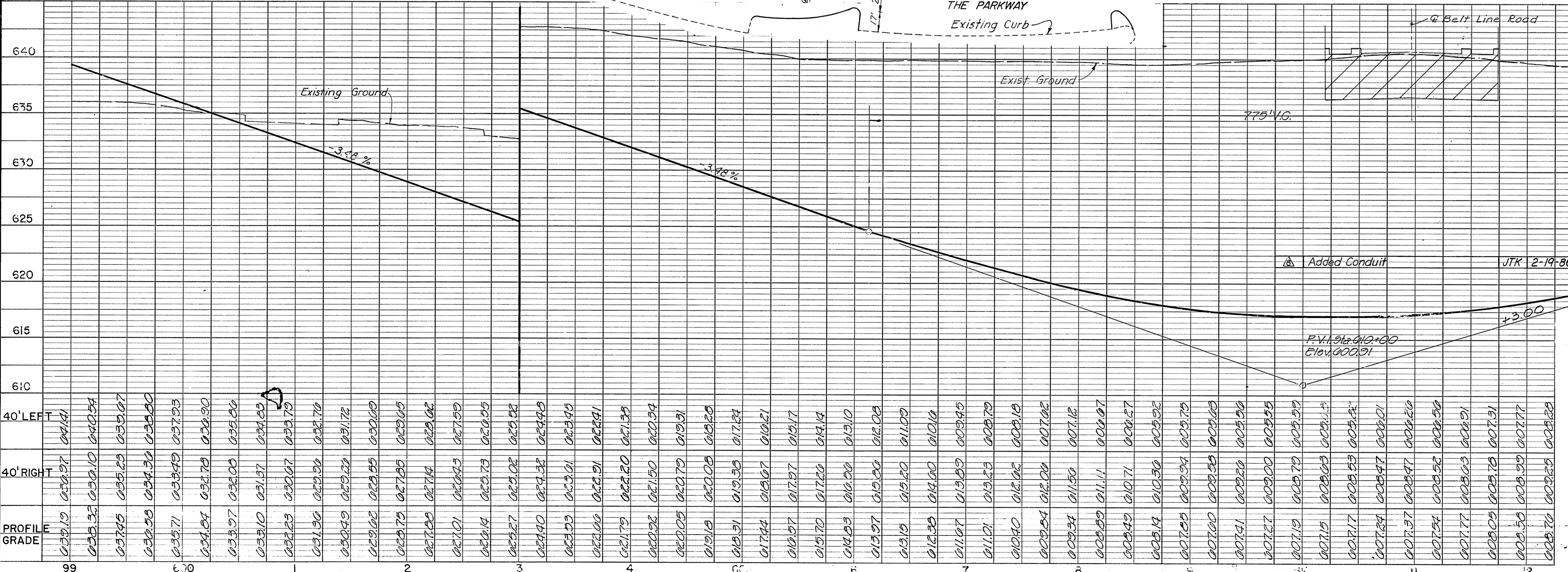
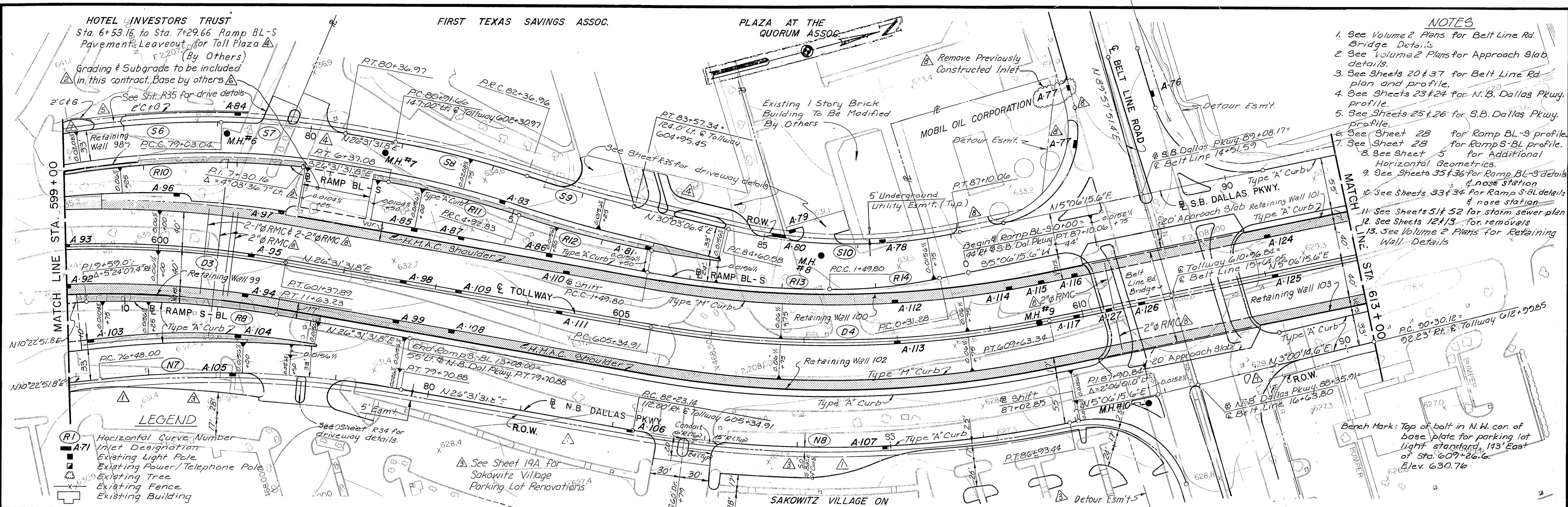

NO.	REVISION	BY	DATE
1	Revise Inlet A-77, Add Two Drives	GRB	10-3-86
2	Added Conduit	JTK	2-19-86
3	Revise Median	GMB	11-12-85
4	Base Note	AMN	7-19-85
5	Revise Drive	WMP	7-11-85
6	Revised Driveways & Toll Plazas	RM	4-18-85
7	Revised Sakowitz Village Park Lot	RM	3-15-85
8	Toll Plaza End Station	AMN	5-18-84
9	Revise East Curb Gutter	KLJ	3-30-84

TEXAS TURNPIKE AUTHORITY
DALLAS NORTH TOLLWAY

PLAN AND PROFILE
STA. 599+00 TO STA. 613+00

Turner Collie & Braden Inc. SECTION VI
Consulting Engineers

DRAWN	A.L.A.	DATE	3-83	DESIGNED	G.G.S.	DATE	3-83
CHECKED	J.B.L.	DATE	3-83	SCALE	H:1"=25'/V:1"=5'		

CONTRACT NO. DNT-114 SHEET R19 OF R103