

SCALE = $\frac{\text{PLAN}}{1" = 30' - 0"}$

OUTFALL NOTE:
 UNDERDRAIN TO OUTFALL AT ROADWAY UNDERDRAINS. NRCP SHALL BE USED BETWEEN THE WALL FACE AND THE ROADWAY UNDERDRAINS. OUTFALL SHALL HAVE A 0.5% MINIMUM SLOPE, SEE SHEET NO. R-54.

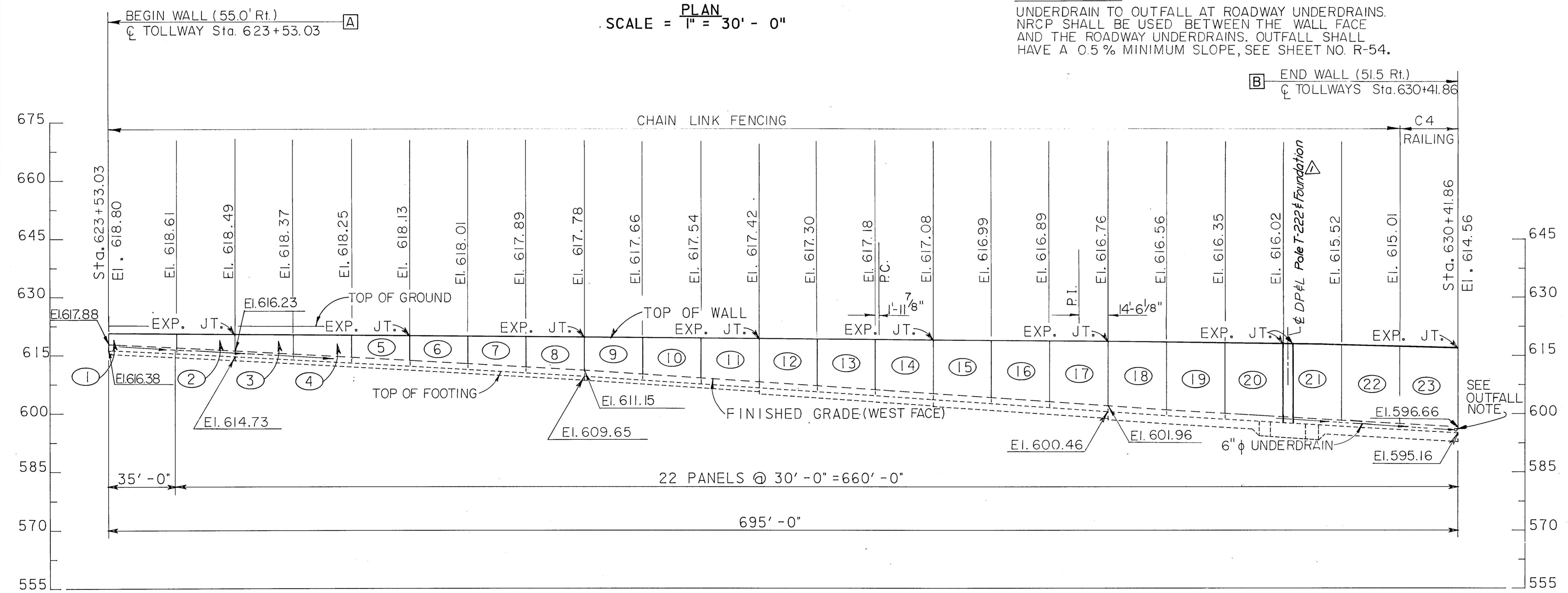
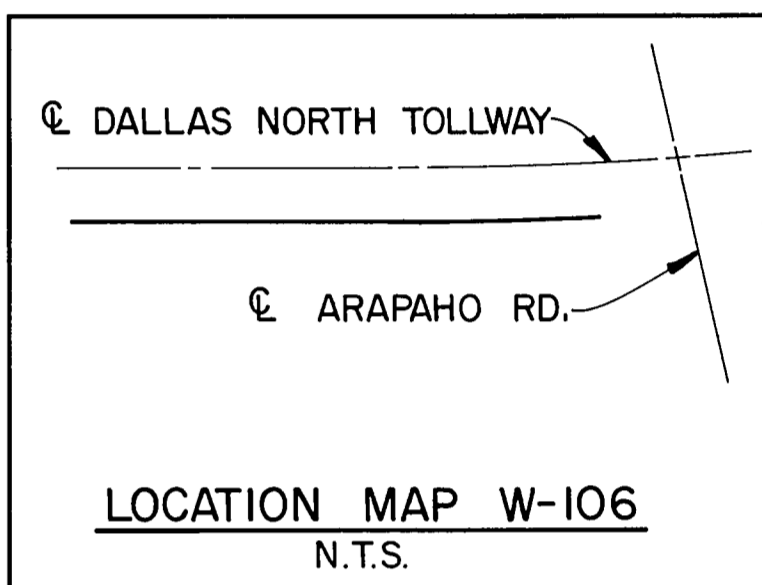

- GENERAL NOTES:**
- FOR RETAINING WALL DESIGN AND DETAILS, SEE STANDARD DRAWING NUMBERS 42 AND 43.
 - FOR ABUTMENT DETAILS, SEE SHEET NUMBER
 - EXPANSION JOINTS ARE NOTED. ALL OTHER JOINTS SHALL BE CONTRACTION.
 - DENOTES PANEL NUMBER.
 - DENOTES MATCH POINT.
 - FOR TYPE C4 RAILING DETAILS, SEE STANDARD DRAWING NUMBER 33.

ASBUILT PLANS

Add DP&L Pole & Foundation		AMM	7-20-85
NO.	REVISION	BY	DATE
TEXAS TURNPIKE AUTHORITY			
DALLAS NORTH TOLLWAY			
ARAPAHO ROAD ~ SOUTHEAST RETAINING WALLS			
PLAN AND ELEVATION			
TurnerCollie & Braden Inc. Consulting Engineers			SECTION VI
DRAWN	RGD	DATE	8-83
DESIGNED	TJR	DATE	7-83
CHECKED	TJR	DATE	8-83
SCALE	AS NOTED		
CONTRACT NO. DNT-114 SHEET S-80 OF S-85			

ESTIMATED QUANTITY SUMMARY

ITEM NO.	DESCRIPTION	UNIT	QUANTITY
423	RETAINING WALL (OPTIONAL)	S.F.	7,207
450	RAILING (WALL) (TYPE C4)	L.F.	30.0
450	RAILING (WALL) (PARAPET ONLY)	L.F.	665.0
556	PIPE UNDERDRAIN (6") (N.R.C.P.)	L.F.	11

WALL NO. W-106

ELEVATION
 (LOOKING WEST)
 SCALE = $1" = 30' - 0"$ HORIZ.
 $1" = 15' = 0"$ VERT.