

LEGEND

- Drainage Structures to be constructed in Phases I & II
- - - Drainage Structures to be constructed in Phase III
- Existing Drainage Structures

See Sheet R34 for Definition of Phase I, II, and III.

Note: Box Culvert #1 to be the first item of work in this contract.

Bench Mark #7
Chiseled "a" on southwest corner of Inlet on north side of Bent Tree Forest Drive, 500' east of Dallas Parkway
Elevation: 604.23

REMOVAL LEGEND

Concrete

Notes:

1. See Sheet R15 for Tollway Plan & Profile.
2. See Sheet R50 for Line "G" Storm Sewer Profile.
3. See Sheets R68 and R69 for Box Culvert Details.
4. See Sheet R2 for Railroad Header Details.
5. See Cross Sections for Slopes.
6. See Sheets R15 and W1 and cross sections for temporary shoring details.

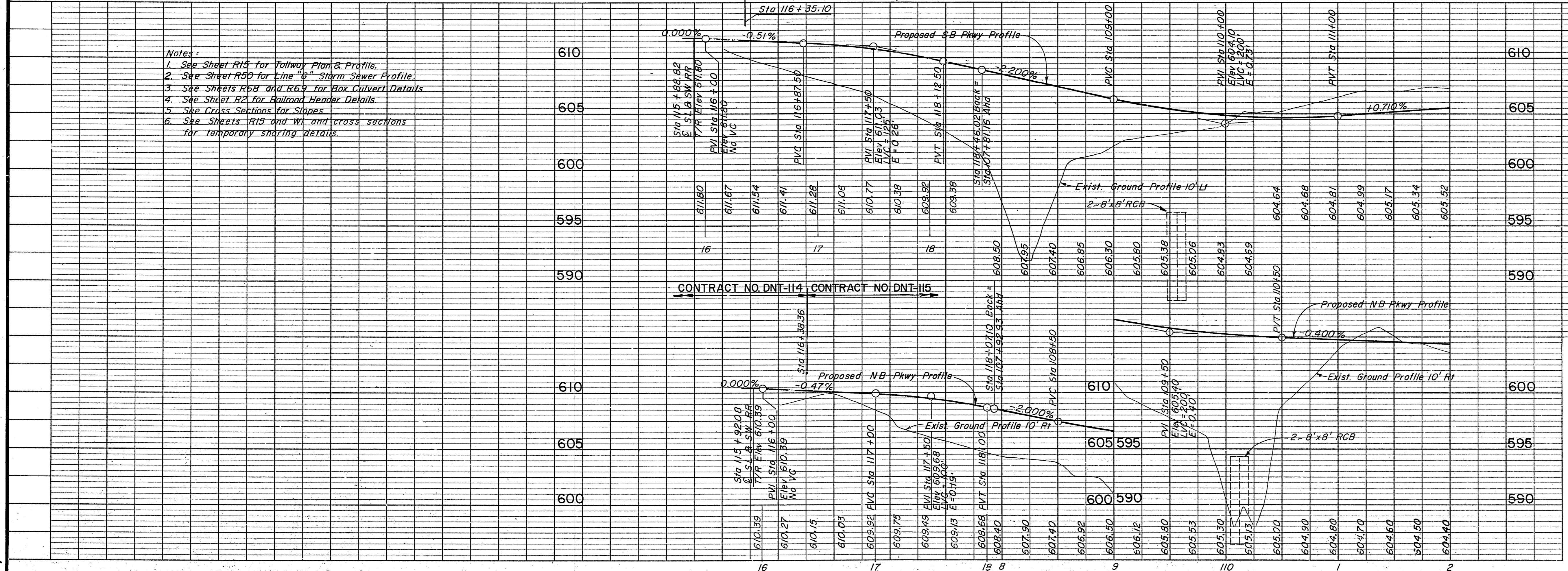

NO.	REVISION	BY	DATE
TEXAS TURNPIKE AUTHORITY DALLAS NORTH TOLLWAY PAVING AND GRADING DALLAS PARKWAY STA 107+81.6 TO STA 112+00 Gibbs & Hill, Inc. <small>ENGINEERS DESIGNERS CONSTRUCTORS</small> DALLAS			
			SECTION VII
<small>DRAWN</small> CJB <small>CHECKED</small> DWG	<small>DATE</small> 4/4/83 <small>DATE</small> 5/4/84	<small>DESIGNED</small> DWG <small>SCALE</small> 1"=50' Hor 1"=5' Vert	<small>DATE</small> 4/1/83
CONTRACT NO. DNT-115 SHEET R5 OF R85			