

LEGEND

- Drainage Structures to be constructed under Phase III
- Drainage Structures constructed under Phase I, II
- Existing Drainage Structures
- Underdrain Lines Constructed Under Phase III

See Sheet R36 for Definition of Phases I, II, & III.

Bench Mark #10
Chiseled "o" on center of inlet on west side on Knoll Trail Drive, 1850' north of Westgrove Drive, 20' south of power pole (#14N 2W 68) and 400' east of Dallas Parkway.
Elevation: 630.40

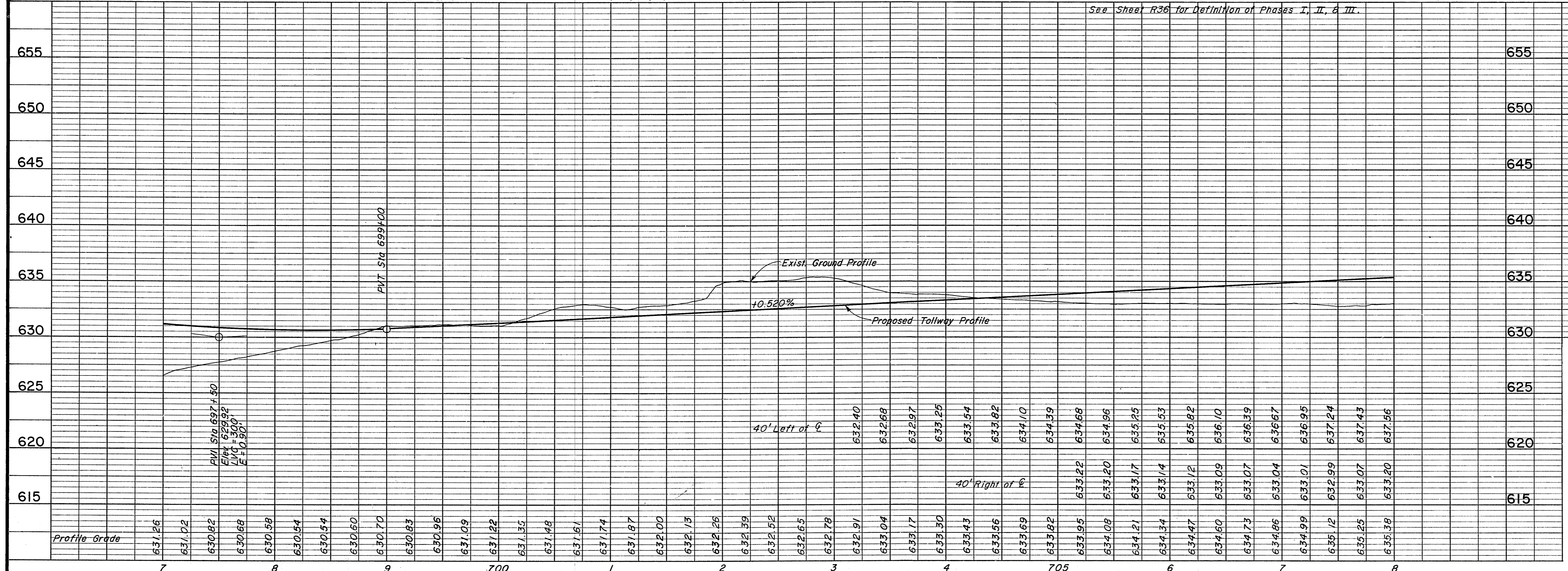

- NOTES:**
- See Sheet R11 for Dallas Parkway Plan & Profile for Removals.
 - See Sheets W11 - W12 for Retaining Wall Details.
 - See Sheets R62 - R63 for Storm Sewer Profile.
 - For Shoulder and Median Barrier Details See Typical Sections.

NO.	REVISION	BY	DATE
TEXAS TURNPIKE AUTHORITY DALLAS NORTH TOLLWAY PAVING AND GRADING TOLLWAY STA 697+00 TO STA 708+00 Gibbs & Hill, Inc. <small>ENGINEERS DESIGNERS CONSTRUCTORS DALLAS</small> SECTION VII			
DRAWN	VER	DATE	7/8/83
CHECKED	DWC	DATE	5/4/84
DESIGNED	DWC	DATE	6/30/83
SCALE	1" = 50' Hor. 1" = 5' Vert.		
CONTRACT NO. DNT-115 SHEET R21 OF R85			