

**RAMP KS-N**

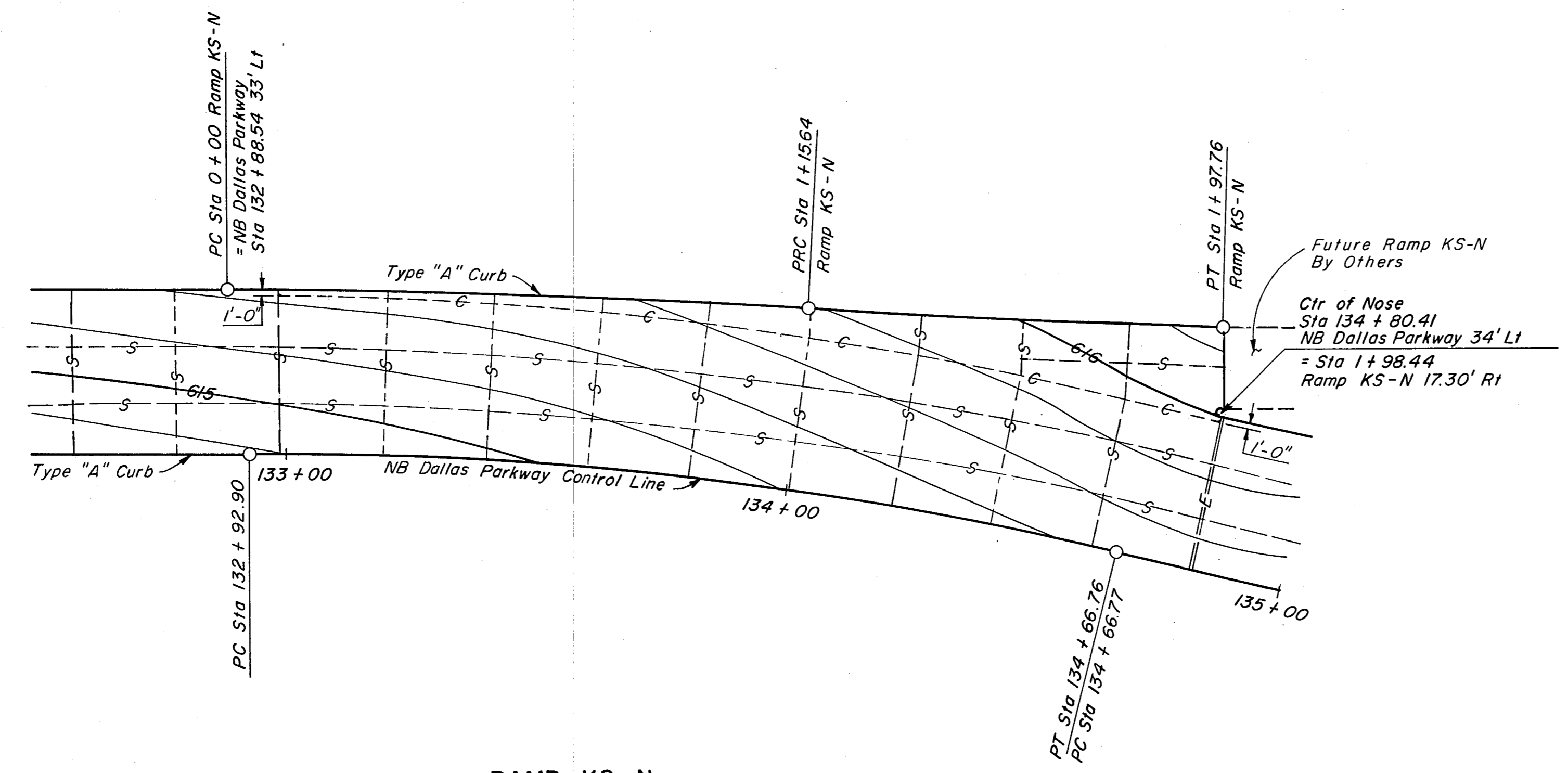

**RAMP KS-N**

**LEGEND**

- +++++ Longitudinal Construction Joint (LC)
- Sawn Longitudinal Joint (SL)
- ==E== Transverse Expansion Joint (E)
- ++ ++ Transverse Contraction Joint (SC)
- S- Sawn Dummy Joint (S)
- L- Longitudinal Construction Joint w/o Tie Bar(L)
- C- Construction Joint (C)

NO.	REVISION	BY	DATE
<b>TEXAS TURNPIKE AUTHORITY</b> <b>DALLAS NORTH TOLLWAY</b>			
PAVING PLAN RAMP KS-N			
<b>Gibbs &amp; Hill, Inc.</b> <small>ENGINEERS DESIGNERS CONSTRUCTORS DALLAS</small>			<b>SECTION VII</b>
<small>DRAWN</small> AELT <small>CHECKED</small> DWG	<small>DATE</small> 4/18/84 <small>DATE</small> 5/4/84	<small>DESIGNED</small> MGB <small>SCALE</small> 1" = 20'	<small>DATE</small> 4/16/84
<small>CONTRACT NO. DNT-115 SHEET R30 OF R85</small>			