

SEE SHEET R17
MATCH LINE STA 662+00

MATCH LINE STA 674+00
SEE SHEET R19

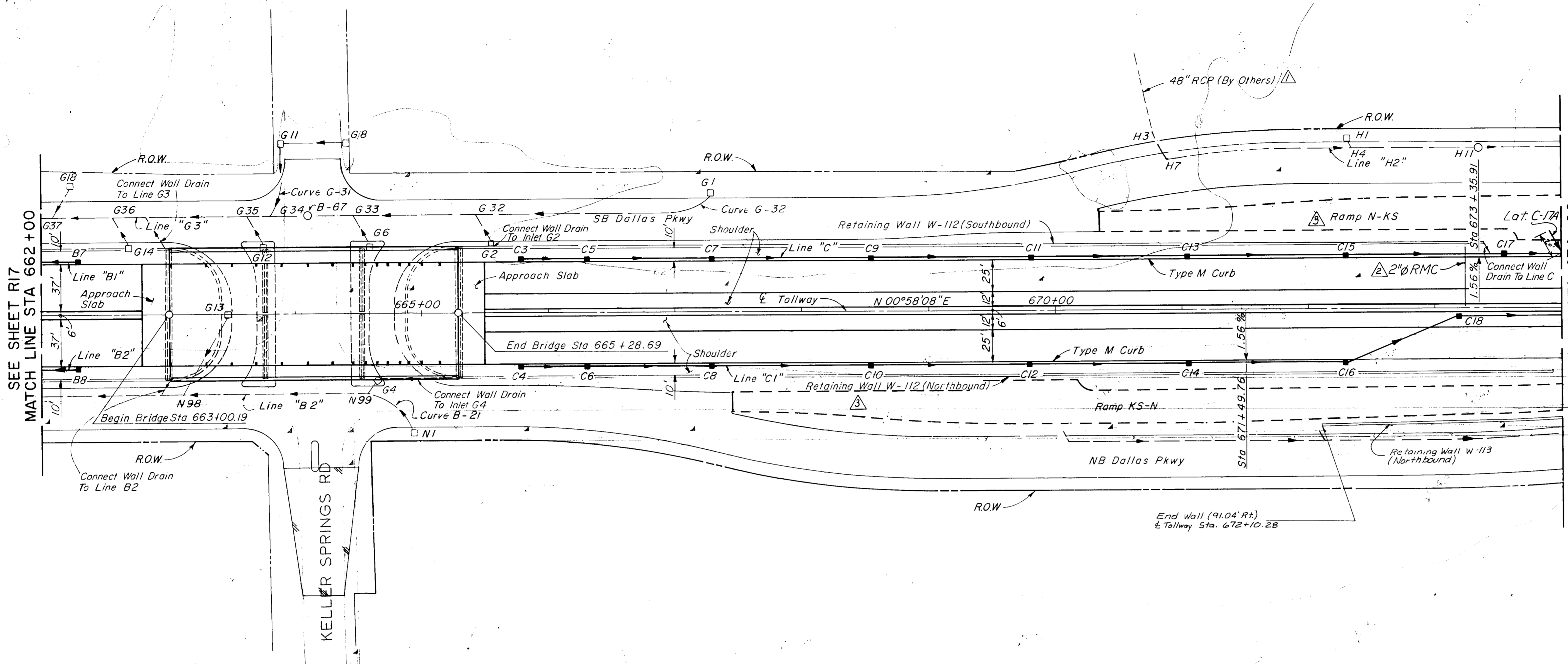

LEGEND

- Drainage Structures to be constructed under Phase III
- Drainage Structures constructed under Phase I & II
- Existing Drainage Structures

See Sheet R35 for Definition of Phase I, II, and III.

Bench Mark #8
Chiseled '8' on end of curb radius at first drive on north side of Keller Springs Road, 150' east of United Fidelity Building, 500' west of Dallas Parkway
Elevation: 626.24

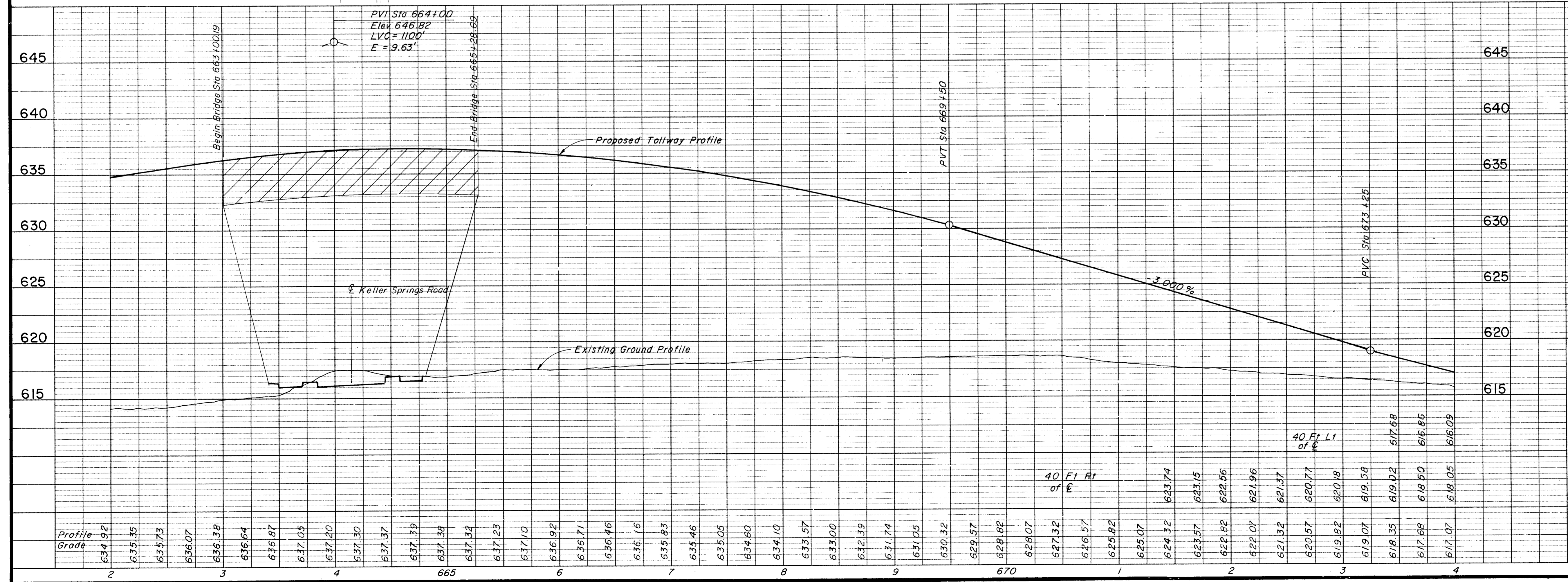

- Notes:**
- See Sheet RB for Dallas Parkway Plan & Profile for Removals.
 - See Sheets W2 - W5 for Retaining Wall Details.
 - See Sheets S1 - S9 for Keller Springs Road Bridge Details.
 - See the following Sheets for Storm Sewer Profiles:

Line	Sheet
B1	R51
B2	R52
C, C1	R53
 - For Shoulder and Median Barrier Details See Typical Sections.

ASBUILT PLANS

	Revise Remove	GMG	7-01-86
	Added Conduit	JTK	2-19-86
	Storm Sewer Line H-2 Redesign	MGB	2-7-85

NO.	REVISION	BY	DATE

TEXAS TURNPIKE AUTHORITY
DALLAS NORTH TOLLWAY
 PAVING AND GRADING
 TOLLWAY
 STA 662+00 TO STA 674+00

Gibbs & Hill, Inc.
 ENGINEERS DESIGNERS CONSTRUCTORS
 DALLAS

SECTION VII

DRAWN VER DATE 7/8/83 DESIGNED DWG DATE 6/30/83
 CHECKED DWG DATE 5/2/84 SCALE 1"=50' Hor. 1"=5' Vert.

CONTRACT NO. DNT-115 SHEET R18 OF R85