

Curve T 2C  
 PI Sta 686+59.28  
 N 476 440.332  
 E 2207883.975  
 $\Delta = 18^{\circ}45'22''$   
 $D = 3^{\circ}49'11''$   
 $R = 1500.00'$   
 $T = 247.73'$   
 $L = 491.04'$

16475

16479

BENT TREE TOWERS

SEE SHEET R19  
 MATCH LINE STA 685+00

SEE SHEET R21  
 MATCH LINE STA 697+00

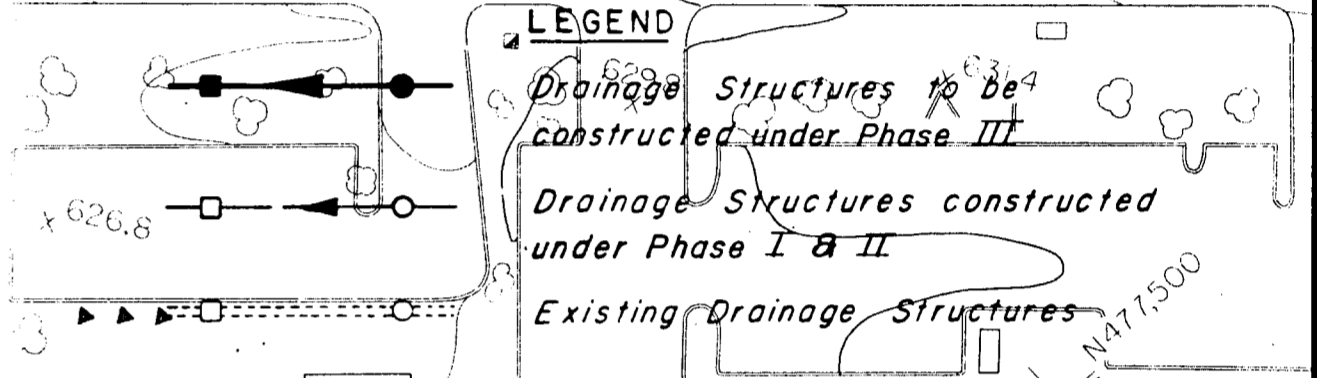
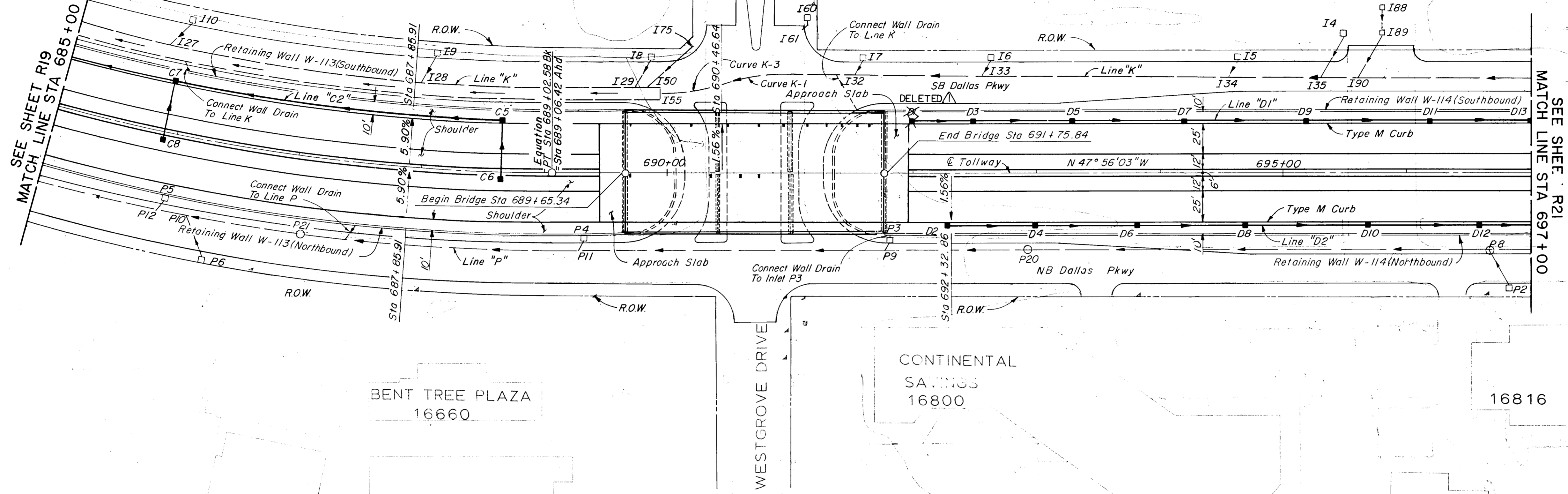

RESEARCH Bench Mark #9  
 Chiseled 'a' on northeast corner of  
 2nd inlet on south side of Westgrove  
 Drive, 500' west of Dallas Parkway.  
 Elevation: 620.80  
 16910  
 16850

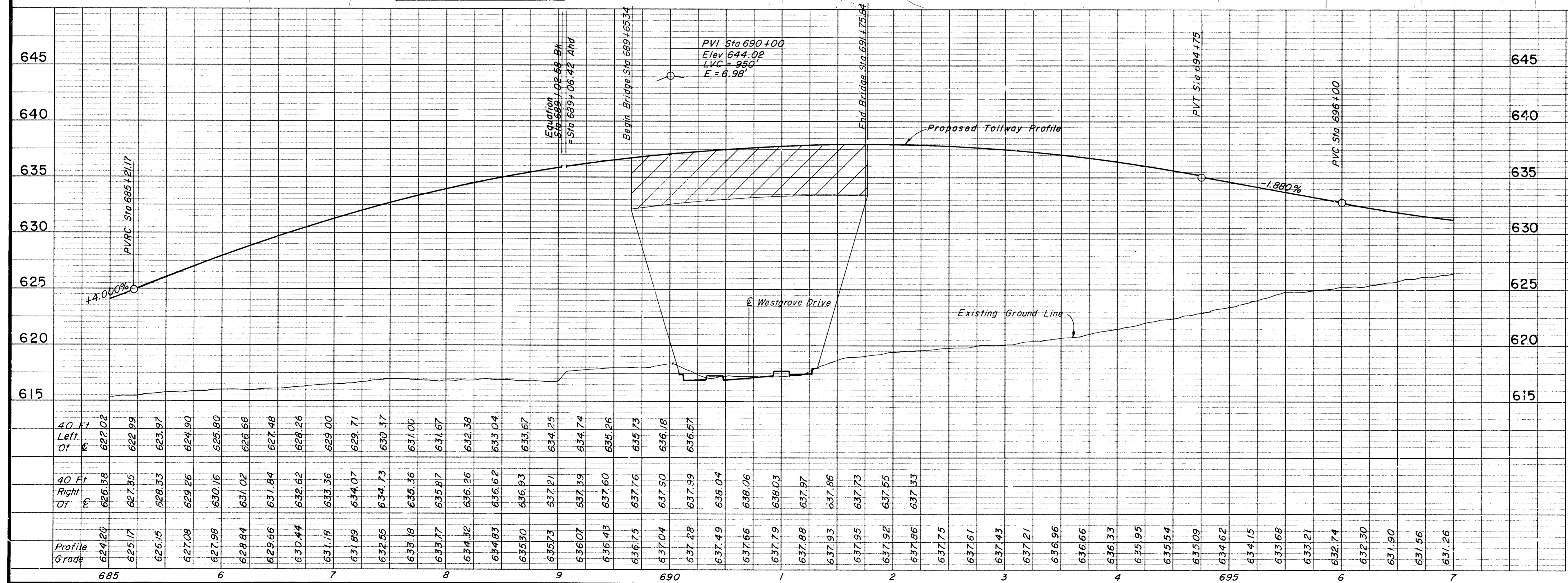

- NOTES:
- See Sheet R10 for Dallas Parkway Plan & Profile for Removals.
  - See Sheet R32 for Paving Plan - Westgrove Drive.
  - See Sheets W6 - W10 for Retaining Wall Details.
  - See Sheets S10 - S20 for Westgrove Drive Bridge Details.
  - See the following Sheets for Storm Sewer Profiles:
 

Line	Sheet
C2	R 53
D1, D2	R 61
  - For Shoulder and Median Barrier Details See Typical Sections.

**ASBUILT PLANS**

AS BUILT PLANS		PJ	I-11-88
NO.	REVISION	BY	DATE
<b>TEXAS TURNPIKE AUTHORITY</b> <b>DALLAS NORTH TOLLWAY</b> PAVING AND GRADING TOLLWAY STA 685+00 TO STA 697+00 <b>Gibbs &amp; Hill, Inc.</b> <small>ENGINEERS DESIGNERS CONSTRUCTORS DALLAS</small> <b>SECTION VII</b>			
DRAWN	VER	DATE	7/8/83
CHECKED	DWC	DATE	7/7/84
DESIGNED	DWC	DATE	6/30/83
SCALE	1"=50' Hor. 1"=5' Vert.		
CONTRACT NO. DNT-115 SHEET R20 OF R85			