

PARKWAY OFFICE
CONDOMINIUM
16685

OFFICE
BLDG
16901

EVERGREEN BLDG
17120

OFFICE
BLDG
17130

Bench Mark #11
Chiseled "a" on the back of curb at
the southwest corner of a handicap
ramp in the parking lot of the Wylain
Building, 275' south of Knoll Trail
Drive and 125' east of Dallas Parkway.
Elevation: 636.26

17250

WYLAIN

Slotted Drain
See R74 for Details

Slotted Drain
See R74 for Details

Slotted Drain
See R74 for Details

SEE SHEET R22
MATCH LINE STA 719+00

MATCH LINE STA 731+00
SEE SHEET R24

LEGEND

- Drainage Structures to be constructed under Phase III
- Drainage Structures constructed under Phase I & II
- Existing Drainage Structures

See Sheet R37 for Definition of Phase I, II, and III.

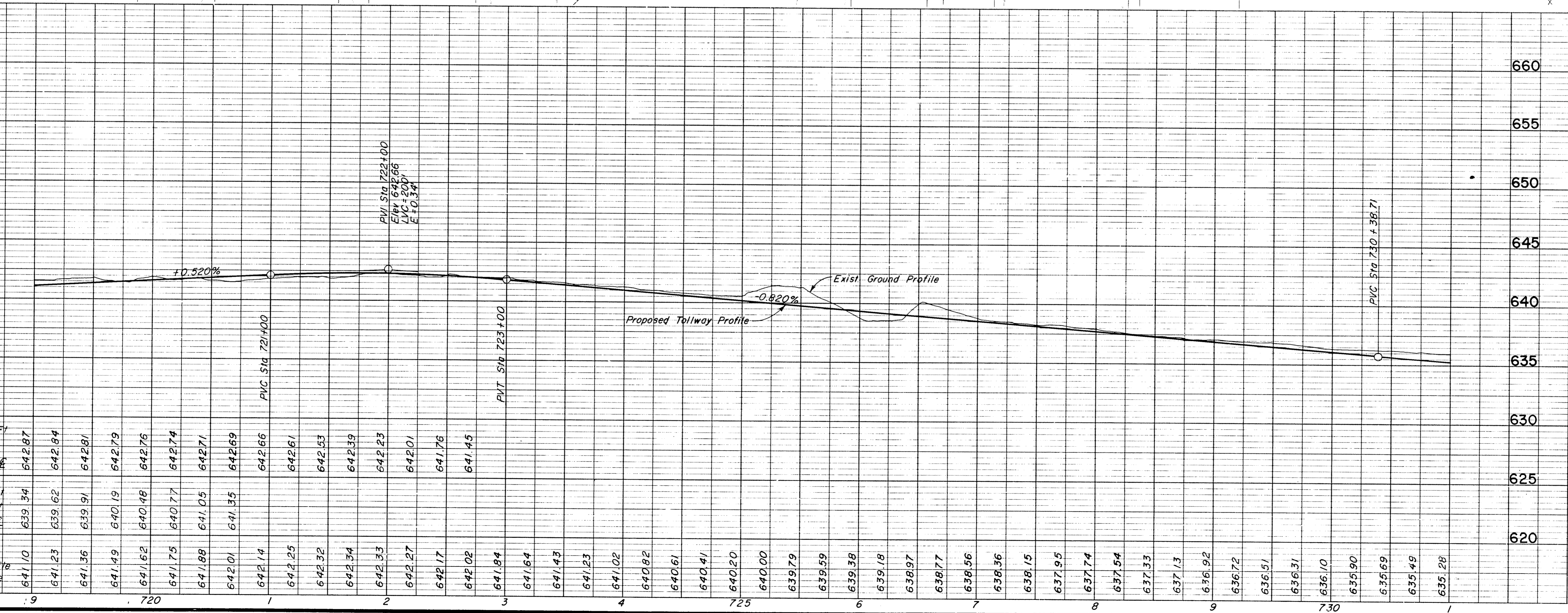

NOTES

1. See Sheet R13 for Dallas Parkway Plan & Profile for Removals.
2. See the following Sheets for Storm Sewer Profiles:

Line	Sheet
D	R62
E, E2	R65
3. For Shoulder and Median Barrier Details See Typical Sections.

ASBUILT PLANS

NO.	REVISION	BY	DATE
TEXAS TURNPIKE AUTHORITY			
DALLAS NORTH TOLLWAY			
PAVING AND GRADING			
TOLLWAY			
STA 719+00 TO STA 731+00			
Gibbs & Hill, Inc.			SECTION VII
ENGINEERS DESIGNERS CONSTRUCTORS DALLAS			
DRAWN	VER	DATE	7/8/83
DESIGNED	DWC	DATE	6/30/83
CHECKED	DWC	DATE	5/4/84
SCALE		1"=50' Hor 1"=5' Vert	
CONTRACT NO. DNT-115 SHEET R23 OF R85			