

PLAN
SCALE: 1" = 20'

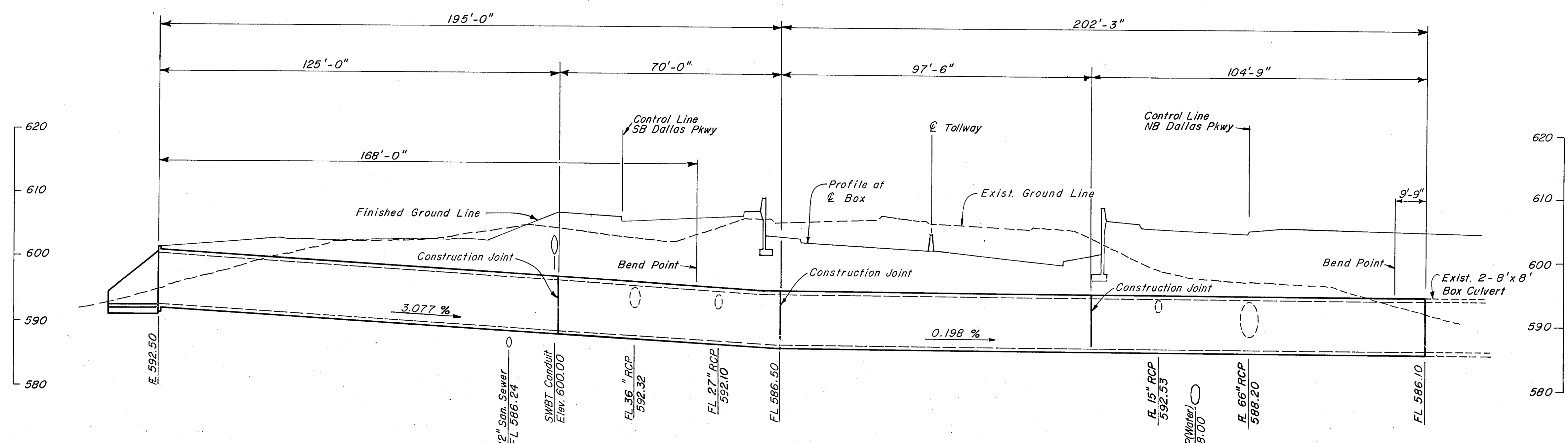

PROFILE
SCALE: 1" = 20' HOR
1" = 10' VERT

- NOTES:**
1. See Sheet R69 for Special MCB details.
 2. Contractor shall use extreme caution when excavating proposed box culvert because of close proximity to existing 12" sanitary sewer and 36" water line.
 3. All dimensions shown are measured along the centerline of the Box Culvert.
 4. All concrete shall be class "C".
 5. All reinforcing steel shall be ASTM A-615 grade 60.

ASBUILT PLANS

NO.	REVISION	BY	DATE
TEXAS TURNPIKE AUTHORITY DALLAS NORTH TOLLWAY SPECIAL BOX CULVERT DETAILS STA 642+50			
Gibbs & Hill, Inc. <small>ENGINEERS DESIGNERS CONSTRUCTORS</small> <small>DALLAS</small>			SECTION VII
<small>DRAWN</small> VER <small>CHECKED</small> LSRa	<small>DATE</small> 7-5-83 <small>DATE</small> 7-6-83	<small>DESIGNED</small> LSRa <small>SCALE</small> As Shown	<small>DATE</small> 6-30-83
CONTRACT NO. DNT-115 SHEET R68 OF R85			