

☉ Tollway Curve Data
 PI Sta 678 +10.96
 N 475652.180
 E 2208198.000
 $\Delta = 16^\circ 37' 26''$
 $D = 2^\circ 30' 26''$
 $R = 2291.83'$
 $T = 334.83'$
 $L = 664.95'$

☉ Tollway Curve Data
 PI Sta 682 +76.95
 N 476105.410
 E 2208070.988
 $\Delta = 13^\circ 31' 23''$
 $D = 5^\circ 00' 00''$
 $R = 1145.92'$
 $T = 135.86'$
 $L = 270.46'$

NOTE:
 The information shown on this drawing concerning type and location of underground utilities is not guaranteed to be accurate or all inclusive. The Contractor is responsible for making his own determinations as to type and location of underground utilities as may be necessary to avoid damage thereto. The Contractor shall verify location of underground pipe lines, conduits, and structures by contacting owners of underground utilities and by prospecting in advance of excavation operations.

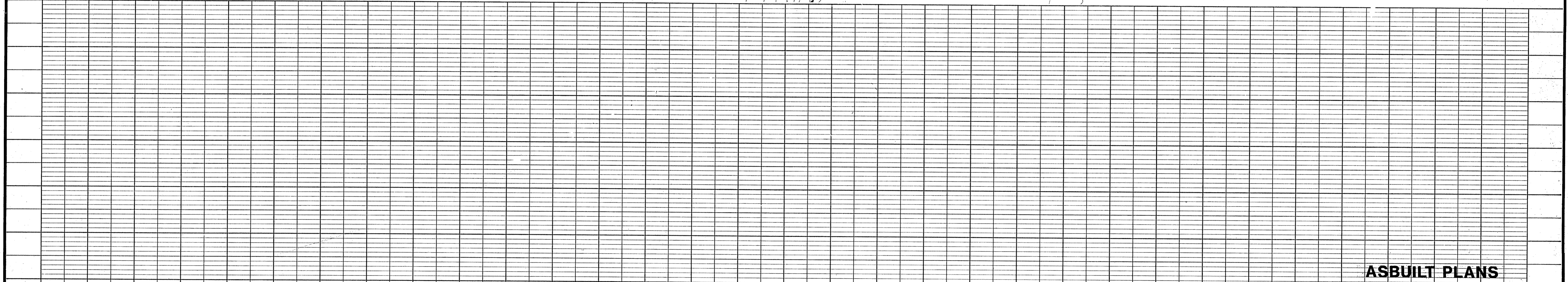
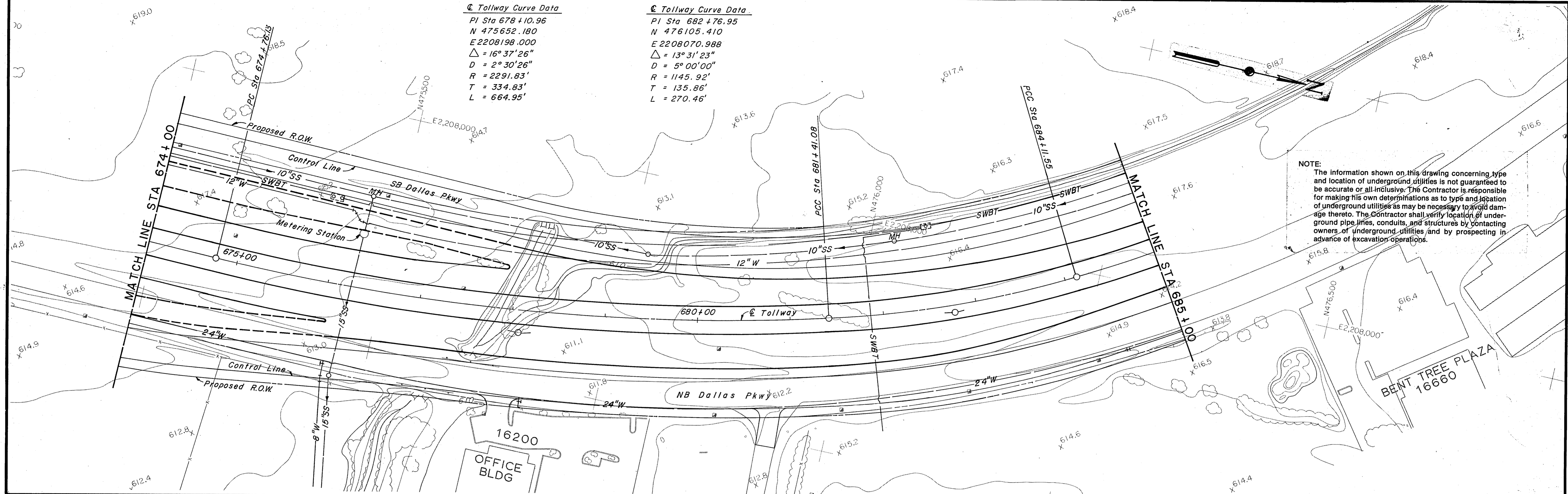

ASBUILT PLANS

NO.	REVISION	BY	DATE
TEXAS TURNPIKE AUTHORITY DALLAS NORTH TOLLWAY			
EXISTING UTILITIES STA 674+00 TO STA 685+00			
Gibbs & Hill, Inc. <small>ENGINEERS DESIGNERS CONSTRUCTORS</small>			SECTION VII
<small>DRAWN</small> VER <small>CHECKED</small> DATE	<small>DATE</small> 9-13-83 <small>SCALE</small> 1"=50'	<small>DESIGNED</small> DATE <small>DATE</small>	<small>DATE</small>
CONTRACT NO. DNT-115 SHEET R79 OF R85			