

CURVE N-KS3	CURVE N-KS4
PI. —	PI. —
N 474,961.342	N 475,070.820
E 2,208,108.305	E 2,208,099.654
$\Delta = 5^\circ 29' 12''$	$\Delta = 5^\circ 29' 12''$
D = 5'00'00"	D = 5'00'00"
R = 1,145.92'	R = 1,145.92'
T = 54.91'	T = 54.91'
L = 109.74'	L = 109.74'

CURVE KS-N3	CURVE KS-N4
PI. —	PI. —
N 474,638.776	N 474,746.026
E 2,208,259.043	E 2,208,271.188
$\Delta = 5^\circ 17' 39''$	$\Delta = 5^\circ 29' 29''$
D = 5'00'00"	D = 5'00'00"
R = 1,145.92'	R = 1,145.92'
T = 52.98'	T = 54.96'
L = 105.88'	L = 109.83'

NOTE:
Roadway Contractor shall provide dowels and dowel baskets for the expansion joints at the toll plaza leave-out and the Toll Plaza Contractor may be required to install them.

Bench Mark #8
Chiseled "I" on end of curb radius at first drive on north side of Keller Springs Road, 150' east of United Fidelity Building, 500' west of Dallas Parkway. Elev. 626.24

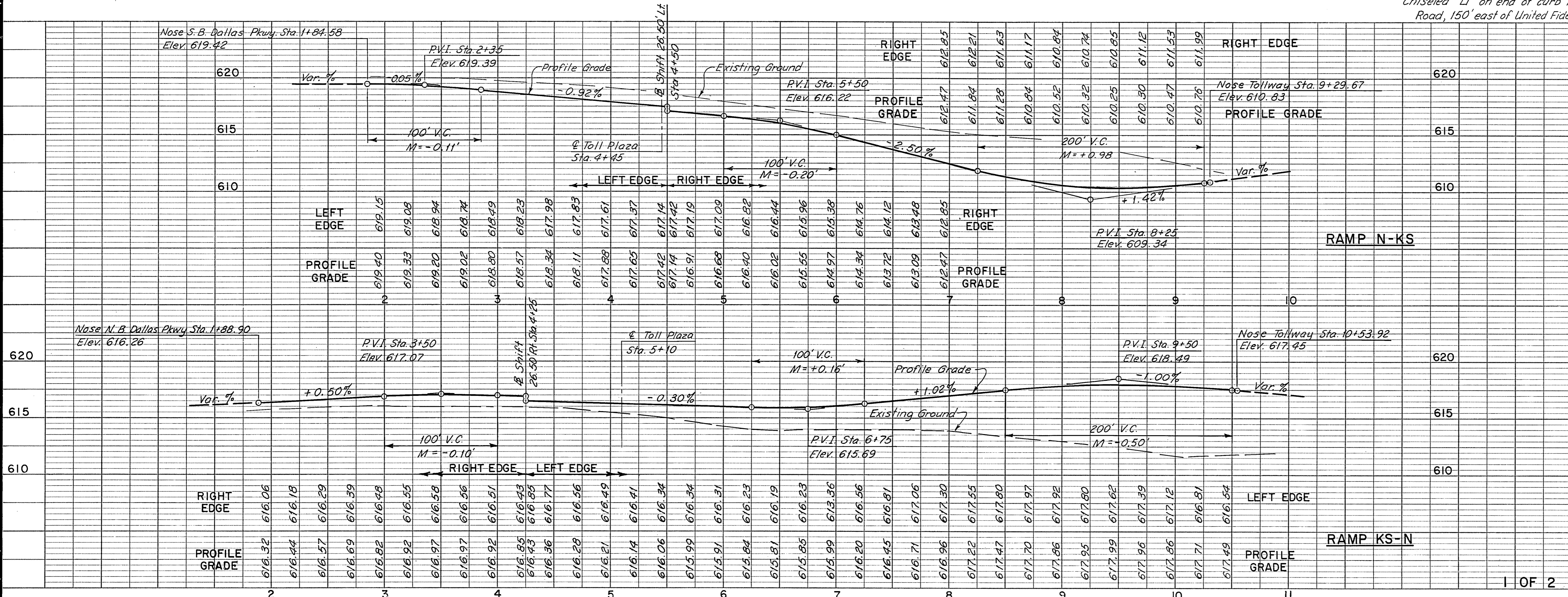

ASBUILT PLANS

NO.	REVISION	BY	DATE
TEXAS TURNPIKE AUTHORITY			
DALLAS NORTH TOLLWAY			
RAMP N-KS AND RAMP KS-N			
PAVING AND DRAINAGE			
HNTB HOWARD NEEDLES TAMMEN & BERGENDOFF			SECTION III
DRAWN <i>GRB</i>	DATE <i>6-13-86</i>	DESIGNED <i>GAL</i>	DATE <i>5-27-86</i>
CHECKED <i>JBR</i>	DATE <i>6-20-86</i>	SCALE <i>1"=50'H; 1"=5'V</i>	
CONTRACT NO. DNT-115 SHEET R18A OF R85			