

**INDEX OF SHEETS**

NO.	TITLE
1	COVER SHEET
2	QUANTITY SHEET
3	GRADING AND STRUCTURE SUMMARY
4-9	TYPICAL SECTIONS
10-22	PLAN AND PROFILE
23	PAVING PLAN - HILTON HEAD DRIVE INTERSECTION
24	PAVING PLAN - TRINITY MILLS INTERSECTION
25	PAVING PLAN - BRIARGROVE LANE
26	PAVING PLAN - PLANO PARKWAY
27	GRADING PLAN - SOUTHWESTERN BELL TELEPHONE DRIVE
28	GRADING PLAN - HILTON HEAD DRIVE INTERSECTION
29	GRADING PLAN - TRINITY MILLS INTERSECTION
30	GRADING PLAN - BRIARGROVE LANE INTERSECTION
31-32	GRADING PLAN - RAMPS "A" AND "B"
33	GRADING PLAN - FRANKFORD RD. & OLD BENT TREE RD. INTERSECTIONS
34	GRADING PLAN - A.T. & S.F. RAILROAD INTERSECTION
35	GRADING PLAN - PLANO PARKWAY & HAVERWOOD RD. INTERSECTIONS
36-37	GRADING PLAN - F.M. 544 INTERSECTION
38-40	CONSTRUCTION PHASING AND BARRICADES
41-42	DRAINAGE AREA MAP
43	STORM SEWER SUMMARY
44	STORM SEWER AND INLET SUMMARY
45-60	STORM SEWER PROFILE
61	PLAN AND PROFILE - CULVERT "D-1"
62	PLAN AND PROFILE - CHANNEL "E"
63	PLAN AND PROFILE - CULVERT "F-1"
64	PLAN AND PROFILE - CHANNELS "G-4" AND "H"
65	PLAN AND PROFILE - CULVERT "J-1"
66	PLAN AND PROFILE - CULVERT "K-1" ( INFORMATION ONLY )
67	PLAN - CHANNELS "J-1" AND "K-1"
68	PROFILE - CHANNELS "J-1" AND "K-1"
69 & 70	HEADWALL DETAILS, CULVERT "D-1"
71	BOX CULVERT SECTIONS "D-1"
72 & 73	HEADWALL DETAILS, CULVERT "E-1"
74	BOX CULVERT SECTIONS "E-1"
75	HEADWALL DETAILS, CULVERT "E-2"
76	HEADWALL DETAILS, STORM SEWER "G-4d"
77	HEADWALL DETAILS, STORM SEWER "H"
78-80	HEADWALL DETAILS, CULVERT "J-1"
81	HEADWALL DETAILS, CULVERT "K-1" ( INFORMATION ONLY )
82	BOX CULVERT SECTIONS, CULVERT "K-1" ONLY
83-95	EXISTING UTILITIES
96	MISCELLANEOUS PAVING DETAILS
96A	MISCELLANEOUS DRAINAGE DETAILS
96B	MISCELLANEOUS DETAILS SIGNING AND STRIPING
96C	MISCELLANEOUS DETAILS - GABIONS

**TEXAS TURNPIKE AUTHORITY**

**CONTRACT NO. DNT 116**

**GRADING, DRAINAGE AND PAVING**

**SECTION VIII**

**VOLUME 1**

**DALLAS NORTH TOLLWAY**

**STANDARD DRAWINGS**

NO.	TITLE
4	STANDARD INLET - TYPE "CDR" - 3', 4', & 5'
5	STANDARD INLET - TYPE "CDR" - 6', 8', & 10'
6	STANDARD INLET TYPE "CDR" - 14'
7	RECESSED AND "Y" INLET DETAILS
14-15	MISCELLANEOUS DETAILS - SERVICE ROAD
16	TRAFFIC SIGNAL INSTALLATION DETAILS
19	METAL BEAM GUARD FENCE
35	PRECAST CONCRETE BOX CULVERTS
50-56	BARRICADE AND CONSTRUCTION STANDARDS
59	PARALLEL WINGS - 30° SKEW FOR SINGLE BOX CULVERT
60	MULTIPLE BOX CULVERTS - MC 6-2
62	CONCRETE HEADWALLS FOR PIPE CULVERTS - CH-II
63	CONCRETE HEADWALLS, 45° SKEW FOR PIPE CULVERTS
64	MULTIPLE BOX CULVERTS - MC 7-2
75	SLOPING AND HORIZONTAL INLETS - IL-S IL-H
80	GRATE DETAILS - ILG-S ILG-H RC-C
81	SINGLE BOX CULVERTS - SC-NA SC-NB SC-NC
82	FLARED WINGS - NORMAL FOR BOX CULVERTS - WS-S-N-3
83	FLARED WINGS - NORMAL FOR PIPE CULVERTS - WS-P-N
84	CONCRETE HEADWALLS, 30° SKEW - CH-II-B - 30°
87	STANDARD INLET - TYPE "CDR" - CITY OF PLANO

Approved by:

**STATE DEPARTMENT OF HIGHWAYS AND PUBLIC TRANSPORTATION**

*Robert L. Yielding*  
District Engineer

Date: 1-10-86

END SECTION VIII  
STA. 896+33.93

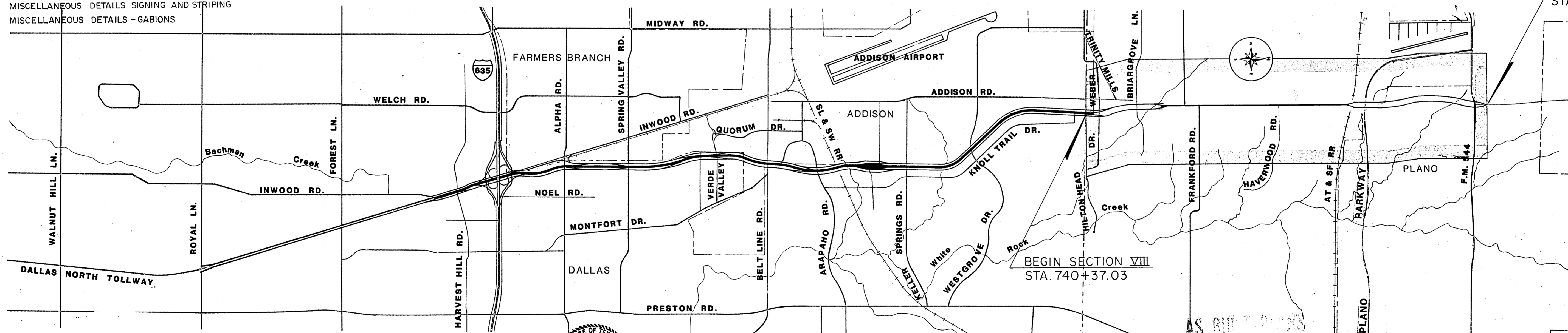

Scale: 1" = 2,000'

BEGIN SECTION VIII  
STA. 740+37.03

Approved by:  
**CITY OF DALLAS**  
*Clifford H. ...*  
Director of Public Works

Date: 3/20/86

Approved by:  
**CITY OF PLANO**  
*...*  
City Manager

Date: 11-22-85

Prepared by:  
**SHIMEK, JACOBS & FINKLEA**  
*J.C. Finklea*

Date: 11/21/84

Recommended by:  
**HOWARD, NEEDLES, TAMMEN & BERGENDOFF**  
*Daniel T. ...*  
Engineer in Charge

Date: March 7, 1985

Recommended by:  
**TEXAS TURNPIKE AUTHORITY**  
*James W. Driffen*  
Director, Engineering & Maintenance

Date: March 8, 1985

Approved by:  
**TEXAS TURNPIKE AUTHORITY**  
*...*  
Engineer Manager

Date: March 11, 1985