

NOTE:
 The information shown on this drawing concerning type and location of underground utilities is not guaranteed to be accurate or all inclusive. The Contractor is responsible for making his own determinations as to type and location of underground utilities as may be necessary to avoid damage thereto. The Contractor shall verify location of underground pipe lines, conduits, and structures by contacting owners of underground utilities and by prospecting in advance of excavation operations.

NOTE:
 ADJUST WATER VALVE BOXES TO PROPOSED GRADES

BENCH MARK #12
 Railroad Spike In South Side Of Pole (ISN IW 99)
 50' North Of Addison Road - Trinity Mills Road
 Intersection, 500' West Of Dallas Parkway.
 Elevation: 638.11

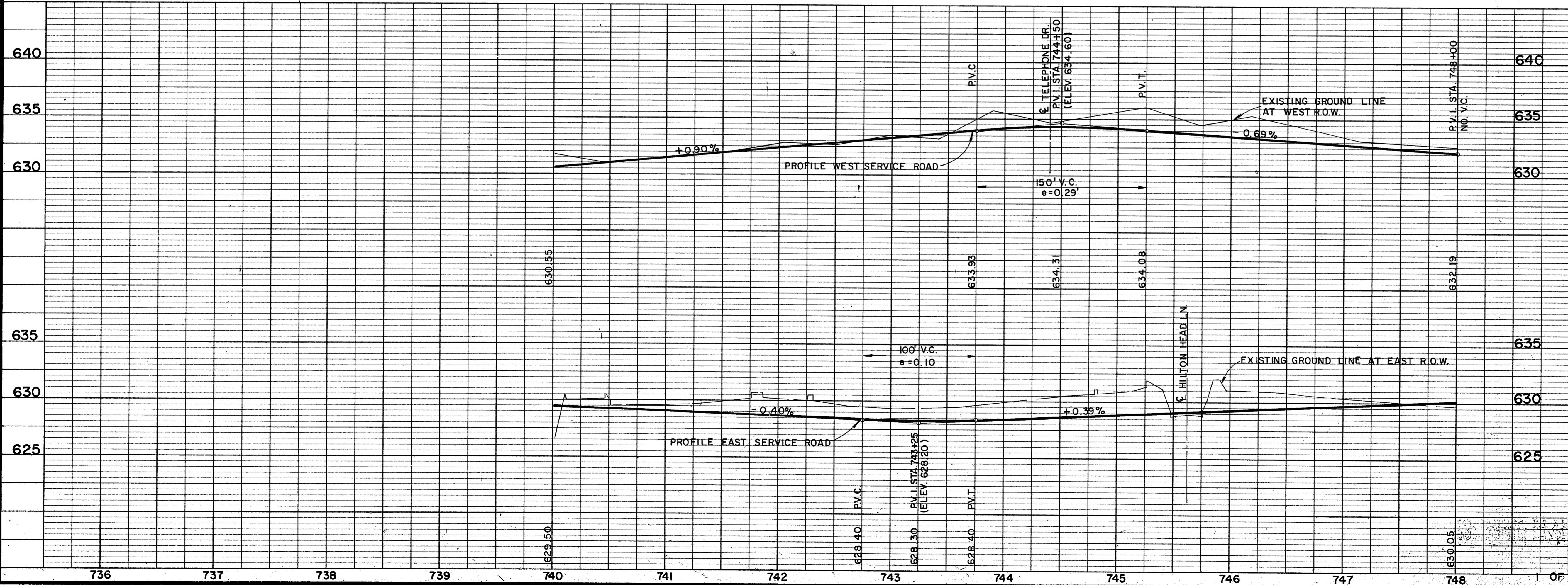

NO.	REVISION	BY	DATE
TEXAS TURNPIKE AUTHORITY			
DALLAS NORTH TOLLWAY			
EXISTING UTILITIES			
STA. 740+37.03 TO STA. 748+00			
SHIMEK, JACOBS & FINKLEA CONSULTING ENGINEERS Dallas, Texas			SECTION VIII
DRAWN S.J.B.F.	DATE MAY 1983	DESIGNED S.J.B.F.	DATE MAY 1983
CHECKED E.T.L.	DATE MAY 1983	SCALE 1"=50' Hor. 1"=5' Vert.	
CONTRACT NO. DNT116 SHEET 83 OF 96			