

Bench Mark: "□" Cut On Conc. Base At South End Of Brick Wall, West Of Stop & Go Store, 139' East Of Sta. 578+68.3 Elev. 631.51

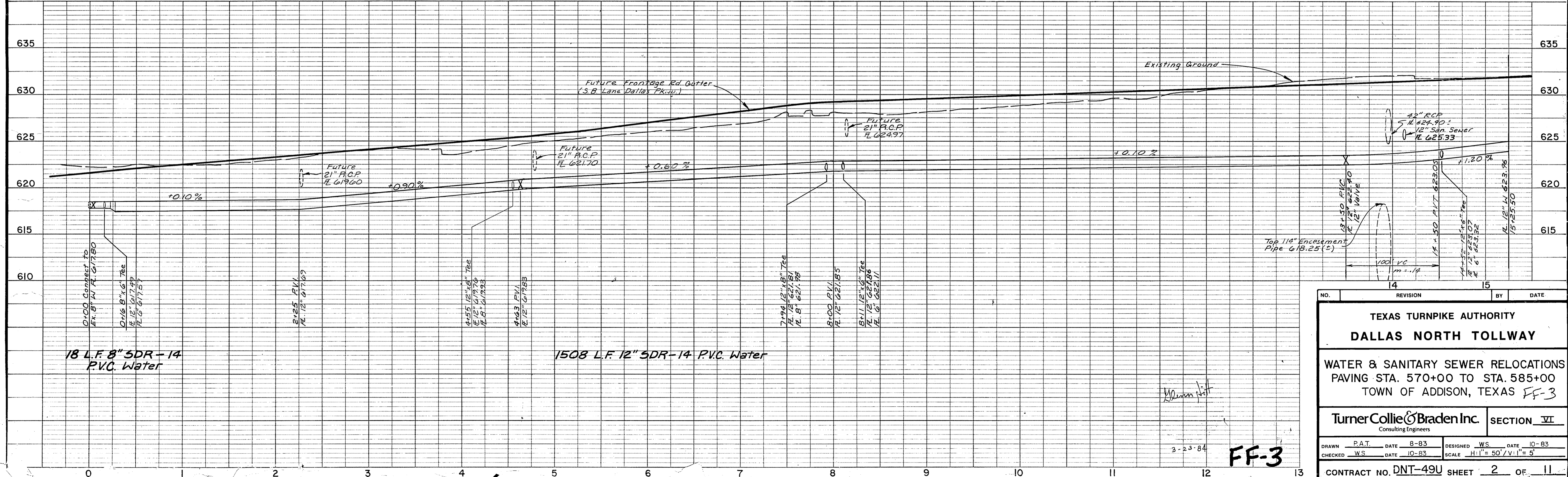

NO.	REVISION	BY	DATE
TEXAS TURNPIKE AUTHORITY DALLAS NORTH TOLLWAY WATER & SANITARY SEWER RELOCATIONS PAVING STA. 570+00 TO STA. 585+00 TOWN OF ADDISON, TEXAS FF-3			
Turner Collie & Braden Inc. Consulting Engineers			SECTION VII
DRAWN	P.A.T.	DATE 8-83	DESIGNED
CHECKED	WS	DATE 10-83	SCALE H:1" = 50' V:1" = 5'
CONTRACT NO. DNT-49U SHEET 2 OF 11			

3-23-84 **FF-3**