

Curve T2A
 P.I. Sta 678+10.96
 N 475652.180
 E 2208198.000
 $\Delta = 16^\circ 37' 26''$
 D = 2° 30' 00"
 R = 2291.83'
 T = 334.83'
 L = 664.95'

Curve T2B
 P.I. Sta 682+76.95
 N 476105.410
 E 2208070.988
 $\Delta = 13^\circ 31' 23''$
 D = 5° 00' 00"
 R = 1145.92'
 T = 135.86'
 L = 270.46'

Curve WL2
 P.I. Sta 681+41.08
 N 475916.035
 E 2208070.442
 $\Delta = 29^\circ 36' 05''$
 D = 5° 15' 55"
 R = 1088.20'
 T = 287.53'
 L = 562.21'

Curve WL3
 P.I. Sta 684+11.55
 N 476105.410
 E 2208070.988
 $\Delta = 13^\circ 31' 23''$
 D = 5° 00' 00"
 R = 1145.92'
 T = 135.86'
 L = 270.46'

NOTE:
 The information shown on this drawing concerning type and location of underground utilities is not guaranteed to be accurate or all inclusive. The Contractor is responsible for making his own determinations as to type and location of underground utilities as may be necessary to avoid damage thereto. The Contractor shall verify location of underground pipe lines, conduits, and structures by contacting owners of underground utilities and by prospecting in advance of excavation operations.

NOTE:
 1. Polyethylene wrap shall be used on all proposed C.I. and D.I. pipe, fittings, and fire hydrant bases.
 2. All Ductile Iron pipe shall be Class 52.

Bench Mark #9
 Chiseled "X" on northeast corner of 2nd inlet on south side of Westgrove Drive, 500' west of Dallas Parkway.
 Elevation: 620.80

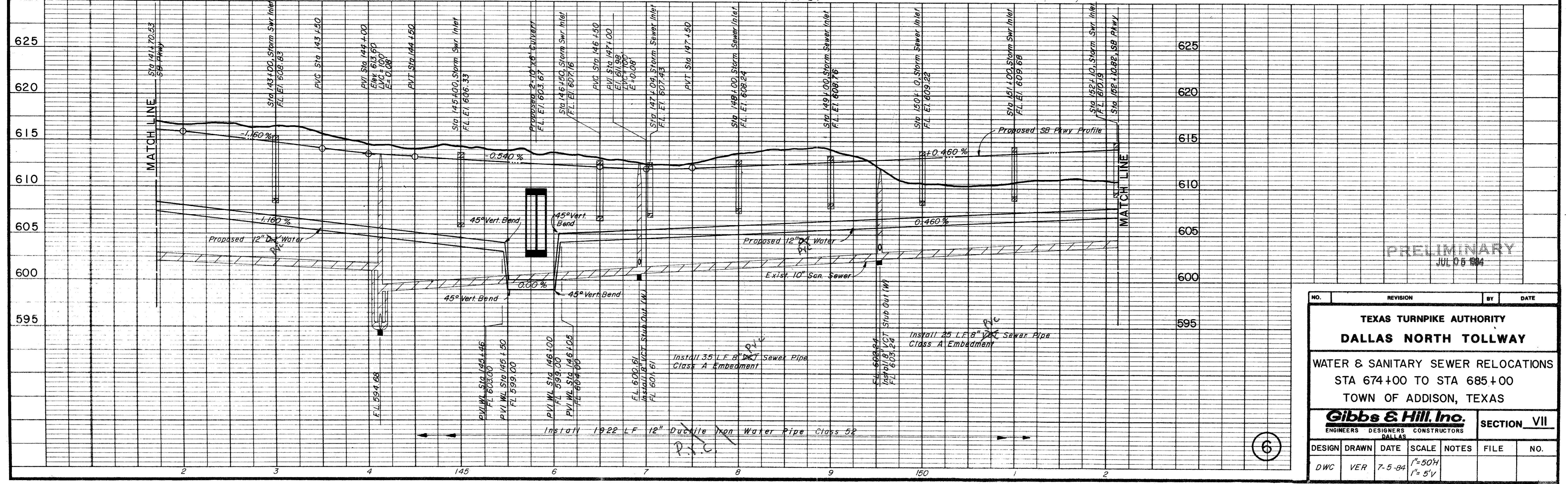

PRELIMINARY
 JUL 05 1984

NO.		REVISION		BY	DATE
TEXAS TURNPIKE AUTHORITY DALLAS NORTH TOLLWAY					
WATER & SANITARY SEWER RELOCATIONS STA 674+00 TO STA 685+00 TOWN OF ADDISON, TEXAS					
Gibbs & Hill, Inc. ENGINEERS DESIGNERS CONSTRUCTORS DALLAS					SECTION VII
DESIGN	DRAWN	DATE	SCALE	NOTES	FILE NO.
DWC	VER	7-5-84	1"=50'H 1"=5'V		