

VICINITY MAP
Map No. 14-D
N.T.S.

*****NOTICES TO CONTRACTOR*****

THE CONTRACTOR(S) SHALL BE RESPONSIBLE FOR CONFIRMING THE LOCATION (HORIZONTAL & VERTICAL) OF ANY BURIED CABLES, CONDUITS, PIPES AND STRUCTURES (STORM SEWER, SANITARY SEWER, WATER, GAS, TELEVISION, ETC.) WHICH IMPACT THE CONSTRUCTION SITE. THE CONTRACTOR(S) SHALL NOTIFY THE OWNER OF ANY DISCREPANCIES FOUND BETWEEN THE ACTUAL CONDITIONS VERSUS THE DATA CONTAINED IN THE CONSTRUCTION PLANS. ANY COSTS INCURRED AS THE RESULT OF NOT CONFIRMING THE ACTUAL LOCATION (HORIZONTAL AND VERTICAL) OF SAID CABLES, CONDUITS, PIPES AND STRUCTURES SHALL BE BORNE BY THE CONTRACTOR(S). IF THE CONTRACTOR(S) DOES NOT ACCEPT THE EXISTING TOPOGRAPHY AS SHOWN ON THESE PLANS, WITHOUT EXCEPTION, HE SHALL HAVE MADE AT HIS EXPENSE A TOPOGRAPHIC SURVEY BY A REGISTERED PROFESSIONAL ENGINEER OR A REGISTERED PROFESSIONAL LAND SURVEYOR AND SUBMIT IT TO THE OWNER FOR REVIEW.

THE CONTRACTOR(S) SHALL CALL 1-800-DIGTESS FOR UTILITY LOCATIONS AND MARKING AT LEAST 48 HOURS PRIOR TO ANY EXCAVATION OR CONSTRUCTION ON THE SITE. WINKELMANN & ASSOC. INC. IS NOT RESPONSIBLE FOR KNOWING THE LOCATION OF ALL EXISTING UTILITIES OR DEPICTING EXACT LOCATIONS OF UTILITIES ON DRAWINGS.

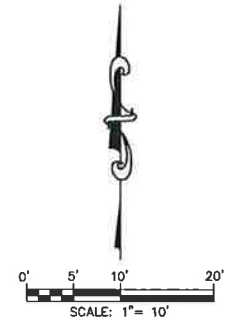
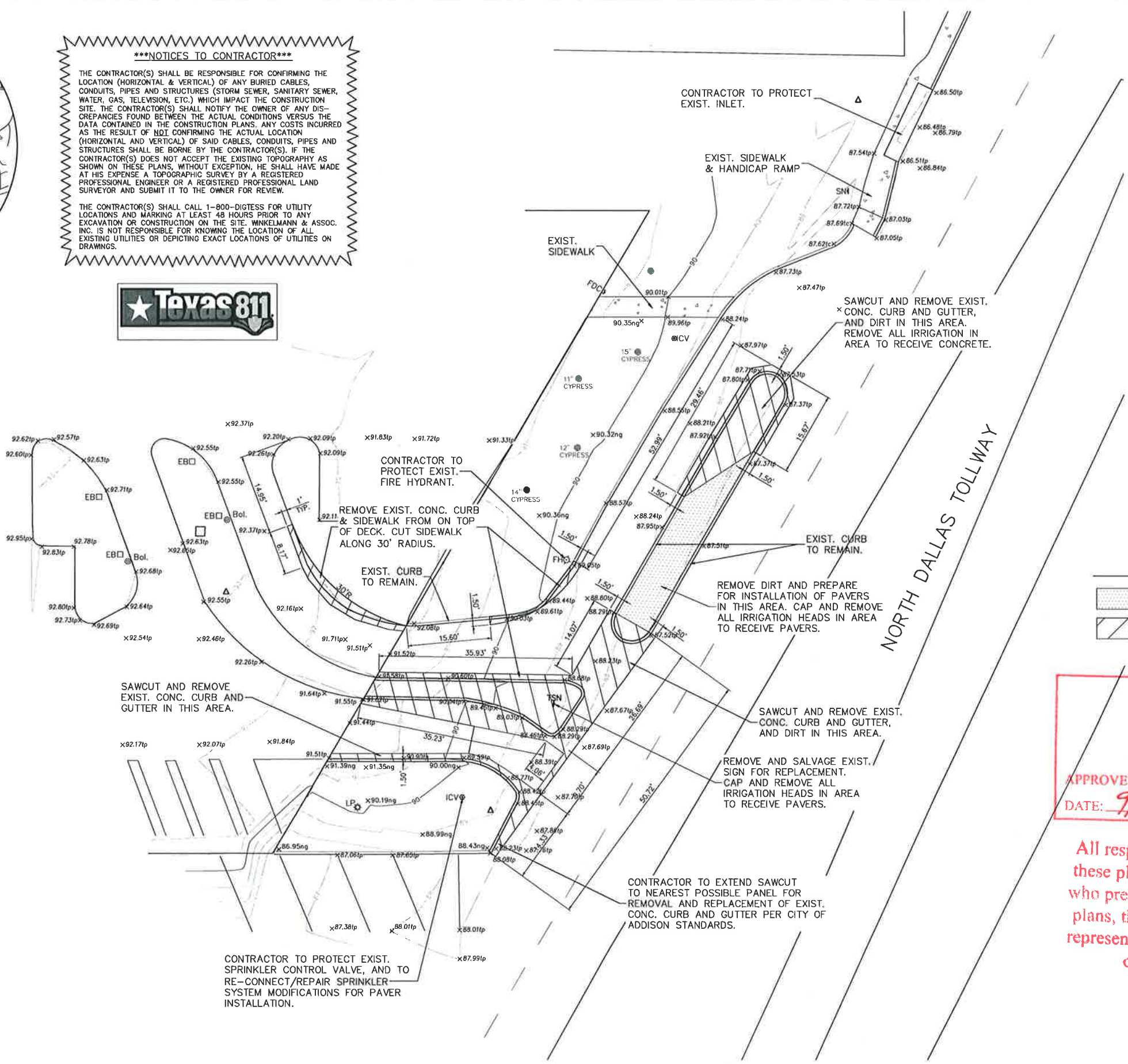

LEGEND

	DIRT REMOVAL
	SAWCUT AND REMOVE EXIST. CONC. PAV'T., CURB, GUTTER AND DIRT

APPROVED FOR CONSTRUCTION

Town of Addison
Public Works Department

APPROVED BY: *Doris E. Wade*

DATE: *9/17/12*

All responsibility for the adequacy of these plans remains with the Engineer who prepared them. In approving these plans, the Town of Addison makes no representation of adequacy of the work of the Design Engineer.

THESE CONSTRUCTION PLANS WERE PREPARED BY MICHAEL D. CLARK, LICENSED PROFESSIONAL ENGINEER NO. 63290

THE SEAL APPEARING ON THIS DOCUMENT WAS AUTHORIZED BY MICHAEL D. CLARK, P.E. # 63290

G.W. FISHER SURVEY, ABSTRACT 0482
CITY OF ADDISON, TEXAS
DALLAS COUNTY, TEXAS

PELOTON COMMERCIAL REAL ESTATE
8333 DOUGLAS AVENUE, #1600
DALLAS, TEXAS 75225
214-220-0600

EXISTING CONDITIONS/
DEMOLITION PLAN
THE ADDISON PARKING GARAGE
ADDISON, TEXAS

Scale: 1" = 10'
Date: JULY 9, 2012
File: 65301-dem.dwg
Project No.: 65301.01(20)

SHEET
C-1

Winkelmann & Associates, Inc.
CONSULTING CIVIL ENGINEERS • SURVEYORS
2500 WEST PALM AVENUE, SUITE 200
DALLAS, TEXAS 75244-1000
PHONE: (972) 496-7000 FAX: (972) 496-7008
TRADE ENGINEERS REGISTRATION NO. 87098-00
REGISTERED PROFESSIONAL ENGINEER
MICHAEL D. CLARK, P.E. # 63290
COPYRIGHT © 2012, Winkelmann & Associates, Inc.

G:\105301\ENGINEERING\Construction Plans\65301-dem.dwg