

VICINITY MAP
Map No. 14-D
N.T.S.

TRAFFIC CONTROL GENERAL NOTES

1. ALL SIGNS, PAVEMENT MARKINGS, AND OTHER TRAFFIC CONTROL DEVICES SHALL CONFORM TO THE "TEXAS MANUAL ON UNIFORM TRAFFIC CONTROL DEVICES" SPECIFICATIONS.
2. DESIGN BASED ON 40 MPH POSTED SPEED LIMIT.
3. ALL CONSTRUCTION TO BE IN ACCORDANCE WITH TxDOT STDS. AND SPECS.

WORK HOUR LIMITATIONS:
WORK IN THE NORTH DALLAS TOLLWAY SERVICE ROAD TO BE PERFORMED BETWEEN 9:00am AND 3:00PM ON WEEKDAYS TO MINIMIZE CONGESTION DURING PEAK HOURS.

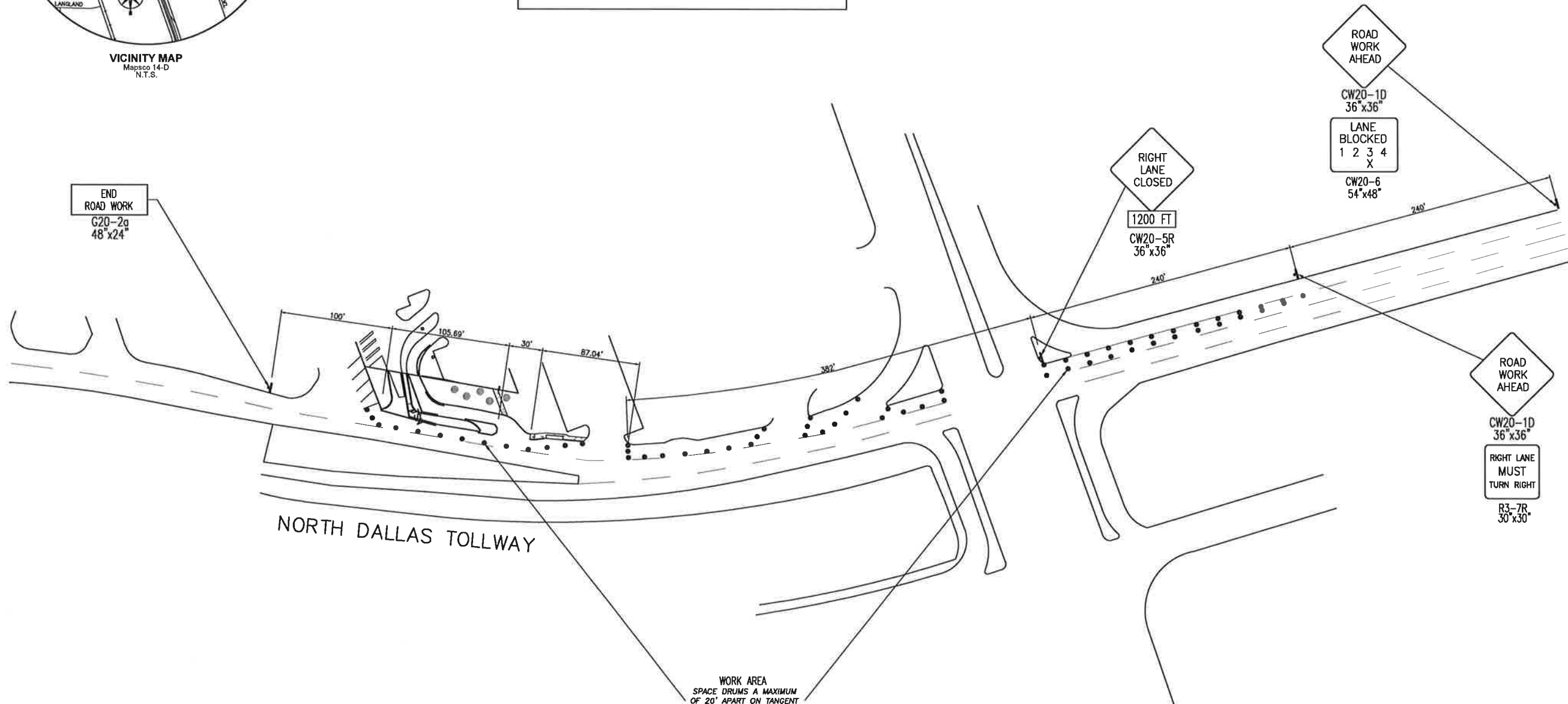
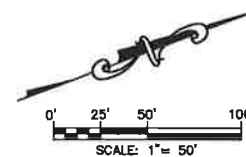

WORK AREA
SPACE DRUMS A MAXIMUM
OF 20' APART ON TANGENT
AND 20' APART ON TAPER.



CHANNELIZING DEVICES
SEE TxDOT BC(8)-07
STANDARD FOR DETAILS.

REVISION	APPROV.
No.	Date

THESE CONSTRUCTION PLANS WERE PREPARED UNDER THE RESPONSIBLE SUPERVISION OF MICHAEL D. CLARK, LICENSED PROFESSIONAL ENGINEER No. 63290

G. W. FISHER SURVEY, ABSTRACT 0482
CITY OF ADDISON
DALLAS COUNTY, TEXAS

PELTON COMMERCIAL REAL ESTATE
8333 DOUGLAS AVENUE, #1600
DALLAS, TEXAS 75225
214-220-0600

TRAFFIC CONTROL PLAN
THE ADDISON PARKING GARAGE
ADDISON, TEXAS

Scale: 1" = 50'
Date: JULY 9, 2012
File: 65301-tcp.dwg
Project No.: 65301.01(20)



Winkelman & Associates, Inc.
CONSULTING CIVIL ENGINEERS & SURVEYORS
4500 WALKER ROAD, SUITE 200
DALLAS, TEXAS 75242
TEL: 972-492-2288 FAX: 972-492-2288
COPYRIGHT © 2012, Winkelman & Associates, Inc.