

ADDISON CIRCLE OFFICE BUILDING ADDISON TEXAS

HUITT-ZOLLARS, INC. 3131 McKinney Ave., Suite 600 Dallas, TX 75204 214-871-3511

HKS HKS Inc. Architects-Engineers-Planners 700 N. Pearl, Suite 1100, LB 307 Dallas, Texas 75201-7465 (214) 969-2599

Job No: 5494 ISSUED FOR CONSTRUCTION

16 JAN. 1998

Revisions:

Date: _____

Sheet Title: **DIMENSION CONTROL PLAN - PAVING**

Sheet No: **C3.1**

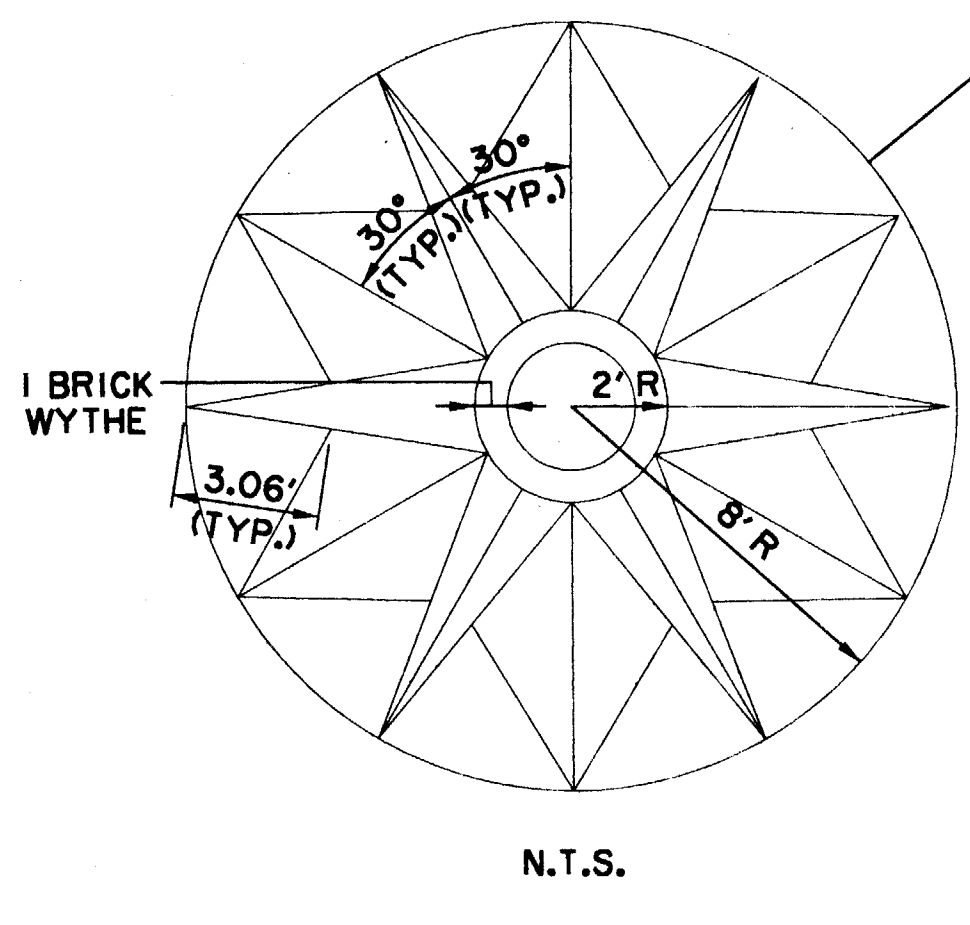
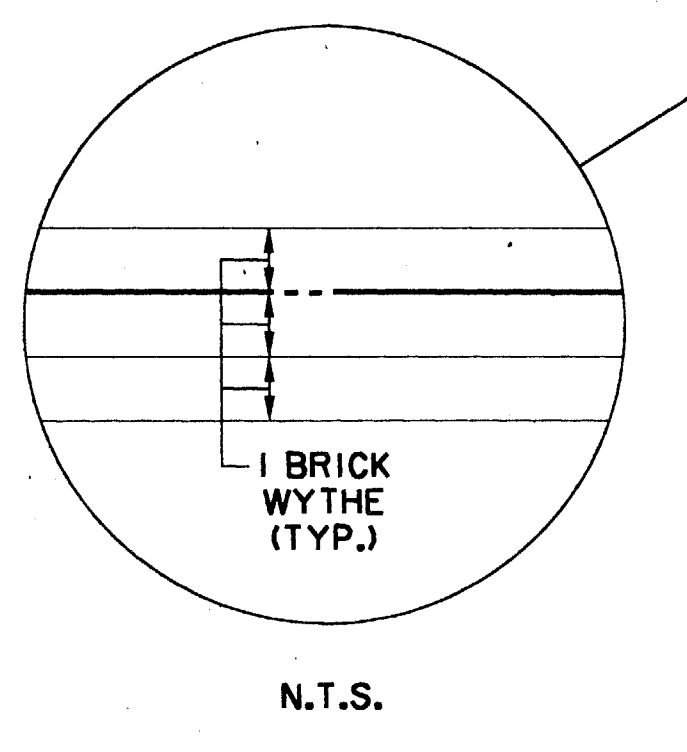
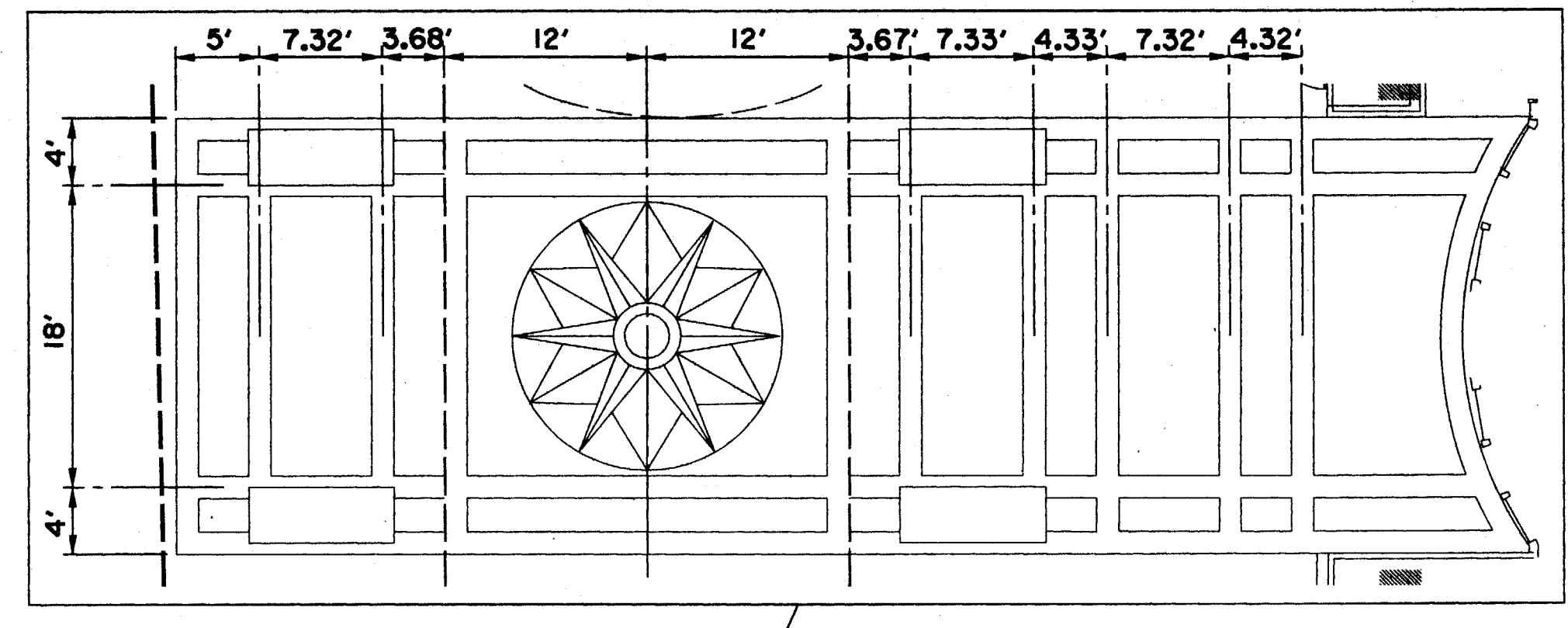
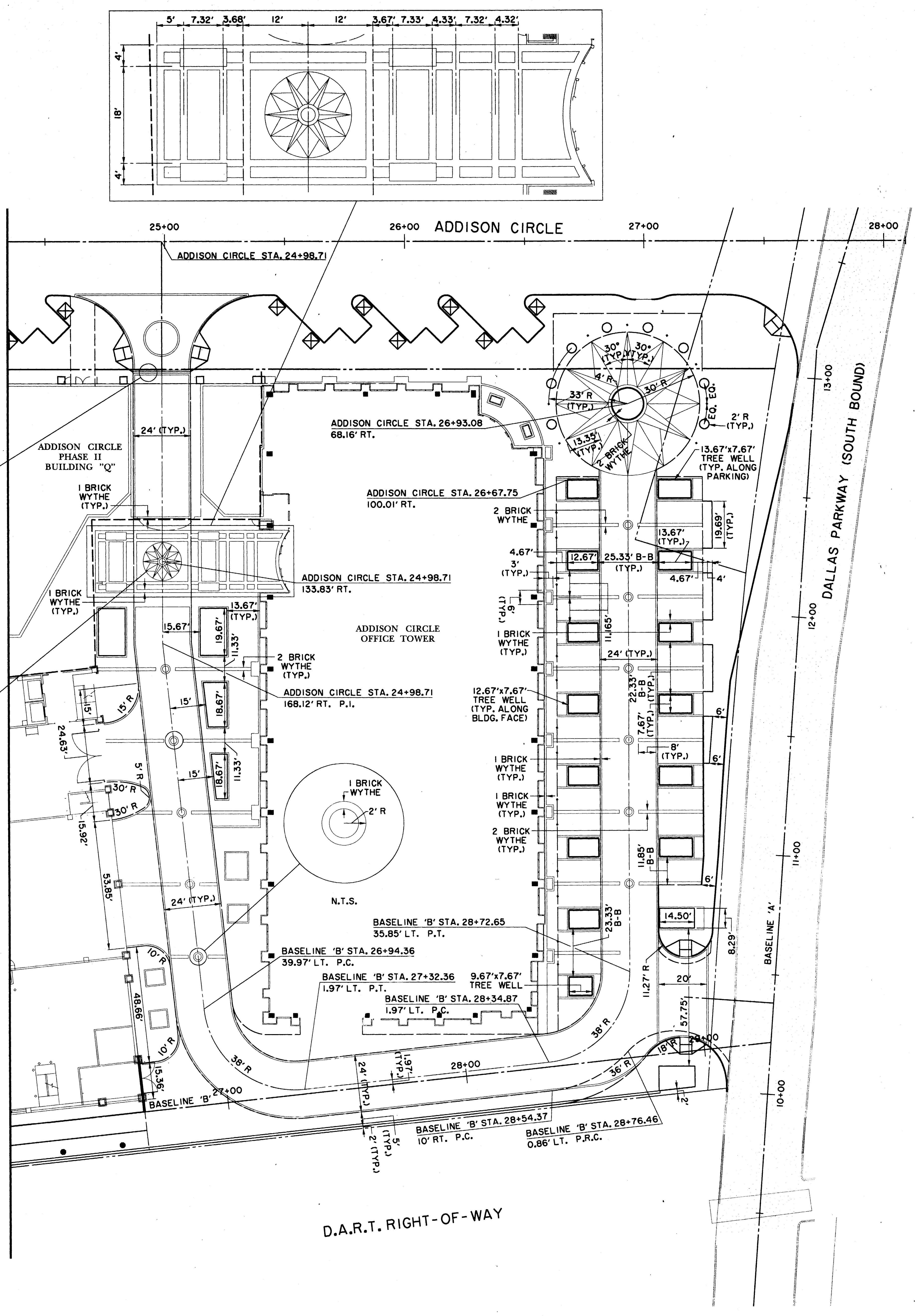
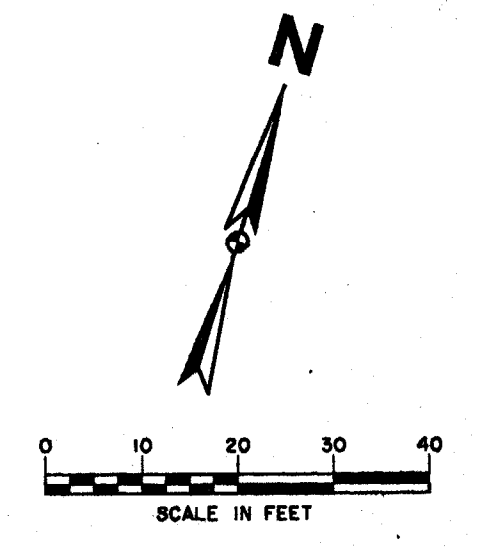

- NOTES:
- SEE SURFACE PATTERNING PLAN FOR BRICK PATTERN AND TYPES. (SHEET C3.2)
 - 1 BRICK WYTHE IS NOMINALLY 8".

BENCHMARKS:
 BM#5
 1' CUT AT NORTHWEST CORNER OF NORTH HDWL. OF 7'X7' BOX CULVERT UNDER RAILROAD, 180' WEST OF DALLAS PARKWAY SOUTHBOUND, ELEV. 610.49
 BM#6
 1' CUT AT CENTER FRONT OF 15' REC. INLET SECOND INLET NORTH OF RAILROAD TRACKS ON THE WEST SIDE OF DALLAS PARKWAY SOUTHBOUND, ELEV. 605.67

THE SEAL APPEARING ON THIS DOCUMENT WAS AUTHORIZED BY DAVID E. MEYERS, P.E. 81512 ON JAN. 16, 1998.

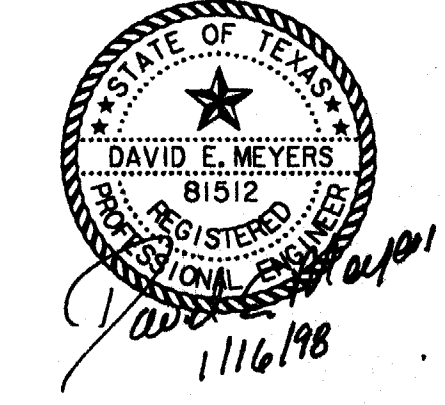

Files: _____

Plot dates: _____

20 JUN 97